

zhiroad

- Dash Cam Front & Rear
- 4K / WiFi / 64G Card / CPL Filter
- Our factory strives on dashcam
- We provide the best after-sales service



View



Replay



Download



Share

Watch Guide Videos

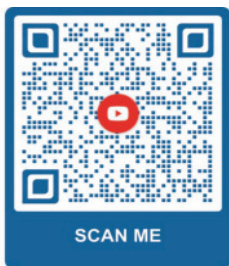

Scan the code with your smart phone or visit the link:

<https://www.youtube.com/@zhiroad-cam>

Watch GUIDE VIDEOS to learn all the features of your dash cam so you can get the most out of it.

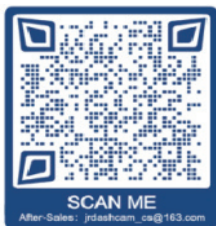

jrdashcam_cs@163.com

Dash Cam



64G card has been inserted in dash cam
Any using question please feel freely contact with us:



After-Sales Services: jrdashcam_cs@163.com

- Product Specification -

LCD Screen Size	3" IPS Screen
Resolution	Front Cam - 4K Rear Cam -1080P
WiFi	Built-in
Battery	Built-in 200mAh lithium-nickel button cell battery
Memory Card	64G (Inserted in dashcam) Max support 256G (Class 10, High Speed)
Video Format	TS
Photo Format	JPG
Current Frequency	50HZ/60HZ
Product	Dash Cam

- Dear Valued Customer -

Thank you for choosing the **Zhiroad D2 Pro** dashcam. We appreciate your trust in our product. Should you have any questions or concerns, please do not hesitate to contact us.

We are dedicated to providing excellent after-sales service to all our customers. You can reach out to us at any time, and we aim to respond promptly.

Encountering Issues?

1. Problems with WiFi connection
2. Missing or faulty product parts
3. Product malfunction
4. Discrepancies between product and website description

Before considering a return, please get in touch with us. While we strive for perfection, we understand that no product can satisfy every customer 100%. However, we assure you of our 100% commitment to address your concerns.

How to contact us?

Method 1: Email us : jrdashcam_cs@163.com

Method 2: Scan the code



Method 3: Visit our product page, enter our store, and click on the "Ask a question" button located in the upper right corner.

Please contact "Amazon Buyer Service" and request assistance in reaching our after-sales customer service. Because Amazon's customer service might not be equipped to answer product-specific questions, we are. We hope for your understanding in this regard.

- Table of Contents -

Mounting Structure Diagram————— 01

Important Notice Before Install————— 02

Camera Overview————— 03

How to Use the Button————— 06

Icon Instruction————— 08

Menu Setting————— 09

How to Playback the Video————— 13

How to Connect WiFi————— 16

Installation Guidance (details)————— 22

Questions & Answer————— 28

After-Sales Service————— 33

- Mounting Structure Diagram -



- Important Notice Before Install -

1. Any using question or not satisfied, please feel freely contact with our seller: jrdashcam_cs@163.com.

2. **Before installation** : Insert the rear cam -- Charge front cam -- Confirm both front and rear cam can works.

3. The 64G Card already inserted in dash cam, max support **256G**.

4. The mirror effect of the rear cam can be set. Found " Pull the mirror back ". The rear cam default setting is the left and right inversion effect, **which prevents accidents when reversing!**

5. Please always keep charging the dash cam when using it, the internal battery is for emergency recording when parking. We also is the supplier of other dash cam's seller, all the 3 inch dash cam in the market like this.

6. If FREEZING or KEEP POWER ON & OFF issues, please use the card needle to insert the RES little hole (at the bottom of the dash cam).

7 When the dash cam connected to WiFi, can't operate the dash cam, only can start/pause the recording on the mobile phone, or Playback/Delete the recorded files on the mobile phone.

- Camera Overview -

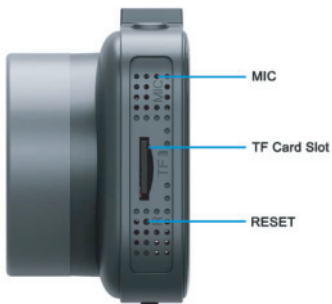
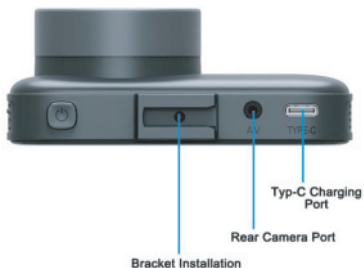

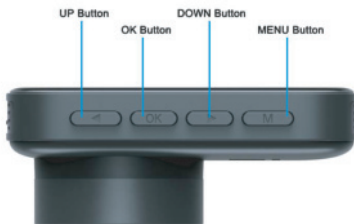



- How to Use the Button -

Power Button

Long Press to turn on/off the camera.

Short Press to turn on/off the screen but still recording (the blue light keep flashing)

Mode Button/ M Button

When recording, Long Press to enter the Playback Mode

When at setting, press it then back to previous step

OK Button

In playback, short press to enter and choose and playback the video /photo

In menu setting, short press to enter and confirm selection.

In recording, short press to manual pause/stat the recording

Up Button

1.Long press: one key turn on/off the WiFi

2.When at setting, you can filter the options that you want

Menu Button

1. In Standby, press Menu button to enter the menu function setting
2. Another function of this button: Return to the previous step or exit the current operation

Down Button

1. Short press: to take a photo (in photo mode)
2. Long press: one key to turn on /off the microphone
3. Short press: switch 3 display way of front and rear cam (front cam only, rear cam only , front+rear see below image)



Display Mode 1: dual
cams display



Display Mode 2: front
camera display only

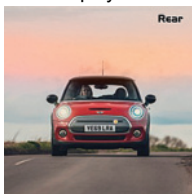

Display Mode 3: rear
camera display only

- Icon Instruction -

(when some function was turn off , the icon will not display on screen)

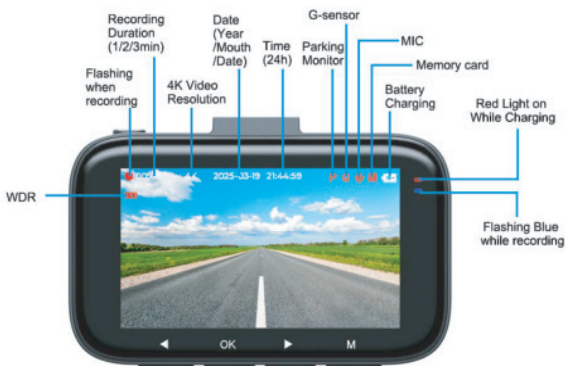

- Menu Setting -



(Press “  Button ” to enter/back off this interface)

Press once **Menu Button** to enter the menu

Press **Up and Down Button** to select toggle other options

Press **Ok Button** to enter/confirm options

Press **Menu Button** again to exit the menu

1)Menu Setting of Recording

Menu	Choice	How to Set	Function
Resolution Ratio	4K/2K/1080P	press "ok " twice to enter and confirm choice	_____
Loop Record	1/2/3min	press "ok " twice to enter and confirm choice	the recording duration
Language	English...	press "ok" to enter and confirm choice	_____
G-sensor	Close/Low/ Middle/High	press "ok" to enter and choose your choice	When collision, the sensitivity of dash cam: auto lock file. (better turn off or set Low when driving)
Parking Monitor	Close/Open	press "ok" to enter and confirm choice	When parking and collision, the sensitivity of dash cam: auto start up and record (better turn off when driving)
Time-Lapse	1/2/5fps	press ok to turn on/off	need using the hardwire kit so that can make the video file playback quickly
Time-Lapse Record Time	Close/12/24 /48 hours	press "ok" to enter and confirm choice	choose 12h means will has 12 recording compat during a day, begin from the setting moment (need using the hardwire kit)

Menu	Choice	How to Set	Function
WiFi Settings	Open/Close	press ok to turn on/off	Scan the code -Down APP- Connec the dash cam wifi on APP - playback videoon your phone
Mirror Flip	Close/Mirror /Rotation	press ok to turn on/off	the video of the rear cam inverted left and right (recommended close, otherwise the reverse is prone to accidents)
Screen Saver	Close/10s/ 30s/1min	press “ok” to enter and confirm choice	the screen will shut down after 10s/30s/ 1min but still keep recording
Sound Record	Close/Open	press ok to turn on/off	microphone/record your sounds or not
Key Tone	Close/Open	press ok to turn on/off	the sounds of pressing the button
Booth Sound	Close/Open	press ok to turn on/off	the sounds of power on/off
Auto Power Off	Close/1/3/5min	press ok to turn on/off	will auto power off after a time

Menu	Choice	How to Set	Function
Time Setting	Y/N/D H/M/S	press up/down to correct, press ok to confirm and enter next option	correct the date and time , after setting , manual turn off and then turn on the dash cam means save the setting
Format	Cancel/ Confirm	press ok to confirm your choice	format the recording file (include the locked file)
Default	Cancel/ Confirm	press ok to confirm your choice	reset the factory setting sometimes dash cam not work can try to reset it
Exposure compensation	-1,-2,-3,0, +1,+2,+3	press ok to confirm your choice	adjust the clarity of the picture according to the brightness of the light
Screen brightness	120/100/ 80/60/40	press ok to confirm your choice	adjust the brightness of the screen
Reject Flicker	50Hz/60Hz	press ok to confirm your choice	record more clear pictures
WDR	On / Off	Press OK to On/ Off	improve overall exposure during recording

- How to Playback the Video -

Way 1 to Playback on Dash Cam



Press the **M Button** to access this **Playback Mode** (Please make sure dash cam is stopped recording.)

Use the **▲ Button** and **▼ Buttons** to choose the Front and Rear video.

Press the **OK Button** to play the selected video.

Playback Control: press **OK Button** to pause/play video, and **▲ Button** and **▼ Buttons** for video navigation.

At **Playback Mode**, when you chose a video file, press **Menu Button** to enter

Photo(1) interface - choose your choice Lock/Unlock /Delete - press **ok Button** to Lock/Unlock/Delete that video file ,

Photo(2) interface



Photo(1)



Photo(2)

Way 2 to Playback on PC

Insert the memory card into **MEMORY CARD READER**

—— insert the reader into your computer

—— open the memory card -select “record”:

record_0 is the front cam file

record_1 is the rear cam file



Way 3 to Playback on Phone

Connect your phone to dash cam via WiFi

Access the recording file and play it on your phone



- How to Connect WiFi -

This feature allows users to connect their phones to the dashcam via a dedicated app and WiFi. Once connected, users can view the live feed from the dashcam on their phones. Please note:

The maximum distance between the dashcam and the phone for a stable connection is 3-5 meters.

The WiFi feature is intended for short-range viewing, and it's not possible to monitor the dashcam from remote locations, such as viewing from home while the dashcam is in a distant car.

Steps to Connect to WiFi for the First Time

1.Initialize Connection:

- Open the dashcam menu.
- Navigate to 'WiFi' settings and enable WiFi.
- Locate the QR code for the app within the menu.
- Scan the QR code with your phone to download and install the dedicated dashcam app.

2.Prepare the Dashcam:

- Restore the dashcam to its factory settings.
- Format the Memory Card.
- Turn off the dashcam, then turn it back on.

3.Finalize Connection:

- Again, open the dashcam menu and ensure WiFi is enabled.
- Click on 'Connect Dashcam' within the app.
- This will redirect you to your phone's WiFi settings. Connect to the dashcam's WiFi network."

WiFi Connection Settings

1. Open Menu Button menu, find wifi, open wifi, find the QR code of the app and scan it to download and install.

Press "Menu Button" enter menu and found the "Wi-Fi" . Press one "OK Button" to enter and turn on the "Wi-Fi"

Then you can see as below picture, scan code and download the APP



Scan the QR code with your mobile phone to download APP. Turn on the mobile phone wifi, wait for the wifi name of the dash cam to appear on the screen, click connect and enter the wifi password.



Wifi name and password for dashcam

Open Your WLAN:

Found the Wifi Account Like : **D2 Pro_******

Wi-Fi Passwd:12345678

Open the App "**BOBOCAM**" or "**Viidure**"



1. Through the mobile APP, you can watch the video recorded by the recorder in real time.

Click the The blue button "Access Camera" at the bottom right to start connecting the dash cam. After connecting, click to zoom in to switch between the front and rear lenses. (Ignore if there is no rear camera.)

2. View the videos and pictures saved in the Memory Card more clearly. Click on a video or photo to view the videos and pictures saved on the Memory Card.

Select the picture or video you want to save, click Download to save it to the APP album.

3. You can start recording and taking pictures through APP authorization.

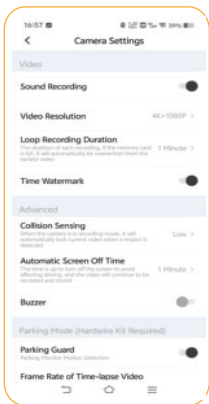

In APP settings

You can modify the Wi-Fi name and Wi-Fi password for this dashcam, and other setting on the page.

app setting, like language setting, date choice, app question feedback (no seller, if you want to contact with us, please mail with

jrdashcam_cs@163.com)

How to playback on your phone



Click it to switch Front or Rear Cam

Click it to Zoom the video screen

Click it to turn on/off the microphone quickly

Click it to pause/star recording

Click it to tack a photo

Camera file: 3 folder

Loop

Snapshot

Locked



Camera Setting: You can do some dash cam setting here, like Loop-Recording, Parking Montion, Format Memory Card.....



Download: you can choose to download the recording file on your phone directly .

After download the file, you can choose ONE-KEY Share it with Your Friends.

Screenshot: you can pause the recording and click screenshot , then easily save that moment in your phone.

Delete: choose and delete the recording file.

- Installation Guidance (details) -

Please test both front and rear cam before install it

Insert the rear cam cable into front dash cam - insert the front cam Type-C port into front dash cam - insert the dash cam charger on your car - Any question please mail with us : jrdashcam_cs@163.com

(If there is a problem with the dash cam before installation, you can contact with us to deal with it in time without wasting installation time. If there is a problem after installation, it can also be ruled out that it is not a machine problem but an installation problem.)

-Install Front Cam -



Step 1: Insert the Memory Card

Before installation, please check the camera's normal function, and make sure you are using a high speed Micro Memory card (speed Class 10 or above.), and format the card in the camera menu before recording.

Gently push the memory card in until you hear a click, and allow the spring release to push the card in/out.



Step 2: Installing the Camera onto the Windshield

1. Clean the front windshield



2. Install the suction cup



3. Adjust the angle of item

You can rotate the camera 360° to record to record the your preferred direction.



Loosen the screw, adjust the main camera's angle and then tighten it to lock at the desired angle.

4. Install the suction cup on the windshield and lock it



5.Way to Charge :

Use the cigarette lighter charger to charger it



-Install Rear Cam -



This dash cam does not have a reverse mode.

The rear camera can be installed on the rear windshield.

There are two packs 3M adhesive in the pack age for the rear camera .Please clean the rear windshield and find a suitable position, then paste the rear camera on the windshield.



Detail on Rear Cam Installation

1. Determine the location of the camera on the inside of the rear windshield and wipe it clean to avoid unstable pasting;
2. Tear off the protective film of the 3M adhesive on the rear camera;
3. Paste the rear camera on the area just cleaned and press hard to make it more firmly pasted;
4. Insert the camera line into the gap along the edge of the windshield, the roof, and the side of the car.



* These accessories are needed during installing the rear cam.



After the installation is completed, connect the rear plug to the rear camera interface of the recorder.

6. Then start the car engine to turn on the dash cam front and rear.



Attention

If turn on front cam firstly then connect rear cam to dash cam, maybe will lead to short circuit black screen - reboot dash cam maybe can fix this problem.

- Questions & Answer -

Q1: Camera can't turn on?

A: There are 3 reasons that can cause this problem:

- 1) The dash cam needs continuous power supply, just check if the power connection is normal.
- 2) The dash cam needs to be reset, just connect the power, use a pin to insert the RE Little Hole (as below photo 1 and restart the camera.
- 3) A defective card can cause the camera not to turn on, just remove the card or get a new card and insert it into the camera.



photo 1

Q2: If Rear Cam Not Display:

A: There are 4 reason that can cause the problem:

- (1) Please used our dash cam charger to charge it.

- (2) Please try to press "Up Button" to switch the recording screen
- (3) Please do not plug in rear cam's charger port (AV-IN) after the dash cam is turned on, otherwise it will cause the recorder to short-circuit and black screen. (Restart may fix the problem)
- (4) Reconnect the rear cam cable, especially the connection of the two sections of the rear cam cable part.

Q3: Camera automatically stop recording?

A: There are 2 reason that can cause the problem:

- (1) Format the memory card in setting menu. (The G-sensor might be triggered too often and locks too many video files, try lower sensitivity)
- (2) Replace a new Memory Card to test (Class10 High Speed **32-256G**)

Q4: Camera auto Power off / on.

- A:(1)Please use USB Type -C Cable to test if the if the car charger is broken.
- (2) Remove the Memory Card and let the camera charging using dash cam cigarette charger included in the box. Then reset the camera again.

Q5: Keeping Saying Format Memory Card?

A:(1)Please format the Memory Card - then reset the default setting on dash cam - then use the needle pin to inset the RE little hole to reset the dash cam (item will auto turn off and turn on again after reset successfully)

(2)Please use another memory card to test

(3)Suggested set to lower G-sensor and recommended to format your Memory Card after using a time.

Q6: Dash Camera Freezing/Lagging or Crashing?

A: Use the card needle to insert the RE little hole to restart the camera (when hear the clicks sounds , it was reset successfully or when dash cam auto turn off and turn on again , then it was reset successfully)

Q7: Some of video files are missing only can see the front and after file.

A: Hitting too much can cause file corruption, but we can fix it. Please copy fromn the before to after files of the accident together to us: jrdashcam_cs@163.com

Q8: Camera automatically stop recording?

A: Format the memory card in setting menu. The G-sensor might be triggered too often and locks too many video files, try lower sensitivity.

Q9: Dash cam can not auto turn on/off with your car:

A: (1)Please using our dash cam charger to charge it

(2) After excluding (1), please Reset the dash cam factory setting, press ok button to stop recording firstly, then press twice the left middle button and choose the " default Setting" press ok button and confirm" ok" choice - Please take off the card and use a needle to insert the RES little hole

Q10: The recording video keep flashing / colourful ?

A: (1)Verify that Frequency option is set to 50Hz (United Kingdom) or set accordingly.

(2)Restore Factory Setting or use a needle to insert the RES little hole to reset

Q11: The dash cam display red light but black screen.

A: (1) Set the Screen Save? Press "Menu Button" - choose the "Screen Saver" - close it
(2) Use our dash cam charger to charge it - Reset it (RES) - Long press the "Power Button" to turn it on again

Q12: The camera gets HOT?

A: It is normal for your camera to run slightly hot. Due to it is recording video at high speed, the dash cam maybe hot during using. (no more than 170°F/75°C)

Q13: Can not save the Date & Time setting?

A: Please use our cigarette charger charging it for 30 minutes - Take off the card and use a needle to insert the RES little hole - Set the default setting - Set the date and time, then exit the menu and manually turn off the dash cam = save the setting. Do not cut off the power, keep charging for about 20 minutes

Q14: Any other questions or need other accessory replacement(like suction cup?)

A: Contact the amazon seller's email, We are always here:
jrdashcam_cs@163.com

- After-Sales Service -

Warranty

- All our products are covered by 3-year warranty.
- Mail: jrdashcam_cs@163.com

Customer Support

- For questions, support, or warranty claims, contact us at AMAZON. We will reply you within 24 hours.
- If you can provide the photos or video to show your problem, we will be appreciated.
- IMPORTANT: Proof of original purchase (Online order receipt is also accepted) is required for any warranty service.

zhroad is firmly committed to continually improving our products, services and customer experience. As our VIP customer, if you have any thoughts on how we can do better, we would appreciate your constructive feedback and suggestions. Please contact us.



Thank you for choosing **zhroad**!

FCC Warning

This device complies with Part 15 of the FCC Rules. Operation is subject to the following two conditions:

(1) This device may not cause harmful interference, and (2) this device must accept any interference received, including interference that may cause undesired operation.

NOTE 1: This equipment has been tested and found to comply with the limits for a Class B digital device, pursuant to part 15 of the FCC Rules. These limits are designed to provide reasonable protection against harmful interference in a residential installation. This equipment generates, uses and can radiate radio frequency energy and, if not installed and used in accordance with the instructions, may cause harmful interference to radio communications. However, there is no guarantee that interference will not occur in a particular installation. If this equipment does cause harmful interference to radio or television reception, which can be determined by turning the equipment off and on, the user is encouraged to try to correct the interference by one or more of the following measures:

- Reorient or relocate the receiving antenna.
- Increase the separation between the equipment and receiver.
- Connect the equipment into an outlet on a circuit different from that to which the receiver is connected.
- Consult the dealer or an experienced radio/TV technician for help.

NOTE 2: Any changes or modifications to this unit not expressly approved by the party responsible for compliance could void the user's authority to operate the equipment.

RF Exposure Statement

To maintain compliance with FCC'S RF Exposure guidelines, This equipment should be installed and operated with minimum 20cm between the radiator and your body. This device and its antenna(s) must not be co-located or operation in conjunction with any other antenna or transmitter.