

CT13

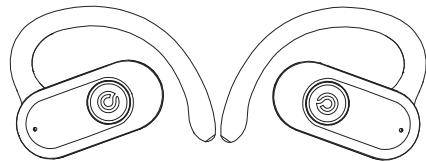

User Manual

User Guides

Thank you for purchasing the CT13 Wireless Earbuds.
Please review this manual thoroughly before operating your device.
In order to avoid unnecessary injuries, please do not disassemble this product by yourself.

Warranty

For your better consumer experience, We provide you with warranty.
Please scan the following QR code:



Scan to get a 2-year warranty for CT13!

Contact Us

Email: support@i-cxk.com
Tel: +1 206-460-0500
Website: www.i-cxk.com

Package Content

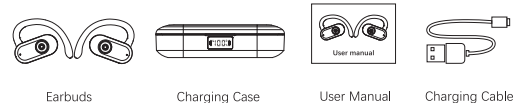

Product Overview

- ① Sound Outlet
- ② MFB (Multi-function button)
- ③ Microphone
- ④ Earbuds Indicator
- ⑤ Earbuds Power Indicator
- ⑥ Charging Case Indicator
- ⑦ Type - C Charging Port
- ⑧ Reset Buttons

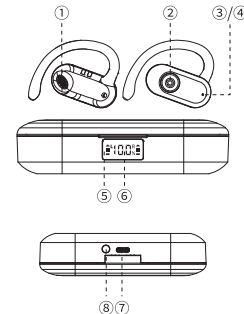

CONTROL

Power on	Open the charging case/press and hold the MFB button for 2 seconds
Power off	Put back into the charging case and close the charging case/press and hold the MFB button for 5 seconds (in standby state)
Play/pause	Click L/R
Volume +/-	Press and hold for L/R
Previous/Next	Double-click L/R
Answer/hang up a call	Click L/R
Reject a call	Press and hold for 2s
Turn on voice assistant	Triple-click L/R

LED INDICATORS

Power on	White indicator stays on for 1 second and then turns off
Power off	White indicator stays on for 2 second and then turns off
Pairing	Main earphone white indicator is pulsating sub-earphone flashes a white light every 3s
Connected	Light off

PAIRING

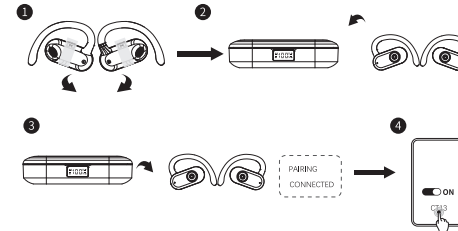

1. For first-time use, remove the insulation stickers on the earbuds.
 2. Return earbuds to the charging case and close the charging case.
 3. Open the charging case or hold the Multi-function button for 2 seconds to turn them on.
 4. Once paired automatically, The main earphone white indicator is pulsating, The sub-earphone flashes a white light every 3s. A voice prompt will say "Pairing".
 5. Select " CT13"on your phone to connect from the Bluetooth list, Once connected, the indicators will be off. A voice prompt will say "connected".
- Note:** Earbuds will turn off automatically after 5 minutes if they have not been paired with any device.

RESET

- 1. Delete "CT13" in the Bluetooth list and turn off the Bluetooth function of your phone.
 - 2. When the charging case has power, place the earbuds in the charging case with the lid open, then long press the charging case button for 5S to reset the earbuds. At the same time, charging case indicator light will flash three times, indicating the reset is successful.
 - 3. If it fails, repeat the above steps.
- Tips :** When both left and right earphones cannot be connected and paired, double-click them simultaneously to pair the two earphones and successfully connect them.

WEARING

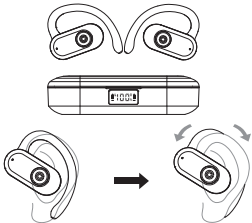

- 1. Pick up the earbuds
- 2. Rotate the earhooks along the auricle of your ear to achieve proper positioning.
- 3. **Dust, earwax or other debris will accumulate in the earplugs. In order to maintain the best sound quality, please gently clean the earplugs with a cotton swab regularly.**

CHARGING

- 1. Fully dry off the earbuds and the USB-C charging port before charging.
- 2. Connect the charging case to a power supply by using the provided USB-C charging cable.

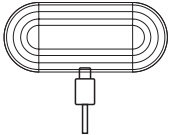

Specifications

Model	CT13
Profile	HFP/HSP/AVRCP/A2DP
Range	Up to 10 meters / 33 feet
Frequency Range	20-20KHz
Earbuds charging time	2 hours
Charging case charging time	2 hours

FCC ID:2BM97-Q17

FCC Warning:

This device complies with Part 15 of the FCC Rules.Operation is subject to the following two conditions: (1) this device may not cause harmful interference, and (2) this device mustaccept any interference received, including interference that maycause undesired operation

NOTE: This equipment has been tested and found to comply with the limits for a Class B digital device, pursuant to Part 15 of the FCC Rules. These limits are designed to provide reasonable protection against harmful interference in a residential installation. This equipment generates, uses and can radiate radio frequency energy and, if not installed and used in accordance with the instructions, may cause harmful interference to radio communications. However, there is no guarantee that interference will not occur in a particular installation.

If this equipment does cause harmful interference to radio or television reception, which can be determined by turning the equipment off and on, the user is encouraged to try to correct the interference by one or more of the following measures:
-- Reorient or relocate the receiving antenna.

- Increase the separation between the equipment and receiver.
- Connect the equipment into an outlet on a circuit different from that to which the receiver is connected.
- Consult the dealer or an experienced radio/TV technician for help.

Warning: changes or modifications not expressly approved by the party responsible for compliance could void the user's authority to operate the equipment

The devices has been evaluated to meet general RF exposure requirement , the device can be used in portable exposure condition without restriction