

User Operation Guide

Please read this guide carefully
before operating the Dog Training collar

⚠ Please make sure the collar is not too tight, two fingers must fit between the collar belt and your dog's neck.
The collar should not be worn longer than 12 hours per day.

⚠ WARNING

Not for use with aggressive dogs. Do not use this product if your dog is prone to aggressive behavior. Aggressive dog can cause severe injury to their owner and others, if you are unsure whether this product is appropriate for you dog please consult your veterinarian or certified trainer.

⚠ CAUTION

- 1、 Avoid leaving the collar on your dog for more than 12 hours a day, which may cause skin irritation.
- 2、 If possible. REPOSITION the collar back on your pet's neck every 1 to 2 hours to prevent skin damage.
- 3、 When using shock mode, start with LOW LEVEL OF SHOCK and observe the dog's reaction. If your pet becomes uncomfortable, STOP using the collar immediately.
- 4、 The collar is waterproof, the remote control transmitter is NOT waterproof.
- 5、 Make sure the collar is NOT TOO TIGHT, one finger must be placed between the collar belt and your dog's neck.
- 6、 Check your dog's neck area DAILY to make sure there is no rash and redness.
- 7、 Do not forcefully plug or unplug the Type-C port while charging.
- 8、 If the transmitting and receiving collars do not work for a long time, they should be fully charged before idle, and charged every other month.

* These cautions will ensure safety and comfort of your pet. Millions of dogs are comfortable wearing stainless steel contacts. Some dogs are sensitive to contact pressure. After a while, you may find that your dog is very tolerant of collars. If so, you can relax some of these precautions. It is important to continue to check the contact area daily. If you notice redness or ulcers, discontinue use until the skin has completely healed.

Overview

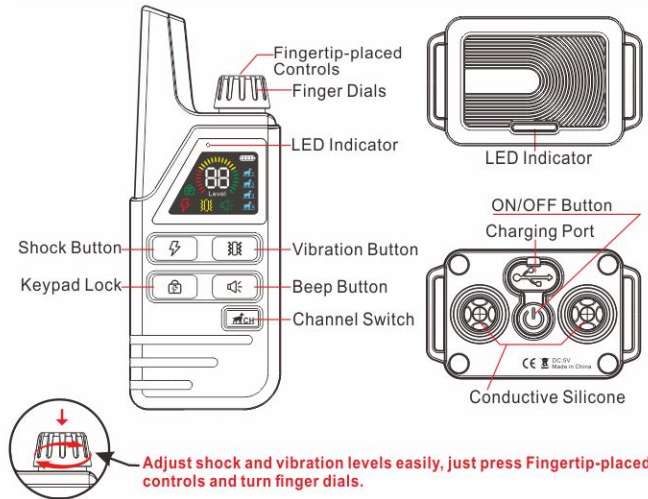

Turn ON/OFF the RECEIVER

Turn on: One Click ON/OFF button to turn on the collar receiver;
Turn off: Double-click ON/OFF button to turn off the collar receiver.

Pairing

1. Make sure the receiver is turned on.
2. Press and hold the receiver's ON/OFF button for 3 seconds until you hear the 1st "beep" from the receiver and the LED light will flash for 10 seconds.
3. Press the remote control "vibrate/beep" button to pair the receiver.
4. You will hear 2nd "beep" from the collar receiver, that means pairing is successfully.

*If you need to pair a 2nd or 3rd collar receiver (you should buy additional receiver collars) follow the same steps but press the channel button to switch to a different channel.

How To Use The Test Light

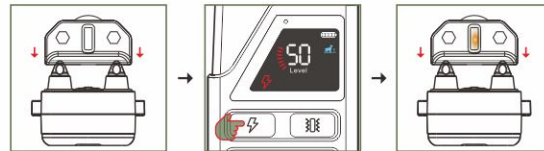

Shock command(1-99 level)

1. Found the test light and place it on the Control Points of the Collar Receiver.
2. Set the intensity of 1-99: press Fingertip-placed controls and turn finger dials to adjust stimulation levels. Press the SHOCK BUTTON on Remote.
3. The test light should flash orange to indicate that the electronic pulse stimulation is functioning properly.

Only when both Contact Points are simultaneously touched, the shock function will work. When the electrostatic shock mode work, the receiver LED indicator will blink RED light. Recommended electrostatic level starts from 1.

Vibration command(1-15 level)

1. Set the intensity to 1-15: press Fingertip-placed controls and turn finger dials to adjust stimulation levels. Press VIBRATION BUTTON on the remote control.
2. If done correctly, the collar receiver will vibrate and the receiver LED indicator will flash green.

Beep command

Briefly press the BEEP BUTTON on the remote, a non-adjustable beep will sound to the collar and the receiver LED will flash green.

we recommend that you give your dog vibration stimulation first, followed by static shock stimulation. After training with this method for a while, the dog will realize that the vibrations followed by a static shock. Vibration will serve as a warning, while static shock is only a threat that may sometimes be needed.

The LED Indication

Low Battery Warning

Remote Control: When the battery icon upper right corner of the LCD screen has only 1 bar that means you need to charge the remote control.

Receiver Collar: When the battery is low, the LED will flash red. This means you need to charge the collar receiver.

Charging

1. Plug in and fully charge the remote and receiver.
2. For the initial charge, be sure to charge it for 4 hours, subsequent charges only takes 2.5 hours.

Night search mode: When the receiver is charging at night, the indicator light will flash when you press the beep/vibration/shock button on the remote so you know where the receiver is.

When the REMOTE control is charging: the LED indicator is solid white and turn off when fully charged, and the BATTERY ICON on the screen FLASHES from 1-4 bars and STOP at 4 bar when fully charged.

Standby time is about 90 days, and working time is about 45 days.



When the RECEIVER collar is charging, the LED light turns RED, and when it is fully charged, the LED light turns GREEN. Standby time is about 30 days, and working time is about 15 days.

Sleep Mode



Remote Control: The remote control LCD screen will turn off without operation within 30seconds. When transmitting a command remotely, press any key to wake up directly.

Receiver Collar: The receiver collar flashes to sleep mode when standby for 3 minutes.

Shock Mode Keypad Lock

When the shock mode is locked, a lock icon (🔒) will show up on the remote screen. Pressing the shock mode will not deliver the shock. Pressing the shock mode keypad lock again will unlock the shock mode, there are no lock icon on the remote screen. Press the shock mode will deliver the shock.

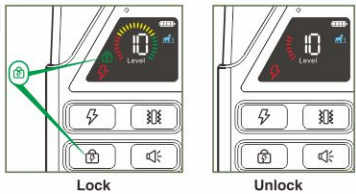

Channel

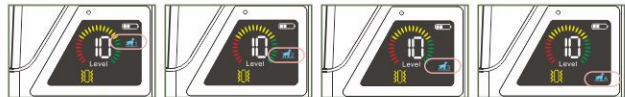

Channel Button: Here are 4 channel modes can be switched, channel 1 (🐕1) channel 2 (🐕2), channel 3 (🐕3) and channel 4 (🐕1 + 🐕2 + 🐕3).

Channel 1: Only show icon (🐕1) on the remote screen. If you pair the remote and receiver on channel 1, the function will only work on channel 1.

Channel 2: Only show icon (🐕2) on the remote screen. If you pair the remote and receiver on channel 2, the function will only work on channel 2.

Channel 3: Only show icon (🐕3) on the remote screen. If you pair the remote and receiver on channel 3, the function will only work on channel 3.

Channel 4: Showing the (🐕1) and (🐕2) and (🐕3) on the remote screen at the same time.

After pairing 3 receivers with the remote control on channel 1, channel 2 and channel 3. In this mode, it can deliver the same order to 3 receivers at the same time

The remote control will only work under the channel matched with the receiver. Please make sure that the remote control is on the channel that matches the receiver before transmitting.

1. If you find that the receiver is not responding to the remote, make sure you have the correct channel selected. Try switching channels to check.

2. If the receiver fails to respond to the remote on both channels, try pairing again. (For pairing method, find page 3 of the manual)

Collar Fitting

1. Make sure that the collar is powered off.
2. Have your dog stand on a flat, flat surface in a balanced position.
3. Place the strap around the dog's neck, centering the collar under the dog's neck
4. Tighten the strap so that it fits snugly around the dog's neck and does not rotate around the neck. If a finger can be inserted underneath, the tightness is at best suitable.
5. When you are satisfied with the fit of the collar, you may need to adjust the excess strap length. Once the collar is removed, you can thread the end of the strap through the buckle, or cut off the excess strap length and seal the end of the strap with a lighter or candle flame.

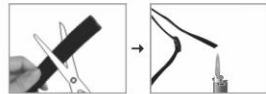

To help reduce the chance of irritation, remove the collar when not in use. Check the fit and comfort of the collar daily. This product is not intended for human use. Do not try to use it on anyone.

IP67 Waterproof



Please make sure the collar receiver charging port is sealed before the dog enters water.

Troubleshooting Guide

1. My dog is not reaching the collar.

Make sure the receiver /collar is turned on and check the intensity levels of vibration and static shock. Be sure the strap is on the dog tight enough so that both contact points are touching the dog's skin. The contact points may be too short for your dog's thick or long coat. If you are already using longer contact points, you may need to trim the hair on the dog's neck so that the contact points touch the dog's skin. The intensity level may be too low for dog. Increase the Simulation until the dog responds, usually by neck movement, head shaking, or looking over the shoulders. The response may be very subtle. If you have tested all of the above and the dog is still unresponsive, try re-pairing the remote transmitter and collar receiver.

2. I want to test Collar Receiver myself, but it does not work.

When testing the collar by hand, touch both the two electrodes simultaneously as touching one electrode will not work.

3. LED indicator light comes on, but I do not feel any Simulation.

Your tolerance may be higher than your dog's. You may need to try the device and increase the stimulation level in a higher sensitivity area. Make sure both points of contact are touching both of your fingertips. The battery may be low, check the LED indicator light on the transmitter and receiver/collar for battery life.

4. Transmitter has no range, or the Simulation is weaker when my dog is farther away.

Check to see if your fingers are touching the antenna, as the range may be drastically reduced. The range indicated on the unit box is for flat terrain (line of sight). Thick bushes, trees, hills, buildings and moisture can affect the range of the device. For best range, place the transmitter vertically overhead, or try moving to a higher ground.

Training Tips

1. Keep training sessions short and active (between 10-15 minutes per session). This will allow the dog to focus on the trainer.
2. Train one dog at a time.
3. During the first initial training, place the dog in a familiar outdoor environment. Training a new position can cause the dog to wander, causing you to overuse the collar receiver to reinforce commands.
4. Use a long leash attached to a non-metallic collar to help the dog learn. Make sure the extra collar and straps don't interfere with the contact points on the collar receiver. Do not use a remote training collar without a long leash until your dog is fully trained.
5. It will be more successful to teach the dog a command before attempting to reinforce the command with a remote transmitter.
6. For basic obedience training, vibration is more useful.
7. Give one obedience commands at a time, this will reduce confusion and keep the dog focused.
8. During training, look for all the positive changes in the dog's behavior and remember to reinforce them promptly with ample praise and reward.
9. Avoid over-correcting your dog. Use as little remote correction as possible during training.
10. When the dog is visibly confused, shift the focus of the training to draw the dog's attention to commands they are familiar with. Example: Tell the dog to sit and give ample praise and encouragement when it successfully completes the sit command.
11. Do not use dog training devices to correct or eliminate aggressive or biting behavior. When a dog shows signs of aggressive behavior, contact your local professional dog trainer immediately.
12. Please remember that you should shorten training sessions and end each session on a high note. Once the dog reaches a new level of proficiency, stop training and play with the dog.

FCC Warning

This device complies with Part 15 of the FCC Rules. Operation is subject to the following two conditions:

- (1) This device may not cause harmful interference, and (2) this device must accept any interference received, including interference that may cause undesired operation.

NOTE 1: This equipment has been tested and found to comply with the limits for a Class B digital device, pursuant to part 15 of the FCC Rules. These limits are designed to provide reasonable protection against harmful interference in a residential installation. This equipment generates, uses and can radiate radio frequency energy and, if not installed and used in accordance with the instructions, may cause harmful interference to radio communications. However, there is no guarantee that interference will not occur in a particular installation. If this equipment does cause harmful interference to radio or television reception, which can be determined by turning the equipment off and on, the user is encouraged to try to correct the interference by one or more of the following measures:

- Reorient or relocate the receiving antenna.
- Increase the separation between the equipment and receiver.
- Connect the equipment into an outlet on a circuit different from that to which the receiver is connected.
- Consult the dealer or an experienced radio/TV technician for help.

NOTE 2: Any changes or modifications to this unit not expressly approved by the party responsible for compliance could void the user's authority to operate the equipment.

The device has been evaluated to meet general RF exposure requirement. The device can be used in portable exposure condition without restriction.

Frequency: 915MHz
Transmitter: 3.7V 300ma LIP
Receiver: 3.7V 300ma LIP

