

10.26-inch carplay (carplay dash camera)

User manual



Note: Manual contents are subject to change without notice in accordance with our policy of continuous product improvement.

Warning: Changes or modifications to this unit not expressly approved by the party responsible for compliance could void the user's authority to operate the equipment.

NOTE: This device complies with part 15 of the FCC Rules. Operation is subject to the following two conditions:

- (1) This device may not cause harmful interference, and
- (2) this device must accept any interference received, including interference that may cause undesired operation.

FCC Statement: This equipment has been tested and found to comply with the limits for a Class B digital device, pursuant to part 15 of the FCC Rules. These limits are designed to provide reasonable protection against harmful interference in a residential installation. This equipment generates, uses and can radiate radio frequency energy and, if not installed and used in accordance with the instructions, may cause harmful interference to radio communications. However, there is no guarantee that interference will not occur in a particular installation. If this equipment does cause harmful interference to radio or television reception, which can be determined by turning the equipment off and on, the user is encouraged to try to correct the interference by one or more of the following measures:

- Reorient or relocate the receiving antenna.
- Increase the separation between the equipment and receiver.
- Connect the equipment into an outlet on a circuit different from that to which the receiver is connected.
- Consult the dealer or an experienced radio/TV technician for help.

This equipment should be installed and operated with minimum distance 20cm between the radiator and your body.

RF exposure compliance statement: This device has been evaluated to meet the general RF exposure requirement.

Warranty Service

Thank you for purchasing products from us.

If you have any questions in using our products, please feel free to contact us . A reply email with solution will reach you within 24 hours.





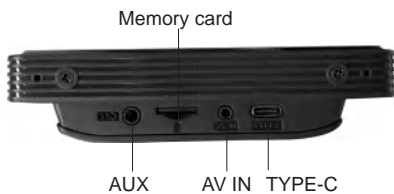

EMAIL: support@accfly.com

1.Product Overview - - - - -	P1
2.SD card specifications (optional) - - - - -	P3
3. Wiring and installation instructions - - - - -	P3
4.Interface Description - - - - -	P5
5.Status bar icon description - - - - -	P5
A.CarPlay - - - - -	P6
B.Android Auto - - - - -	P7
C.AirPlay - - - - -	P9
D.Miracast - - - - -	P9
E.BT Music - - - - -	P10
F.WiFi video - - - - -	P10
6.DVR - - - - -	P12
7.Playback - - - - -	P13
8.Settings - - - - -	P14
9.Common problems - - - - -	P16

1.Product Overview





Name	Graphic	Instructions	Number
The host		10.26 inch high-definition display (1600 * 600) / Touch control / Bluetooth / WIFI / Audio / SD card recording	1
The power cable		12V-24V / 3A Cigarette lighter car charging power supply	1
Camera		AHD High Definition (1080N)	1
AUX cord		Supports wired connection of car audio system	1
Suction cup bracket		Supports installation on the windshield	1
SD card (Optional)		Class10, minimum support 32GB, maximum support 256GB	1

2.SD card specifications (optional)

The quality of SD card has a great influence on the stability of video recording. In order to record video safely, please choose a big brand SD card, such as SanDisk, Kingston, Toshiba, Samsung, etc. The SD card should be at least Class10 level or above. The minimum capacity supports 32GB and the maximum capacity supports 256GB



3. Wiring and installation instructions



- ① Fix carplay on windshield Or on the car center console.
- ② Prepare all kinds of vehicle charging cable, as shown in photo, and put the car charger into cigarette lighter;
- ③ Arrange rear-view camera cable and plug rear-view camera AV connector into car driving recorder AV-in port,connect the Red cable of the camera to car reversing light power positive (Optional) ,then fix the rear-view camera.

- 4 Start car to check if drive recorder turn on automatically and begins recording, if it does, the installation is correct, or else, check car charger and AV connector installation problem.



Red line: Connected to the positive pole of the reverse lamp



Rear camera line installation

We do not provide installation,
please find a professional to install

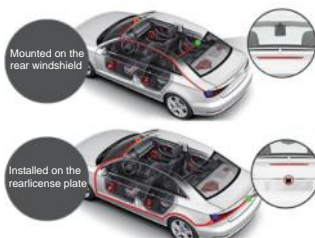





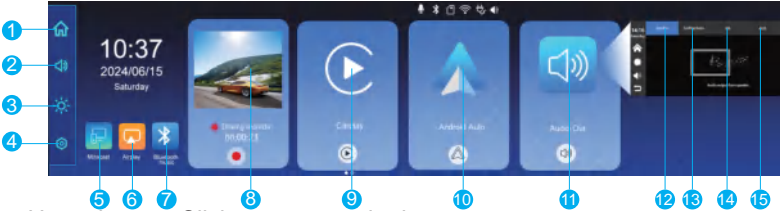

※ Red trigger line connected to backup light power +

4.Interface Description



- 1.Home button: Click to return to the home page
- 2.Volume adjustment: Adjust the size of the sound
- 3.Brightness key: Click to adjust screen brightness
- 4.Settings: Click to enter the function settings interface
- 5.Miracast
- 6.Airplay
- 7.BT Music
- 8.Record button: Click to enter the dash camra recording interface
- 9.Carplay
- 10.Android Auto
- 11.Audio Out
- 12.Speaker
- 13.CarPlay/Auto
- 14.FM
- 15.AUX

5.Status bar icon description:

	Sound Recording icon
	Indicates being in CarPlay projection mode
	Indicates that Bluetooth is connected
	Indicates that the SD card has been inserted
	WIFI
	volume display

A.CarPlay

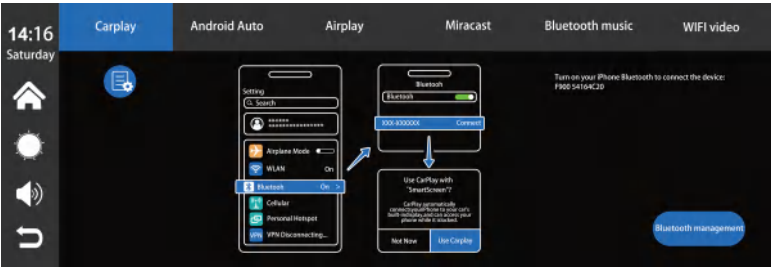

As shown in the above figure, click the 'CarPlay' button, then select the 'CarPlay' option, and first turn on the phone's WiFi and Bluetooth, as shown in the above figure. Bluetooth will turn on automatically, named F900-XXXX. Once Bluetooth is connected successfully, you can connect to CarPlay. (When the machine is powered on, it will attempt to connect to the last connected phone automatically)

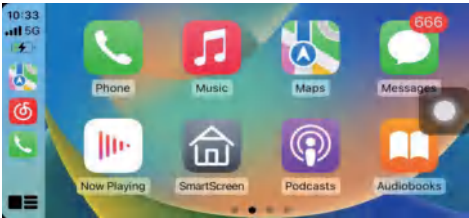

Click Assistive Touch to display the shortcut menu: [Back to Home], [Record Video Screen], [Volume Adjustment], [Brightness Adjustment].

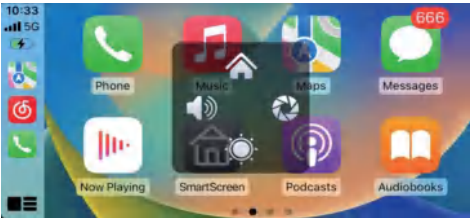

When Assistive Touch is turned off, you can tap the [SmartScreen] button

(CarPlay option is only supported for Apple mobile phones. Please turn off the Bluetooth button and then the WiFi button in your phone's settings to disconnect.)

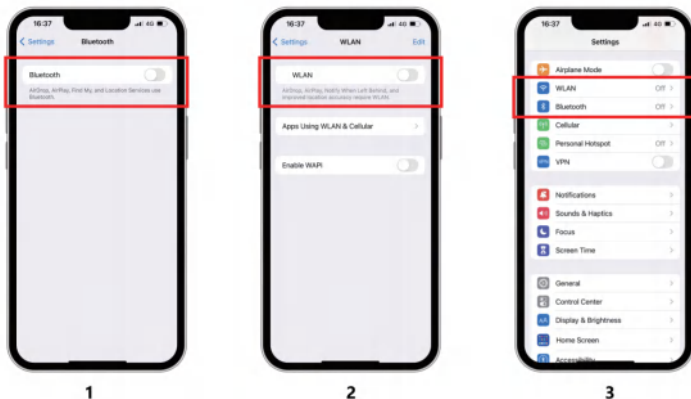

B.Android Auto

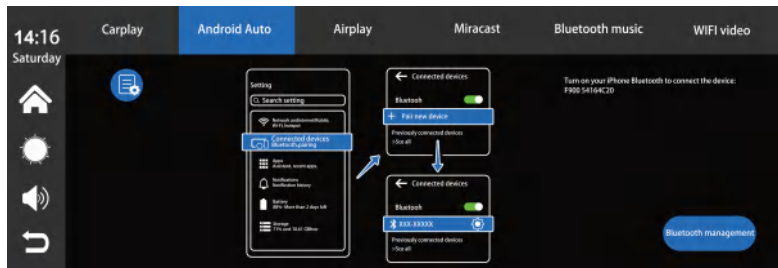

As shown in the picture, click the [Auto] button, and then select the [Auto] option, first turn on the phone's Wi-Fi and Bluetooth, as shown in the picture above. Bluetooth will be turned on automatically and the name will be F900-XXXX. Once the Bluetooth is successfully connected, you can connect to Auto. (When the machine is powered on, it will try to connect to the last connected phone automatically)

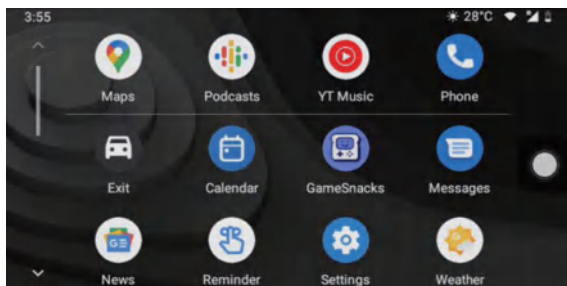

Click Assistive Touch to display the shortcut menu: [Back to Home], [Record Video Screen], [Volume Adjustment], [Brightness Adjustment].

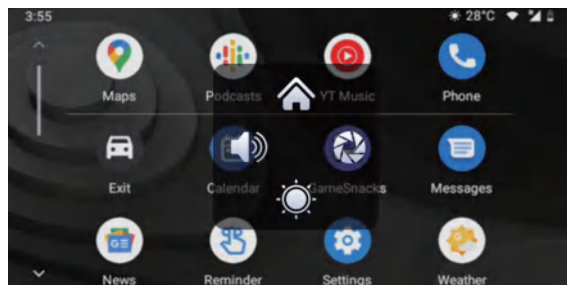

When Assistive Touch is turned off, you can tap the [Exit] button to return to the home page.

(Wireless Auto option is only supported for Android phones. Please forget Bluetooth in your phone's settings and turn off the WiFi button to disconnect).

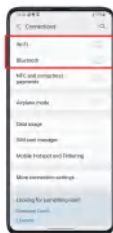

C.AirPlay

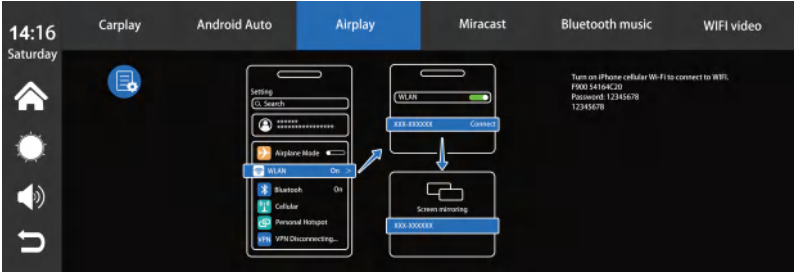

As shown in the above figure, click the 'CarPlay' button, then select the 'AirPlay' option, and first turn on the phone's WiFi and Bluetooth, as shown in the above figure. WIFI will turn on automatically, named F900-XXXX. Once WIFI is successfully connected, you can connect to AirPlay.

(AirPlay option is only supported for Apple mobile phones.)

D.Miracast

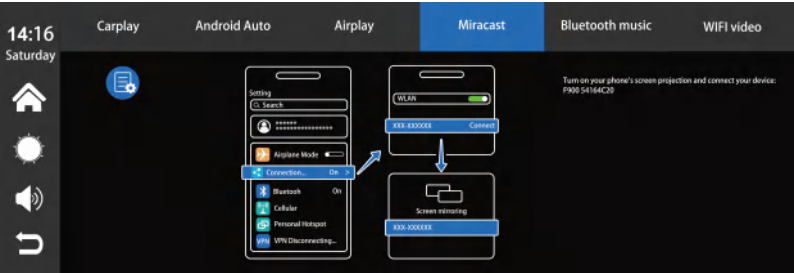

E.BT Music

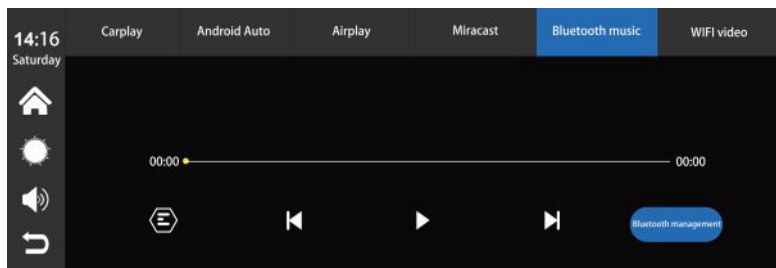

F.WiFi video

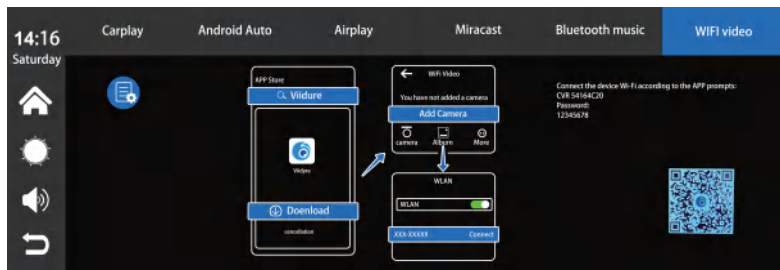

As shown in the above figure, first scan the QR code to download the corresponding app.

After downloading, open the app and follow the prompts to connect to the machine's WiFi. WiFi name: CVR-XXXXXX, password as shown on the machine.

After connecting, the machine will enter the recording interface and cannot perform any operations. You can watch or download recorded videos, set machine parameters, and more on your phone.

WWiFi Video Connection Help

1.Scan the GRt code to download the
caresponding cpp

2.Falewy the app prompts to cannect to your
locel WFi

WFiname.CVR 54164C20

Password12545678



Click the Details button for detailed connection steps and connection FAQs.







(Turn off the WiFi key on your phone to disconnect, and it will take one minute to disconnect before you can operate on the machine.)

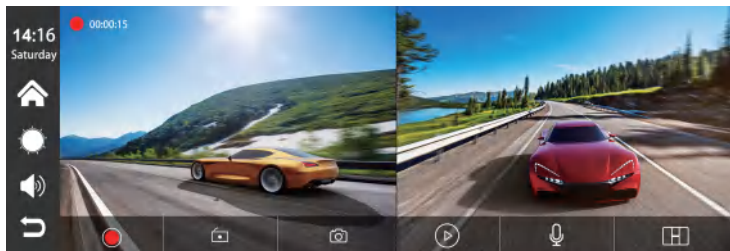

6.DVR

As shown in the picture, the main page will not display the camera image, you need to click the Dvr button  to view the camera image. After inserting the memory card, the system enters the recording mode automatically.



	Tap to start recording the video and tap again to close the recorded video.
	Lock the recorded video and the data will not loop over the recording.
	Click to take a photo with one click.
	Enter the video playback interface
	Turning on and off the sound recording function
	Click to switch camera screen display

Lock the current video:

If too many videos are locked, the first locked video will be overwritten.

The number of videos that can be locked depends on the capacity of the SD memory card. 32G SD memory card can lock 40 videos, when locking the 41st video, the 41st video will overwrite the first one and the 42nd video will overwrite the second one.

64G SD memory card can store 80 locked videos, 128G SD memory card can store 160 locked videos, 256G SD memory card can store 320 locked videos. The SD card supports a minimum of 32GB and a maximum of 256GB!

H.Supports dual Bluetooth connection



After connecting [CarPlay] or [Auto] for screen casting, you can use your phone's Bluetooth to connect to the Bluetooth headset. After the connection is successful, all sounds from the device will be transmitted to the Bluetooth headset for playback.

7.Playback

As shown in the above figure, click the [Playback] button to enter the Playback interface.

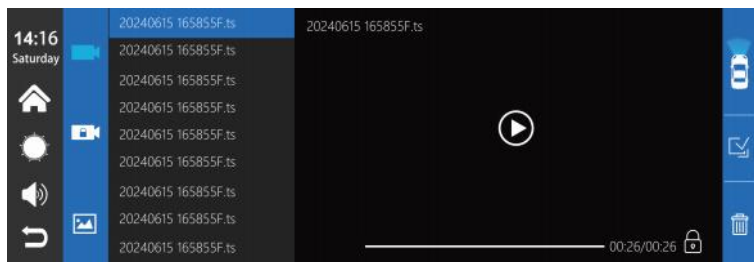

You can select [Video], [Photo], [Locked Video] folder, after selecting, you can click the select button on the right side of the file to delete, lock or unlock the video.

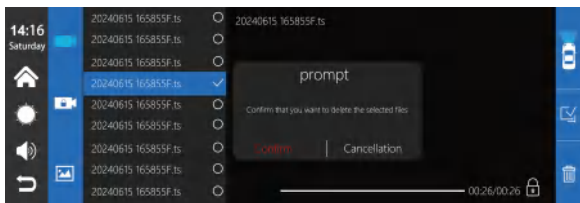







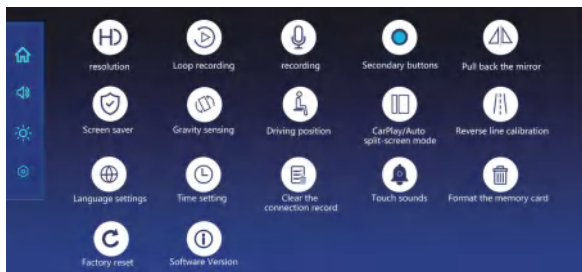









Click the [] icon, you can switch the video recording playback of front camera and rear camera.

8.Settings

Set options to set various functions of the

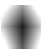

	Video resolution settings: 1080P, 2K, 4K
	Loop recording time settings of 1 minute, 3 minutes, and 5 minutes
	Turning on and off the recording function
	[Assistive touch] It's a hover window button in your phone's screen casting mode, you can choose to turn it off or on.
	Screen saver function turned off or on
	Adjustment of gravitational inductance sensitivity to turn off, low, medium, high
	Driving position switching
	Carplay/Auto split screen mode selection

	Rear camera reverse line calibration
	Click on [Language] to enter settings: Language can be set: Simplified Chinese / Traditional Chinese / English / Russian / Spanish / French / German / Japanese / Korean / Italian / Portuguese
	Click on [Date and Time] to enter settings: separate settings: Year / month / day / hour / minute / second / time format
	If the customer has changed mobile phones, click to clear the connection records of all previous mobile phones.
	Touch screen sound effects on or off
	Click [Format] button will delete all data information from the SD memory card. It is recommended to manually format the SD card when inserting it for the first time to ensure sufficient card capacity. Note: It is recommended that users manually format the SD card regularly.
	Click [Factory reset] to enter the settings: Restore factory settings, the system will restore all settings to their original state
	Click on [Firmware version] to enter the menu: This option allows you to see the current software version number

9.Common problems

Number	Problem	Solution
1	Unable to start	<ol style="list-style-type: none"> 1. Check whether the power cord is damaged or aged 2. Check whether the fuse of the power cord is disconnected or burnt out
2	No touch phenomenon	<ol style="list-style-type: none"> 1. Touch is invalid during power-on, wait for normal power-on before operation. 2. Check whether the touch is damaged, do not touch the screen with sharp objects, it is easy to scratch and damage.
3	No image from camera	<ol style="list-style-type: none"> 1. Use only after using the manufacturer's matching camera. 2. The camera connector is not loose.
4	High temperature lag phenomenon of the mach	<ol style="list-style-type: none"> 1. The normal operating temperature of the MTO2 is -4 to 149 F. If the temperature exceeds the limit, disconnect the power supply and the temperature of the MTO2 will be lower than 149 F before switching on the power.
5	Carplay cannot connect	<ol style="list-style-type: none"> 1. The first connection takes a little longer. 2. Only iPhone supports Carplay. 3. Check that the WiFi and Bluetooth functions of the mobile phone are normal. 4. Enter Settings - General - Carplay vehicle, delete all records and reconnect. 5. Restart the iPhone and reconnect it. 6. Turn on the Siri function on your phone.
6	Auto cannot connect	<ol style="list-style-type: none"> 1. Only Android phones are supported. 2. Update Auto and related applications on mobile phones to the latest version. 3. Do not enable VPN on the mobile phone. 4. Check that the WiFi and Bluetooth functions of the mobile phone are normal. 5. Restart the Android phone and connect it again.
7	WiFi Video cannot connect	<ol style="list-style-type: none"> 1. Try to upgrade the version of the application. 2. Check if the SD card of the machine exists. 3. Check if the machine's mode has been switched to WiFi video mode.