

使用说明书 INSTRUCTION MANUAL

产品简图

① 换纸键

- 同时按下开盖换纸

② USB数据线

- 可连接充电宝或手机充电器充电

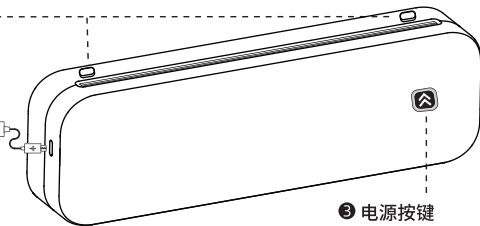

③ 电源按键

- 长按2秒开/关机
- 短按2次打印连接设备的二维码
- 单击可终止打印

电源指示灯状态介绍

- 绿灯亮：正常打印状态/充满电。
- 红灯亮：开盖/缺纸/过热/充电中。
- 绿灯闪：吸纸模式，请装好折叠纸。
- 红灯闪：低电量，请及时充电。

苹果手机App打印

- 第一步:长按电源按键2秒,将打印机开机;
- 第二步:在手机应用商店搜索下载【快印-智能打印】App;
- 第三步:打开App,在App里根据提示搜索连接打印机,或短按2次电源按键打印二维码,用App扫码连接打印机;
(注:请勿在手机蓝牙设置里搜索连接打印机蓝牙)
- 第四步:在App中选择编辑需要打印的内容,确认并打印。

App下载: 扫描以下二维码



苹果版



安卓版

电脑打印

- 第一步:长按电源按键2秒,将打印机开机;
- 第二步:用原装USB数据线连接打印机和电脑;
- 第三步:访问官网 <http://www.xmdepert.com> 下载安装打印驱动;
- 第四步:打印所需文档时,选择该打印机打印即可。

卷纸安装指南

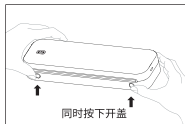

① 开盖

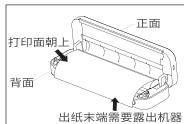

② 放纸

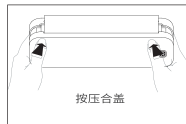

③ 合盖

折叠纸安装指南 (请确保打印机内无卷纸)

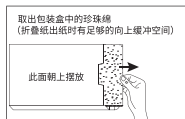

① 拆封

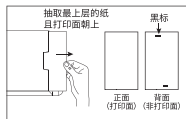

② 取纸



③ 装纸



④ 撕纸

卡位器安装/拆卸



①

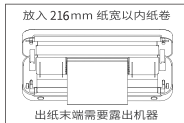

②



③

充电说明

- 5V \Rightarrow 2A输入充电，建议使用手机充电器进行充电；
- 建议购买后第一次使用时请先充满电；
- 长时间无使用请间隔3个月充一次电，以免锂电池长时间自然损耗无法充电。

温馨提示:工作环境:5°C~40°C环境温度,相对湿度45%~90%RH (非冷凝)环境下使用。

⚠ 警告: 本产品不带电源适配器销售,销售者若使用电源适配器供电,则应购买配套使用获得CCC认证且满足标准要求的电源适配器,适配器的输出规格应符合:5V \Rightarrow 2A。
• 此为A级产品,在生活环境中,该产品可能会造成无线电干扰。在这种情况下,可能需要用户对干扰采取切实可行的措施。

清洗打印头



- ① 请关机后打开打印机纸仓盖取出纸卷；
- ② 将棉布或者棉棒沾上医用酒精，沿着打印头中央到四周的方向轻轻擦拭；
- ③ 清洁打印头后，不要立即使用打印机，请等候1~2分钟，待酒精完全挥发后方可使用。

“三包”服务政策(中国大陆地区)

出现非人为损坏的外观问题或性能故障,享有国家规定的三包服务。消费者自签收之日起:

- 7日内,可退货、更换或维修;
- 15日内,可更换或维修;
- 1年内,可免费维修。

不符“三包”服务范围

- 因不可抗力造成的损坏;
- 未经授权的维修/拆装等;
- 长期(约3个月)未充电可能导致电池自然耗尽,无法激活充电的。

QC
PASS

电子信息产品有毒有害物质申明

有毒有害物质或元素	塑胶外壳	线路板	内部线缆	电池
铅 (Pb)	○	×	○	○
汞 (Gg)	○	○	○	○
镉 (Cd)	○	○	○	○
六价铬 (Cr6+)	○	○	○	○
多溴联苯 (PBB)	○	○	○	○
多溴二苯醚 (PBDE)	○	○	○	○

本表格依据SJ/T 11364的规定编制

○: 表示该有害物质在该部件所有均质材料中的含量在GB/T26572-2011规定的限量要求以下。

×: 表示该有毒物质至少在某一均质材料中的含量超出GB/T26572-2011规定的限量要求。

Product Sketch

① Paper change button

- Press the buttons at the same time to open cover and exchange paper.

② USB data cable

- Charged with power bank or mobile phone charger.

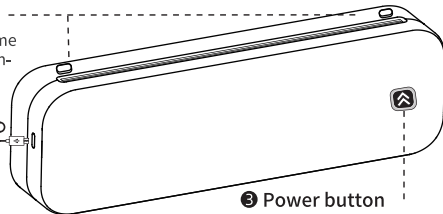

③ Power button

- Press and hold 2 seconds to turn on/off.
- Double click to print device connection QR code.
- Click to terminate printing.

Power Indicator Status

- Green light on: Normal use status/full charged.
- Red light on: Cover opened/No paper/Over-heat/Charging.
- Green light flashing: Paper suction mode, please install the folded paper.
- Red light flashing: Low battery, please charge in time.

iPhone Mobile App Printing

- Step 1: Press and hold the power button for 2 seconds to turn on the printer.
- Step 2: Search 【EasyPrint】and download App in the mobile app store.
- Step 3: Open the App, and search for the connected printer according to the prompts in the App.
Or double click the power button to print the QR code, and scan the code with the App to connect to the printer. (Tips: Don't connect printer in the mobile phone Bluetooth settings.)
- Step 4: Select and edit the content to be printed in the App, confirm and print.

App download: Find " EasyPrint " on Google Play Or App Store.



ios



Android

Computer Printing

- Step 1: Press and hold the power button for 2 seconds to turn on the printer.
- Step 2: Connect the printer to computer with the original USB cable.
- Step 3: Visit the official website <http://www.xmdeprt.com> to download and install printer driver.
- Step 4: When printing the required documents, select the printer to print.

Replace Paper

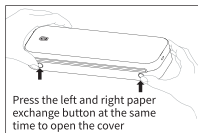

① Open The Cover

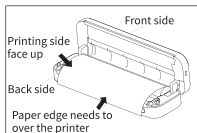

② Put Paper

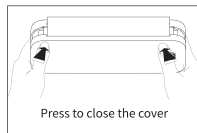

③ Close The Cover

Folding paper installation guide (Make sure there is no roll paper in the printer)

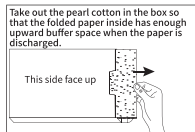

① Unpack

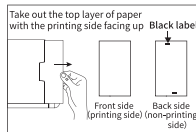

② Take out Paper

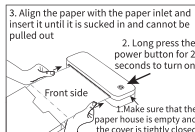

③ Loading Paper



④ Tear Paper

Paper Holder Installation/Removal



①

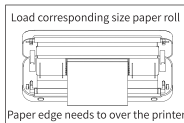

②



③

Charging Instructions

- 5V = 2A input, recommend to use mobile phone charger for charging.
- Recommend to charge the battery fully before using.
- Please charge it every 3 months if you don't use it for a long time, to avoid the long time natural loss of lithium battery and can not be charged.

Tips:

Operating ambient: 5°C-40°C ambient temperature, 45%-90%RH.
(Non condensing state).

Caution!

This is a Class A product. It may cause radio interference in the living environment.
In this case, users may need to take actions against interference.

Clean The Printer Head

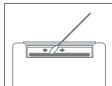

- ① Please turn off the printer and open the printer cover and take out the paper.
- ② Dip a cotton cloth or cotton swab with medical alcohol, and wipe gently along the center to the periphery of the printer head.
- ③ After cleaning the printer head, do not use the printer immediately. Please wait for 1 to 2 minutes, use the printer after the alcohol has completely evaporated.

This device complies with part 15 of the FCC Rules. Operation is subject to the following two conditions: (1) This device may not cause harmful interference, and (2) this device must accept any interference received, including interference that may cause undesired operation.

Any Changes or modifications not expressly approved by the party responsible for compliance could void the user's authority to operate the equipment.

Note: This equipment has been tested and found to comply with the limits for a Class B digital device, pursuant to part 15 of the FCC Rules. These limits are designed to provide reasonable protection against harmful interference in a residential installation. This equipment generates uses and can radiate radio frequency energy and, if not installed and used in accordance with the instructions, may cause harmful interference to radio communications. However, there is no guarantee that interference will not occur in a particular installation. If this equipment does cause harmful interference to radio or television reception, which can be determined by turning the equipment off and on, the user is encouraged to try to correct the interference by one or more of the following measures:

- Reorient or relocate the receiving antenna.
- Increase the separation between the equipment and receiver.
- Connect the equipment into an outlet on a circuit different from that to which the receiver is connected.
- Consult the dealer or an experienced radio/TV technician for help.

FCC Radiation Exposure statement

The device has been evaluatec to meel general RF exposure requirement. The device can be used in portable exposure condition without restriction.