

User Manual

Bluetooth remote control controller

APP Program Usage

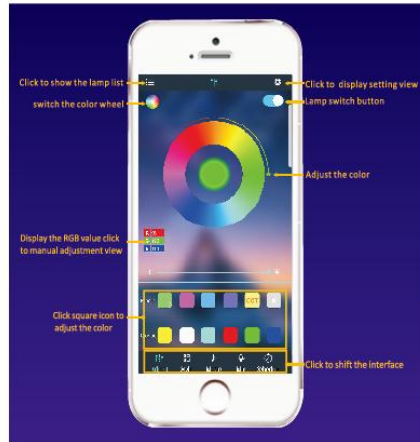

Notes:
detailed operating
instructions, enter
the menu "Guide".

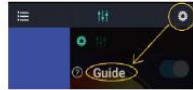

Scan two-dimensional code download APP

① Connect LED color strip and controller, power on controller

② Scan two-dimensional code download APP:



③ Start APP, search and connect controller

④ Enjoy the Bluetooth wireless control experience

V. Cutting & Connectors Application:

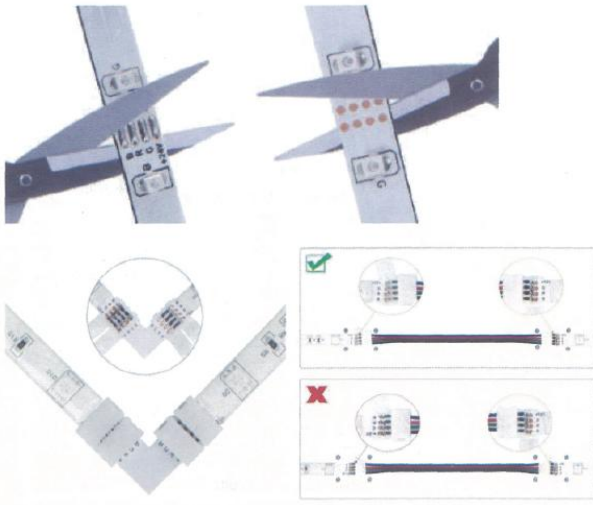

- Avoid tearing back glue quickly during installation and stick it to the installation surface slowly.
- Avoid pressing the lamp bead on the lamp strip vigorously.
- Backing adhesive does not have good adhesion to all materials, so please use the buckle we deserve.
- Avoid the direct contact between light beads, which risks the fault of light beads caused by short-circuit.
- The light strip can be cut according to the required length, but if you want to reuse the extra light strip, you need to buy the connectors

VI. Safety Information

- FOR INDOOR USE ONLY.
- RISK OF ELECTRIC SHOCK.
- DO NOT EXPOSE TO LIQUID, VAPOR OR RAIN.
- Keep away from open flame.
- Avoid overheating the light bar when power is on. Please unlock the light bar in time.
- Avoid rough mounting surface. Make sure the surface is clean and dry before installation.

VII. Warranty Policy

30-day money-back guarantee for any reason

For 30 days after the date of purchase, return your undamaged product and receive a full refund for ANY reason.

12-month warranty for quality-related issues

For 12 months after the date of purchase, we take care of all quality-related issues with a REPLACEMENT OR FULL REFUND.
Reminder: Be sure to use your product as directed.

III. Specifications

LED Type: SMD LED

Color: Multiple Colors Selection
Strip Width: 10mm

Color Rendering Index (CRI): Ra8+

Working Temperature: -20°C to 50°C

Beam angle: 120 degrees

Lifespan: 36,000 Hrs+

Usage: Indoor use only

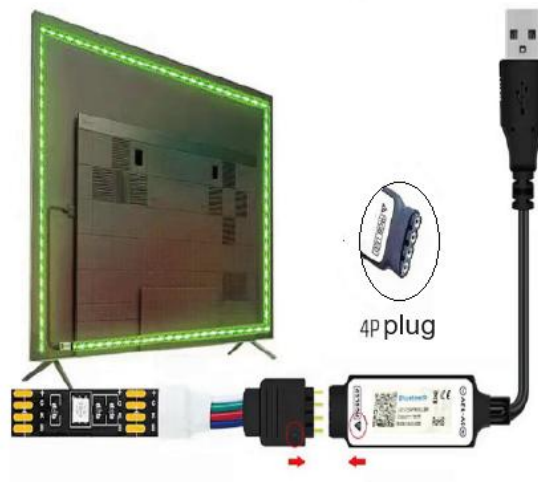

IV. Control Method

1.15 Steady Color

2. Brightness Dimming

3. White Light Brightness Percentage

4. Simulation of sunrise sunset

5. Timing on / Mode

6. MMusic Activation Mode

7. Multiple Color Changing Mode

The connection lamp belt is powered by the connector USB

FCC Statement

This device complies with part 15 of the FCC rules. Operation is subject to the following two conditions: (1) this device may not cause harmful interference, and (2) this device must accept any interference received, including interference that may cause undesired operation.

Caution: Changes or modifications not expressly approved by the party responsible for Compliance could void the user's authority to operate the equipment.

NOTE: This equipment has been tested and found to comply with the limits for a Class B digital device, pursuant to part 15 of the FCC Rules. These limits are designed to provide reasonable protection against harmful interference in a residential installation. This equipment generates uses and can radiate radio frequency energy and, if not installed and used in accordance with the instructions, may cause harmful interference to radio communications. However, there is no guarantee that interference will not occur in a particular installation. If this equipment does cause harmful interference to radio or television reception, which can be determined by turning the equipment off and on, the user is encouraged to try to correct the interference by one or more of the following measures:

- Reorient or relocate the receiving antenna.
- Increase the separation between the equipment and receiver.
- Connect the equipment into an outlet on a circuit different from that to which the receiver is connected.
- Consult the dealer or an experienced radio/TV technician for help important announcement .

Radiation Exposure Statement

To comply with FCC RF exposure compliance requirements, this grant is applicable to only mobile configurations. The antennas used for this transmitter must be installed to provide a separation distance of at least 20 cm from all persons and must not be co-located or operating in conjunction with any other antenna or transmitter.