

instructions for the use of AI chatting peanut box

Model: AiSpea-nut-001

Product Description

The new experience of integrating smart devices into toys, letting everything talk to each other intelligently

Description of keys and functions

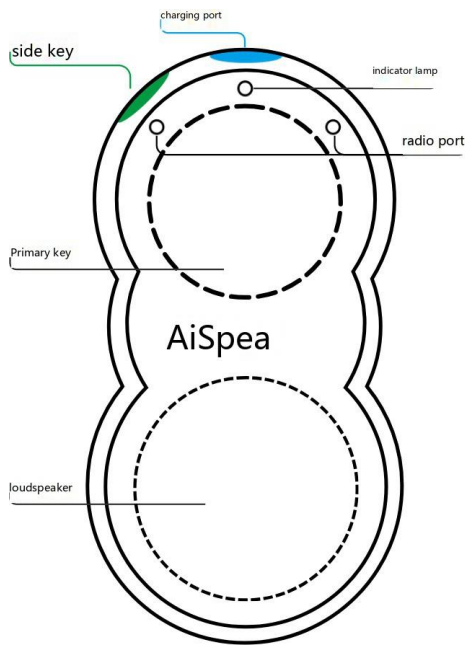

Pushbutton	Operation	Description
------------	-----------	-------------

Home button	Short press	Waking up from hibernation to turn on the computer
	Long press	Press and hold Dialog, release Send
Side keys	Press and hold for 3 seconds	On/Off
	Press and hold for 10 seconds	Forced shutdown
	Short press after powering on the	Adjusting the volume
Home button, side keys	Press at the same time	Entering distribution mode
-	Dormant	Sleeps after 15 minutes of inactivity

Configuring the network

1. Booting

Press and hold the Side Button for 3 seconds to turn on the power for the first time, and the indicator light will be on.

2. Open the applet

Search for "AiSpea lite" applet on WeChat and follow the prompts to match the network.

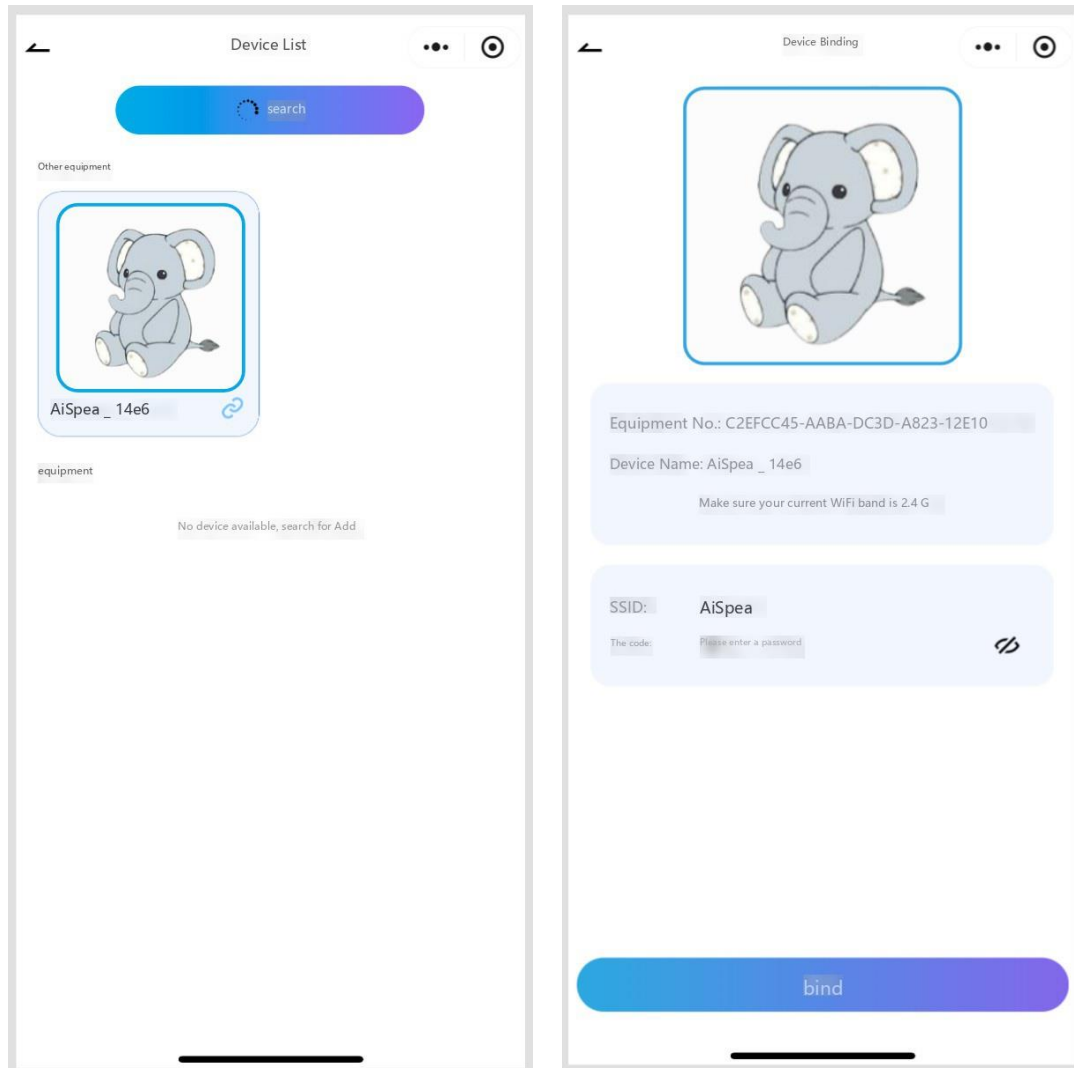

VIDEO:Small Program Matching Network

[Small Program Matching Network Tutorial.mp4]

voice command words

[Turn up the volume] louder sound/turn up the volume/turn up the volume [Turn down the volume] smaller sound/turn down the volume/turn down the volume [Device shutdown] shut down the device

product parameters

Product Name	AiSpea talking to Peanut
Battery	1000mAh polymer lithium battery
Speakers	3W speaker
Overall dimensions	100mm*52mm*26mm
Weight	84g
Shell material	ABS plastic
Charging port	USB-C interface 5V 500mA
Standby time	4 days standby time (30-60mins/continuous use) (days)

safety precautions for use

To ensure that you use this product correctly and safely, please read and observe the following.

1. Strictly according to the product charging standard power charging, avoid using high power plug.
 2. Please suspend use of the toy during charging and place it in a well-ventilated area to ensure heat dissipation. It is not recommended to place the charging toy on a sofa, bed or other padded objects to avoid obstructing the heat dissipation and to ensure the heat dissipation efficiency and safety of the product.
 3. Keep away from water and high temperature to avoid damage to the electronics.
 4. Adjust the volume appropriately to avoid excessive sound affecting children's hearing.
 5. Check the surface of the product for cut edges and tips to protect children's skin.
 6. Make sure children use this product under adult supervision, especially for younger children.
- Parental Responses

Children are instructed in the proper use of toys.

7. Avoid prolonged charging, especially overnight charging, which may result in overcharging the battery.
8. This product may contain data collection features, please read the Privacy Policy carefully to ensure that you understand and agree to how the data will be used and protected.

Contact Us



Cybertronics Public

Mailbox: , support@aispea.com

More news:wiki.aispea.com

Address: 8/F, Building G33, China Mobile Information Port III, Changping District, Beijing,
China

FCC STATEMENT :

This device complies with Part 15 of the FCC Rules. Operation is subject to the following two conditions:

- (1) This device may not cause harmful interference, and
- (2) This device must accept any interference received, including interference that may cause undesired operation.

Warning: Changes or modifications not expressly approved by the party responsible for compliance could void the user's authority to operate the equipment.

NOTE: This equipment has been tested and found to comply with the limits for a Class B digital device, pursuant to Part 15 of the FCC Rules. These limits are designed to provide reasonable protection against harmful interference in a residential installation.

This equipment generates uses and can radiate radio frequency energy and, if not installed and used in accordance with the instructions, may cause harmful interference to radio communications. However, there is no guarantee that interference will not occur in a particular installation. If this equipment does cause harmful interference to radio or television reception, which can be determined by turning the equipment off and on, the user is encouraged to try to correct the interference by one or more of the following measures:

- Reorient or relocate the receiving antenna.

- Increase the separation between the equipment and receiver.

- Connect the equipment into an outlet on a circuit different from that to which the receiver is connected.

- Consult the dealer or an experienced radio/TV technician for help.

RF warning statement:

The device has been evaluated to meet general RF exposure requirement. The device can be used in portable exposure condition without restriction.