



100W RGBCW Smart Super Bright Area Light

User Manual
Notice d'Emploi
Manual De Usuario

*HUB REQUIRED

DOWNLOAD SMART LIFE APP



works with
Hey Google

WORKS WITH
alexa

Add to Siri

*HUB REQUIRED

PACKAGE CONTENT

INCLUDED

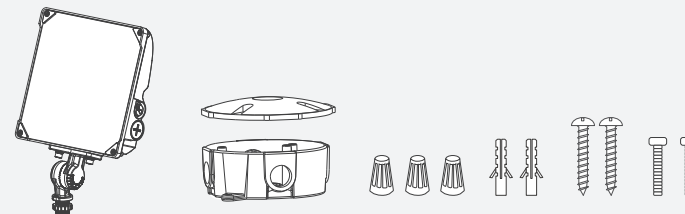

NECESSARY TOOLS (Not included)

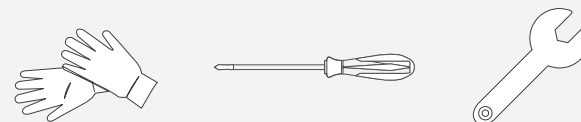

PRODUCT FEATURES



OUTDOOR



HUB REQUIRED
FOR REMOTE CONTROL



BLUETOOTH



EXPOSE TO
SUN LIGHT



HIGH VOLTAGE
AC 100-277V



IP65
WATERPROOF



-4°F-104°F
WORKING TEMP



ELECTRICIAN
REQUIRED

IMPORTANT SAFETY INSTRUCTIONS



Read instructions carefully for safe installation. Instructions may not cover all setup or maintenance scenarios. Dimensions are for reference as per ASME Y14.5-2018, not for production or inspection.

- Electric Shock Prevention: Power off at breaker before installation or maintenance. Avoid contact with live electrical parts.
- Fire Hazard Reduction: Install fixtures away from flammable materials. Ensure proper ventilation to prevent overheating.
- Do NOT install this fixture with the power on and avoid operating it with wet hands.
- This fixture is designed for 100-277V AC power and should not be used with DC power.
- Avoid looking directly into the light while it is turned on.
- This fixture is suitable for outdoor use.
- Follow Electrical Codes: Adhere strictly to the National Electrical Code (NEC) and local regulations for hazard prevention and warranty validity.
- Hire a Certified Electrician: Licensed professional required for safe and compliant installation.
- Coverage: Protects against defects in materials and craftsmanship under normal usage.
- Exclusions: Excludes damages from misuse, accidents, unauthorized alterations, and normal wear.

A

PRODUCT INFORMATION

1 Turn off the main power switch before installation.

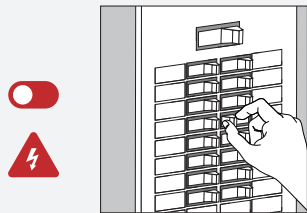

2 Knuckle Screw Specification

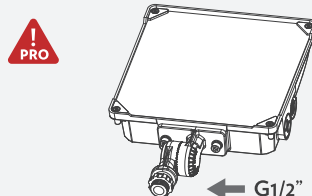

3 Adjustable Projection

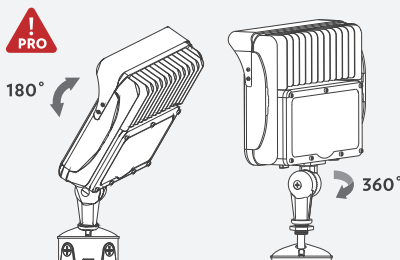

4 Dimensions of Included Junction Box

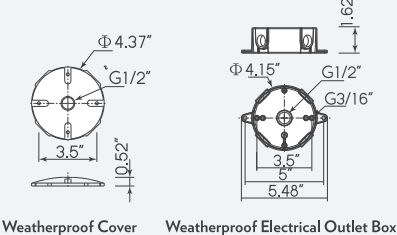

5 Wiring Connection Diagram

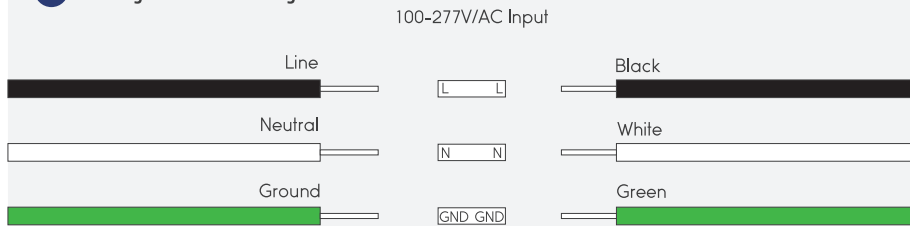

6	Wattage	100W
	Luminous flux	8000lm
	Voltage	100-277V AC
	Working temperature	-4°F-104°F (-20°C-40°C)
	Color temperature	RGBCW (3000K-5000K)
	Light source	LED
	Material	Aluminum alloy & Glass
	Dimmable	APP (0-100%)
	Lifespan	50,000 hrs
	Waterproof rating	IP65

7 After installation is complete, flip the switch to bring your lights back to life. Keep an eye out - when it starts blinking blue, you'll know that it's ready for a connection with your smartphone. If not, remove the waterproof cover on the side of the light and press the button for 5 seconds to enter pairing mode.

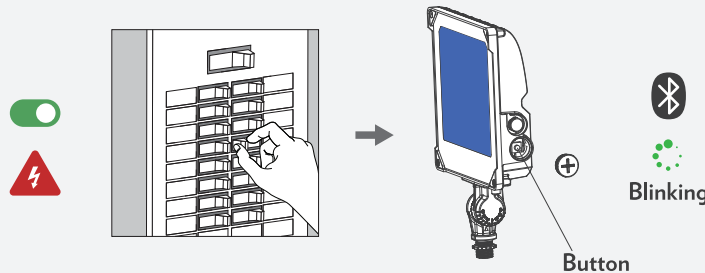

8 Link to online quick start guide.



1-800-990-7688 (Toll Free)



www.leonlite.com/contact



Warning:
This device complies with part 15 of the FCC Rules. Operation is subject to the following two conditions:
(1) This device may not cause harmful interference.
(2) this device must accept any interference received, including interference that may cause undesired operation.

Changes or modifications not expressly approved by the party responsible for compliance could void the user's authority to operate the equipment.

LeonLite Product innovation has always been a critical driver of LEONLITE's business. In a highly competitive industry, we constantly strive to develop new products that offer homeowners unique advantages in terms of style, installation, and energy efficiency. In addition, our products meet the industry's strictest safety and performance standards to ensure product quality.