

# RGB Bluetooth car logo RGB Manual

## Technical Parameters

Product Name	RGB Bluetooth car logo RGB
Support System	Android4.4 and above/iOS10.0 and above
Signal Mode	Bluetooth 4.0
Input Voltage	5V-24V
Remote Control	24key

## Product Description

### Controller:



### Remote control:



The plastic sheet isolate the battery, remove the plastic sheet when using the remote control

## Download App Software

Please search LED LAMP in major Appcenters, or scan below QR code.



1. Download the "LED LAMP" APP with your mobile phones by scanning the QR code on user manual or search the "LED LAMP" APP in iPhone APP store or Google play store.
2. After the APP are downloaded successfully, you need to turn on Bluetooth function on your phone firstly, then plug in the strip light, then open the APP, your APP will pair with the strip light automatically and you can control it.

☆Android phones need to open the location function and allow permission

### Unable to Connect Troubleshooting

- (1) Check if the power supply of the light strip is normal.
- (2) Check if the Bluetooth is turn on.
- (3) Check if there are other mobile phone are connected, Bluetooth 4.0 only support connections one to many, dose not support many to many.
- (4) Check APP Bluetooth setting if the phone is connected to the device, if connect, exit the APP and reopen, the APP will go to connect automatically.
- (5) Normal operations and can not connect, please exit the APP and reopen.
- (6) Exit APP, restart mobile phone, power on the strip light, reopen the APP, then them will connect automatically.

## Instructions

On the homepage interface, pull down to refresh, the APP will automatically search for nearby devices. After finding the device, Click the device icon to enter the light control interface. You can also click the "+" button in the upper right corner, Select the device and enter the light control interface.

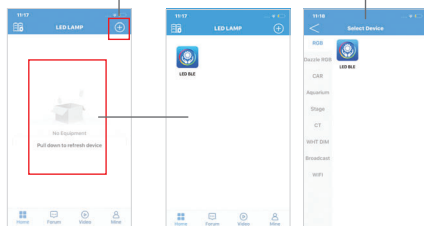

1. **Color interface:** The color interface has two parts: color ring, monochrome. You can adjust the color, brightness, and custom color by the color ring; Monochrome interface: brightness can be adjusted through the ring.

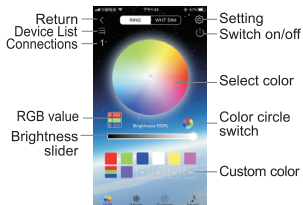

2. **Mode:** You can choose the mode you want, speed adjustment, and brightness adjustment.



3. **Custom:** You can add the colors you want to and choose a mode.

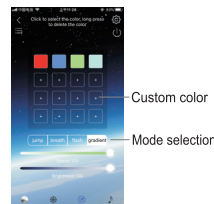

4. **Music interface:** The music interface has two parts music and microphone: where the music needs the phone to play the song to adjust; and the microphone is adjusted by the external sound size.

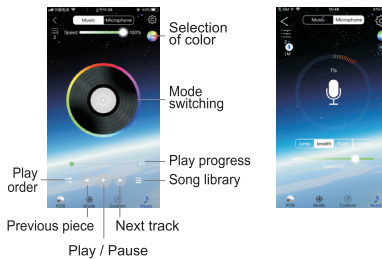

5. **Settings:** You can set modes like rhythm, RGB sort, code, timing, shake, change skin. in rhythm mode you can design color, rhythm pattern, and sensitivity.

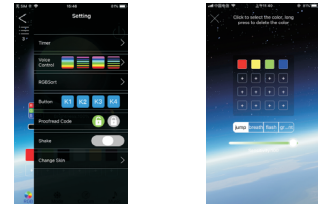

6. **Timer:** In timer mode, you can set the desired time period to open/close the desired mode.

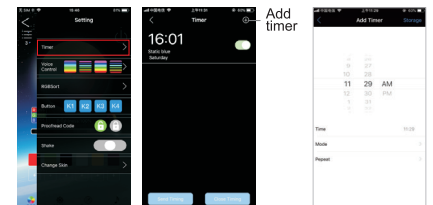

The timer can be set to turn on automatically, and the mode includes static, jump, gradient, cold and warm four modes.

#### Controller FCC WARNING

This device complies with part 15 of the FCC Rules. Operation is subject to the following two conditions : (1) this device may not cause harmful interference, and (2) this device must accept any interference received, including interference that may cause undesired operation.

Any changes or modifications not expressly approved by the party responsible for compliance could void the user's authority to operate the equipment.

NOTE: This equipment has been tested and found to comply with the limits for a Class B digital device, pursuant to Part 15 of the FCC Rules. These limits are designed to provide reasonable protection against harmful interference in a residential installation. This equipment generates, uses and can radiate radio frequency energy and, if not installed and used in accordance with the instructions, may cause harmful interference to radio communications.

However, there is no guarantee that interference will not occur in a particular installation. If this equipment does cause harmful interference to radio or television reception, which can be determined by turning the equipment off and on, the user is encouraged to try to correct the interference by one or more of the following measures:

- Reorient or relocate the receiving antenna.
- Increase the separation between the equipment and receiver.
- Connect the equipment into an outlet on a circuit different from that to which the receiver is connected.
- Consult the dealer or an experienced radio/TV technician for help.

To maintain compliance with FCC's RF Exposure guidelines, This equipment should be installed and operated with minimum 20cm distance between the radiator and your body: Use only the supplied antenna.

#### Remote control FCC WARNING

This device complies with part 15 of the FCC Rules. Operation is subject to the following two conditions : (1) this device may not cause harmful interference, and (2) this device must accept any interference received, including interference that may cause undesired operation.

Any changes or modifications not expressly approved by the party responsible for compliance could void the user's authority to operate the equipment.

NOTE: This equipment has been tested and found to comply with the limits for a Class B digital device, pursuant to Part 15 of the FCC Rules. These limits are designed to provide reasonable protection against harmful interference in a residential installation. This equipment generates, uses and can radiate radio frequency energy and, if not installed and used in accordance with the instructions, may cause harmful interference to radio communications. However, there is no guarantee that interference will not occur in a particular installation.

If this equipment does cause harmful interference to radio or television reception, which can be determined by turning the equipment off and on, the user is encouraged to try to correct the interference by one or more of the following measures:

- Reorient or relocate the receiving antenna.
- Increase the separation between the equipment and receiver.
- Connect the equipment into an outlet on a circuit different from that to which the receiver is connected.
- Consult the dealer or an experienced radio/TV technician for help.

The device has been evaluated to meet general RF exposure requirement. The device can be used in portable exposure condition without restriction