

4. Installation precautions

- 1 When disassembling packaging and handling equipment, please handle with care.
- 2 Please organize and clean up the location of the installation site in advance, and plan the wiring path for power supply, network connection, and other environments in advance.
- 3 During the installation process of the equipment, please make sure to operate it without power, and do not use power for installation operations.
- 4 Please make sure to use a grounded power outlet;
- 5 In the Windows system, to shut down, please use the shutdown command under the corresponding system on the display page (such as: Start → Shut Down Computer), Do not shut down the device directly after cutting off the power.

5. Equipment installation operation

- 1 **Planning the waiting area:** Please pre plan the spatial location, size area, and electrical path of the equipment to be pre installed, and clean and tidy it up;
- 2 **Unpacking:** Open the packaging and take out the main unit and its accessories (if there are auxiliary screens, docking stations, peripherals, etc.) separately. Please check whether the corresponding materials are neat according to the packaging list or order form;
- 3 **Assembly of customer display screen (if available):**
(applicable to 15.6 "or 10.1" customer display screen)
 - a. Place the host device on a flat cash register table, adjust the angle of the main screen to the appropriate position, and remove the cover 1 and hard drive cover 2 that fix the guest display screen on the main screen;
 - b. Remove the customer display screen and corresponding screws, place and install the customer display screen on the main screen in the direction shown in Figure 2 on the right(Also pay attention to the routing of the HDMI cable), install it correctly and lock the corresponding screws;
 - c. Insert the HDMI cable head on the guest display screen into the HDMI interface on the main screen, as shown in Figure 3 on the right; And confirm that the insertion is correct and secure, and tidy up the HDMI harness;
 - d. After checking that the secondary screen is installed correctly and securely, install the hard drive cover and lock the corresponding screws.
- 4 **Assembly docking station (if required):**
 - a. Adjust the main screen and sub screen (if any) to the appropriate positions, and open the wiring cover of the I/O interface cover on the main screen, as shown in Figure 4 on the right;
 - b. Insert the TYPE-C cable of the docking station correctly into the column from the bottom of the base, and insert it correctly into the TYPE-C interface of the main screen I/O area. Secure it correctly with the screws on the TYPE-C cable head, as shown in Figure 5 on the right.

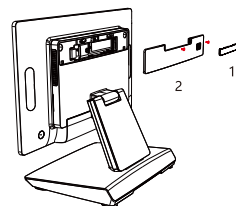

[Figure 1]

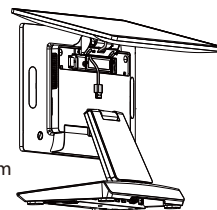

[Figure 2]