

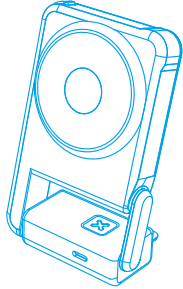

User Manual

RE-Q70



Thank you for buying this product!
To ensure you the best usage, please carefully read this manual and read the manual of your Phone, Laptop or other Device.

Warnings

Improper use of the product may lead to battery malfunction or severe overheating, and may even cause fire or explosion. To avoid any damage to you and your property, please follow the instructions below when you use and store the product.

1. This is not a toy! Please place this product in areas that are not easily accessible by children. Do not allow children to operate this product, or accidents may occur.
2. Please charge this product with a charger approved by the local safety standards in case of danger or damage.
3. Do not apply pressure, and avoid collisions. The battery and circuit may be damaged if this product falls from a great height, experiences intense shocks, or is immersed in liquid; if so, please avoid using this product.
4. If this product suffers from deformation, leakage, or radical decline in performance, please stop using this product.
5. Please do not charge any device or recharge this product in places that may affect its heat dissipation, such as pants pockets, enclosed bags, beds, or couches. And ensure this product is not under any cover when operating. When charging other devices for prolonged periods, do not stack any device on top of this product, or it might affect its heat dissipation.
6. This product can not be disassembled,

applied pressure ,pierced, short-circuited, immersed in liquid, disposed of in a fire, or exposed to a high temperature or heat source with a temperature greater than 140°F(60°C).

7. Do not place this product in areas with extremely high temperatures. Such as under direct sunlight or in a vehicle with a very high interior temperature.
8. This product contains lithium batteries, do not disassemble it! or danger or battery damage may occur.

Attention

1. Please fully charge this device before using it for the first time.
2. The power banks have conversion efficiency, so the battery capacity of power bank is not equal to the rechargeable capacity.
3. Please choose an appropriate charger for recharging this product and suitable cables when charging other devices.
4. Please ensure some supervision is in progress when recharging this product, do not charge this product without any care.
5. Please remove the cable when done recharging this product or finished charging for any other device to preserve the product integrity.

6. If the indication does not light up after pressing the power button, please recharge this product

7. Please preserve this product with a battery percentage between 25%-50%for long-term storage. Place this product in a cool and dry environment. To slow down battery aging, avoid storing this product in an empty or full charge for long-term storage.

8. Please do not dismantle the product by yourself. Improper use or placement may compromise the service life or damage the product, to which outcome pany will not bear any legal responsibilities nor offer any guarantee. Please understand.

9. Working temperature:

Non-tropical areas, 0°C to 35°C

Storage ambient temperature 0°C to 40°C

Specification

Capacity : 10000mAh 3.85V/38.5Wh

Type-C1/C2 Input : 5V≍3A 9V≍2A 12V≍1.5A

Type-C1/C2 Output : 5V≍3A 9V≍2.22A 12V≍1.67A

Wireless Charger : 3W/5W/7.5W/10W/15W(Max)

Content

Power Bank * 1
Warranty Card * 1

User Manual * 1
Charging Cable * 1

Operations

1. Functional illustrations

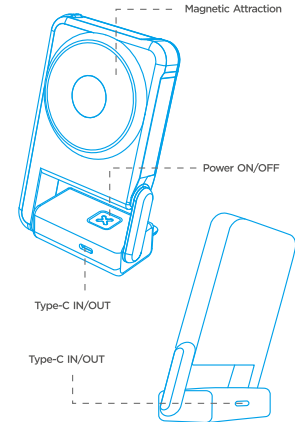

2. Power Output : fits most digital electronic products , which is compatible withmost mobile phones and other digital devices. Below is a simple charging diagramtaking

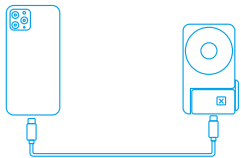

3. Charge your device using the Type-C port

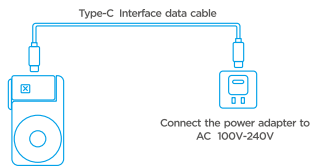

Connect the power adapter to AC 100V-240V

COMMON PROBLEMS AND SOLUTIONS

| BREAKDOWN | REASON | SOLUTION |
|-------------------------------------------------------------------------------------------------------------------------------------------------------------|------------------------------------------------------------------------------------------------------------------------------------------------------------------------------------------------------------------------------------------|----------------------------------------------------------------------------------------------------------------------------------------------------------|
| The product charge for a long time,the power indicator can not show full | 1.The charging time is not enough 2.The charger or the product is faulty | 1.The Product charging time is approximately 12 hours. 2.Consult with dealers or after-sales service providers |
| Unable to check the remaining power of this product | 1.The remaining power is zero 2.The battery button or indicator is faulty 3.The power supply of the product is faulty | 1.Recharge 2.Consult with dealers or after-sales service providers |
| This product cannot charge or power other devices | 1.This product is short of power 2.The conversion cable is not connected to the adapter 3.The selected adapter is incorrect 4.This mode of charging or power supply is prohibited by the power management system of the product | 1.Charge the product again 2.Replace the conversion cable or adapter 3.Find the correct adapter 4.This product cannot be applied to this device |
| When charging other devices,this product can be charged or powered but not fully charged | The battery of the product is exhausted | Charge the product again |
| When theproduct still has a certain amount of poweruse its external power supply,the product suddenly stops working and cannot display the power phenomenon | External short circuit or excessive load,r esulting in automatic protection of this product | This product is recharged to activate |

Statement on Toxic and Hazardous Substances in Electronic Information Products

| Part Description | hazardous substances and elements | | | | | |
|------------------|-----------------------------------|--------------|--------------|-----------------------------|--------------------------------|---------------------------------------|
| | Lead (Pb) | Mercury (Hg) | Cadmium (Cd) | Hexavalent chromium (Cr VI) | Polybrominated biphenyls (PBB) | Polybrominated diphenyl ethers (PBDE) |
| PCB | X | O | O | O | O | O |
| Electrode | O | O | O | O | O | O |
| Battery | X | O | O | O | O | O |
| Casing | O | O | O | O | O | O |

O : It indicates that the content of the toxic and harmful substance in all homogeneous materials of the component

is below the limit specified in standard.

X : he content of toxic and harmful substances in at least one homogeneous material of this part exceeds the limit stipulated in standard.

This device complies with part 15 of the FCC Rules. Operation is subject to the following two conditions: (1) this device may not cause harmful interference, and (2) this device must accept any interference received, including interference that may cause undesired operation. Any changes or modifications not expressly approved by the party responsible for compliance could void the user's authority to operate the equipment.

NOTE: This equipment has been tested and found to comply with the limits for a Class B digital device, pursuant to Part 15 of the FCC Rules. These limits are designed to provide reasonable protection against harmful interference in a residential installation. This equipment generates, uses and can radiate radio frequency energy and, if not installed and used in accordance with the instructions, may cause harmful interference to radio communications. However, there is no guarantee that interference will not occur in a particular installation. If this equipment does cause harmful interference to radio or television reception, which can be determined by turning the equipment off and on, the user is encouraged to try to correct the interference by one or more of the following measures:

- Reorient or relocate the receiving antenna.
- Increase the separation between the equipment and receiver.
- Connect the equipment into an outlet on a circuit different from that to which the receiver is connected.
- Consult the dealer or an experienced radio/TV technician for help.



Warning Please follow the above safety instructions otherwise it will cause fire, electric shock damage or other damage.

The device has been evaluated to meet general RF exposure requirement. The device can be used in portable exposure condition without restriction.

WARRANTY SERVICE CARD

Warranty Feedback Form (check)

- A. The charging is abnormal
B. The power button cannot be operated
C. The parts are broken or damaged
D. Other : _____

Date of purchase : _____

Dealer name : _____

Customer name : _____

Address : _____

Mobile : _____

phone : _____

Product Qualification Certificate

Name: Power Bank

Model: RE-Q70

Examination clerk: _____

QC 06
PASS

This product has been tested to meet the required quality standards Standard, allowed to leave the factory.

Manufacturer : CHONGZHENG(HK)CO.,LIMITED
Address : RM A071701-02 NEW TREND CENTRE,
704 PRINCE EDWARD ROAD EAST, SAN PO KONG KLN



Made in china