



Manual de Usuario

QD15I5GW8512



Announcement

Version (V1.0) (March 2024)

Our company can improve and update the contents of this manual at any time.

This manual may contain errors and omissions, please forgive us.

If the content of this manual is inconsistent with the actual product, please refer to the actual product.

Battery Precautions

Notice:

- Replacing the battery with the wrong type may invalidate the safety protection.
- Throwing the battery into a fire or heating furnace, or subjecting the battery to mechanical crushing or cutting may cause an explosion.
- Exposing batteries to extremely high temperatures may cause them to explode or leak flammable liquids or gases.
- Batteries are subject to extremely low air pressure, which may cause explosions or leakage of flammable liquids or gases.

Never use batteries in the following cases:

- Touch or immerse in water.
- Place in high temperature above 100°C(212F).
- Repair or disassemble

Always dispose of old batteries in accordance with local ordinances or regulations.

Laser Product Certificate Statement

If your personal computer was shipped with a factory-installed optical disc drive, your personal computer system is a laser product. The optical disc drive complies with the requirements of GB7247 for Class I laser products.

Class I laser products are not considered hazardous products.

Radio Interference precautions

This equipment has been tested and proven to comply with the requirements of GB9254 on radio interference:

This equipment can produce, utilize and radiate radio frequency energy. If it is not installed in accordance with the instructions, it will cause interference to radio communications. However, there is no guarantee that interference will not occur in a particular installation. If this equipment does cause interference to radio or television reception, which can be tested by turning the equipment off and on, the user is encouraged to try to correct the interference by:

- Adjust the direction or position of the receiving antenna.
- Increase the separation between the equipment and receiver.
- Plug the equipment into an outlet different from that to which the receiver is connected.
- Request consultation and assistance from your local distributor or service representative.
- Properly shielded and grounded wires and connectors must be used to meet emission limits.

Power Cord

For safety reasons, certified power cords with grounded plugs are provided with Great Wall products. To prevent electric shock and ensure system stability, please use a well-grounded power outlet and ensure a stable and continuous power supply environment.

Instructions for recycling and disposal of discarded computers

After computer parts are scrapped, random discarding will cause pollution to the surrounding environment. Therefore, when you plan to scrap your computer, do not throw it away or send it to the garbage disposal station. Please send it to the local repair station for professional treatment.

Copyright Notice

MS DOS, Windows, Windows NT, Windows XP, Windows Vista, Windows 7, Windows 8, Windows 10, Windows 11 are registered trademarks of Microsoft Corporation.

Safety precautions

Please read the user manual carefully before using your computer. To prevent damage to you, others, and your property, please pay attention to the following information:

- Avoid using the computer in dusty, humid, direct sunlight, magnetic locations, or dirty environments.
- Do not block openings on the computer body, and do not place the computer near a radiator or in a place without proper ventilation.
- The computers are equipped with lightning protection designs. However, due to the large differences in the range and energy range of various lightning effects, the relevant designs cannot currently cover all lightning damage ranges. Therefore, users are advised that in order to ensure the safety of computer use, please do not When using a computer in an environment where thunder and lightning are running, you should cut off the external power supply of the computer and disconnect the network cables, telephone lines and other lines connected to the computer when encountering strong lightning. This can avoid accidents caused by lightning hitting the external circuit environment. damage.
- Please note: 1. Do not use poor quality discs: 2. Store and use discs carefully: 3. Do not put stickers on the disc (it will make the disc surface uneven) 4. Do not take out the disc at will or face when the optical drive is running at high speed Close to the optical drive. Please use the optical drive correctly. Our company will not be responsible for any damage caused by the user himself.
- Do not plug or unplug any components or peripherals connected to the computer host while the power is on. This may cause permanent damage to the interface.
- Do not use the computer when the power supply is unstable. When using the computer normally, a stable and continuous power supply must be ensured. Direct power outage may cause permanent damage to the internal components of the computer.
- Only use the power supply type indicated on the back of the chassis. If you do not understand, please consult the sales unit or the local power supply bureau.
- As soon as you notice unusual smells, overheating or smoke, turn off the power switch immediately and unplug the wires! Call a professional maintenance person for repair!
- Do not push anything through the gaps in the computer, otherwise it may cause a short circuit or smoke! If this problem occurs, immediately turn off the power switch, unplug the AC output terminal, and find a maintenance personnel to repair it!
- Do not try to repair the computer yourself, and do not disassemble the machine without permission!
- Please unplug the power cord when not using the computer for a long time!
- This product is suitable for safe use at altitudes of 5000m and below and is suitable for safe use under tropical climate conditions. No relevant warnings are required in the instructions and nameplate; other relevant safety information has been described in the instructions.

We strive to make the manual accurate and reliable, but it is still difficult to avoid omissions in every link. In addition, due to the development of technology, we may make some changes or upgrades to the software or hardware, resulting in inconsistencies with the manual. We will no longer issue change notices. Please pay attention to the user and apologize for this.

Thank you again for your cooperation!

Chapter 1 Introduction of Computers

This chapter summarizes the characteristics of compaq Computer, please be sure to read it carefully.

Unpacking and inspection

Compaq Computer comes with a packing list, which contains a list of all the parts and information in the host box. When opening the box, please confirm whether the parts and information are complete and whether they have been damaged during transportation.

Note: During the three-guarantee period, please keep all random information, accessories, and packaging materials in order to reduce unnecessary losses during the three-guarantee period.

Model identification

There is a model and serial number barcode label on the back of your case. For some models, the model label may be affixed to the bottom of the case. When you need help or report a problem, please provide the full model name or serial number so that we can quickly know the details of your machine and serve you better.

Usage environment

Ambient Temperature

---Working: 10~35°C.

---Storage and transportation: -20~55°C

Ambient humidity (relative humidity)

---Working: 35~80%.

---AC 198~242V, 50Hz.

---Storage and transportation: 20~93% (40°C).

Atmospheric Pressure

---86~106kpa.

Power requirements

Altitude Requirements

---Work:-300~3048m

It is prohibited to use computers under the following circumstances

- Humid environment.
- Place exposed to direct sunlight.
- Near magnets or places that generate magnetic fields.
- A place that vibrates.
- Areas with excessive dust.
- Near a heater or other heat source.
- Places with sudden temperature changes.
- An environment where voltage fluctuates frequently or is intermittent.

Chapter 2 Using Your Computer

This chapter will help you learn to operate your computer step by step

Know what the product looks like

Front and rear views of the main unit

(*) Some specific models may not have this interface or function, please refer to the actual product!

Notice:

- Do not block the cooling holes;
- The model you purchased may not have some of the interfaces in the picture, please refer to the actual product;
- The hard disk activity indicator light on the front of the host will only flash when the hard disk is reading or writing;
- The power indicator light on the front of the host will remain on after the host is turned on.

Desktop PC front view

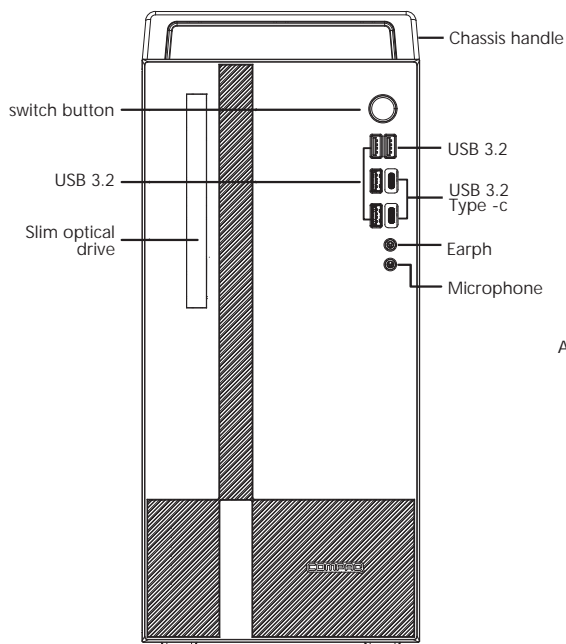

Desktop PC rear view

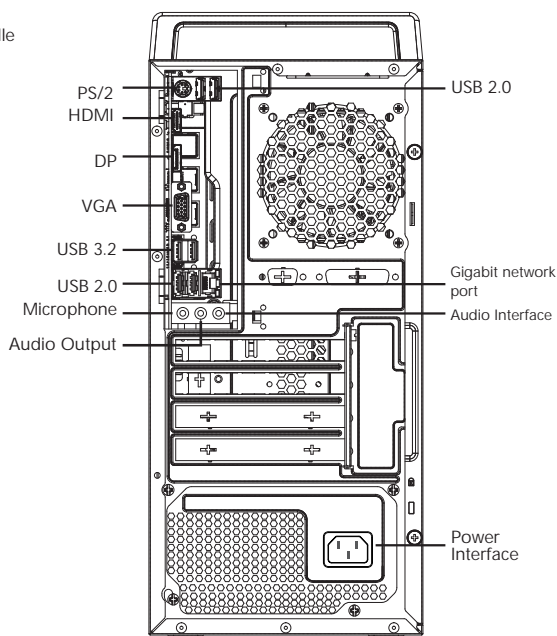

Cable Connection

Warning: When connecting the keyboard, mouse, and monitor to the computer, make sure that your monitor, computer and other devices are powered off and do not operate them with power on.

1. Connect keyboard and mouse

Please connect the keyboard and mouse to the keyboard and mouse interfaces of the computer as shown in the figure; if the keyboard or mouse of the model you purchased has a USB interface, just plug the keyboard or mouse into any USB socket of the host.

2. Connect to the computer host

Please use the included monitor cable to connect the monitor to the computer host as shown in the figure, and use the included power cord to connect the monitor to the power outlet.

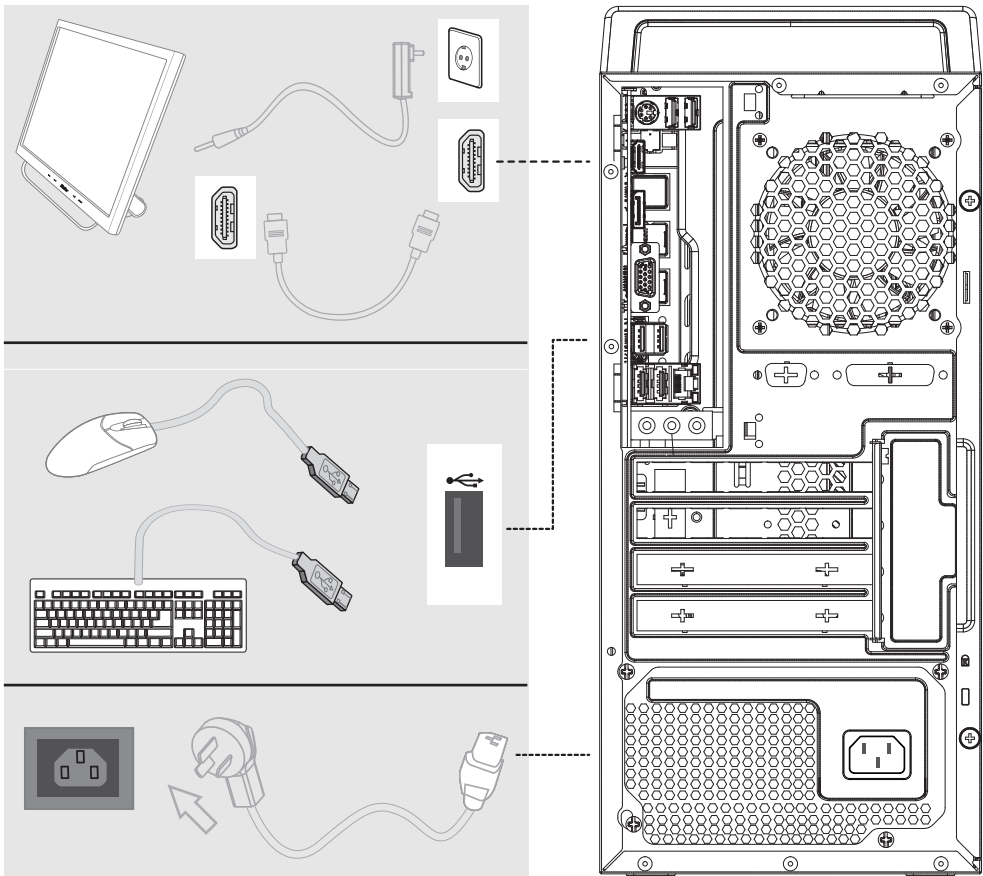

Power on

Press the computer's power switch (the switch marked with a (⏻)) and the computer will start.

Shut down

When you prepare to shut down your computer, use the proper shutdown procedures specified by your operating system to prevent the loss of unstored data or damage to software programs. See your operating system documentation for specific instructions.

Note: Do not shut down the computer by directly cutting off the power supply by unplugging the power cord.

Statement 1

The power supplies of compaq computers are mainly ATX (MICRO-ATX, FLEX-ATX) type. When the computer is turned off, the power supply is not completely cut off, and some circuits are still working. At this time, the computer still consumes energy. To achieve zero energy consumption, you need to turn off the power outlet switch connected to the computer's power cord or simply unplug the power plug.

Statement 2

The computer energy consumption indicators (for reference):

Rated power(W)	Normal working status	Sleep state	Shutdown state
≤200	≤80w	≤15w	≤3w
>200, ≤300	≤90w	≤20w	≤3w
>300, ≤350	≤100w	≤25w	≤3w
>350, ≤400	≤250w	≤30w	≤3w

Warn:

1. When cutting off the power, hold the plug firmly before unplugging the power cord, do not pull the cord directly.
2. Do not open the case without a Great Wall authorized repair organization or yourself, otherwise your machine may lose the right to free warranty.
3. Please do not install non-compaq original parts at will or upgrade by yourself. This may cause damage to the machine or cause compatibility issues; otherwise, your machine may lose the right to free warranty.
- 4.To prevent viruses from damaging your files, you need to back up all your software and data.

Appendix: List of names and contents of toxic and harmful substances or elements

Part name	Toxic and harmful substances or elements						Remark
	Lead (Pb)	Mercury (Hg)	Cadmium (Cd)	Hexavalent chromium (Cr6+)	Polybrominated Biphenyls (PBB)	Polybrominated diphenyl ethers (PBDE)	
CPU	×	○	○	○	○	○	
Memory	×	○	○	○	○	○	
PCBA	×	○	○	○	○	○	
Power Supply	×	○	○	○	○	○	
Keyboard	×	○	○	○	○	○	
Mouse	×	○	○	○	○	○	
Fan	×	○	○	○	○	○	
Chassis	×	○	○	○	○	○	
Cable	○	○	○	○	○	○	
Power Cord	○	○	○	○	○	○	
Graphics Card (optional)	×	○	○	○	○	○	
Expansion Card (optional)	×	○	○	○	○	○	
HardDisk (optional)	×	○	○	○	○	○	
CD-ROM drive (optional)	×	○	○	○	○	○	
Floppy drive (optional)	×	○	○	○	○	○	
Headset (optional)	×	○	○	○	○	○	
<p>○ : Indicates that the content of the toxic and hazardous substances in all homogeneous materials of the component is below the limit requirements stipulated in the Chinese RoHS standard SJ/T11363-2006 "Maximum Requirements for Toxic and Hazardous Substances in Electronic Information Products";</p> <p>×</p> <p>× : Indicates that the content of the toxic and hazardous substance in at least one homogeneous material of the component exceeds the limit requirements stipulated in the Chinese RoHS standard SJ/T11363-2006 "Standard for Limits of Toxic and Hazardous Substances in Electronic Information Products";</p> <p>Note: Parts of this product that contain toxic and hazardous substances or elements cannot be replaced due to global technological development limitations. However, more than 90% of the parts of this product comply with the exemption provisions of the EU RoHS Directive.</p>							

FCC Requirement

Any changes or modifications not expressly approved by the party responsible for compliance could void the user's authority to operate the equipment.

This device complies with Part 15 of the FCC Rules. Operation is subject to the following two conditions:

- (1) this device may not cause harmful interference, and
- (2) this device must accept any interference received, including interference that may cause undesired operation.

This transmitter must not be co-located or operating in conjunction with any other antenna or transmitter.

Note: This equipment has been tested and found to comply with the limits for a Class B digital device, pursuant to Part 15 of the FCC Rules. These limits are designed to provide reasonable protection against harmful interference in a residential installation. This equipment generates, uses, and can radiate radio frequency energy, and if not installed and used in accordance with the instructions, may cause harmful interference to radio communications. However, there is no guarantee that interference will not occur in a particular installation. If this equipment does cause harmful interference to radio or television reception, which can be determined by turning the equipment off and on, the user is encouraged to try to correct the interference by one or more of the following measures:

- Reorient or relocate the receiving antenna.
- Increase the separation between the equipment and receiver.
- Connect the equipment into an outlet on a circuit different from that to which the receiver is connected.
- Consult the dealer or an experienced radio/TV technician for help.

This device complies with FCC radiation exposure limits set forth for an uncontrolled environment. This device should be installed and operated with minimum distance 20cm between the radiator & your body.

This device complies with Part 15 of the FCC Rules. Operation is subject to the following two conditions:

- (1) this device may not cause harmful interference, and
- (2) this device must accept any interference received, including interference that may cause undesired operation.

Indoor use only.