

SUNLINK

User Manual

COB Led Strip Light

Item NO: PAK544600

FCC ID: 2BLSZ-03

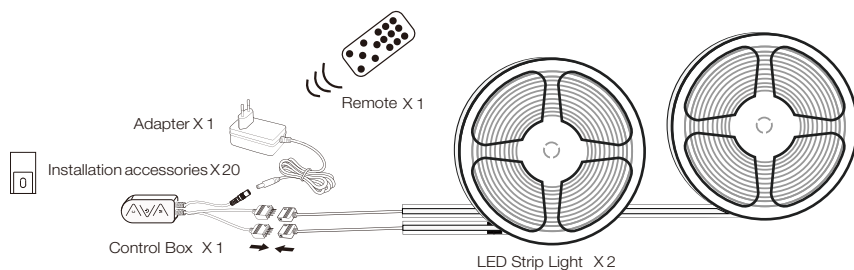

01

Ways to Operation

(1) Manual Control by 3 Buttons

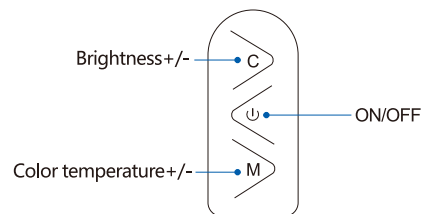

DO NOT ROLL UP WHEN USING

Please spread out the strip light before connecting the power supply

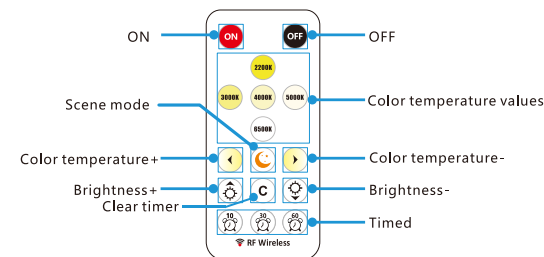

Replacing the battery

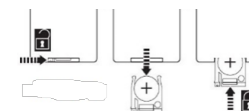

To replace the batteries in the remote control, use
▪ 1x CR2025 / Li-ion / 100 mAh / 3 V.

02

Specification

Model	Voltage	CRI	LED quantity	Color temperature	Length
PAK544600	DC 24V	>90	608LEDs/m	CCT(2300-6500K)	5M*2/32.8ft

Smart Life App Control

1. Download and install the "Smart Life" app.



2. Register and log in to your account.

(1) Press and hold the Control Box on/off key for 5 seconds, when the light strip enters the flash mode, it will enter the pairing mode.

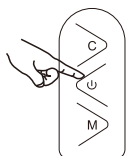

(2) Turn on Bluetooth on your phone and open the WiFi for connection.

(3) Open the "smart life" APP. (4) Click on "Add Device"

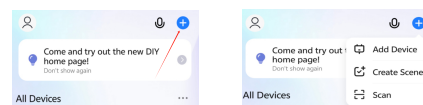

(5) Wait for the search device and click on "COB LED Strip Light".

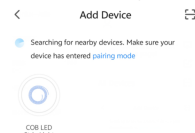

3. After successful pairing, you can remotely control the light through the app, and set timers, scene linkages, and other functions.

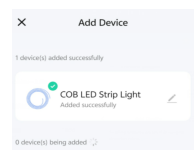

03

Installing Steps

1. Wipe dust particles and debris from the wall surface with a clean cloth.



2. Estimate the positions of the control box and the power socket and make sure the strip light is long enough. Peel off the cover of the adhesive on the back of the control box and stick it to the wall surface. For a more convenient installation. Please do not connect the control box with the adapter in this step.



3. Peel off the cover of the adhesive on the back of the strip light. Stick the strip light onto the wall surface and press hard to ensure it is firmly mounted.

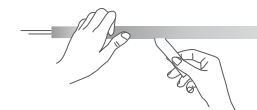

4. Connect the adapter to the control box and plug the adapter into the power socket.

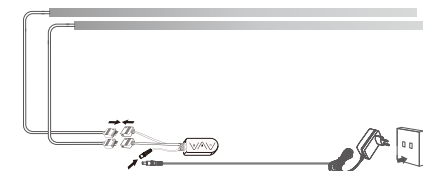

04

Operation



WARNING

Epileptic seizure

A small percentage (approximately 1 person in 4,000) of the population may experience epileptic seizures while viewing flashing lights and patterns.

- Never look directly into the light source.
- Immediately switch off the product if there is any sign of an epileptic seizure.

Non-compliance with this instruction can cause serious or fatal injury and damage to property.



CAUTION

Damage to eyes

- Never look directly into the light source.

Non-compliance with these instructions can cause personal injury or damage to property.

05

NOTE

Damage to the product

- Do not use any solvents for cleaning.

Non-compliance with this instruction can cause damage to property.

- Use a soft, dry cloth for cleaning.

- In case of severe soiling, use a soft and slightly damp cloth to clean the product.

Repairs and spare parts

NOTE

Unsuitable parts

- Use original spare parts and accessories from the manufacturer only.

Non-compliance with this instruction can cause damage to property.

06



DANGER

Electric shock

- Disconnect the mains voltage or mains plug before starting work.
- Do not unplug the mains plug by pulling the cable, always take hold of the mains plug directly.
- Make sure that no hazards can be caused by electrically conductive objects or media.
- Make sure that the type of electrical installation does not reduce the protection against electric shock (protection class, protective insulation).
- Make sure that the cable is not bent excessively or crushed.

Non-compliance with these instructions will result in serious or fatal injury.

Disposal



Do not dispose of old appliances with household waste!

If the product can no longer be used, every consumer is legally obliged to dispose of old appliances separately from household waste, e.g. at a collection point in their municipality/district. This ensures that old appliances are disposed of properly.

Dispose of the product in accordance with the applicable regulations, standards and safety instructions in your country.

1. Disconnect the product from the power supply.
2. Disassemble the product.
3. Dispose of the product.

07

FCC Statement

1. This device complies with Part 15 of the FCC Rules. Operation is subject to the following two conditions:
(1) This device may not cause harmful interference.
(2) This device must accept any interference received, including interference that may cause undesired operation.
2. Changes or modifications not expressly approved by the party responsible for compliance could void the user's authority to operate the equipment.
Note: This equipment has been tested and found to comply with the limits for a class B digital device, pursuant to Part 15 of the FCC Rules. These limits are designed to provide reasonable protection against harmful interference in a residential installation.
This equipment generates uses and can radiate radio frequency energy and, if not installed and used in accordance with the instructions, may cause harmful interference to radio communications. However, there is no guarantee that interference will not occur in a particular installation. If this equipment does cause harmful interference to radio or television reception, which can be determined by turning the equipment off and on, the user is encouraged to try to correct the interference by one or more of the following measures:

- Reorient or relocate the receiving antenna.
- Increase the separation between the equipment and receiver.
- Connect the equipment into an outlet on a circuit different from that to which the receiver is connected.
- Consult the dealer or an experienced radio/TV technician for help

The device has been evaluated to meet the general RF exposure requirement. This equipment should be installed and operated with a minimum distance of 20 cm between the radiator and your body.

08