

140*100MM

Installation instructions



Open the car door and use tools to open the door panel



Open the door panel and directly remove it



Install light strips in the door panel



All light strips installed

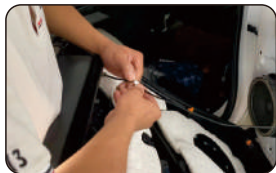

Installation completed,
wiring port docking completed



Installation effect

Insert the light source into the host and reinstall the door panel.

Note: during the installation process, it is troublesome to walk the line. You need to find a professional master to install it. For detailed installation video, please scan the QR code on the right.



FCC Warning

This device complies with Part 15 of the FCC Rules. Operation is subject to the following two conditions:
(1) This device may not cause harmful interference, and (2) this device must accept any interference received, including interference that may cause undesired operation.

NOTE 1: This equipment has been tested and found to comply with the limits for a Class B digital device, pursuant to part 15 of the FCC Rules. These limits are designed to provide reasonable protection against harmful interference in a residential installation. This equipment generates, uses and can radiate radio frequency energy and, if not installed and used in accordance with the instructions, may cause harmful interference to radio communications. However, there is no guarantee that interference will not occur in a particular installation. If this equipment does cause harmful interference to radio or television reception, which can be determined by turning the equipment off and on, the user is encouraged to try to correct the interference by one or more of the following measures:

- Reorient or relocate the receiving antenna.
- Increase the separation between the equipment and receiver.
- Connect the equipment into an outlet on a circuit different from that to which the receiver is connected.
- Consult the dealer or an experienced radio/TV technician for help.

NOTE 2: Any changes or modifications to this unit not expressly approved by the party responsible for compliance could void the user's authority to operate the equipment.

RF Exposure Statement

To maintain compliance with FCC's RF Exposure guidelines, This equipment should be installed and operated with minimum 20cm between the radiator and your body. This device and its antenna(s) must not be co-located or operation in conjunction with any other antenna or transmitter.

Click the icon to enter the Symphony APP interface

Interface icons



Click to enter the control interface

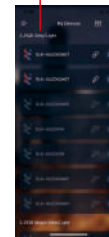

Color adjustment

Mode interface, you can choose the mode you want, speed, brightness adjustment

RGB value

Color selection

Color selection

Color selection

switch

toning | mode | at regular time
rhythm scene

Download application software



- 1: Scan the QR code above with your mobile phone to download it to the mobile phone interface
- 2: After the download is successful, you need to turn on the Bluetooth function of the mobile phone first, and then plug in the light. Open the app again, it will automatically match with the light, and then you can control the light. Android needs to turn on location and allow permissions

The device cannot be linked

- 1: Check whether the lamp is powered normally.
- 2: Whether the Bluetooth of the mobile phone is turned on.
- 3: Whether there are other mobile phones already connected, if so, please disconnect, Bluetooth 4.0 only supports one-to-many, not many-to-many control.
- 4: Whether the bluetooth device is linked in the mobile phone settings, if it is linked, please disconnect the APP background and exit and reopen it, the APP will automatically go to the link.
- 5: Normal operation still cannot be linked, please exit the APP from the background and reopen it.
- 6: Exit the APP in the background, restart the mobile phone, power on the lamp again, reopen the APP software and link again