

User Manual

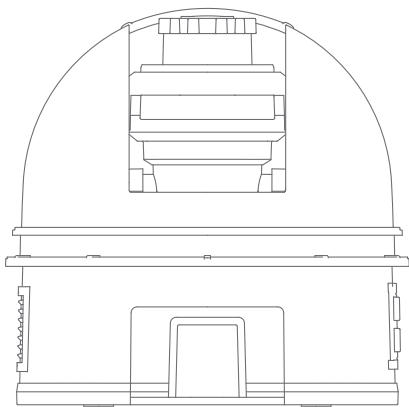

TYD-TWT-003



Attention

- ◆ The intensity of the light is high, so please don't look at the light source directly.
- ◆ Do not use the product in damp or high-temperature environments.
- ◆ This product is not replaceable, when the light source reaches the end of life, the entire lamp should be replaced.
- ◆ A pre-programmed 2-hour auto-shutdown function is activated to extend the product's service life.
- ◆ Do not expose projection film to direct light for extended periods, as light will accelerate its aging and fading. Store them in the designated space provided by the product when not in use.

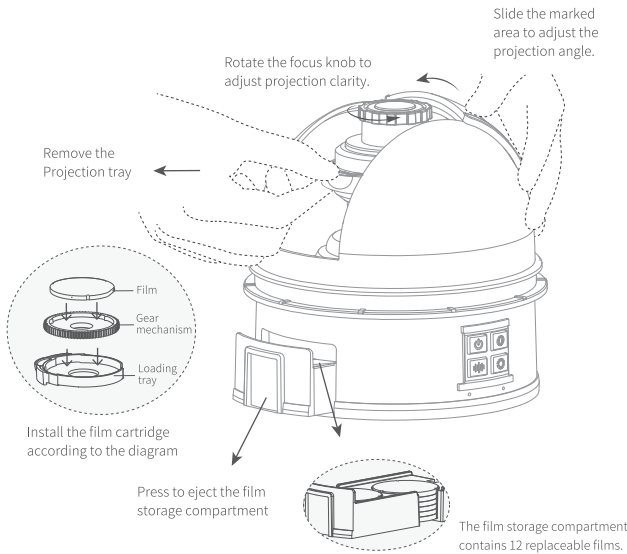

Host Button Operation Instructions

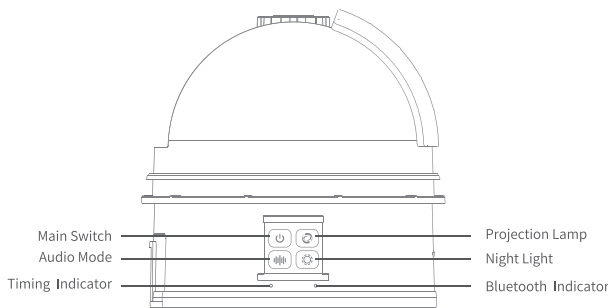

Note:
1.The product requires a power cord to use.
2.Please connect the 5V=1A adapter for power supply. Please do not directly connect to the USB socket for power supply. Otherwise, there is a chance that the product will shut down frequently due to insufficient power supply.

- ◆ **Main Switch:** Press the button to turn on the device. When powered on, the science knowledge presentation starts by default. Long press the button to turn off the device after it has started. The device will auto-shutdown after two hours of operation.
- ◆ **Projection Lamp:** The Projection lamp turns on automatically when you power on the device. Press the button to pause rotation. Press again to resume. Long Press to turn off the projection lamp.
- ◆ **Audio Mode:** There are three types of audio in this mode, the science knowledge presentation, White Noise and Bluetooth (connect to your phone and play the audio you like). The science knowledge presentation turns on automatically when you power on the device. Press to switch to white noise mode; press again for Bluetooth mode. Hold down to deactivate audio functions.
- ◆ **Night Light:** The Night Light turns on automatically when you power on the device. Press to change the light color. Hold down to deactivate night light functions.

How to Connect the Bluetooth?

When the Bluetooth Indicator blinks. The Bluetooth function is turned on and ready to connect to your phone. The Bluetooth name of the product is "Observatory." Turn on your phone Bluetooth and search, when "Observatory" appears, select this option to pair with a successful connection tone and the Indicator blinking to normal light.

Remote Control Operation Instructions

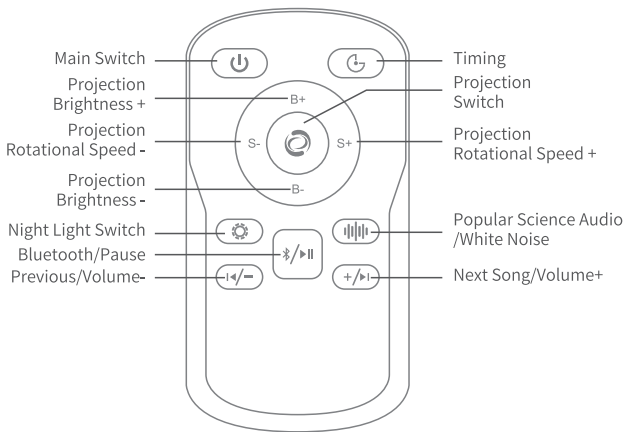

- ◆ **Main Switch:** Press the button to turn on the device. When powered on, the science knowledge presentation starts by default. Long press the button to turn off the device after it has started. The device will auto-shutdown after two hours of operation.
- ◆ **Timing:** Press the button to activate a 30-minute countdown. You'll hear a confirmation beep and see the timing indicator light up blue. Press the button again to activate a 60-minute countdown. You'll hear two confirmation beeps and see the timing indicator light up red. Long press this button to cancel the Automatic Turn Off Function with the timing indicator light off.
- ◆ **Projection Brightness +:** The projector offers 3 adjustable brightness levels, defaulting to the median level (Level 2). Each button press increments the brightness by one level.
- ◆ **Projection Switch:** The Projection lamp turns on automatically when you power on the device. Press the button to pause rotation. When rotation is paused, Press again to resume. Long Press to turn off the projection lamp.
- ◆ **Projection Rotational Speed -:** The projection rotation features three-speed settings: Low, Medium, High. The system defaults to Medium at startup. Press the this button to cycle downward through speed levels until reaching minimum. When at Low speed, subsequent presses are disabled.
- ◆ **Projection Rotational Speed +:** The projection rotation features three-speed settings: Low, Medium, High. The system defaults to Medium at startup. Press the control button to cycle upward through speed levels until reaching maximum. When at High speed, subsequent presses are disabled.
- ◆ **Projection Brightness -:** The projector provides 3 adjustable brightness levels, defaulting to the median level (Level 2). Each button press decrements the brightness by one level.
- ◆ **Night Light Switch:** The Night Light turns on automatically when you power on the device. Press to change the light color. Hold down to deactivate night light functions.
- ◆ **Popular Science Audio/White Noise:** When powered on, the science education presentation starts by default. Press to switch to white noise mode; press again to switch to science education mode. Hold down to deactivate both modes. Press again to reactivate science education mode.

- ◆ **Bluetooth/Pause:** Hold down to activate Bluetooth mode (indicator blinks during pairing). When Bluetooth connects successfully, the indicator stays lit. In Bluetooth mode, hold down again to deactivate. During audio playback: Briefly press to pause; press again briefly to resume.
- ◆ **Previous/Volume-:** Short press the button to switch to the previous song. Hold down to reduce the volume.
- ◆ **Next Song/Volume+:** Short press the button to switch to the next song. Hold down to turn up the volume.

Material: ABS/PC
Rated Voltage: 5V=1A
Control Mode: Remote control
Remote Control Range: <5meters(Best distance)
Product Size: 136x136x134mm
Applicable Environment: Indoor Home(Better in a dark environment)
Working Temperature: 10°~40°Celsius



Do not look directly at the light source!



FCC Caution:

This device complies with part 15 of the FCC Rules. Operation is subject to the following two conditions: (1) This device may not cause harmful interference, and (2) this device must accept any interference received, including interference that may cause undesired operation.

Any changes or modifications not expressly approved by the party responsible for compliance could void the user's authority to operate the equipment.

NOTE: This equipment has been tested and found to comply with the limits for a Class B digital device, pursuant to Part 15 of the FCC Rules. These limits are designed to provide reasonable protection against harmful interference in a residential installation. This equipment generates, uses and can radiate radio frequency energy and, if not installed and used in accordance with the instructions, may cause harmful interference to radio communications. However, there is no guarantee that interference will not occur in a particular installation. If this equipment does cause harmful interference to radio or television reception, which can be determined by turning the equipment off and on, the user is encouraged to try to correct the interference by one or more of the following measures:

- Reorient or relocate the receiving antenna.
- Increase the separation between the equipment and receiver.
- Connect the equipment into an outlet on a circuit different from that to which the receiver is connected.
- Consult the dealer or an experienced radio/TV technician for help.

The device has been evaluated to meet general RF exposure requirement. The device can be used in portable exposure condition without restriction.