

Outdoor sports music
thermos cup

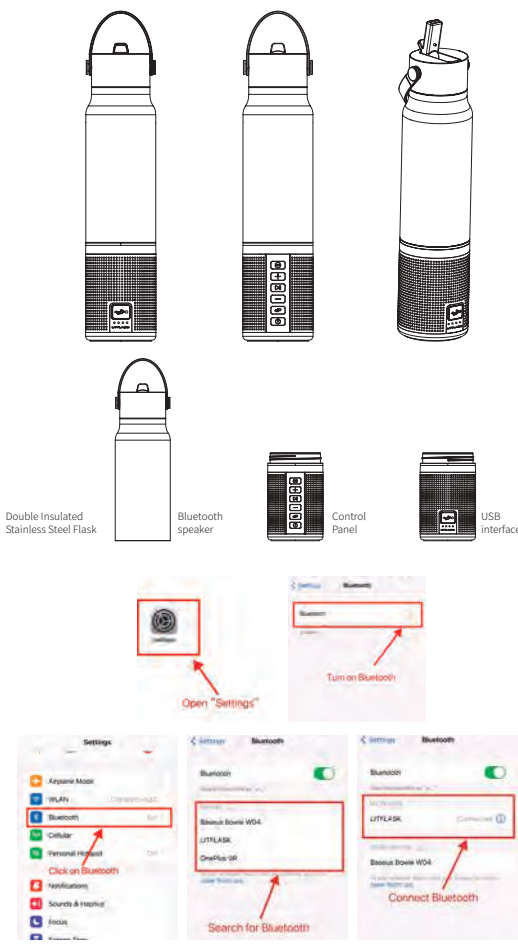

LITFLASK OPERATING INSTRUCTIONS	
Press and hold to power LITFLASK on/off. When powered on the LED light will turn on.	
Pairing Your LITFLASK for the First Time: 1. Power on your LITFLASK. It will automatically search for devices. 2. In your device's Bluetooth settings, select "LITFLASK". 3. A beep confirms a successful connection.	
Auto-Pairing on Next Uses: 1. When powered on, LITFLASK will automatically reconnect to the last paired device. 2. A beep will sound upon successful reconnection. 3. If there's no prior successful connection, LITFLASK will revert to search mode for new pairings.	
If there is no Bluetooth pairing connection after 5 minutes after powering on, the system will automatically shut down.	
+	Click to increase the volume. (When you hear a beep, this means the volume is max.)
+	Hold for next song.
⏮	Click to play/pause the music.
⏮	Answer a call: Tap this button to answer a call. Call rejection: Press and hold this button to decline an incoming call. End call: Tap this button again to end the call.
-	Click to decrease the volume.
⏮	Hold for previous song.
BUMP TECHNOLOGY: Pairing LITFLASKs to each other 1. Power on both LITFLASKs: e.g., LITFLASK White and LITFLASK Black. 2. Connect your phone's Bluetooth to LITFLASK White only. 3. Press and hold the link button on either LITFLASK. 4. You will hear two beeps, a short beep followed by a connection beep, indicating a successful link. 5. In this step, LITFLASK White drives the connection. Your phone only shows a connection to LITFLASK White. 6. To unlink, press and hold the link button again. If powered off without unlinking, they'll reconnect upon restart. 7. In this scenario, you won't be able to connect to LITFLASK Black on your device again until you unlink.	
Click the LIT button to change light modes.	
Green lights are the battery level indicator. (Each light represents 25% battery.) IE: 2 Lights mean 50% battery. You will hear a sound indicating low battery at 10% and 5%. The Power button will flash red as well.	
Power input TYPE-C - Top port charges LITFLASK	
Power output TYPE-C - Bottom port is the portable charger for external DEVICES.	

Outdoor sports music
thermos cup

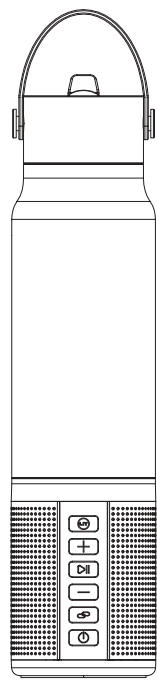
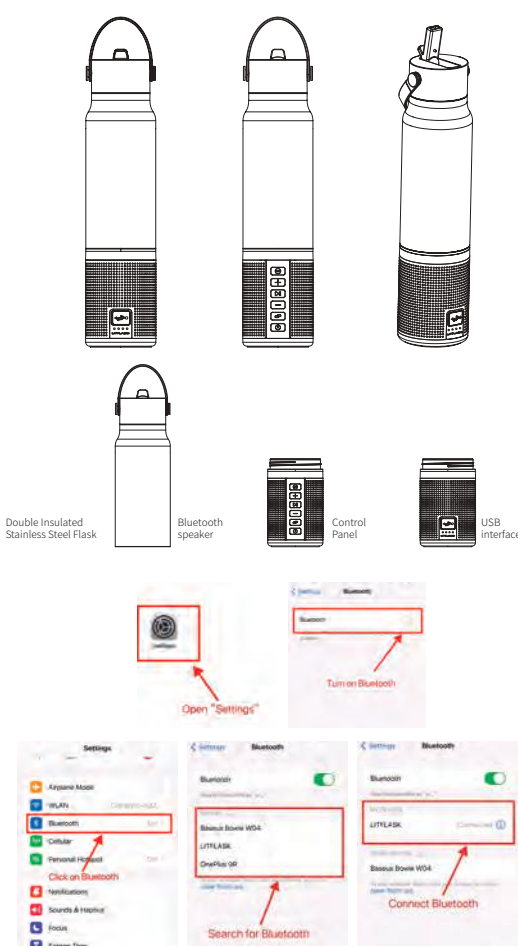
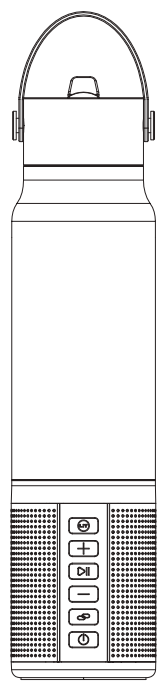

LITFLASK OPERATING INSTRUCTIONS	
Press and hold to power LITFLASK on/off. When powered on the LED light will turn on.	
Pairing Your LITFLASK for the First Time: 1. Power on your LITFLASK. It will automatically search for devices. 2. In your device's Bluetooth settings, select "LITFLASK". 3. A beep confirms a successful connection.	
Auto-Pairing on Next Uses: 1. When powered on, LITFLASK will automatically reconnect to the last paired device. 2. A beep will sound upon successful reconnection. 3. If there's no prior successful connection, LITFLASK will revert to search mode for new pairings.	
If there is no Bluetooth pairing connection after 5 minutes after powering on, the system will automatically shut down.	
+	Click to increase the volume. (When you hear a beep, this means the volume is max.)
+	Hold for next song.
⏮	Click to play/pause the music.
⏮	Answer a call: Tap this button to answer a call. Call rejection: Press and hold this button to decline an incoming call. End call: Tap this button again to end the call.
-	Click to decrease the volume.
⏮	Hold for previous song.
BUMP TECHNOLOGY: Pairing LITFLASKs to each other 1. Power on both LITFLASKs: e.g., LITFLASK White and LITFLASK Black. 2. Connect your phone's Bluetooth to LITFLASK White only. 3. Press and hold the link button on either LITFLASK. 4. You will hear two beeps, a short beep followed by a connection beep, indicating a successful link. 5. In this step, LITFLASK White drives the connection. Your phone only shows a connection to LITFLASK White. 6. To unlink, press and hold the link button again. If powered off without unlinking, they'll reconnect upon restart. 7. In this scenario, you won't be able to connect to LITFLASK Black on your device again until you unlink.	
Click the LIT button to change light modes.	
Green lights are the battery level indicator. (Each light represents 25% battery.) IE: 2 Lights mean 50% battery. You will hear a sound indicating low battery at 10% and 5%. The Power button will flash red as well.	
Power input TYPE-C - Top port charges LITFLASK	
Power output TYPE-C - Bottom port is the portable charger for external DEVICES.	

2024-09-13

Balokta

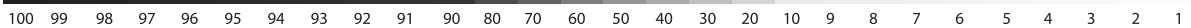
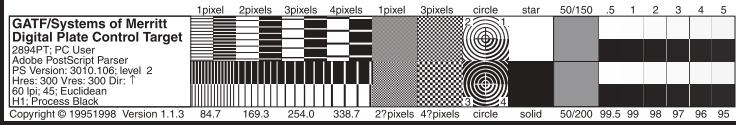
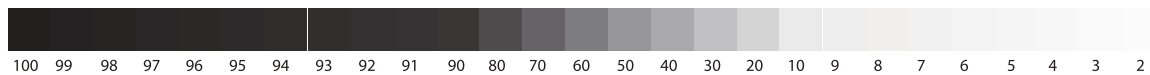

FCC Caution

This device complies with part 15 of the FCC Rules. Operation is subject to the following two conditions:

- (1) This device may not cause harmful interference, and
- (2) this device must accept any interference received, including interference that may cause undesired operation.

Any Changes or modifications not expressly approved by the party responsible for compliance could void the user's authority to operate the equipment.

Note: This equipment has been tested and found to comply with the limits for a Class B digital device, pursuant to part 15 of the FCC Rules. These limits are designed to provide reasonable protection against harmful interference in a residential installation. This equipment generates uses and can radiate radio frequency energy and, if not installed and used in accordance with the instructions, may cause harmful interference to radio communications. However, there is no guarantee that interference will not occur in a particular installation. If this equipment does cause harmful interference to radio or television reception, which can be determined by turning the equipment off and on, the user is encouraged to try to correct the interference by one or more of the following measures:

- Reorient or relocate the receiving antenna.
- Increase the separation between the equipment and receiver.
- Connect the equipment into an outlet on a circuit different from that to which the receiver is connected.
- Consult the dealer or an experienced radio/TV technician for help.

The device has been evaluated to meet general RF exposure requirement. The device can be used in portable exposure condition without restriction.