

# QM25-LE-A-01E

## Instruction Book



### Function Feature

- Wireless Receiver
- Jog Dimming
- Motor Running Speed can be adjustable
- Reversing Function
- The Third Stroke Point Function
- Low Consumption Stand By
- Electronic Strok Setting

### Usage Range



The motor is suitable for roller blinds.

### Specifications

|                                |                                       |
|--------------------------------|---------------------------------------|
| Working Temperature: 0°C~+55°C | Radio-Frequency: 433.92MHz RX, Zigbee |
| Rated Voltage: DC 5V           | Thermal Protection Time: 3 Minutes    |

For more motor models and specific torque, please refer to the nameplate.

### Attention

Please do not drop, strike, drill into or immerse the motor in water. Hold the power supply cord in the right position as shown as below.  
Please read the important safety instructions before installing.  
Improper installation could result in serious damage and out of the manufacturer's liability and warranty.



×

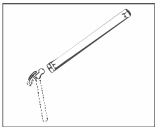

×

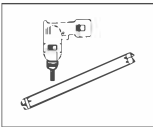

×

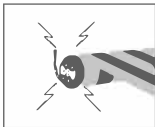

×



✓

### Charging batteries



The motor can not run  
and beep five sounds



Red light is always on  
after fully charged



Green light is always on  
after fully charged

## Motor Installation

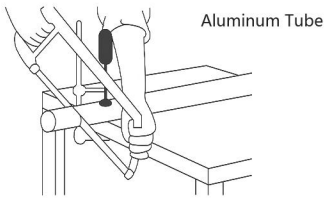

Step 1 Cutting aluminum tube to desired length.



Step 2 Ensure tube edges are clean and free of burrs.

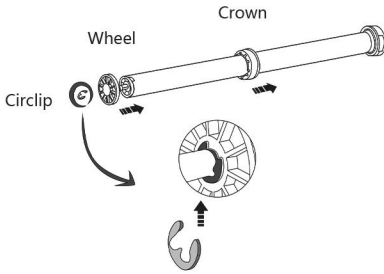

Step 3 Install the correct crown and drive adapter on the motor. Make sure the drive adapter is securely installed and the crown spins freely.

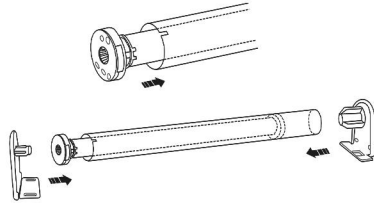

Step 4 Align the notches on the crown and drive adapter with the aluminum tube, slide and install the motor into the aluminum tube, install the stroke bracket and end plug bracket on both ends of the aluminum tube.

## Attention

1. Please do not expose the motor to moisture or extreme temperature conditions.
2. Please don't drill into the motor.
3. Please never cut the antenna and keep it away from metal objects.
4. Please do not allow children to play with this device.
5. Please do not use if the power supply cord or connector is damaged.
6. Please make sure to use the correct crown and drive adapter.
7. Please do not move the component parts and make sure the power supply cord and antenna are clear.
8. Cables passing through walls should be properly isolated.
9. The motor can only be installed in a horizontal position.
10. Please remove unnecessary power supply cords and disable devices that not required for powered operation before installation.
11. Installation and programming should be operated by qualified professionals. Any using or modifications beyond the scope of this instruction may avoid the warranty.



Please read the important safety instructions before operating.

## Operation Notes

Please read the following notes carefully before setting.

1. Please charge the motor first before using it for the first time. The motor is charged with a 5V USB charger and please make sure it is fully charged before use.
2. Please do not operate the motor when the low voltage alarm occurred.  
The motor will stop running when the power supply voltage is lower than 6.8V.
3. During Operation
  - ① The effective time interval of the remote button is 10 seconds, if there is no operation within 10 seconds, it will exit the current setting.
  - ② There will be a chirping sound prompt, please proceed to the next operation step after the prompt completed.
4. During Strok Point Setting
  - ① It can only be used after the up/down limit point has been set, and the up/down limit point and the third limit point cannot be in the same position.
5. The maximum running time is 3 minutes and it will stop automatically after the time is up when there is no other operation on the motor.
6. Please follow the operation steps to do code match again and re-set the Strok of the new remote after the previous remote lost.
7. A motor can store up to 20 remote channels. The last channel of the motor will be cyclically covered if there is a new remote channel is added after 20 channels are stored.

## Button Instruction

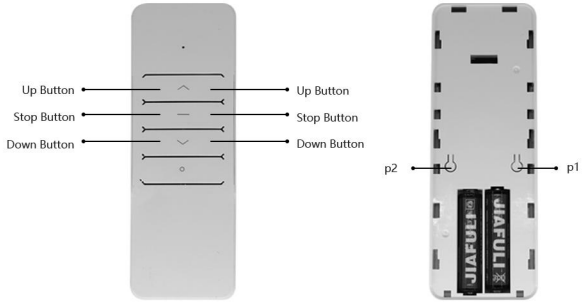
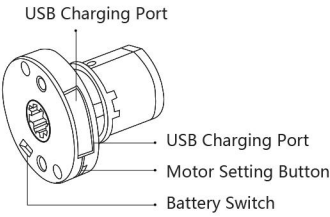

\* Toggling the lithium battery switch, " 0 " means to close the switch, " 1 " means to open the switch.



Basic Setting  
Steps 1-3 must be completed to ensure proper operation.

## Match Code

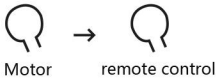

- 1.1. Press the motor [match code] button 3 seconds, the green LED of motor is bright means that entering the match code state.
- 1.2. Press the [match code] in the back of remote control within 5 seconds, The motor shakes once and the LED is off means the match code successfully.

## Setting the limit

### 2.1 Setting the upper limit



- 2.1.1 Press the [match code] button in the back of remote control, the motor shakes once and the LED is bright means that entering the setting limit state.
- 2.1.2 Press the [ up/open] button of remote control, the motor up running, while the motor running your setting upper limit site around, press the [stop] button, the motor will stop running.
- 2.1.3 Short press the remote control [up/open] button can make the blinds up a small step about 2-3mm, or press the remote control [down/close] button can make the blinds down a small step about 2-3mm, this way can make the motor up to your setting site exactly.
- 2.1.4 Press the [match code] button in the back of remote control again, the green LED of motor flashes 5 time means the upper limit site was setting successfully.

### 2.2 Setting the down limit site



- 2.2.1 Press the [match code] button in the back of remote control, the motor shakes once and the LED is bright means that entering the setting limit state.
- 2.2.2 Press the [ down/close] button of remote control, the motor down running, while the motor running your setting down limit site around, press the [stop] button, the motor will stop running.
- 2.2.3 Short press the remote control [up/open] button can make the blinds up a small step about 2-3mm, or press the remote control [down/close] button can make the blinds down a small step about 2-3mm, this way can make the motor up to your setting site exactly.
- 2.2.4 Press the [match code] button in the back of remote control again, the green LED of motor flashes 5 time means the down limit site was setting successfully.

2.3 Setting third limit site (It can be set when the third limit site haven't been set)

2.3.1 Press the [up/open] button,[down/close] button and [stop] button of remote control,let the blinds run to your desired position

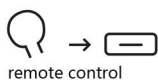

2.3.2 Press the [match code] button in the back of remote control,the motor shakes once and the LED is bright means that entering the setting limit state

2.3.3 Press the remote control [stop] button 2 seconds,The motor shakes once and the LED is flashes 5 times then off, Setting the position currently is the third limit site.After that only need to press the remote control [stop] 2 seconds , the motor will run to the third limit site

## Correct the motor steering

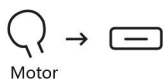

Because while installing the blinds, it can be installed either right or left,therefore the steering of motor needs to be corrected. If press the remote control [up/open] button,the blinds not being raise but falls, through the operation of reversing can correct the motor steering.

Press the motor [match code] button about 3 seconds, the green LED of motor is bright means that entering the match code state.

3.2 Press the remote control [stop] button in 5 seconds, the motor shakes once and the LED flashes 3 time means correcting steering successfully.

## Delete the all remote control code

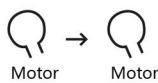

4.1 Press the motor [match code] button about 3 seconds, the green LED of motor is bright means that entering the match code state.

4.2 Release the motor [match code]button within 5 seconds,and press the motor [match code] about 3 seconds immediately, the motor shakes once and LED flashes 4 time means deleting the all remote control code successfully.

## Venetian blinds/ roller blinds mode switch

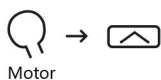

5.1 Press the motor [match code] button about 3 seconds,the green LEDof motor is bright means that entering the match code state.

5.2 Press the remote control [up] button with 5 seconds,the motor shakes once and the LED flashes 3 times means Venetian blinds/roller blinds mode switch successfully,if If you are currently in roller blinds mode and switch modes, you will enter Venetian blinds mode,If you are currently in Venetian blinds mode and switch modes,you will enter roller blinds mode.

Circuit board usually default to roller blinds mode,In roller mode,if you setting the route,press the remote control [up] or [down] button can run the motor continuously.

In the Venetian blinds mode, if you setting the route, press the remote control [up] or [down] button,The motor performs the page turning operation; press [up] or [down] button about 2 seconds, the motor will run continuously.

## Delete the stroke



Press the remote control [match code] button 2 times continuously, the motor shakes 2 time and LED bright, then press the remote control [ stop] button immediately, the motor will shake once again and LED flash 2 times will extinguish,it means delete the stroke successfully.

## Delete the third limit site

(It can be delete when the third limit site haven been set)



remote control

7.1 Press the [match code] button in the back of remote control,the motor shakes once and the LED is bright means that entering the setting limit state

7.2 Press the remote control [stop] button 2 seconds,The motor shakes once and the LED is flashes 5 times then off, deleting the third limit site

## Selecting the motor speed



remote control   remote control

### 8.1 Increasing the speed

Press the [match code] button of remote control 2 times continuously,the motor shakes once and the LED is bright, then press the [up] button of remote control immediately,The speed will be increased in the order of 60rpm->70rpm->80rpm. LED flashed 2 times means the speed is 70rpm, flashed 3 times means the speed is 80rpm.



remote control   remote control

### 8.2 Decreasing the speed

Press the [match code] button of remote control 2 times continuously,the motor shakes once and the LED is bright, then press the [down] button of remote control immediately,The speed will be decreased in the order of 80rpm->70rpm->60rpm. LED flashed 2 times means the speed is 70rpm, flashed once means the speed is 60rpm.

Quick Index

|    | Function                              | Step   |                                    |
|----|---------------------------------------|--|------------------------------------|
| 1  | Match Code                            | P1(Press and hold for 2 seconds) P2→P2→Up/Down |                                    |
| 2  | Reversing Settings                    | P1(Press and hold for 11 seconds)→P1           |                                    |
| 3  | Limit Settings                        | Up   |                                    |
| 4  | Jog/Consecutive Mode Switching        | P2→Up→Down                                     |                                    |
| 5  | Setting/Delete Third Limit Point      | P2→Stop→Stop                                   |                                    |
| 6  | Manual Settings Open/Close The Border | Manual Setting To Open The Border              | P2→Up→Up                           |
|    |                                       | Manual Setting To Close The Border             | P2→Down→Down                       |
| 7  | Delete A Emitter                      | P2(a)→P2(a)→P2(b)                              |                                    |
| 8  | Clearing Limit                        | P2→Down→P2                                     |                                    |
| 9  | Open/Close Wireless Receiver Function | P1(Press and hold for 6 seconds)→P1            |                                    |
| 10 | Adjust Running Velocity               | 1 Acceleration Setting                         | P2→Up→Stop                         |
|    |                                       | 2 Deceleration setting                         | P2→Down→Stop                       |
| 11 | Switch To Storage Mode                | 1 Normal Mode                                  | Dip switch to 1                    |
|    |                                       | 2 Storage Mode                                 | Dip switch to 0→Dip switch to 1→P1 |
| 12 | Factory Data Reset                    | P1(Press and hold for 14 seconds)              |                                    |

Common Problems and Solutions

| Problem       | Reason   | Solution                               |
|---------------|--|--|
| Motor Failure | Battery not activated  | Activate the Motor after Charged Fully |
|               | Emitter has not finish the code match  | Doing Wireless Code Alignment          |
|               | If there is no reaction after long press the motor setting button, the power supply is short circuit, the circuit board is damaged or the motor is damaged | Contact After-sales Service            |

FCC Warning

This device complies with part 15 of the FCC Rules. Operation is subject to the following two conditions:  
(1) This device may not cause harmful interference, and (2) this device must accept any interference received, including interference that may cause undesired operation.

Any Changes or modifications not expressly approved by the party responsible for compliance could void the user's authority to operate the equipment.

**Note:** This equipment has been tested and found to comply with the limits for a Class B digital device, pursuant to part 15 of the FCC Rules. These limits are designed to provide reasonable protection against harmful interference in a residential installation. This equipment generates uses and can radiate radio frequency energy and, if not installed and used in accordance with the instructions, may cause harmful interference to radio communications. However, there is no guarantee that interference will not occur in a particular installation. If this equipment does cause harmful interference to radio or television reception, which can be determined by turning the equipment off and on, the user is encouraged to try to correct the interference by one or more of the following measures:

- Reorient or relocate the receiving antenna.
- Increase the separation between the equipment and receiver.
- Connect the equipment into an outlet on a circuit different from that to which the receiver is connected.
- Consult the dealer or an experienced radio/TV technician for help.

This equipment complies with FCC radiation exposure limits set forth for an uncontrolled environment. This equipment should be installed and operated with minimum distance 20cm between the radiator & your body.