

# Manual de APP Lotus Lantern

Nombre del producto	Lotus Lantern
Sistema de apoyo	Android 4.3 y superior / IOS 8.0 y superior
Modo de señal	Bluetooth 5.2
Mando a distancia	Mando a distancia de 20/24 teclas
Voltaje de entrada	5-24V
USO	Comercial

## 1.Descripción del producto

### 1.1 Visión general

Lotus Lantern es un programa de aplicación móvil que utiliza un teléfono móvil Apple o Android para controlar las tiras LED. El método de control del teléfono móvil sustituye a los tradicionales infrarrojos, 433, 2.4G y otros antiguos métodos de control remoto, que es conveniente, rápido, potente y extensible. El color, el brillo y la temperatura de color de la tira de luz LED pueden ser inteligentemente controlados a través de la APP del teléfono móvil, y se pueden establecer varios modos de parpadeo, y la tira de luz LED puede ser rítmica con el ritmo de la música. Solo tiene que mantener las tiras de luz LED encendidas, abrir el teléfono móvil Lotus Lantern APP software de control inteligente, y conectar una o más tiras de luz LED a través de Bluetooth, a fin de realizar diversos ajustes y el control de múltiples tiras de luz LED. El funcionamiento es muy sencillo, fácil de aprender y utilizar.

### 1.2 Rendimiento

El Lotus Lantern App tiene una buena facilidad de uso y compatibilidad, la prueba real y verificación olhundreds de teléfonos móviles es compatible con más del 95% de los teléfonos móviles actualmente en el mercado. La aplicación es pequeña y cómoda, ocupa menos recursos del sistema y tiene pocos requisitos de configuración del teléfono móvil. El retardo de control es pequeño, la sensación de funcionamiento es buena y el control de la luz tiene una alta sensación visual.

## 2、Instrucciones

Nota: La versión de Android y la versión de IOS son básicamente las mismas para descargar y utilizar. Aquí, la versión de Android se utiliza como un ejemplo para la explicación.

### 2.1 Descarga de la APP

Tanto los sistemas iOS como Android pueden descargar la App "Lotus Lantern" escaneando el código QR. Abra el navegador:QQ,WeChat y otras herramientas de programa con la "función de escaneo, y escanee el código QR de "Lotus Lantern".



Después de que el software se ha instalado y descargado correctamente, haga clic en APK para instalar. Después de theinstallation se ha completado, el icono del programa de estilo anterior aparecerá en el escritorio.

## 2.2 Ejecución del software

1、Haga clic en el icono de la APP "Lotus Lantern" para entrar en la página de la APP:



3、Cambia a la paleta de colores interace:

Mostrar lista de luces  
rueda de Color del  
interruptor

Interfaz de ajuste del  
valor RGB

Vista del interruptor

4、Pulsa en la lista de dispositivos para  
ver el dispositivo:



Dispositivo conectado  
Dispositivo desconectado

2、Después de entrar en la interfaz APP si Bluetooth no está activado, aparecerá "Una aplicación quiere activar la función Bluetooth de este dispositivo". Haga clic en [Permitir]:



5、Pulsa el botón de ajuste RGBpara entrar en la interfaz de ajuste manual del valor RGB:



6、Cambiar a la interfaz de modo



7、Cambia a la interfaz de música:

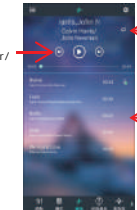

8、Cambia a la interfaz de música online :

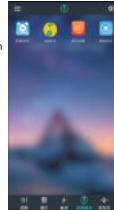

9.Cambia a la interfaz de temporización:

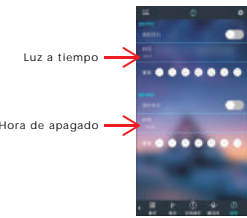

10、Cambia a la interfaz de ritmo de microfono:

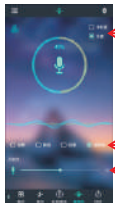

11、Cambia a la interfaz de ajuste de línea:

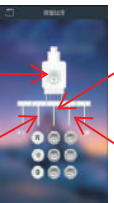

Ritmo musical a través del microfono del móvilel microfono del producto.

# Lotus Lantern APP Manual

Product name	Lotus Lantern
Support system	Android 4.3 and above / IOS 8.0 and above
Signal mode	Bluetooth 5.2
Remote control	20/24key remote control
Input voltage	5-24V
Use	Commercial

## 一、Product Description

### 1.1 Overview

Lotus Lantern is a mobile APP program that uses an Apple or Android mobile phone to control LED strips.

The mobile phone control method replaces the traditional infrared, 433, 2.4G and other old remote control methods, which is convenient, fast, powerful and extensible!

The color, brightness, and color temperature of the LED light strip can be intelligently controlled through the mobile phone APP, and various flashing modes can be set, and the LED light strip can be rhythmic with the rhythm of the music. You only need to keep the LED light strips powered on, open the mobile phone Lotus Lantern APP intelligent control software, and connect one or more LED light strips via Bluetooth, so as to realize various settings and control of multiple LED light strips. The operation is very simple, easy to learn and use!

### 1.2 Performance

The Lotus Lantern APP has good ease of use and compatibility. The actual test and verification of hundreds of mobile phones is compatible with more than 95% of the mobile phones currently on the market. The APP is small and convenient, occupies less system resources, and has low requirements for mobile phone configuration. The control delay is small, the operation feel is good, and the light control has a high visual feel.

## 二、Instructions

Note: The Android version and IOS version are basically the same for downloading and using. Here, the Android version is used as an example for explanation.

### 2.1 APP Download

Both iOS and Android systems can download the "Lotus Lantern" APP by scanning the QR code. Open the browser, QQ, WeChat and other program tools with the "scan" function, and scan the "Lotus Lantern" QR code.



After the software is successfully installed and downloaded, click APK to install. After the installation is complete, the above style program icon will appear on the desktop.

## 2.2 Software Running

1、Click the icon of "Lotus Lantern" APP to enter the APP page:



2、After entering the APP interface, if Bluetooth is not turned on, it will pop up "An application wants to turn on the Bluetooth function of this device". Click [Allow]:



3、Switch to the color palette interface:

Show light list  
Switch color  
wheel

RGB value adjustment  
interface

Switch view

4、Click on the device list to view the  
device:



Device connected  
Device disconnected

5、Click the RGB adjustment button to enter the manual adjustment RGB value interface:



6、Switch to the mode interface:



7、Switch to the music interface:

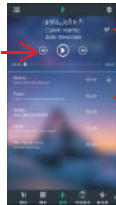

8、Switch to the online music interface :



9、Switch to the timing interface:

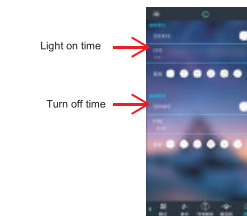

10、Switch to the microphone rhythm interface:



11、Switch to the line adjustment interface:



Music rhythm through mobile microphone / the microphone on the product.

## FCC Warning

This device complies with Part 15 of the FCC Rules. Operation is subject to the following two conditions:

(1) This device may not cause harmful interference, and (2) this device must accept any interference received, including interference that may cause undesired operation.

NOTE 1: This equipment has been tested and found to comply with the limits for a Class B digital device, pursuant to part 15 of the FCC Rules. These limits are designed to provide reasonable protection against harmful interference in a residential installation. This equipment generates, uses and can radiate radio frequency energy and, if not installed and used in accordance with the instructions, may cause harmful interference to radio communications. However, there is no guarantee that interference will not occur in a particular installation. If this equipment does cause harmful interference to radio or television reception, which can be determined by turning the equipment off and on, the user is encouraged to try to correct the interference by one or more of the following measures:

- Reorient or relocate the receiving antenna.
- Increase the separation between the equipment and receiver.
- Connect the equipment into an outlet on a circuit different from that to which the receiver is connected.
- Consult the dealer or an experienced radio/TV technician for help.

NOTE 2: Any changes or modifications to this unit not expressly approved by the party responsible for compliance could void the user's authority to operate the equipment.

## RF Exposure Statement

To maintain compliance with FCC'S RF Exposure guidelines, This equipment should be installed and operated with minimum 20cm between the radiator and your body. This device and its antenna(s) must not be co-located or operation in conjunction with any other antenna or transmitter.