

manual

Models: BT-X



Made in China

How to wear

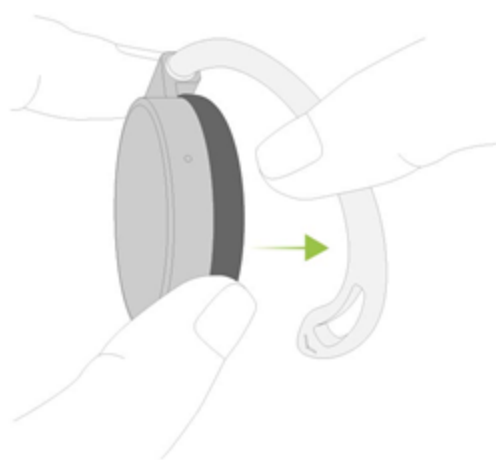

STEP 1

Open the ear-hook at 30° angle

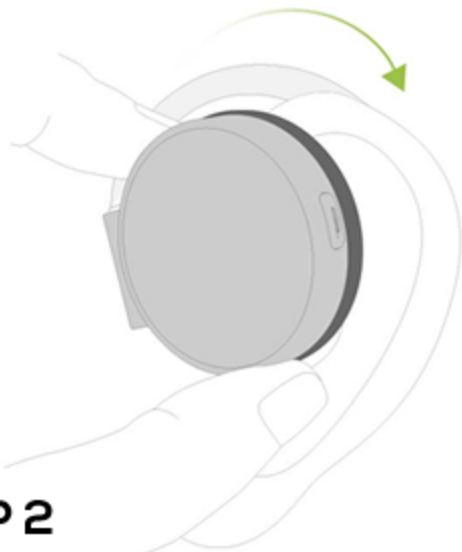

STEP 2

Rotate around the ear to the bottom of the ear-hook

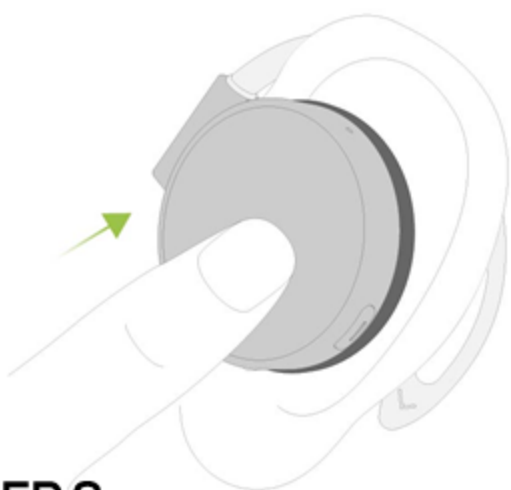

STEP 3

Press the headphones and clamp the ears tightly



STEP 4

Adjusting the angle to make wearing more comfortable

Bluetooth pairing

STEP 1



Open the charging case, and the BT-X headset's green light will flash, entering pairing mode.

STEP 2



Music Mode



▶|| Play/Pause: Click x1

LEFT

🔊- Hold

▶▶ Click x2

RIGHT

🔊+ Hold

◀◀ Click x2

Call mode



Answer/end call : Click x1



Reject call (hold)



Mute (in a call) : Click x2

There is a prompt sound when double-clicking

LEFT

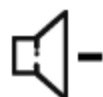

Hold

RIGHT



Hold

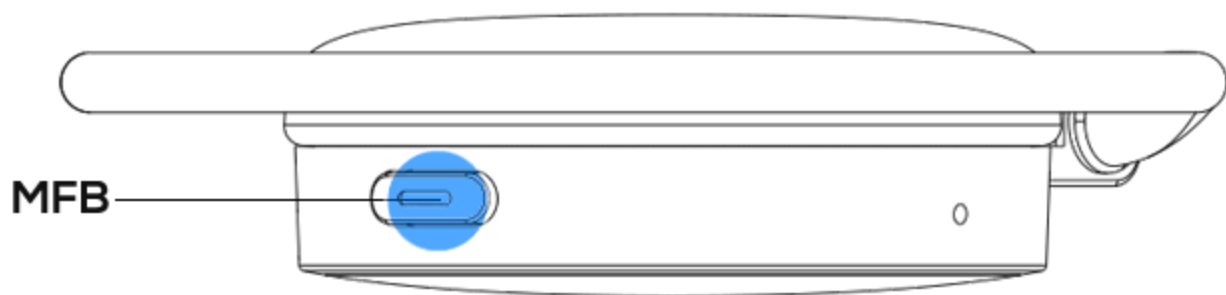

Language switching(EN/JP)

1. Disconnect Bluetooth
2. Double-click on the MFB button to exchange language between English and Japanese

LED light sport mode

led off / on : Click x3



Reset

When the power is turned on and Bluetooth is not connected, press and hold the MFB button for 3 sec. to reset and clear the pairing record.

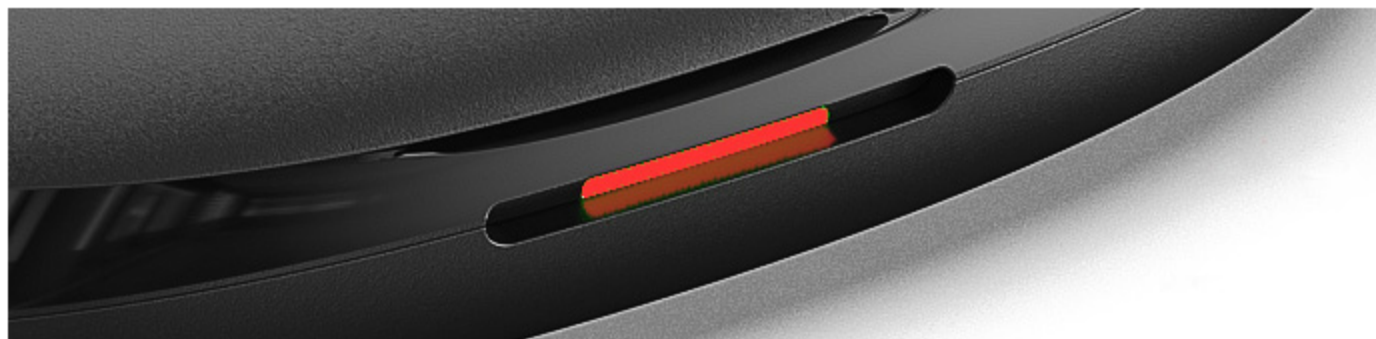

Charging case indicator light

Charging : Red light flashes slowly

Fully Charged : Red light is always on



Headphone Charging indicator light

Charging : Green light is always on

Fully Charged : Green light is off

When the charging case is fully charged, the headset can be charged repeatedly about 3~5 times.

Warning

- 1, Contains non-replaceable Li-ion polymer battery.
- 2, Do not force disassemble, heat above (manufacturer's specified temperature rating) or incinerate.
- 3, Please use 5V voltage and 1A charging cable to charge the headphones

Avertissement

- 1, Contient une batterie polymère Li-ion non remplaçable.
- 2, Ne forcez pas le démontage, ne chauffez pas au-dessus de la température spécifiée par le fabricant ou n'incinerez pas.
- 3, Veuillez utiliser un câble de charge de 5V et 1A pour charger les écouteurs.

Warnung

- 1, Enthält einen nicht austauschbaren Li-Ion-Polymer-Akku.
- 2, Nicht gewaltsam zerlegen, nicht über die vom Hersteller angegebene Temperatur erhitzen oder verbrennen.
- 3, Bitte verwenden Sie ein 5V und 1A Ladekabel zum Aufladen der Kopfhörer.

Avvertimento

- 1, Contiene una batteria al polimero di Li-ion non sostituibile.
- 2, Non smontare con forza, non riscaldare sopra la temperatura specificata dal produttore o incenerire.
- 3, Si prega di utilizzare un cavo di ricarica da 5V e 1A per caricare le cuffie.

Advertencia

- 1, Contiene una batería de polímero de Li-ion no reemplazable.
- 2, No desmonte a la fuerza, no caliente por encima de la temperatura especificada por el fabricante o incinere.
- 3, Por favor, use un cable de carga de 5V y 1A para cargar los auriculares.

General info

Box contents : Headset, USB-C cable, Manual

Warranty: 1 year limited warranty

Audio

Microphone type: 4 x MEMS

Noise reduction on calls: Yes

Speaker size: 28mm | 1.1in

Speaker frequency range: 20Hz - 20000Hz

Microphone sensitivity : $-42\pm 1\text{dB}$ ($0\text{dB}=1\text{V/Pa}$, at 1KHz)

Connectivity

Connectivity : Laptop, Phone, Tablet

Battery

Battery type : Rechargeable lithium-ion batter

Design

Ear Clip Headphones/ Open Ear Headphones

Register your product.

Register and activate the after-sales service guarantee within 7 working days of receiving the product and you can extend the warranty for 180 days free of charge.

How to register ?

Send your order number to email : vipsevice@163.com

SPECIFICATIONS

NAME: HEADSET

MODEL : DY20PLUS

HEADPHONE BATTERY:230MAH

WIRELESS RANGE : 10~20M

CHARGE TIME: 2H

CHARGEING VOLTAGE: 5V/1A

MANUFACTURER

DONGGUAN QIANDO ELECTRONICS CO., LTD

10TH FLOOR, BLOCK B, JINHUI BUILDING,
HUAIBEI ROAD, HUAIDE COMMUNITY,
HUMEN TOWN,DONGGUAN CITY,
GUANGDONG PROVINCE

vipsevice@163.com

© 2024 . All rights reserved.



FCC Warning:

This equipment has been tested and found to comply with the limits for a Class B digital device, pursuant to part 15 of the FCC Rules. These limits are designed to provide reasonable protection against harmful interference in a residential installation. This equipment generates, uses and can radiate radio frequency energy and, if not installed and used in accordance with the instructions, may cause harmful interference to radio communications. However, there is no guarantee that interference will not occur in a particular installation. If this equipment does cause harmful interference to radio or television reception, which can be determined by turning the equipment off and on, the user is encouraged to try to correct the interference by one or more of the following measures:

- Reorient or relocate the receiving antenna.
- Increase the separation between the equipment and receiver.
- Connect the equipment into an outlet on a circuit different from that to which the receiver is connected.
- Consult the dealer or an experienced radio/TV technician for help.

Caution: Any changes or modifications to this device not explicitly approved by manufacturer could void your authority to operate this equipment.

This device complies with part 15 of the FCC Rules. Operation is subject to the following two conditions:

(1) This device may not cause harmful interference, and (2) this device must accept any interference received, including interference that may cause undesired operation.

This equipment complies with FCC radiation exposure limits set forth for an uncontrolled environment. This equipment should be installed and operated with minimum distance 0cm between the radiator and your body.