



USER MANUAL

— MODEL NO:G3 —



*Unlock the Future with Our Smart Lock:
Security Meets Convenience*

Please read this manual carefully before using the lock
Please take good care of this manual for reference after reading

FOR USERS IMPORTANT

Thank you for choosing DEVO smart lock

In order to ensure the ease of use and safety of our products, we have prepared this manual to help you better understand DEVO Smart Lock.

Thank you for purchasing a "DEVO" smart lock. Considering the continuous improvement and updating of our products, the actual products may be slightly different from the pictures in this manual, please refer to the actual products!

DEVO smart lock is popular among users for its unique appearance, advanced and reliable technology and considerate after-sales service. Our smart locks have been tested for reliability and functionality. Ambient light test, temperature test, etc. constitute the leading and unique advantages of smart locks.

Our company has established a complete intelligent R&D, manufacturing and sales system. All smart locks are independently developed by the company. We sincerely invite you to share with us your experience of use and opinions of improvement, which will help us to improve our products.

CONTENTS

• • •	Hardware Introduction	01-03
• • •	Compatible Doors	04
• • •	Parts List	05-06
• • •	Product Dimension	07-08
• • •	Installation Overview	09-20
• • •	Programming Instructions	21-32
• • •	Troubleshooting	33-34
• • •	Product Parameters	35-36

1/ Hardware Introduction

(1) Overview

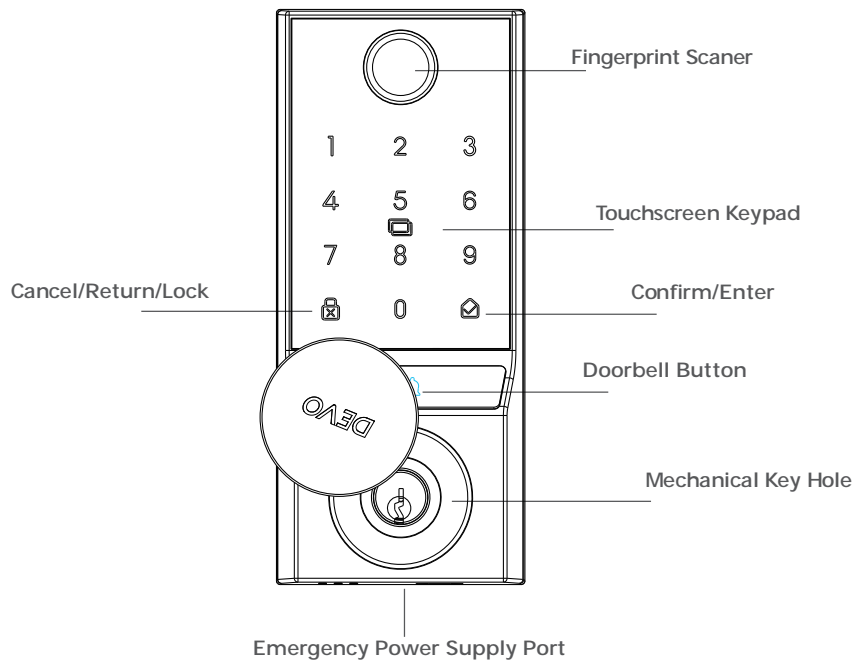

Notes: The "Emergency Power Supply Port" is not for battery charging purpose and can only be used for emergency power supply to the lock.

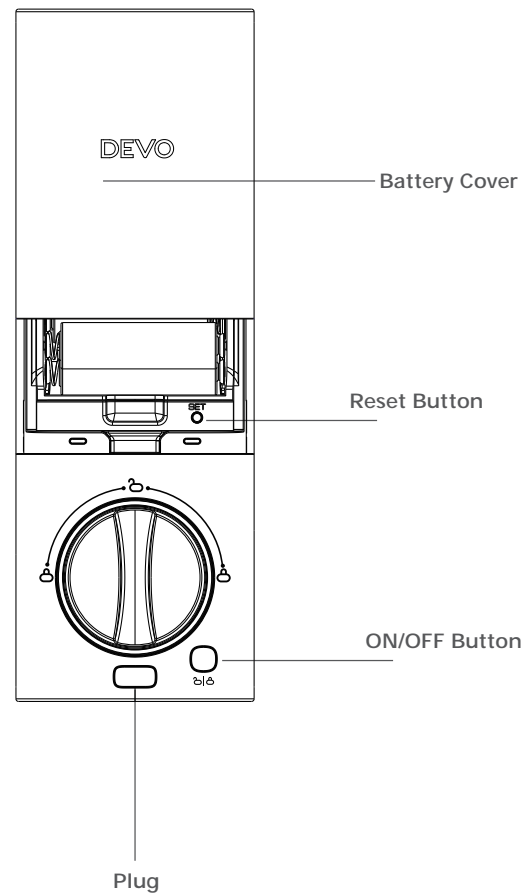

(2) How To Open / Close Lock Cylinder Cover

Press and hold the Lock Cylinder Cover and turn it clockwise/counterclockwise to open it.

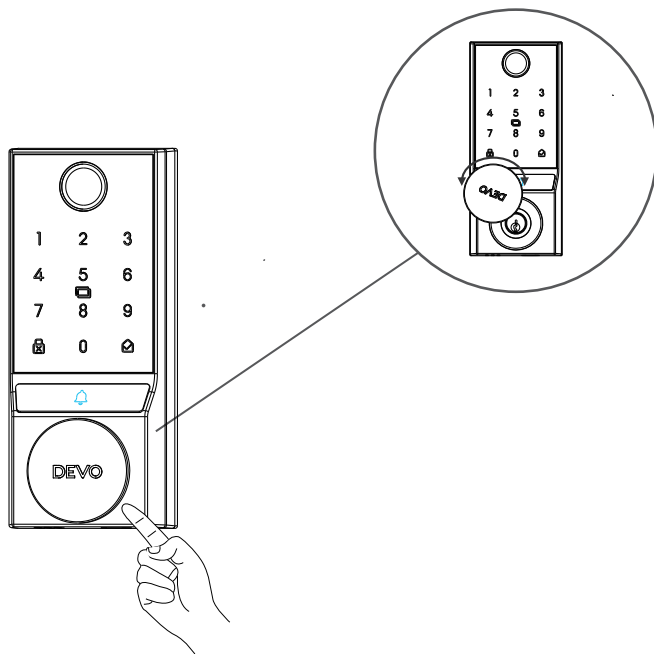

2 / Compatible Doors

Compatible Doors

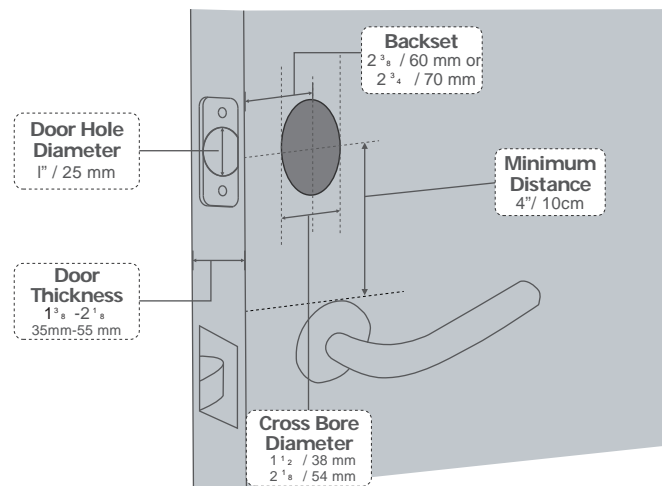

3 / Parts List

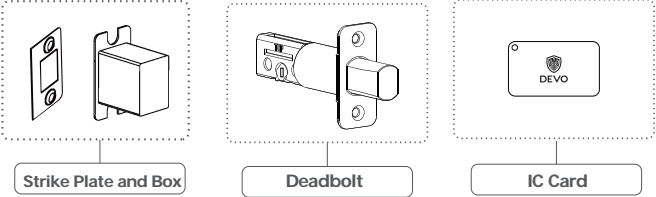
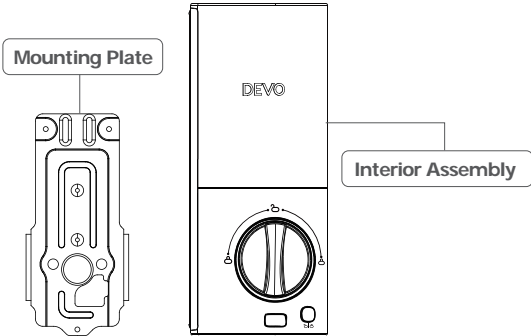
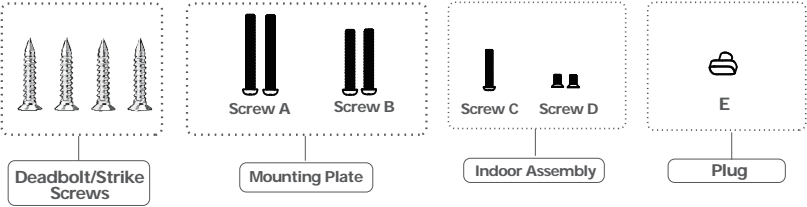
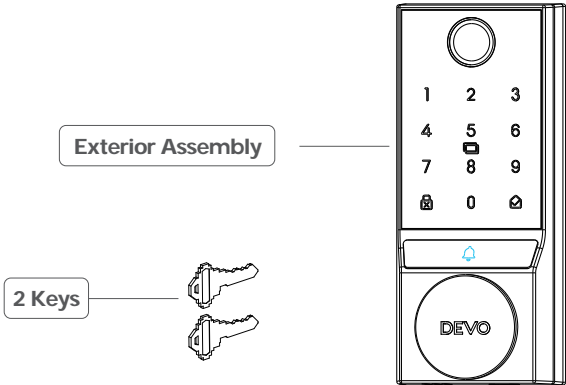

4 / Product Dimension

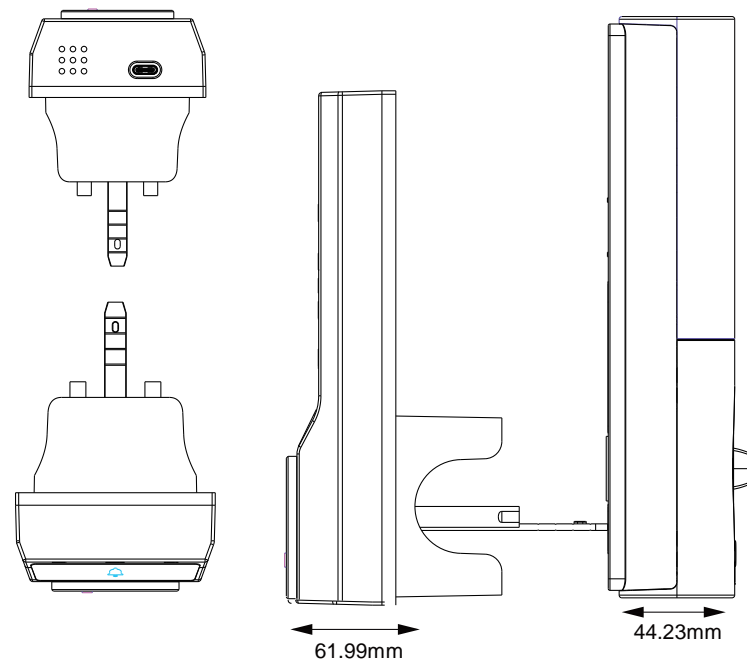
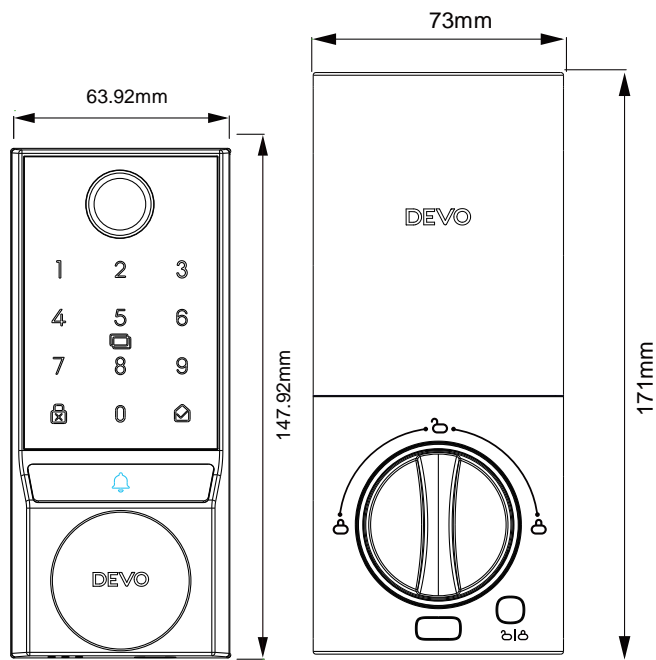

5/ Installation Overview

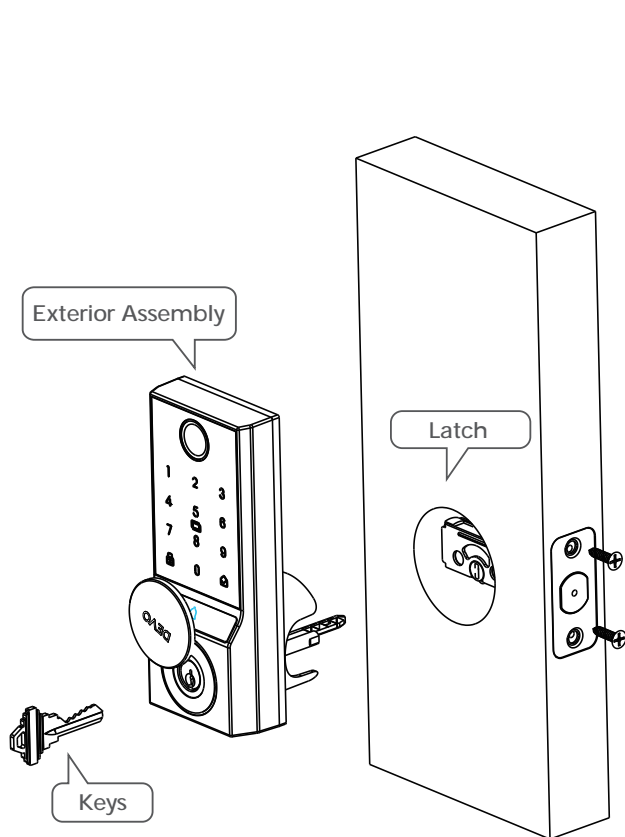

*45-55mm door thickness use **A**

*35-45mm door thickness use **B**

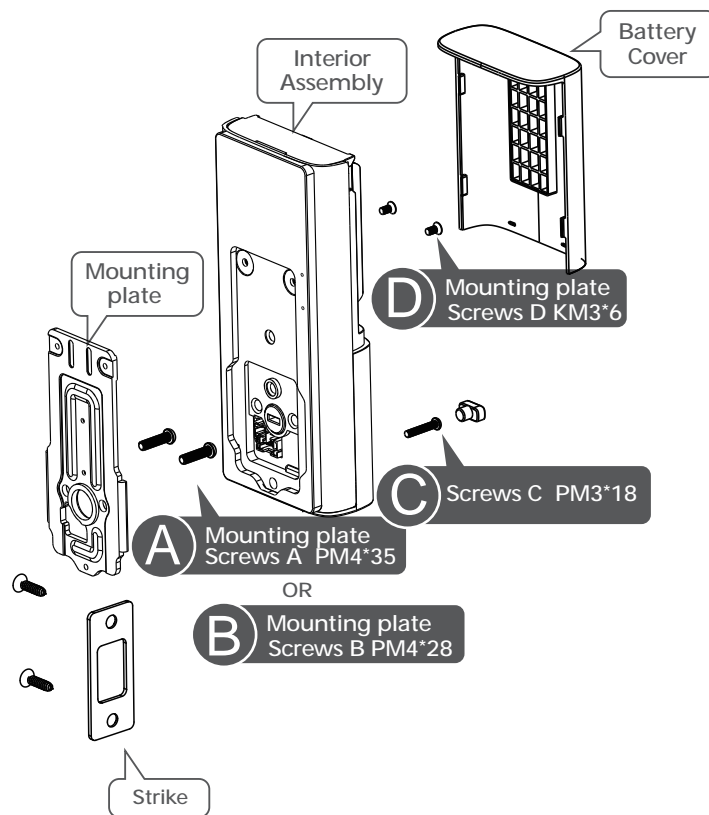

Step 1. Install Deadbolt

(1). Check your door to see if the deadbolt requires adjustment.

If the backset is 70mm, turn the faceplate 180° to extend the length.

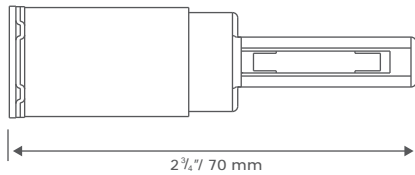
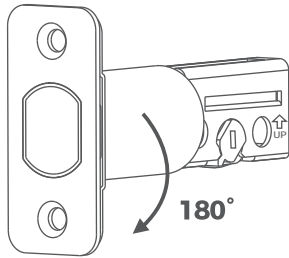
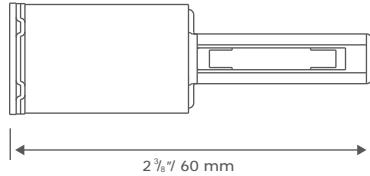

(2). Insert and screw the deadbolt into the doorframe.

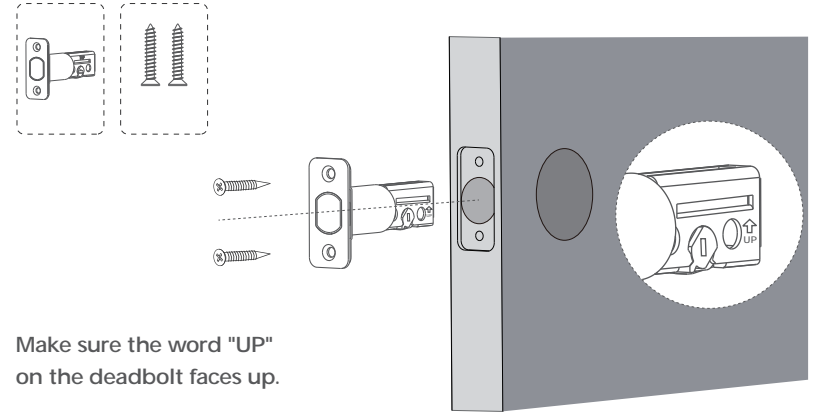

Step 2. Install Strike Plate

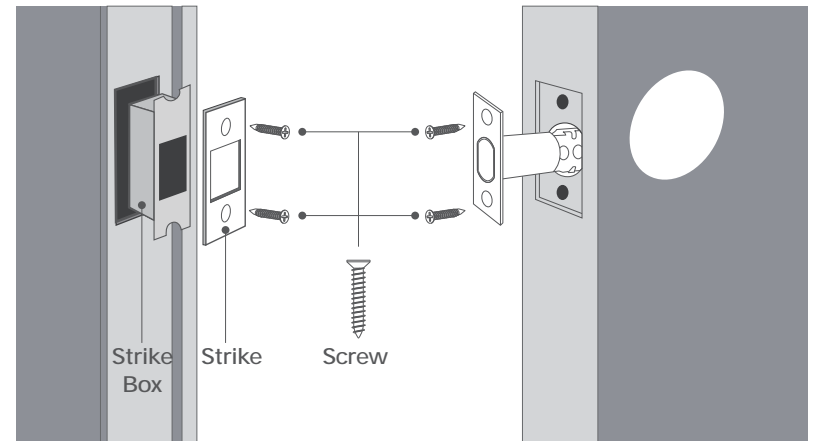

Step 3. Install Exterior Assembly

Remember to attach the rubber gasket to the handle before Installation.

(1). Measure your cross bore dimension and determine the installation steps accordingly

- If the cross bore of your door is 1 ½" / 38mm", please remove the adapter.
- If the cross bore of your door is 1 ¾" / 54mm", please keep the adapter.

(2). Route the cable connected on the exterior assembly under the Latch. Make sure the tailpiece is Vertically to the exterior assembly bottom, as the illustration shows.

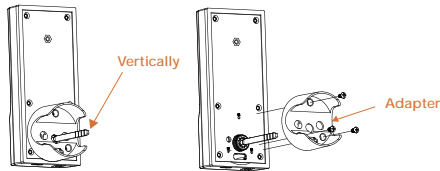
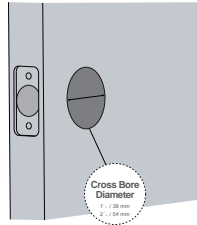

Step 4. Install Interior Assembly

(1). Detach the back cover from the interior assembly.

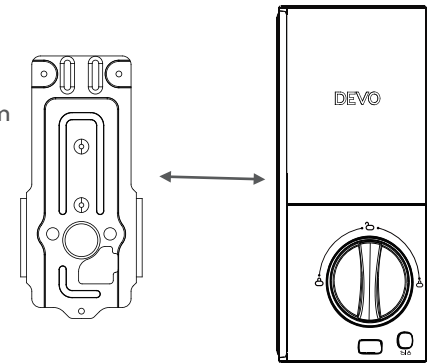

(2). Run the wires through the back cover.

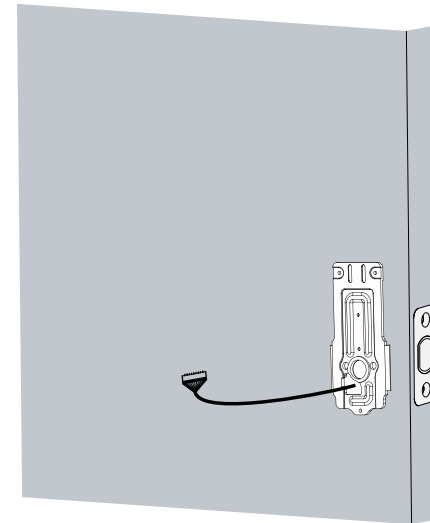



45-55mm door
thickness use A



35-45mm door
thickness use B

(4). Tightly fasten the screws
in place. Set the screws
with your hands, then use
a screwdriver to secure
them.

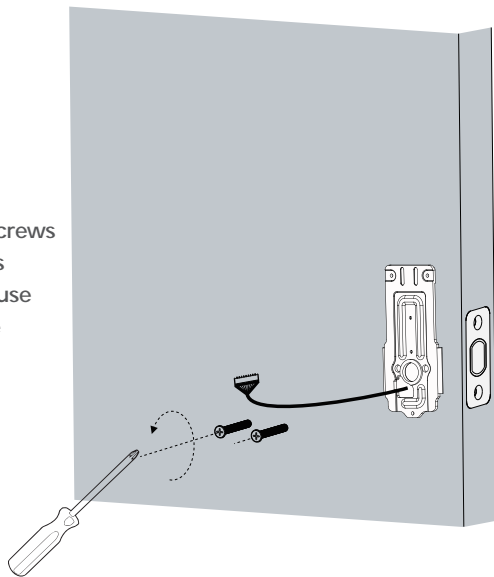

(3). Secure the back cover with screws.

Important:Please select Screw A ,Screw B based on
the thickness of the door(35mm-55mm)

- 1.Thickness of Screw A compatible doors:45-55mm
- 2.Thickness of Screw B compatible doors:35-45mm

(5). Fix the exterior assembly by the double-sided tape.

(6). Wire to the interior assembly.

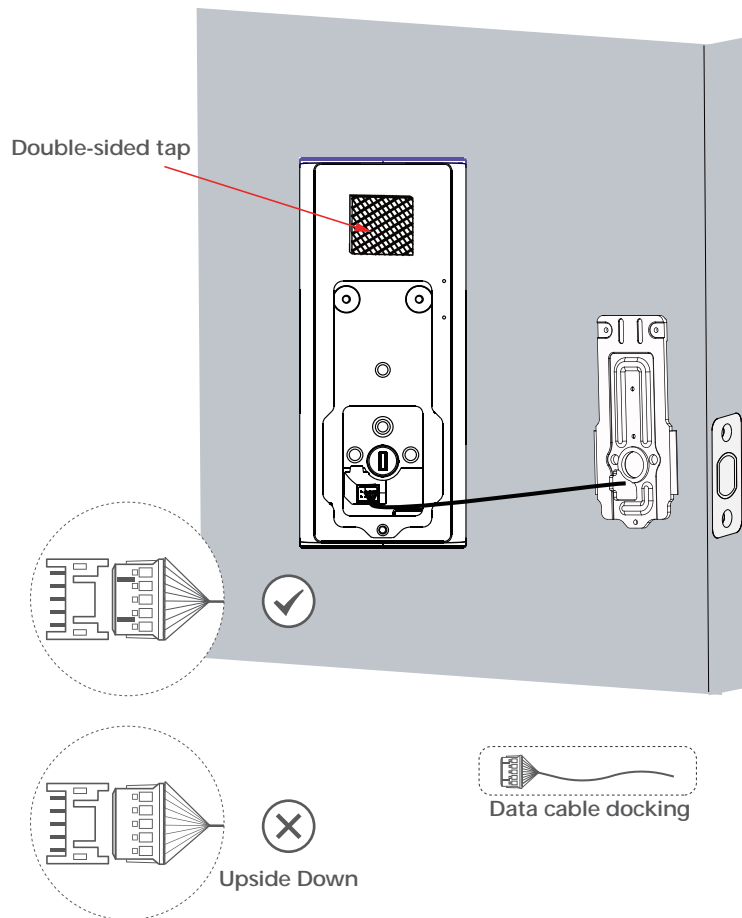

(7) Mount the interior assembly. Make sure the wire is tucked into the cabin on the back of the interior assembly.

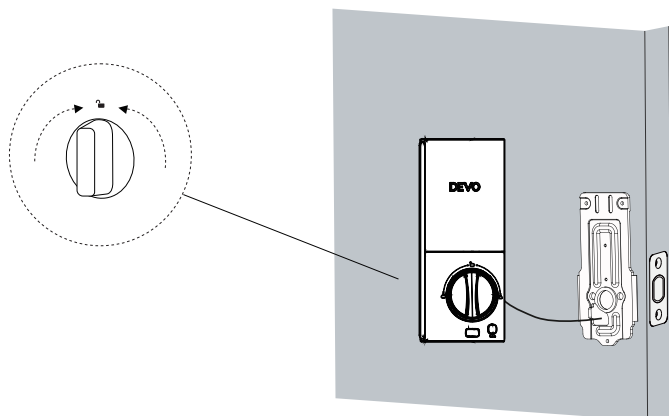

(8) Check if the deadbolt retracts by turning the thumbturn.

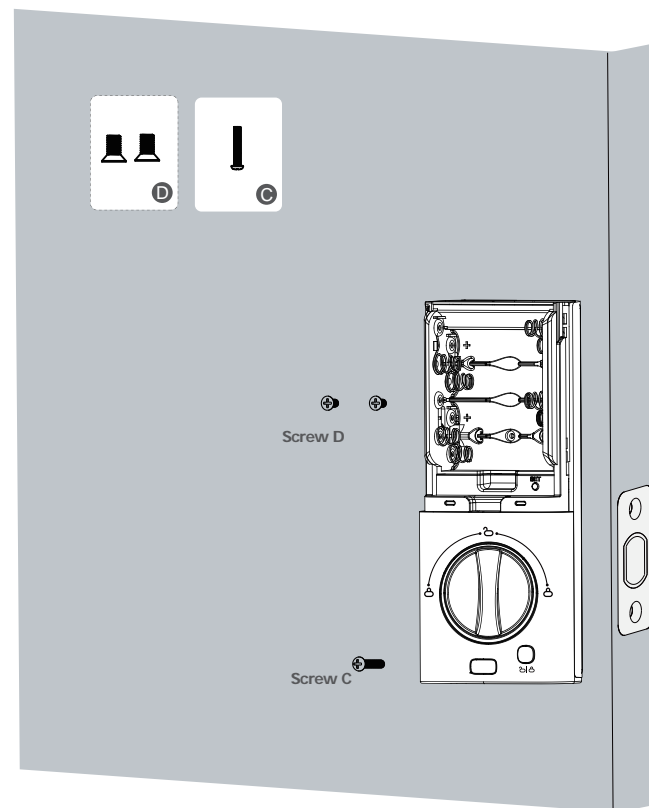
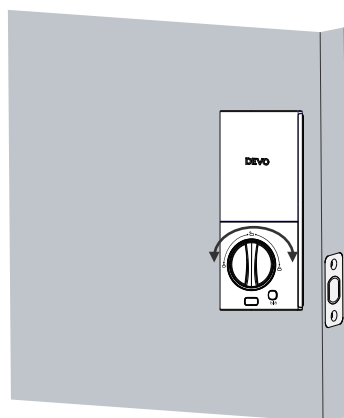

(9). Install 8 AA batteries into the door lock and it is ready to be used.

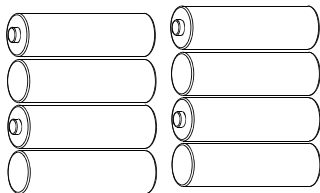

(10). Pay attention to the placement direction of the positive and negative poles of the battery when installing it.

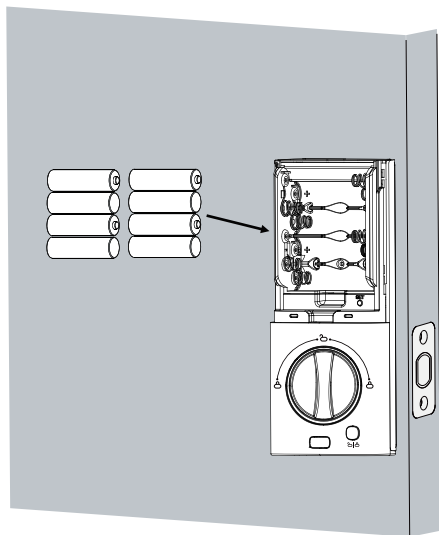

Apart from being able to configure your door lock through the app, you can also directly set the relevant settings on the door lock following the instructions below.

(1). Smart Lock Powered on

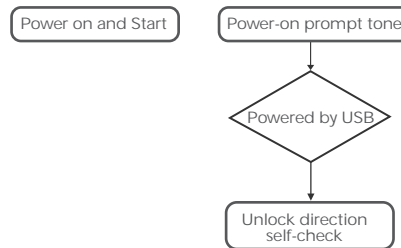

The smart lock self-checks the unlocking direction when powered on. After the self-check is completed, the lock will be closed.

6/ Programming Instructions

(1). User Type

Type	Capacity	Description
Administrator	1	<ul style="list-style-type: none">• Sequence ID 1• Unlock• Management
Regular User	199	<ul style="list-style-type: none">• Sequence ID 2-200,• Unlock, (Invalid when the Anti-lock is On)
Total	200	<ul style="list-style-type: none">• Fingerprint Capacity: 100• Passcode Capacity: 50• IC Capacity: 50

(2). Enter The Function Settings Mode

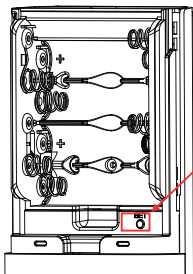

Short press the "Settings" button. You will hear a voice prompt saying, "Please verify administrator user." Enter the correct administrator password, then press the "unlock" button to confirm. If the password verification is successful, you will enter the setting mode.

Notes: When the automatic locking is turned on, the lock enters the unlocked state. After the set time, the lock will automatically close.

(3). Setting Mode Function List

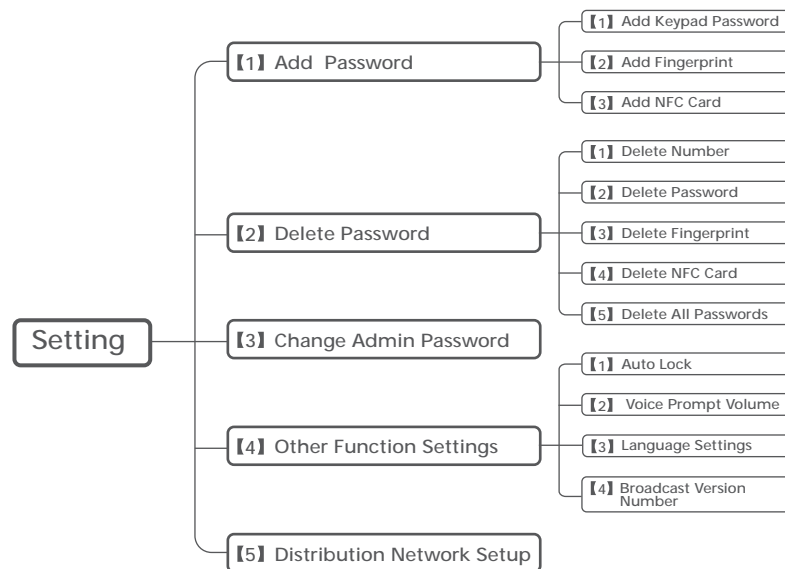

(4). Restore Factory Settings

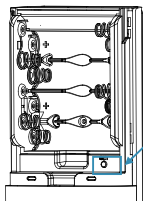

- 1. Press and hold the "Set" button. After 4 seconds, the lock will start to make a "dong" sound (7 times).
- 2. Press and hold the button until you hear a voice prompt: To confirm, press the unlock button "🔓".
- 3. Press the unlock button within 4 seconds and you will hear a voice prompt: Factory reset successful.



(5). Set Administrator Password

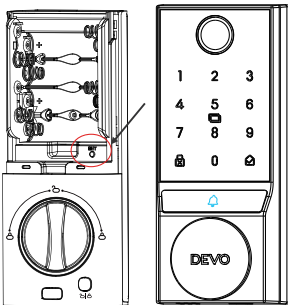

- Step1:** Press the setting button. If no administrator password has been set before, you will hear a voice prompt: Please set the administrator password.
- Step2:** After input the administrator password, press the unlock button to confirm.
- Step3:** Follow the voice prompt instructions, enter the administrator password again, and press the unlock button to confirm.

(6). Others

- 1. There are 5 consecutive trial and error opportunities for fingerprints and passwords within 5 minutes, and will be locked for one minute after exceeding the limit
- 2. After the ultra-low power alarm, the motor cannot work. load condition If the battery power is lower than 10%, it will report low battery.
- 3. Before configuring the network. please ensure that the power has just been disconnected and plugged in to avoid abnormal pre-operations that may cause the device to fail to enter the network configuration mode normally.
- 4. After entering the network configuration mode, it will remains for 120s. If the network is not configured within the validity period of the network configuration the device will automatically restart and exit this mode. In this mode. no other operations are possible.

Operation	Operation result	Indicator status	Voice broadcast
Fingerprint / Password / Remote unlock / Wake up panel	Verify successfully	The green indicator light briefly lights up once	Verify successfully, Unlocked
	verification failed	The red indicator light lights up briefly once	Verify successfully
	Locked after exceeding the number of trial and error attempts	/	System locked
	Battery is less than 25%	The red indicator light flashes 3 times briefly	Low battery please replace the battery
	Battery is about to run out	The red indicator light flashes 4 times briefly	The battery is too low, please use the key or emergency power supply
Lock	Successful	/	Locked
Enter the menu	The button panel is fully illuminated	/	Please enter administrator password
Invalid menu item	Repeat the current menu content	/	/
Factory reset	Press and hold for 7s	The key panel is fully illuminated during the process.	7 sounds of "dong dong dong" Please press the unlock button to confirm
Power on the device	Install the battery and turn on the power	The panel lights gradually turn on from top to bottom.	Power-on tone

(7). App Operation Guidance

1). Connect The Lock To Internet

- 1 Following the installation instruction to install the smart lock.

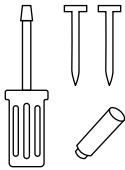

- 2 Download Smart Life App.

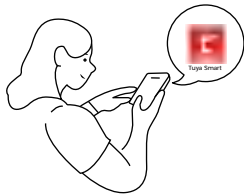

- 3 Register and login to the Smart Life App.



- 4 Calibrate the smart lock and Complete Wi-Fi settings in the App.

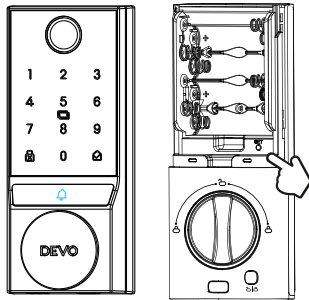

2). Steps to Access System Networking

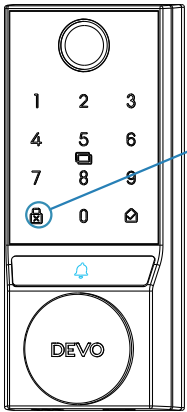
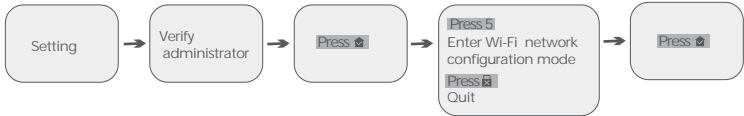

After entering the network, all numeric keys except "[F]" will be locked.

(8). Main Interface Introduction

1). Add Device (Smart Life App For Reference)

 Please make sure that your Phone is connected to the 2.4G Wi-Fi network
Please make sure that your Phone 's Bluetooth is turned on

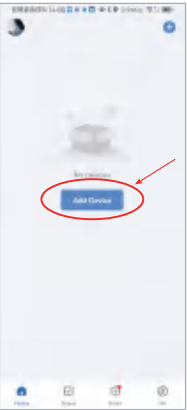

① Click'Add Device'



② Waiting for device search

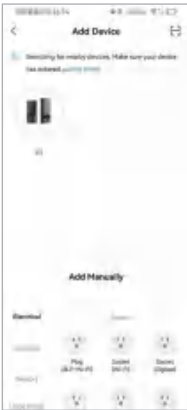

③ Once the device is discovered click G3 device

2). Network Configuration



① Device added successfully Click'Done'



② Choose the same 2.4G Wi-Fi network as your phone and enter you password

3).Members Management

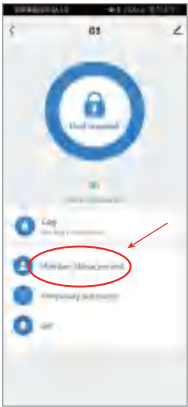

① Member management

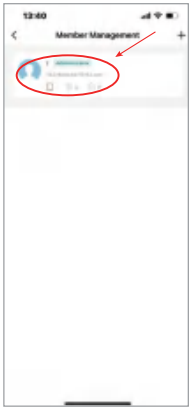

② Select the corresponding member

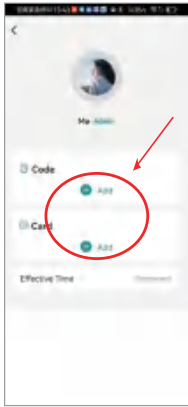

③ Add or delete fingerprints and passwords

4). Settings



① Enter the setting page

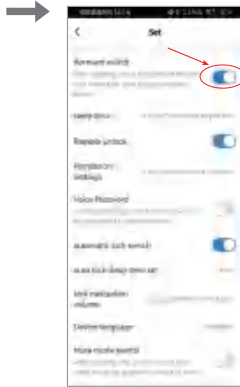

② Open the dormant switch

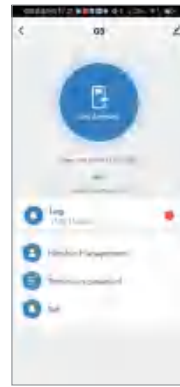

③ In sleep mode, the app does not support unlocking

Notes: In sleep mode, the device cannot be woken up from the App and only be triggered from the device, which can greatly reduce the power consumption of the device.

5). Password Settings

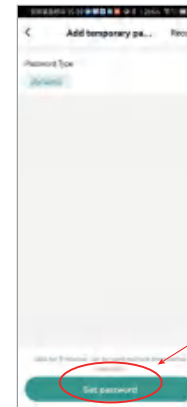

6). Device Unbinding

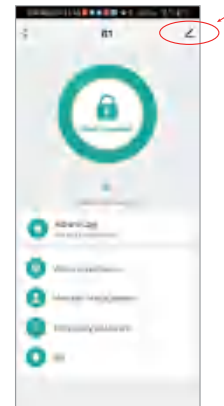

①

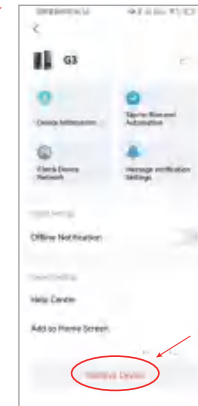

②

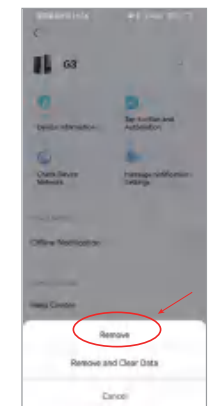

③

Answers	
Can't connect to Wi-Fi	<ul style="list-style-type: none"> • This device only supports 2.4 GHz network and does not support 5G network and mixed-band network. • When connecting Wi-Fi to the device , Please make sure that the lock is in pairing mode (please refer to page28). Please make sure that your phone is connected to the 2.4G Wi-Fi network. Please make sure that your phone's Bluetooth is turned on. When you select the Wi-Fi to the device, you must choose the same 2.4G network Wi-Fi as your phone. (After the lock's Wi-Fi connection is successful, the access network of your phone does not restrict 5G or 2.4G) • How to test whether the Wifi network meets the requirements: Prepare a phone that provides a hotspot network as a Wifi signal, and connect the lock to the hotspot Wi-Fi according to the above requirements. If the network connection is successful and works properly, please log in to the router's background to check the Wi-Fi frequency band and signal stability it provides.
The device is stay offline and cannot reconnect to the network	<ul style="list-style-type: none"> • Please check if the lock has entered dormant mode. While device is sleeping, the APP will be absolutely offline.(please refer to page 31) • When the battery power is lower than 10%, the lock will automatically enter low-power mode and disconnect from the network to ensure basic functions such as locking and unlocking. The network connection triggered by the doorbell is not affected by low battery.

8/Product Parameters

Power Supply	4.8V-6V Eight Cell No.5 Battery/2400 mAh
Emergency Power	5V
Fingerprint Capacity	Fingerprints 100MAX,Passcodes 50 MAX,IC Card 50 Max
Identification Speed	0.25 Sec
False Positive Rate	<0.0001%
Rejection Rate	<0.1%
Working Temperature	<-15°-50°C (5°F-122°F)
Working Humidity	0%~85%(No Condensation)
Standby Current	380uA
Dynamic Power Consumption	450mA
Material	Aluminum Alloy
Passcode Length	Supports 6-8 Digits
Emergency Power Interface	Type-C
Scramble Passcode	Support Scramble Passcode

3578 123456 65987

Real Passcode

Random Digits

(Add Random Digits Before Or After The Real Passcode)

Random Digits No Length Limit

Any Changes or modifications not expressly approved by the party responsible for compliance could void the user's authority to operate the equipment.

This device complies with part 15 of the FCC Rules. Operation is subject to the following two conditions: (1) This device may not cause harmful interference, and (2) this device must accept any interference received, including interference that may cause undesired operation.

Note: This equipment has been tested and found to comply with the limits for a Class B digital device, pursuant to part 15 of the FCC Rules. These limits are designed to provide reasonable protection against harmful interference in a residential installation. This equipment generates, uses and can radiate radio frequency energy and, if not installed and used in accordance with the instructions, may cause harmful interference to radio communications. However, there is no guarantee that interference will not occur in a particular installation. If this equipment does cause harmful interference to radio or television reception, which can be determined by turning the equipment off and on, the user is encouraged to try to correct the interference by one or more of the following measures:

- Reorient or relocate the receiving antenna.
- Increase the separation between the equipment and receiver.
- Connect the equipment into an outlet on a circuit different from that to which the receiver is connected.
- Consult the dealer or an experienced radio/TV technician for help.

This equipment complies with FCC radiation exposure limits set forth for an uncontrolled environment. **This equipment should be installed and operated with minimum distance 20cm between the radiator & your body.**



DEVO

For any questions, please feel free to contact us, we will send you a reply and solve the problem within 24 hours.



Email: DEVO.services@outlook.com

DEVO reserves the final interpretation right of all terms and conditions in this manual.

MADE IN CHINA