

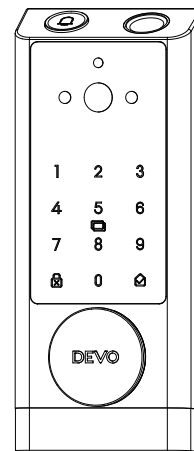

# USER MANUAL

— MODEL NO:G1 —



*Intelligent Share & Relieved Life Notices*

Notices: Read this user manual carefully before operating the lock and keep it for future use

## FOR USERS IMPORTANT

Thank you for choosing DEVO smart lock

To ensure easy and safe use of the product, we have prepared this manual to help you better understand the DEVO smart lock.

DEVO smart lock is popular among users for its unique shape, advanced and reliable technology and thoughtful after-sales service. The company has established a complete DEVO intelligent R&D, manufacturing and sales system. All smart locks are independently developed by the company and have won high praise from customers.

Our smart locks have undergone reliability tests and functional tests, ambient light tests, temperature tests, etc., all of which constitute the leading and unique advantages of smart locks.

Thank you for sharing your experiences and opinions with us, which help us improve our products.

Thank you for purchasing the "DEVO" smart lock. Considering our continuous improvement and updating of products, the actual product may be slightly different from the pictures in this manual. Please refer to the actual product.

Please read carefully and abide by the contents marked in this manual.

## CONTENTS

• • • .....	<b>Hardware Introduction</b>	01-03
• • • .....	<b>Compatible Doors</b>	04
• • • .....	<b>Parts List</b>	05-06
• • • .....	<b>Product Dimension</b>	07-08
• • • .....	<b>Installation Overview</b>	09-20
• • • .....	<b>Programming Instructions</b>	21-32
• • • .....	<b>Troubleshooting</b>	33-34
• • • .....	<b>Product Parameters</b>	35-36

# 1/ Hardware Introduction

## (1) Overview

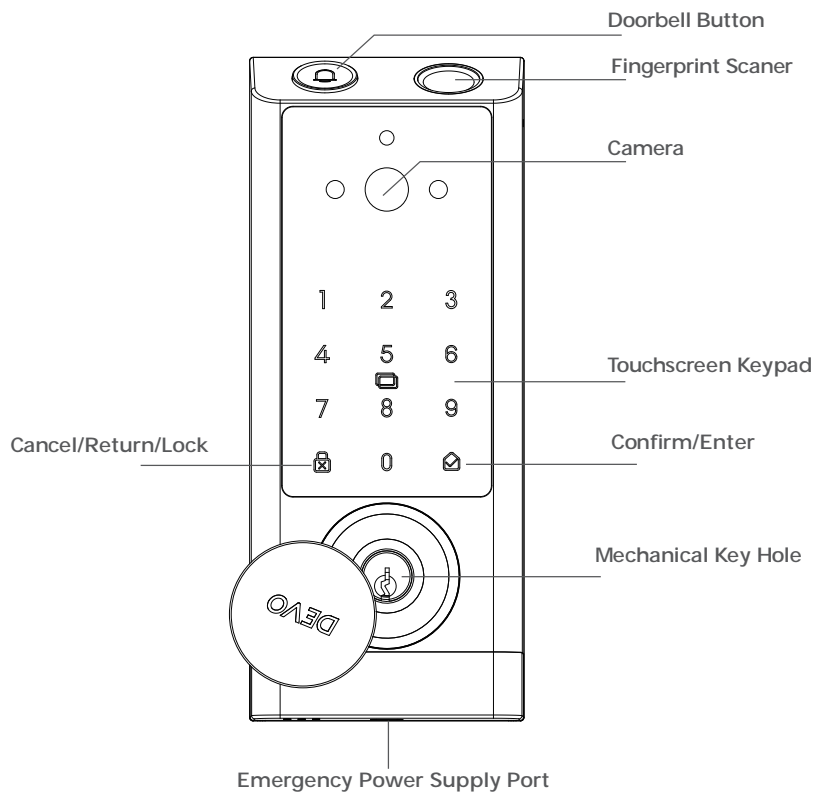

Note: The "Emergency Power Supply Port" is not for battery charging purpose and can only be used for emergency power supply to the lock.

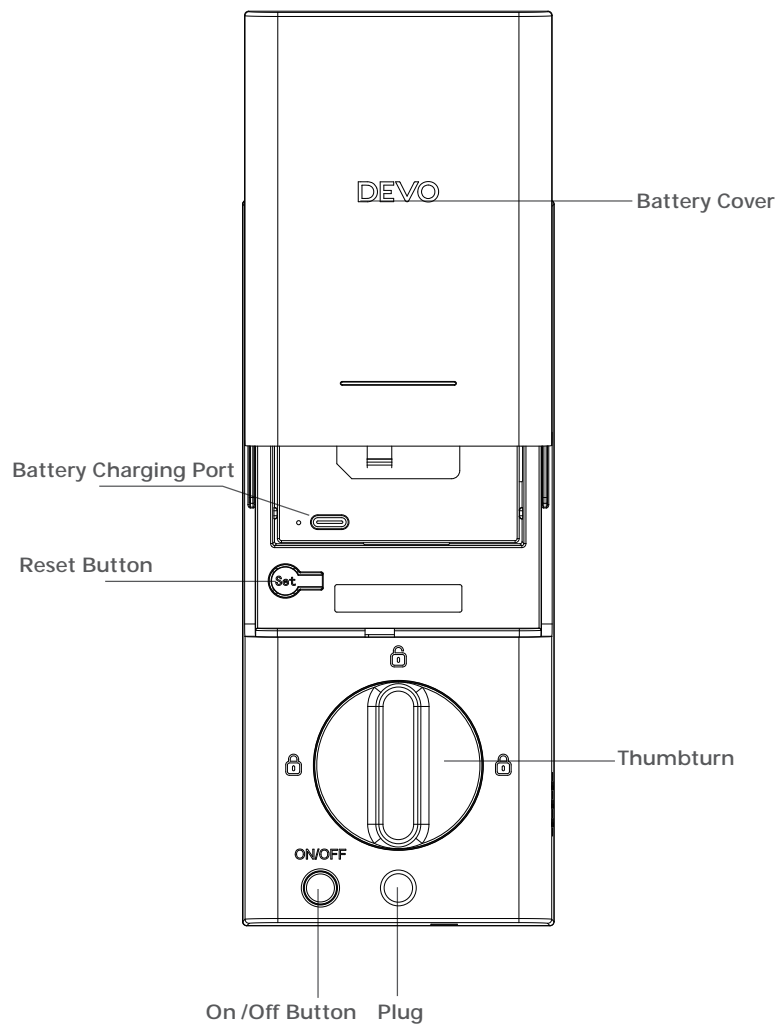

## (2) How To Open / Close Lock Cylinder Cover

Press and hold the Lock Cylinder Cover and turn it clockwise/counterclockwise to open it.

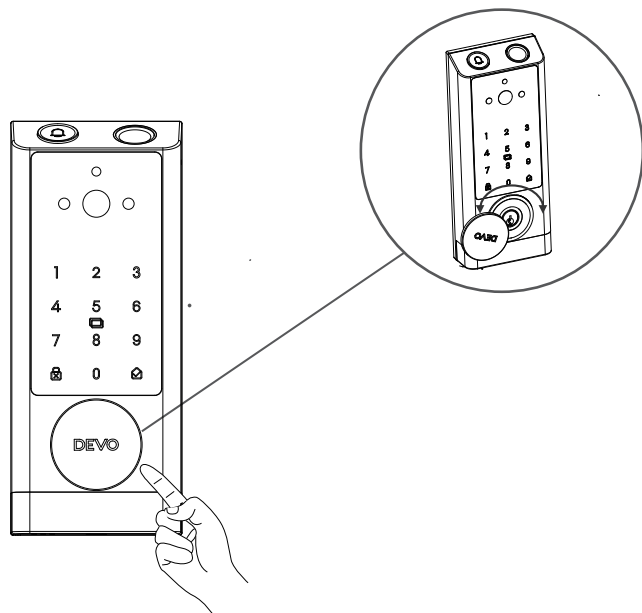

## 2 / Compatible Doors

### Compatible Doors

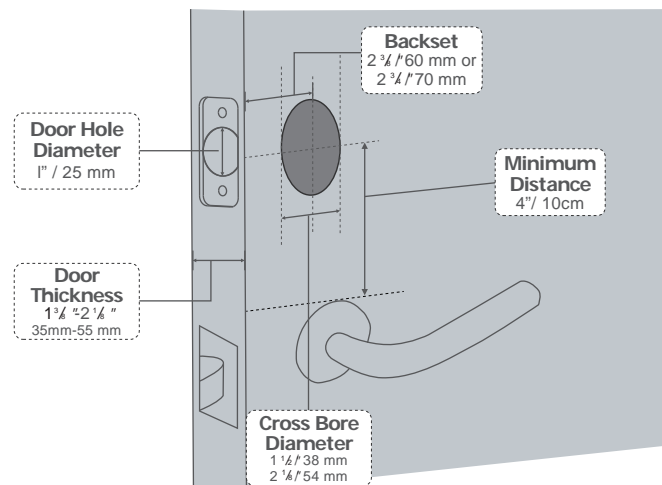

# 3 / Parts List

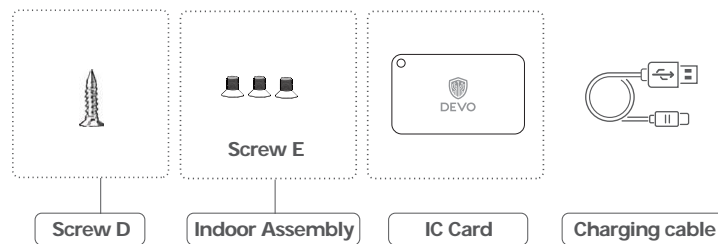
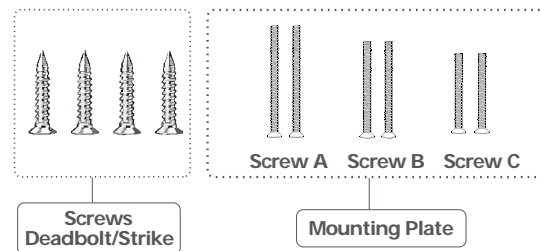
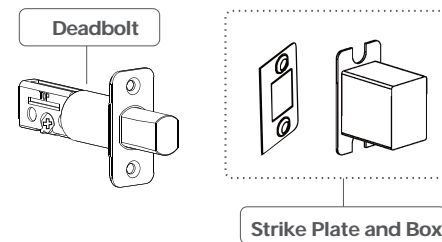
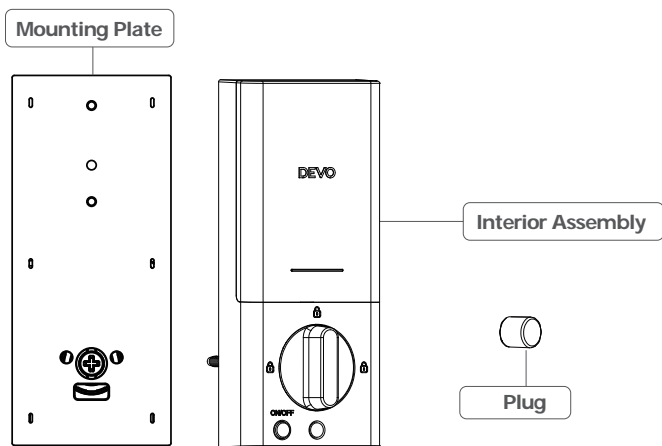
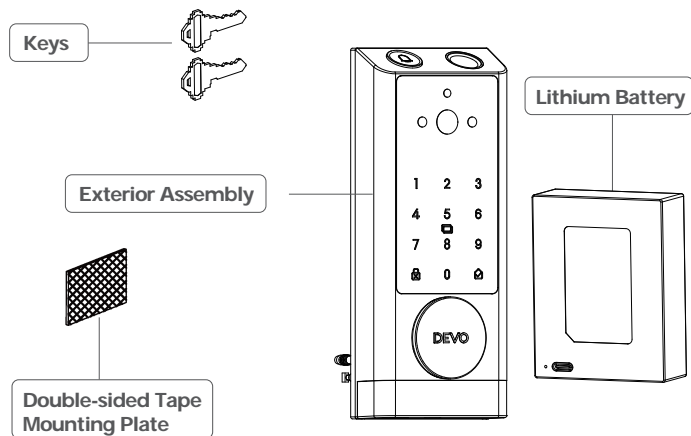

## 4 / Product Dimension

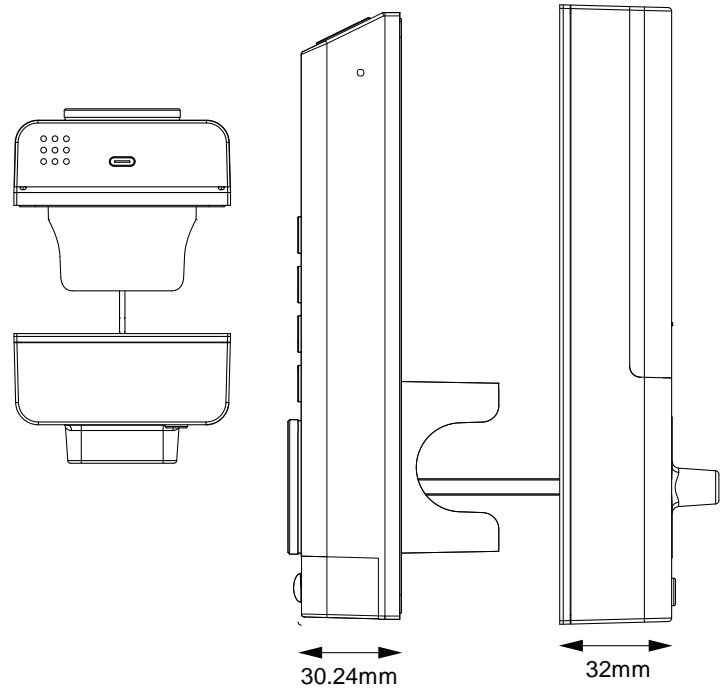
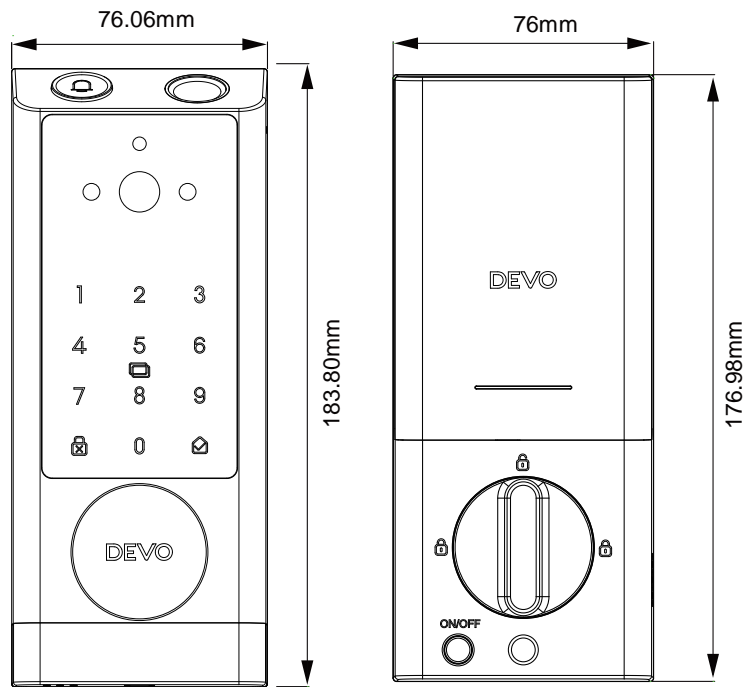

# 5/ Installation Overview

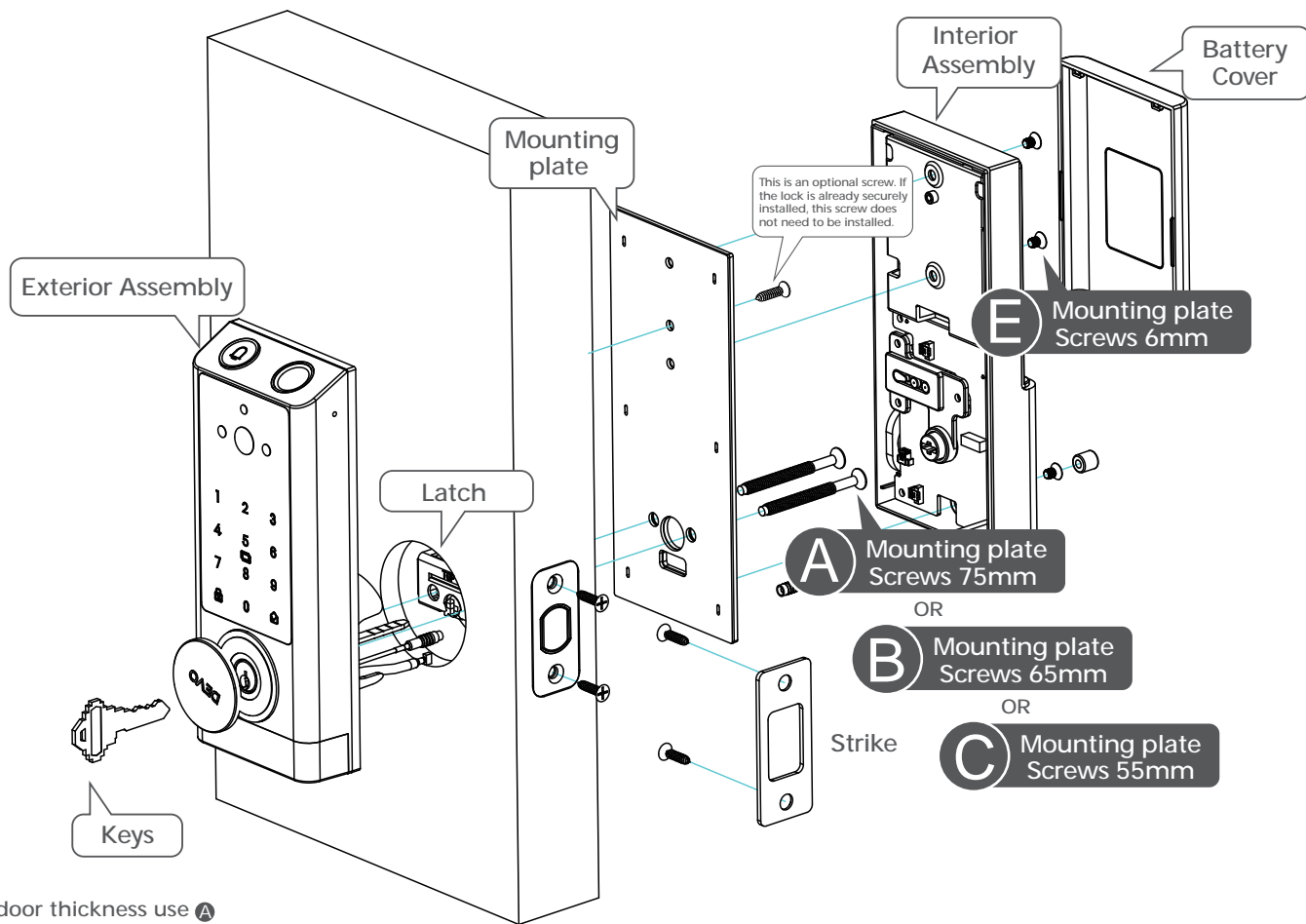

\*50-55mm door thickness use **A**

\*40-50mm door thickness use **B**

\*35-40mm door thickness use **C**

## Step 1. Install Deadbolt

(1). Check your door to see if the deadbolt requires adjustment.

If the backset is 70mm, turn the faceplate 180° to extend the length.

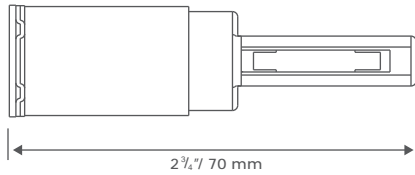
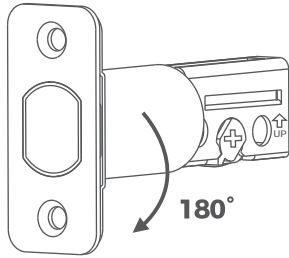
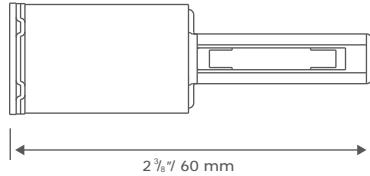

(2). Insert and screw the deadbolt into the doorframe.

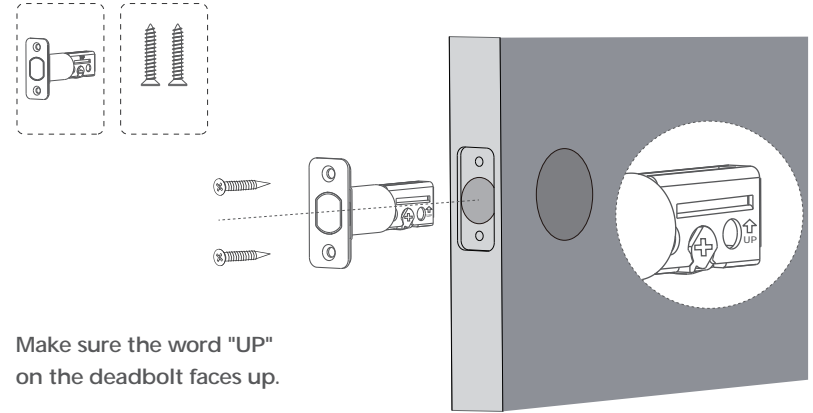

## Step 2. Install Strike Plate

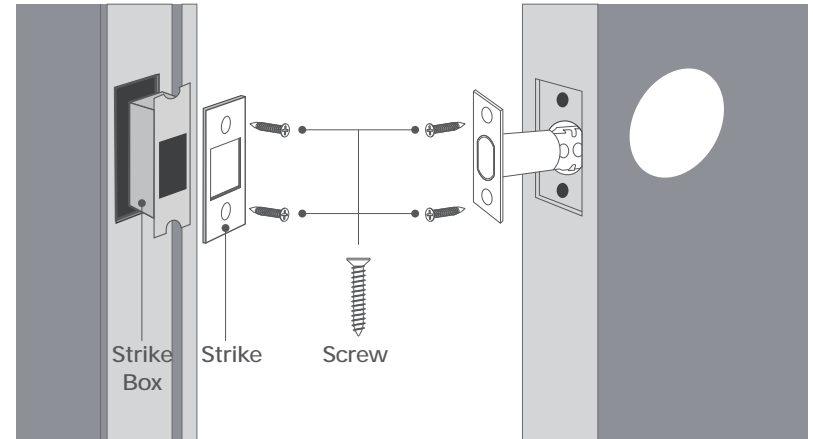



### Step 3. Install Exterior Assembly

Remember to attach the rubber gasket to the handle before Installation.

(1). Measure your cross bore dimension and determine the installation steps accordingly

- If the cross bore of your door is 1 ½" / 38mm", please remove the adapter.
- If the cross bore of your door is 1 ¾" / 54mm", please keep the adapter.

(2). Route the cable connected on the exterior assembly under the Latch. make sure the tailpiece is Horizontal to the exterior assembly bottom, as the illustration shows.

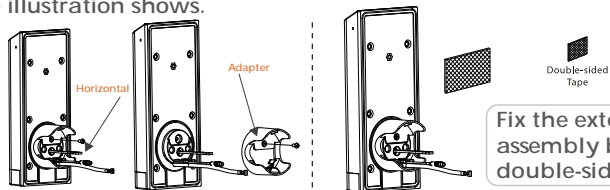
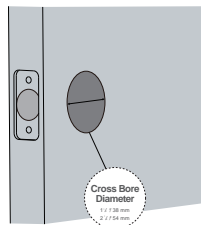

### Step 4. Install Interior Assembly

(1). Detach the back cover from the interior assembly.

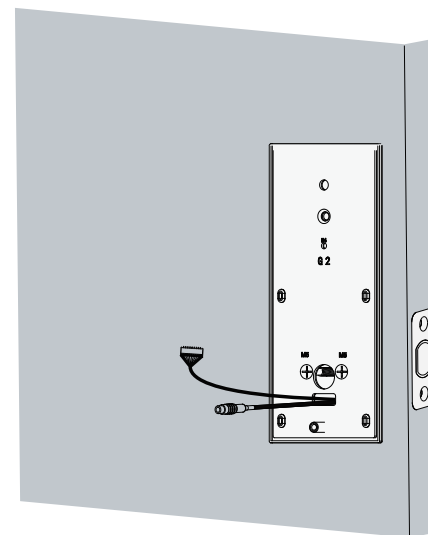
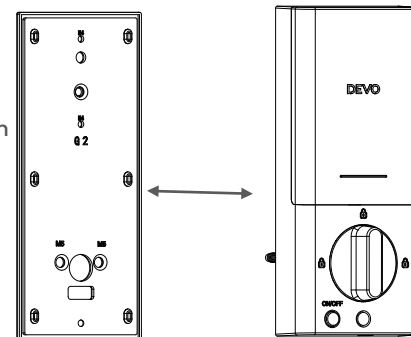

(2). Run the wires through the back cover.

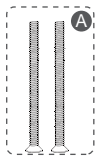

50-55mm door  
thickness use A

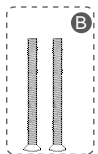

40-50mm door  
thickness use B

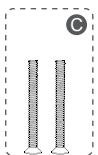

35-40mm door  
thickness use C

(4). Tightly fasten the screws  
in place. Set the screws  
with your hands, then use  
a screwdriver to secure  
them.

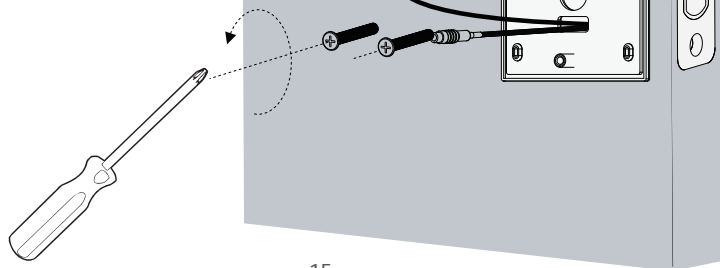

(3). Secure the back cover with screws.

**Important:** Please select Screw A ,Screw B,or Screw C  
based on the thickness of the door(35mm-55mm)

- 1.Thickness of Screw A compatible doors:50-55mm
- 2.Thickness of Screw B compatible doors:40-50mm
- 3.Thickness of Screw C compatible doors:35-40mm

(5). Wire to the interior assembly.

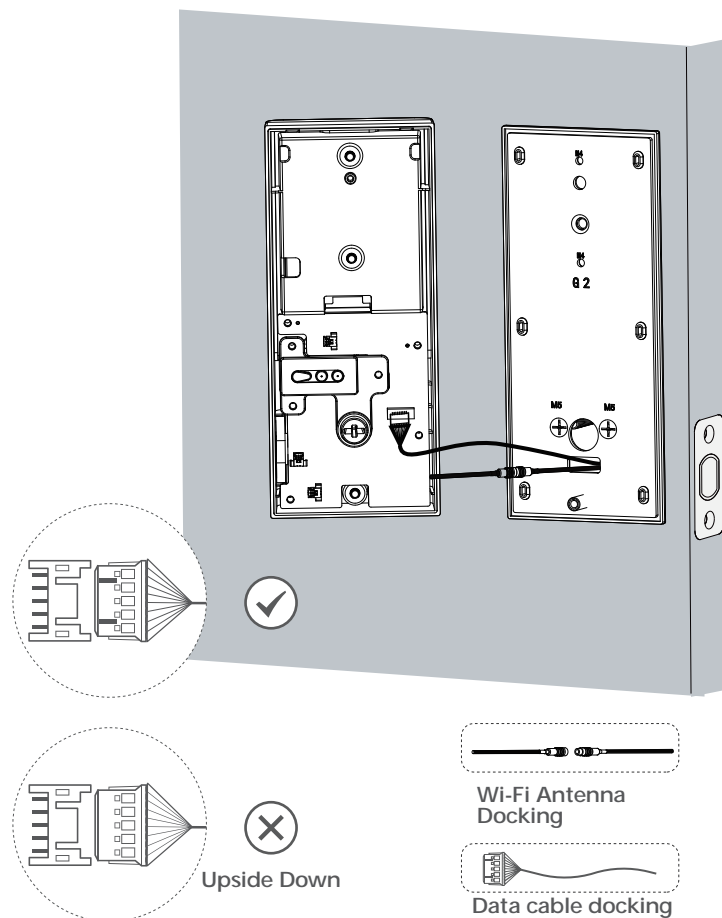

(6) Mount the interior assembly. Make sure both wires are tucked into the cabin on the back of the interior assembly.

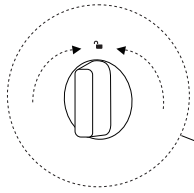

Notes: Make sure to rotate Thumbturn to the unlocked position before installing.

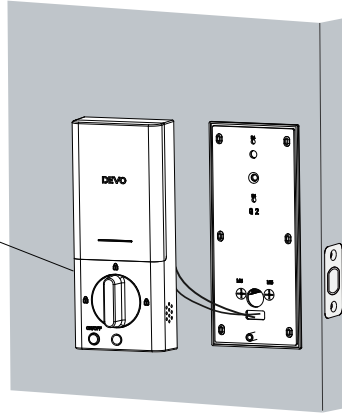

(7). Check if the deadbolt retracts by turning the thumbturn.

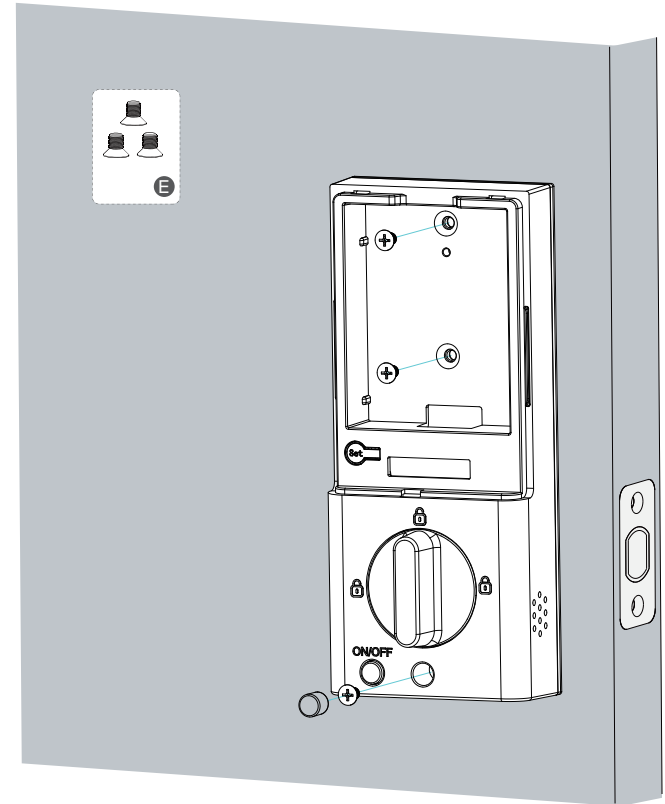
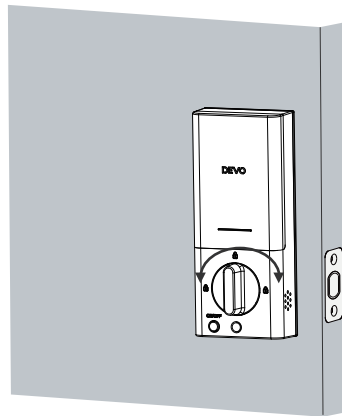

(8). Fully charge the battery before first use. It might take about 6 hours.

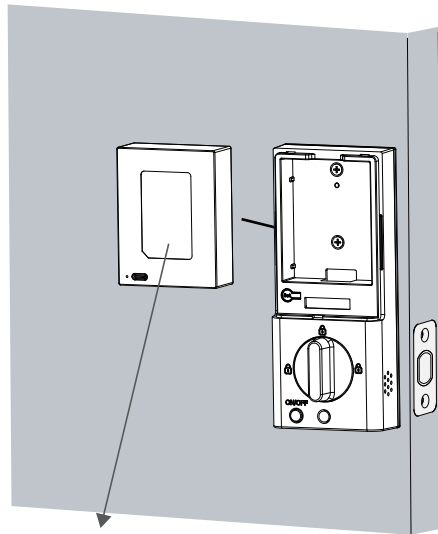
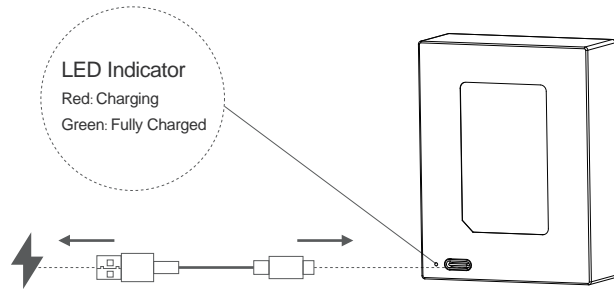

Notes: After fully charged, install the battery into the door lock and it can be used

**Apart from being able to configure your door lock through the app, you can also directly set the relevant settings on the door lock following the instructions below.**

### (1). Smart Lock Powered on

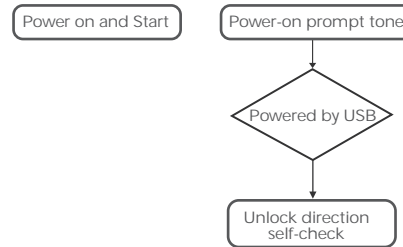

The smart lock self-checks the unlocking direction when powered on. After the self-check is completed, the lock will be closed.

### (2). Calibration of door opening direction

If the automatic door opening direction calibration fails, you can also select the door opening direction calibration in the system to re-calibrate, after the success of the door opening direction back to normal, the system settings are as follows.

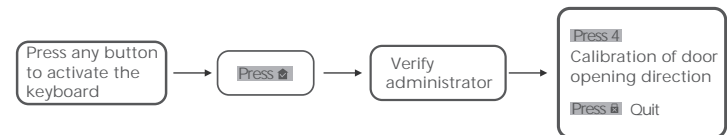

## 6/ Programming Instructions

### (1). User Type

Type	Capacity	Description
Administrator	5	<ul style="list-style-type: none"><li>• Sequence ID 1-5</li><li>• Unlock</li><li>• Management</li></ul>
Regular User	195	<ul style="list-style-type: none"><li>• Sequence ID 6-200,</li><li>• Unlock,(Invalid when the Anti-lock is On)</li></ul>
Total	200	<ul style="list-style-type: none"><li>• Fingerprint Capacity:100</li><li>• Passcode Capacity:50</li><li>• IC Capacity:50</li></ul>

(2). Enter the Door Lock Setting Menu

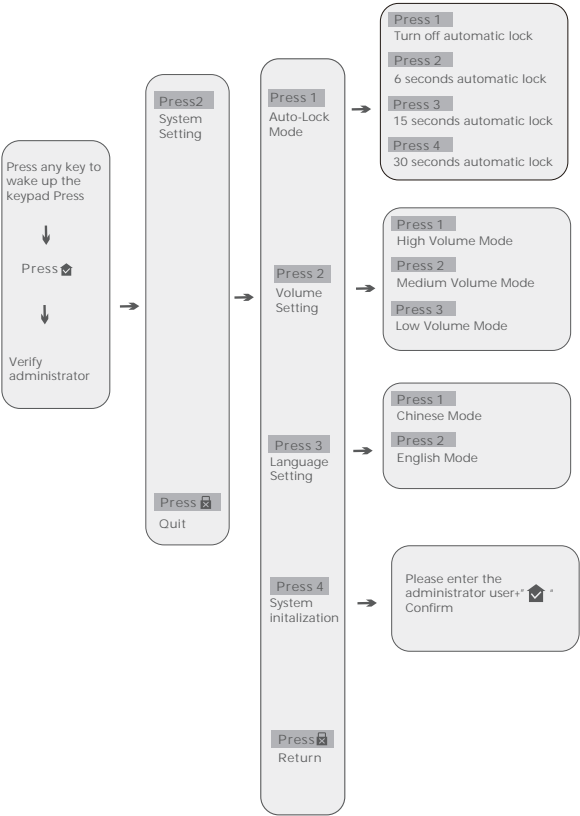

(3). How to Program User Access Code



The default Administrator code is 123456.It's required that you change it to a code of your own before programming.

After adding the first administrator password or fingerprint, the default code will invalid.

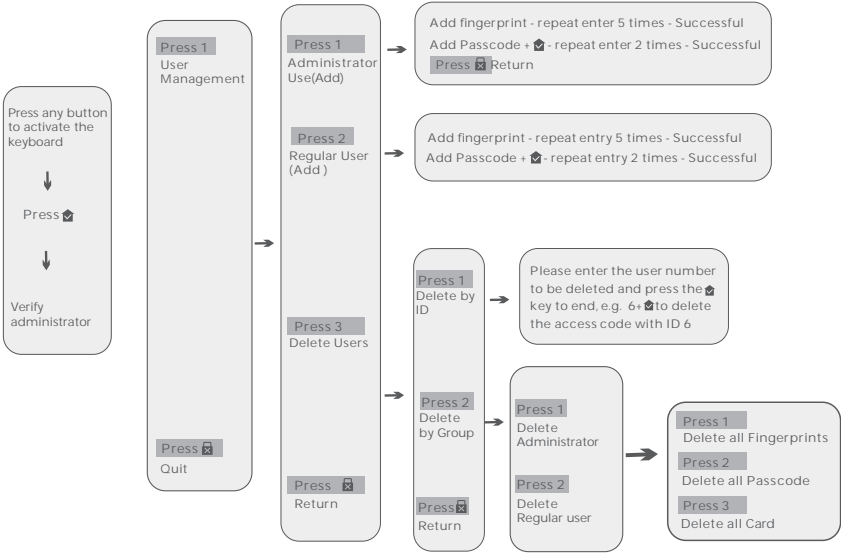

(4). Restore Factory Settings

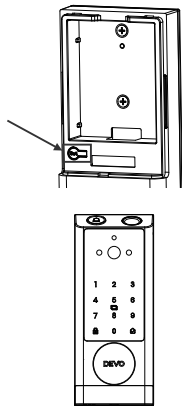

- 1. Long press the "Set" button, and release it when you hear two beeps and the No. 5 button flashes.
- 2. The lock end broadcasts the successful operation.

(5). Set Administrator Password

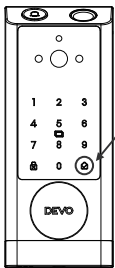

- 1. Wake up the keyboard, press the " " key, and hear the prompt "Please enter the administrator user".
- 2. Enter the initial password 123456, and then press the " " key to enter the system
- 3. In the system menu, press the "1" key to select the user to enter, and then press the "1" key to enter the new administrator user (the original administrator password is invalid)

(6). Others

- (1 ). There are 5 consecutive attempts allowed for fingerprint, password, and IC card authentication. After exceeding this limit, the system will be locked for one minute.
- (2). After the ultra-low power alarm, the motor cannot work. (Please replace the battery at this time, current firmware version, load condition (peephole lock control working status), If the battery power is lower than 10%, it will report low battery.)

Operation	Operation result	Indicator status	Voice broadcast
Fingerprint / Password / Card / Remote unlock / Wake up panel	Verify successfully	The number keys will light up except for key 5	Verify successfully Unlocked
	verification failed	The number key 13579 will light up	Voice prompt for verification failure
	Wrong password for more than five times	/	Alarm sounds and locks the system
	Battery level is less than 20%	App cannot view video	/
	Battery level is less than 10%	Low battery warning	The battery is too low, please use the key or emergency power supply
Lock	Successful	/	Locked
Enter the menu	Wake up the panel and press" "	/	Please enter administrator password
Invalid menu item	Repeat the current menu content	/	/
Factory reset	Press and hold the "set" initialization button for three seconds.	The"5" key flashes until the initialization is successful	Successful operation
Power on the device	Install the battery and turn on the power	All number keys light up simultaneously	Power-on tone

# (7). App Operation Guidance

## (1). Connect The Lock To Internet

- 1 Following the installation instruction to install the smart lock.

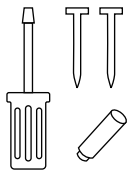

- 2 Download Smart Life App



- 3 Register and login Smart Life App



- 4 Calibrate the smart lock and Complete Wi-Fi settings in the App

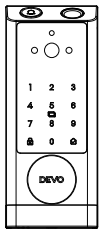

## (2). Steps to Access System Networking

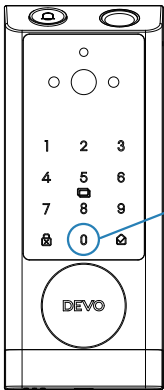
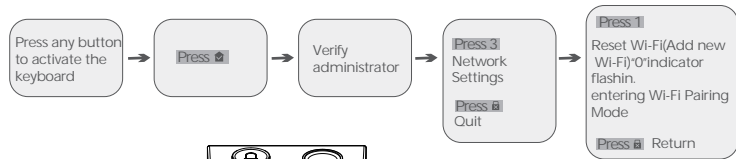

The "0" key blinks when the distribution network is activated. (Networking effective time: 120S)



(8). Main interface introduction

(1). Add Device(Smart Life App for reference)

 Please make sure that your Phone is connected to the 2.4G Wi-Fi network  
Please make sure that your Phone ' s Bluetooth is turned on

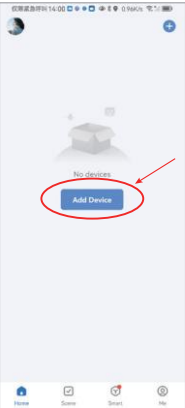

① Click'Add Device'



② Waiting for device search



③ Once the device is discovered click G1 device

(2). Network Configuration

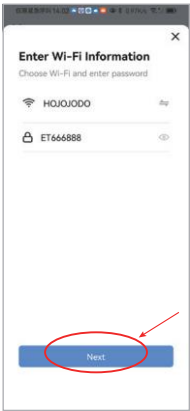

① Choose the same 2.4G Wi-Fi network as your phone and enter you password

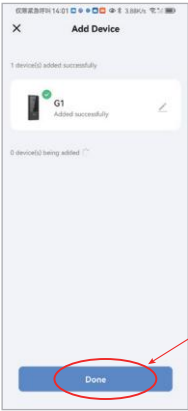

② Device added sucessfully Click'Done')

### (3). Settings

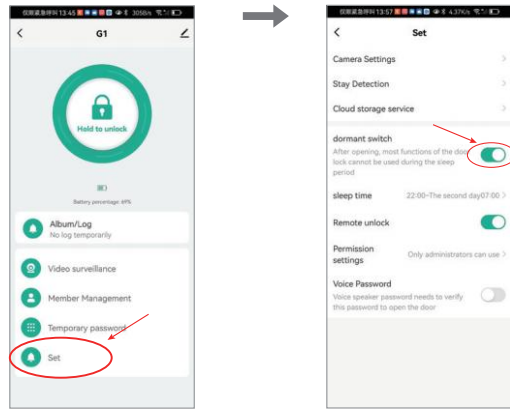

① Enter the setting page

② Open the dormant switch

**Notes:** In sleep mode, the device cannot be woken up from the App and only be triggered from the device, which can greatly reduce the power consumption of the device.

### (4). Real-time monitoring and Doorbell Calling

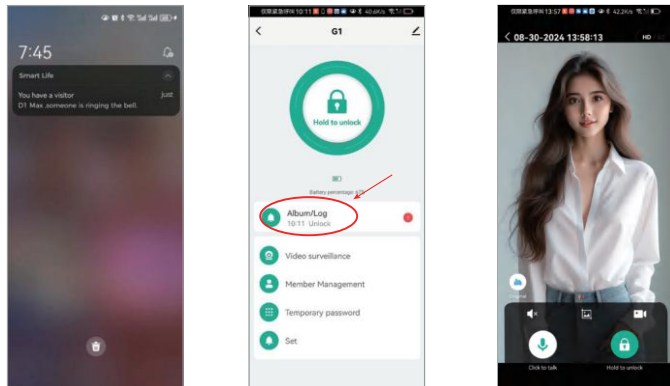

① Enter the app

② Enter the real-time monitoring preview interface

(Can't actively view video if battery is below 20%)

③ Click the mic to talk

### (5). Password Settings

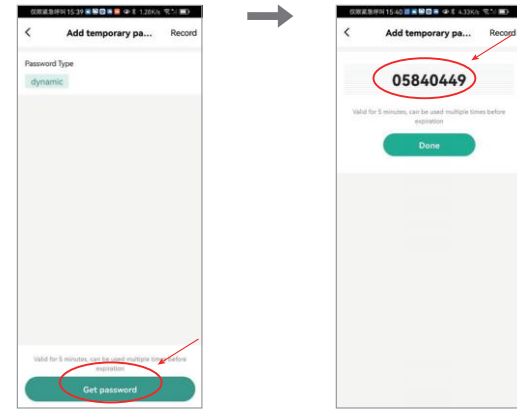

①

②

### (6). Device Unbinding

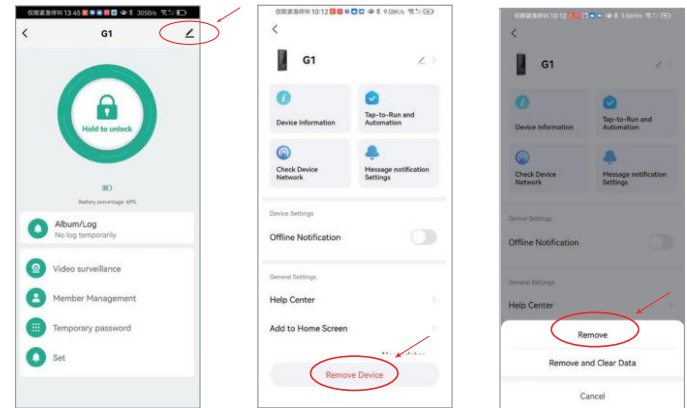

①

②

③

Questions	Answers
<p>Can't connect to Wi-Fi</p>	<ul style="list-style-type: none"> <li>• This device only supports 2.4 GHz network and does not support 5G network and mixed-band network.</li> <li>• When connecting Wi-Fi to the device , Please make sure that the lock is in pairing mode (please refer to pag 28 ). Please make sure that your phone is connected to the 2.4G Wi-Fi network. Please make sure that your phone's Bluetooth is turned on. When you select the Wi-Fi to the device, you must choose the same 2.4G network Wi-Fi as your phone. (After the lock's Wi-Fi connection is successful, the access network of your phone does not restrict 5G or 2.4G)</li> <li>• How to test whether the Wifi network meets the requirements: Prepare a phone that provides a hotspot network as a Wifi signal, and connect the lock to the hotspot Wi-Fi according to the above requirements. If the network connection is successful and works properly, please log in to the router's background to check the Wi-Fi frequency band and signal stability it provides.</li> </ul>
<p>The device is stay offline and cannot reconnect to the network</p>	<ul style="list-style-type: none"> <li>• Please check if the lock has entered dormant mode. While device is sleeping, the APP will be absolutely offline.(please refer to page 31 )</li> <li>• When the battery power is lower than 10%, the lock will automatically enter low-power mode and disconnect from the network to ensure basic functions such as locking and unlocking. The network connection triggered by the doorbell is not affected by low battery.</li> </ul>

## 8/Product Parameters

Power Supply	3.7V Lithium Battery 10000mAh
Video	1080p HD Video, Night Vision
Emergency Power	5V
Fingerprint Capacity	Fingerprints 100 MAX, Passcodes 50 MAX , IC Card 50 MAX
Fingerprint Pixels	508dpi
Identification Speed	0.25sec
False Positive Rate	<0.0001%
Rejection Rate	<0.1%
Working Temperature	-15C°-50°C (5°F - 122°F)
Working Humidity	0%~85%( No Condensation)
Standby Current	< 500 μA
Dynamic Power Consumption	< 600 mA
Material	Aluminum Alloy
Passcode Length	Supports 6 -10 digits
Emergency power Interface	Type-C
Scramble passcodes	Support Scramble Passcode (Add Random Digits Before Or After The Real Passcode)

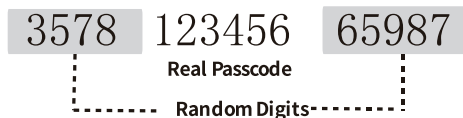

Random Digits No Length Limit

## FCC Warning

This device complies with part 15 of the FCC Rules. Operation is subject to the following two conditions: (1) This device may not cause harmful interference, and (2) this device must accept any interference received, including interference that may cause undesired operation.

Any Changes or modifications not expressly approved by the party responsible for compliance could void the user's authority to operate the equipment.

**Note:** This equipment has been tested and found to comply with the limits for a Class B digital device, pursuant to part 15 of the FCC Rules. These limits are designed to provide reasonable protection against harmful interference in a residential installation. This equipment generates uses and can radiate radio frequency energy and, if not installed and used in accordance with the instructions, may cause harmful interference to radio communications. However, there is no guarantee that interference will not occur in a particular installation. If this equipment does cause harmful interference to radio or television reception, which can be determined by turning the equipment off and on, the user is encouraged to try to correct the interference by one or more of the following measures:

- Reorient or relocate the receiving antenna.
- Increase the separation between the equipment and receiver.
- Connect the equipment into an outlet on a circuit different from that to which the receiver is connected.
- Consult the dealer or an experienced radio/TV technician for help.

This equipment complies with FCC radiation exposure limits set forth for an uncontrolled environment. This equipment should be installed and operated with minimum distance 20cm between the radiator & your body.



For any questions, please feel free to contact us, we will send you a reply and solve the problem within 24 hours.



Email: [DEVO.services@outlook.com](mailto:DEVO.services@outlook.com)

DEVO reserves the final interpretation right of all terms and conditions in this manual.

MADE IN CHINA