

Product introduction

1. The polar crystal wireless switch series (door control sensor remote controller /hand waving sensor controller/ body sensor remote controller/touch sensor remote controller) is used in conjunction with our company's "wireless control box" or "ultra-thin smart power supply" to enable wireless control of cabinet lights.
2. 3VDC safe ultra-low voltage drive
3. 3-year quality warranty

Product Name	Voltage	Function	Sense distance	Ambient temperature
Polar crystal - Wireless double sensor door Remote Controller	DC3V	Door control sensor	0-50mm	-10°C~+45°C
Polar crystal - Wireless Hand waving sensor Sequential Controller		Hand wave sensor	0-80mm	
Polar crystal -Wireless Human Body sensor Remote Controller		Body sensor	0-2.5m	
Polar crystal -Wireless Touch sensor Remote Controller		Touch sensor	—	

Packing list

Polar crystal wireless sensor Remote Controller Series						
Product Name	Double sensor door remote controller	Installation base	Battery	Screw	Double-sided adhesive tape	Instructions
	Hand waving sensor sequential controller					
	Body sensing remote control					
	Touch sensor remote controller					
Specification	42×42×10mm	55×43.5×7.4mm	CR2450	3×10mm	35×10mm	A4
Diagram						
Quantity	1PCS	1PCS	1PCS	2PCS	1PCS	1PCS

Basic dimensions

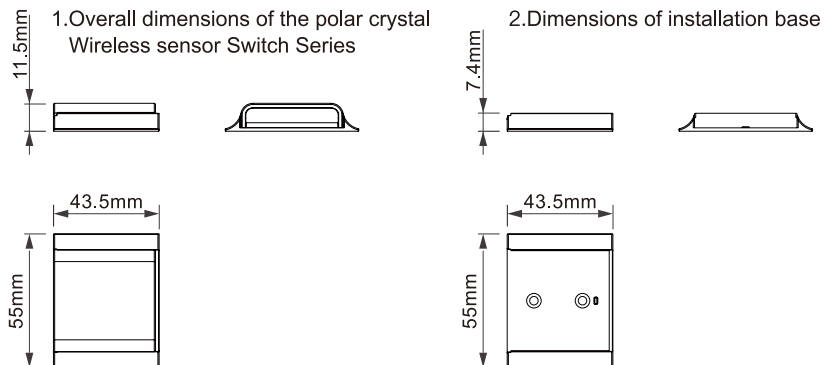

Connection pair code diagram

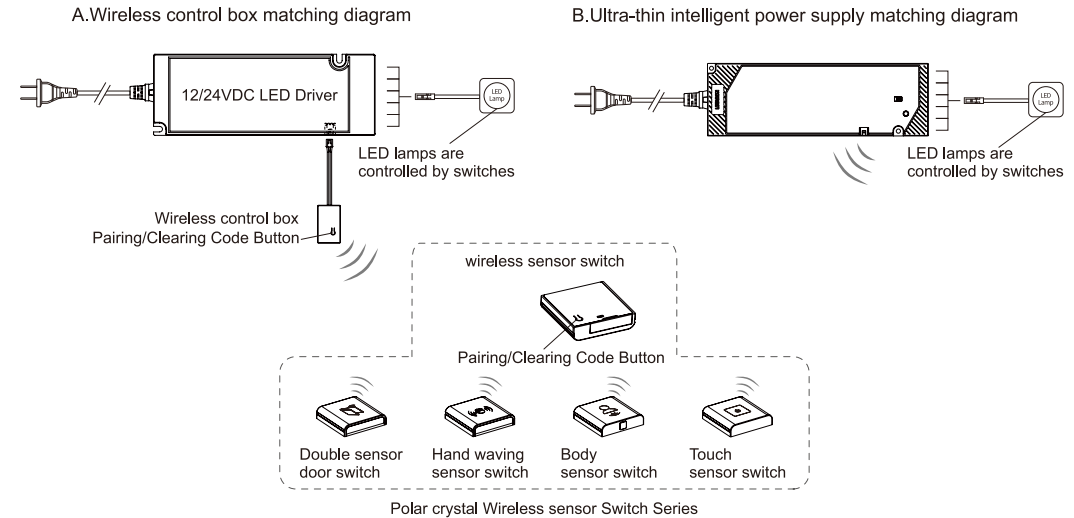

Wireless Switch Pairing

1. Control Box:
Press the pairing button once to enter pairing mode.
2. Ultra-thin Smart Power Supply:
Press the pairing button twice to enter pairing mode. Wait for the blue indicator light on the Control Box or Ultra-thin Smart Power Supply to flash slowly, indicating pairing mode. Within 30 seconds, press the 'Pairing Button' on the back of the wireless switch. When the blue indicator light goes out or the lamp flashes three times, it represents successful pairing.

Note: If pairing fails, please move the Control Box or Ultra-thin Smart Power Supply closer to the wireless switch and repeat steps 1 and 2.

Wireless Switch Code Clearing

1. Press and hold the 'Pairing/Clearing Code Button' on the back of the wireless switch for 10 seconds. If the lamp flashes three times, it indicates successful code clearing.
2. After successful code clearing, the wireless switch will no longer control the wireless control box or ultra-thin smart power supply. Test to confirm whether the code clearing is successful.

Note: If code clearing is unsuccessful, please move the control box or ultra-thin smart power supply closer to the wireless switch and repeat steps 1 and 2 until successful.

Installation procedure

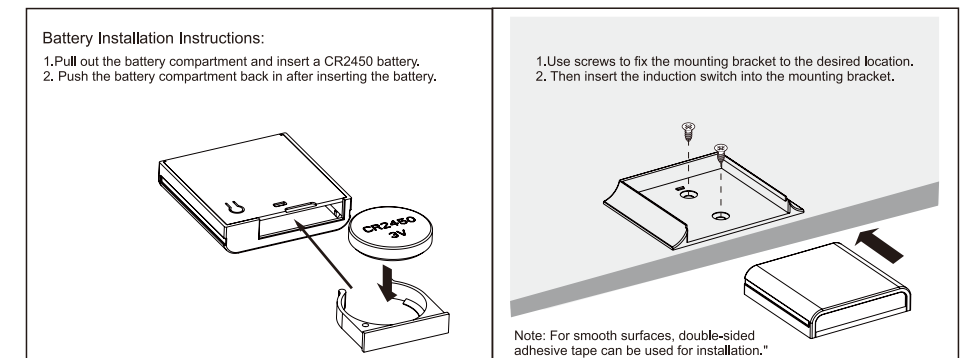

Induction diagram

① Wireless hand waving sensor switch

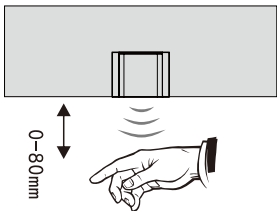

Wireless Control Box Matching:

Door Control: Automatically turns light on/off when door opens/closes.
Hand Wave: Wave to toggle light on/off. Blocking adjusts brightness.

Ultra-thin Smart Power Matching:

Door Control: Same as above.
Hand Wave: Same as above. Blocking also adjusts color (10%-100%). Color reverses after reaching max/min.

Note: Avoid strong natural light interference..

③ Wireless body sense switch

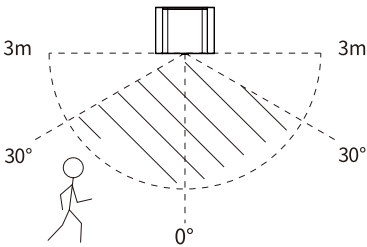

Wireless Control Box Matching:

Function: Automatically turns on the light when someone is detected moving; automatically turns off the light 30 seconds (±5 seconds) after the person leaves. If movement is detected during this period, the timer will reset.

Ultra-thin Smart Power Matching:

Function: Same as above. Additionally, short pressing the pairing button adjusts the color from "cool - warm - neutral".

② Wireless door sensor switch

The wireless door sensor switch must be moved in by 5mm

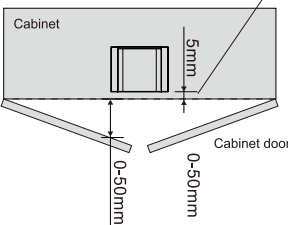

④ Wireless touch sense switch



Function: Control light on/off; adjust brightness from 10% to 100%.

Wireless Control Box Matching:

1. On/Off Control: Short press the "Power Button" (less than 0.5s).
2. Brightness Adjustment: While the light is on, long press the "Power Button" to adjust brightness from 10% to 100%.

Ultra-thin Smart Power Matching:

1. On/Off Control: Short press the "Power Button" (less than 0.5s).
2. Brightness Adjustment: While the light is on, long press the "Power Button" to adjust brightness from 10% to 100%.
3. Color Temperature Adjustment: While the light is off, long press the "Power Button" to adjust the color temperature until it reaches the maximum or minimum and stops. The next adjustment will reverse the direction.

Precautions

1. This switch is specifically designed for use with our company's "Wireless Control Box" or "Ultra-thin Smart Power Supply".
2. This switch needs to be paired with a powered "Wireless Control Box" or "Ultra-thin Smart Power Supply" with a battery installed.
3. The remote control distance between this switch and the "Wireless Control Box" or "Ultra-thin Smart Power Supply" it is used with should not exceed 5 meters.
4. This switch supports a maximum of 10 "Wireless Control Boxes" or 10 "Ultra-thin Smart Power Supplies".
5. The "Wireless Control Box" supports a maximum of 6 wireless switches, and the "Ultra-thin Smart Power Supply" supports a maximum of 10 wireless switches.
6. The installation process of the product should be completed by a professional.
7. Choose an installation location for the product that avoids areas with moisture or humidity.
8. Before cleaning the product, turn off the power. When cleaning, please use a slightly damp towel to wipe the surface. Do not use chemicals or other cleaning agents to avoid damaging the surface or leaving cleaning agent residue.
9. Unauthorized disassembly of the product will void the warranty.

FCC Warning

This device complies with part 15 of the FCC Rules. Operation is subject to the following two conditions:

- (1) This device may not cause harmful interference, and
- (2) this device must accept any interference received, including interference that may cause undesired operation.

NOTE 1: This equipment has been tested and found to comply with the limits for a Class B digital device, pursuant to part 15 of the FCC Rules. These limits are designed to provide reasonable protection against harmful interference in a residential installation. This equipment generates, uses and can radiate radio frequency energy and, if not installed and used in accordance with the instructions, may cause harmful interference to radio communications. However, there is no guarantee that interference will not occur in a particular installation. If this equipment does cause harmful interference to radio or television reception, which can be determined by turning the equipment off and on, the user is encouraged to try to correct the interference by one or more of the following measures:

- Reorient or relocate the receiving antenna.
- Increase the separation between the equipment and receiver.
- Connect the equipment into an outlet on a circuit different from that to which the receiver is connected.
- Consult the dealer or an experienced radio/TV technician for help.

This equipment should be installed and operated with minimum distance 20cm between the radiator & your body

NOTE 2: Any changes or modifications not expressly approved by the party responsible for compliance could void the user's authority to operate the equipment.

