

User Manual

GPS wireless electronic fence dog traine

Model:K999-01

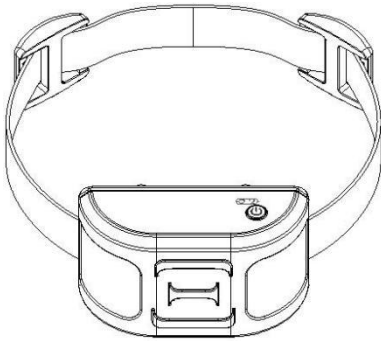

Packing list:

1*GPS fence collar

1*USB data cable

1*Test light

2*2 sets conductive silicone gel

1*user Manual

Parameter

Product name:	GPS wireless electronic fence dog traine
Connection mode:	<i>Bluetooth/APP</i>
APP name:	<i>My Pet Paradise</i>
Warning Mode:	<i>Lighting;Sound;Vibration;Telegraphic</i>
Power:	USB
Input Voltage:	3.7V
Input Current:	40mAh
Battery:	3.7V 800mAH
Waterproof IP Rating:	IP67
Fence drawing mode:	Google:Circular Boundary OR Polygon Boundary
Controlling Distance:	Radius3280ft

WARNING

Please use outdoors, Because it needs to receive GPS signals

Please keep your phone and collar connected within Bluetooth range

Prohibited for Pets under 6 months old or weighing less than 8 pounds

Not for aggressive dogs. Do not use this product if your dog is aggressive, or if your dog is prone to aggressive behavior. Aggressive dogs could result in death or serious injury.

Please do not wear the collar for a long time and wearing collars correctly, Prevent damaging the skin of beloved pets

Product Description

This is the latest, most stable, and secure GPS electronic fence in the world. Through the application "My Pet Paradise" we use the Circular Boundary or Polygon Boundary mode on Google Maps to accurately draw our ideal fence, and can interact with our beloved pets within Bluetooth range through dog training mode. The control range is within a radius of 3280ft.

Main Features

1. Real wireless fence system without any wire and flags layout;
2. Max signal range is up to 3280FT radius with GPS positioning technology;
3. Variety stimulus modes: *Lighting;Beeper;Vibration;Telegraphic*
4. Through our "My Pet Paradise", we can achieve the dual function of dog training or fence;
5. Flexible and adjustable stimulus intensity from level 1 to levels 5 to fit various size dogs;
6. We can use Google Maps in "My Pet Paradise" to draw the security fence we need with Circular Boundary or Polygon Boundary
7. Once your dog steps out of the safety fence, the stimulation will automatically start, and we have 1-4 levels to choose (Note: 1. Light warning 2. Light+alarm sound 3. Light+alarm sound+vibration 4. Light+alarm sound+vibration electric shock);
8. IP67 waterproof, suitable for different scenarios;
9. The product comes with a step counting function. The dog stays still for two minutes, and the system enters sleep mode until the

dog walks for more than 8 steps before resuming operation to save more usage time, We can set it up by clicking on the operation(1, Click on the icon(P1). 2, Click “Set” (P2). 3, Appear: Automatic sleep keep, select whether you need it or not according to the following

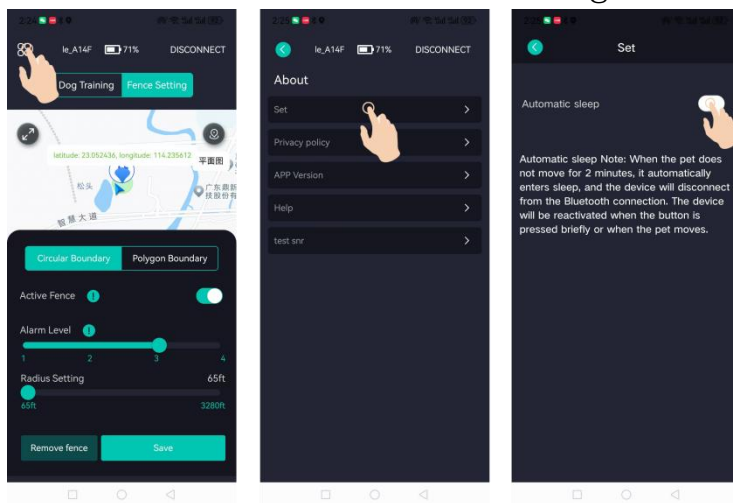

prompts)

10. We can switch between flat and 3D maps according to our

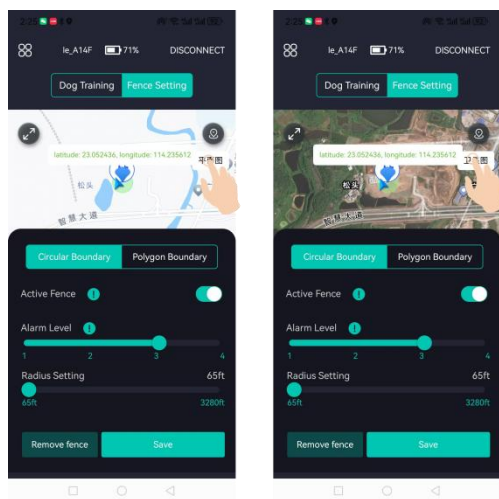

preferences. (P1/P2)

Product Instructions

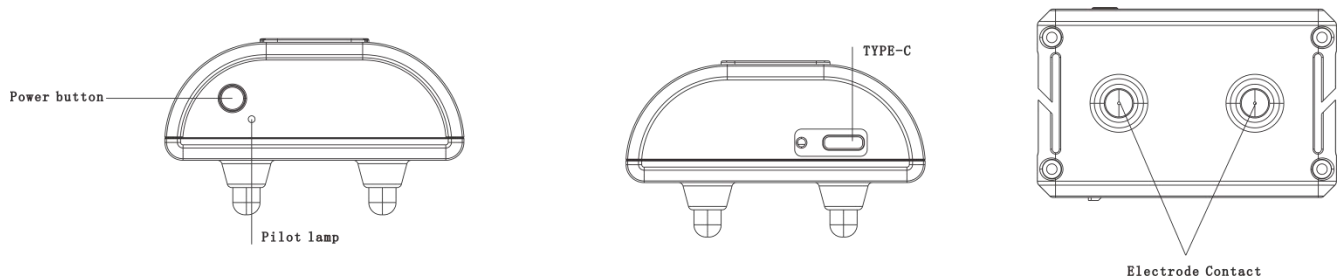

Charging the GPS fence system

Please fully charge the GPS fence system before use it and it will take about 3-4 hours.

When charging the battery indicator will flash in red color and stop flashing when fully charged, Flash in green color.

Low battery alert: when the battery indicator is continuous red light and fast flashing it means low battery and please recharge it.

How to use it:

1. Search for mobile application" My Pet Paradise", Or directly scan the QR code on the packaging box, Download to mobile phone.

2. Open" My Pet Paradise" APP, Turn on the switch on our collar(P1) , Then turn on your phone's Bluetooth, Click on the app" CONNECT" key(P2) , Our product's Bluetooth name will appear(P3) , Click, Will prompt" Linked already"(P4)

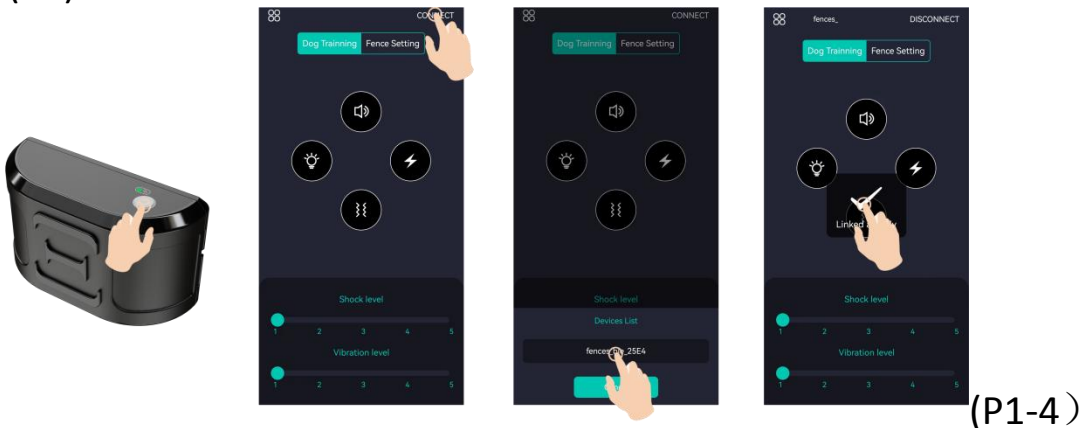

3. "Dog Training":

As indicated in the following diagram(P5) , among" Digit, Beeper", Only one level function is available, Shock level 1-5, Vibration level 1-5 (each triggered

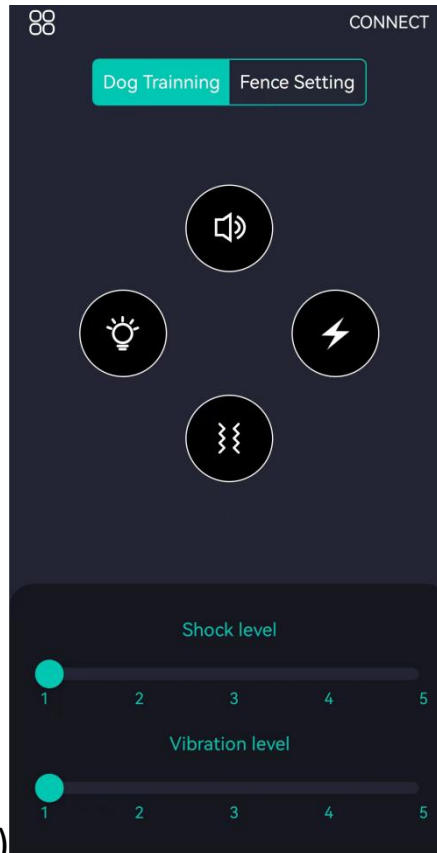

Function works for 5 seconds) (P5)

4. "Fence Setting":(The map can be opened in flat or 3D format)(p1)

1) Circular Boundary:Click on the appropriate location on the map as the origin(P6) ,There are 50-3280FT radius options available below.Choose our suitable size fence,Click Save key,Complete the setting of of our fence.If you want to reset,Clock Remove fence key,Reset as before.After setting the fence,Click Active fence key,Wait for 1-2 minutes until the dog head image is displayed on the map (P7) ,GPS signal received successfully and can now be

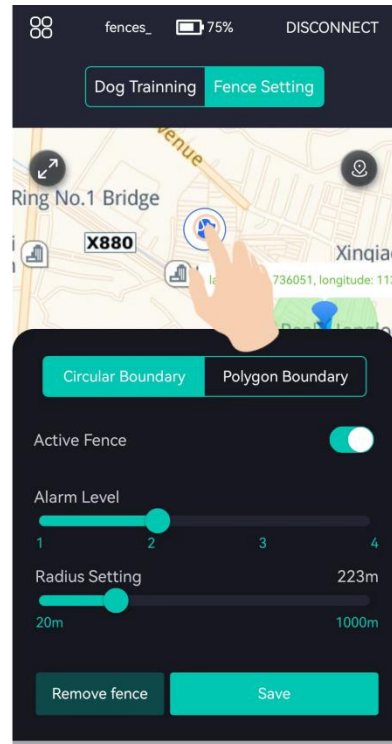
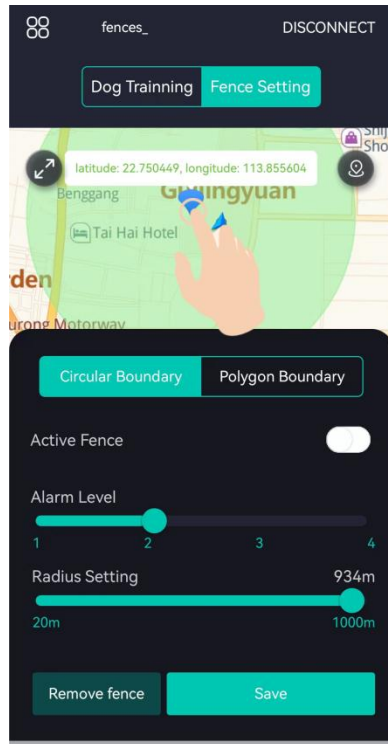

used normally.

(P6-7)

2) Polygon Boundary: Click on the fence you need on the map using polygons, Can be clicked multiple times, connecting two points in a straight line, If you click the wrong button, you can press Revoke key, Save your choose (P8) ,, Click Active Fence KEY, Wait for 1-2 minutes until the dog head image is displayed on the map, GPS signal received successfully and can now be used normally.

(On our fence mode "Alarm level" 1-4: 1 representing light warning, 2 representing light and beeper warnings, 3 representing light , beeper and vibration warnings , 4 representing light , beeper, vibration and electric

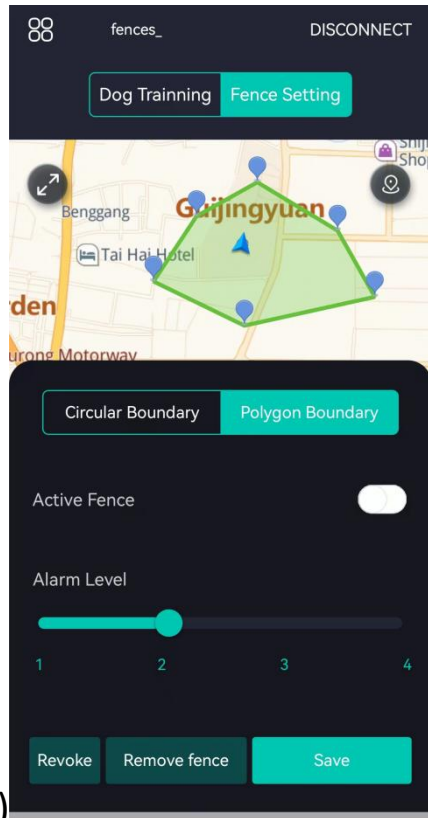

shock warnings) (P8)

5. Stimulus settings and operation as following:

When the dog is 1 meter away from the set fence,a red light will be displayed as a warning.if it exceeds the fence,a punishment will be issued according to the warning level you set above until it returns to the fence.If your dog is stubborn and still outside the fence,after 3 warning level cycles,it will emit a 35S beeper sound and turn off the punishment to better protect your beloved pet.When your dog returns to the fence,the fence mode will continue to work.

6. How to wear it

Put the collar and wear it on your dog's neck with proper tightness.

Important:the proper fitness and placement of your collar is important for effective training.the contact points must direct contact with your dog's skin.

7. Set stop counting function

To save more usage time, we can activate our product's step counting function.Open the app,click the set button" (p1),and open automatic sleep(p2).There are also definition explanations inside(it is recommended to open it according to your own needs)

Important Notes

1. When setting up fences and training dogs,be sure to ensure that your phone and collar are connected via Bluetooth.
2. The fence system might not position the initial point due to the poor satellite signal. So that,please use this fence system in an open area,which do not have high-rise buildings around it.
3. This product is only for behavioral training of pets such as dogs or cats,Do not use it on human.
4. Please keep this product away from children to avoid their playing causing unintended electric shock.

5. DO NOT leave the collar on your dog for more than 8 hours per day.

6. The fence system has a built-in rechargeable battery. please fully charge it before using, to avoid any unexpected shutdown or a unsatisfied result during training.

7. When the device is put on the dog's neck, please make sure the tightness is appropriate. Being too loose or too tight will evidently affect the training effect or cause discomfort to the dog.

This device complies with part 15 of the FCC Rules. Operation is subject to the following two conditions: (1) this device may not cause harmful interference, and (2) this device must accept any interference received, including interference that may cause undesired operation.

Any changes or modifications not expressly approved by the party responsible for compliance could void the user's authority to operate the equipment.

NOTE: This equipment has been tested and found to comply with the limits for a Class B digital device, pursuant to Part 15 of the FCC Rules. These limits are designed to provide reasonable protection against harmful interference in a residential installation. This equipment generates, uses and can radiate radio frequency energy and, if not installed and used in accordance with the instructions, may cause harmful interference to radio communications. However, there is no guarantee that interference will not occur in a particular installation.

If this equipment does cause harmful interference to radio or television reception, which can be determined by turning the equipment off and on, the user is encouraged to try to correct the interference by one or more of the following measures:

- Reorient or relocate the receiving antenna.
- Increase the separation between the equipment and receiver.
- Connect the equipment into an outlet on a circuit different from that to which the receiver is connected.
- Consult the dealer or an experienced radio/TV technician for help.

The device has been evaluated to meet general RF exposure requirement. The device can be used in portable exposure condition without restriction