

3-in-1 Wireless Charging Station

User Manual

Model: SR6

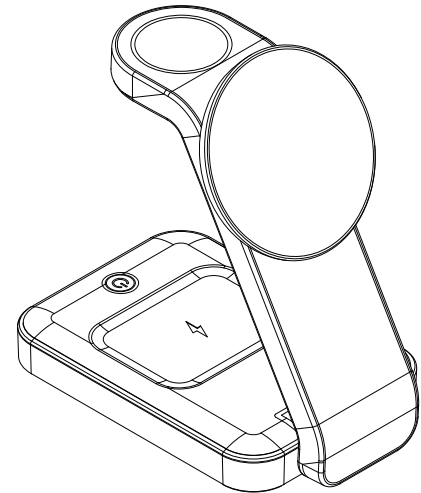

EN

Thank you for buying this product.
Before using this product, please read carefully and strictly abide by the instructions and precautions of use.

Product Diagram

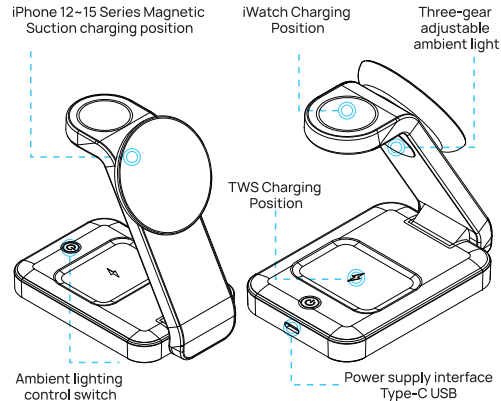

Packing List

Portable Magnetic Wireless Charger x1
USB Data Cable x1
User Manual x1
PD 20W Adapter x1

Specifications

Name	3-in-1 Wireless Charging Station
Charging Port	Type-c
Input	9V --- 2.22A/12V --- 1.67A
Output 1	15W Max (Phone)
Output 2	5W Max (TWS)
Output 3	2.5W Max (iWatch)
Total Output	15W Max
Size	136*70*38mm

Operating Steps

Please use the adapter that comes with the package. A adapter that is PD 20W or QC3.0 can also be used. When the device is plugged into the Type-C cable and powered on, the ambient light will turn white (the default brightness is 1 gear). The phone can be placed in the magnetic adsorption position to charge. When the ambient light is off, the working mode is:

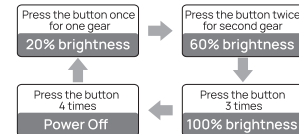

When your cell phone, iWatch and TWS need to be charged, just simply place the device flat on the corresponding charging position, and the magnetic wireless charging stand will start charging the device in 0.1 seconds. During the charging process, you can remove the device to stop charging at any time if necessary. Horizontal or vertical charging depending on your needs.

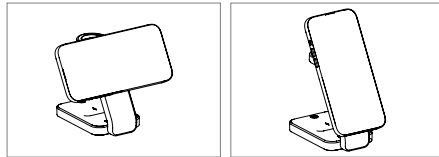

Precautions

It is forbidden to immerse the device in water to avoid short of the internal circuit.
It is strictly prohibited to disassemble or knock the equipment without permission to avoid damaging the device.
Please place the device away from liquids, flammable and explosive objects.
Do not place magnetic cards, magnetic stripe media and precision machinery too close to the device.

FCC Warning

This device complies with part 15 of the FCC Rules. Operation is subject to the following two conditions:
(1) This device may not cause harmful interference, and (2) this device must accept any interference received, including interference that may cause undesired operation.
Any Changes or modifications not expressly approved by the party responsible for compliance could void the user's authority to operate the equipment. This equipment has been tested and found to comply with the limits for a Class B digital device, pursuant to part 15 of the FCC Rules. These limits are designed to provide reasonable protection against harmful interference in a residential installation. This equipment generates uses and can radiate radio frequency energy and, if not installed and used in accordance with the instructions, may cause harmful interference to radio communications. However, there is no guarantee that interference will not occur in a particular installation. If this equipment does cause harmful interference to radio or television reception, which can be determined by turning the equipment off and on, the user is encouraged to try to correct the interference by one or more of the following measures:
- Reorient or relocate the receiving antenna.
- Increase the separation between the equipment and receiver.
- Connect the equipment into an outlet on a circuit different from that to which the receiver is connected.
- Consult the dealer or an experienced radio/TV technician for help.

FCC RF exposure statement:

The equipment complies with FCC radiation exposure limits set forth for an uncontrolled environment. This equipment should be installed and operated with minimum distance between 20cm the radiator your body.



Konformitätserklärung
Shenzhen Muweisan Technology Co., Ltd. erklärt hiermit, dass Produkttyp die Richtlinien 2014/53/EU erfüllt. Der vollständige Text der EU-Konformitätserklärung ist unter der folgenden Internetadresse verfügbar:
<https://www.eazpowertech.com>
Shenzhen Muweisan Technology Co., Ltd.
Room 613, 6 Floor, Xusheng R&D Building, Xi'fa District B, Gonghe Industrial Rd., Longteng Community, Xi'xiang street, Bao'an District, Shenzhen City, Guangdong Province, China 518102

Dieses Produkt erfüllt die Anforderungen der Europäischen Gemeinschaft an Funkstörungen.

	Verwendung nur in Innenbereichen
	Dieses Symbol bedeutet, dass das Produkt nicht als Hausmüll entsorgt werden darf. Stattdessen ist es an der jeweiligen Sammelstelle für das Recycling von Elektro- und Elektronikgeräten abzugeben.

eazpower
Easy Power, Easy Go

support@eazpowertech.com
 <https://www.eazpowertech.com>