

3-in-1 Wireless Charging Station

User Manual

Model: EZ30

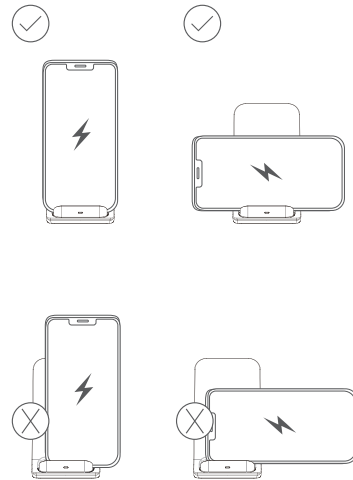
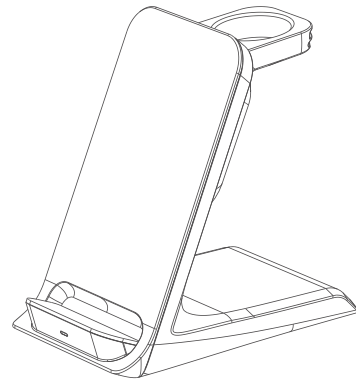

EN

Thank you for buying this product. Before using this product, please read carefully and strictly abide by the instructions and precautions of use.

Product Details

1. Wireless Charging Area1 (Phone)
2. Wireless Charging Area2 (TWS)
3. Wireless Charging Area3 (iWatch)
4. Indicator Light
5. Type-C USB

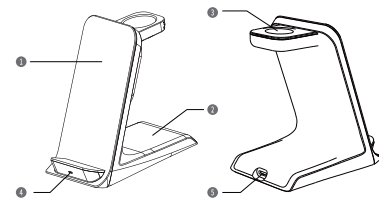

Specification

Input: 9V==2.22A/12V==1.67A
Output 1: 15W Max (Phone)
Output 2: 5W Max (TWS)
Output 3: 2.5W Max (iWatch)

Total Output: 15W Max
Size: 115*74*124mm
Max Phone Charging Distance:
10mm(0.39")

How it works

1. Connection Instruction

- a. Connect the power supply according to the diagram.
- b. Place the device on the wireless charging surface.
- c. When the indicator light is on continuously, it means that the device is charging.

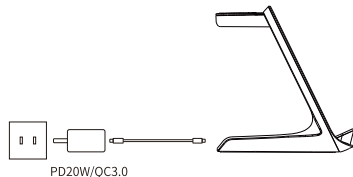

2. Power Indicator Light Instruction

| LED Indicator Status | Status |
|--|--|
| The green and sky blue lights flash once and then turn off | Connected to the power |
| a. The green light is on b. The blue light is on c. The sky blue light is on | a. Charging (Phone) b. Charging (TWS) c. Charging all |
| Flashing green | Metal object detected while charging, over-voltage or under-voltage protection activated |

Attention

- a. Please use PD20W or QC3.0 compatible power adapter for fast charging.
- b. It is normal to get hot while charging, if your phone gets hot seriously and stops charging for a long time, please adjust the position of the charger. Please make sure the center of the charger is aligned with the center of the wireless charger charging zone before charging.

Important Safety Instructions

1. Do not squeeze or collide.
2. Do not disassemble or put it into fire or water to avoid short circuit and leakage.
3. Do not use the wireless charger in high temperature, high humidity or corrosive environments to avoid circuit damage and current leakage.
4. Do not place the wireless charger too close to magnetic cards with magnetic stripes or chips (ID cards, bank cards, etc.) to avoid the magnetic cards becoming invalid.
5. Please stay away from implanted medical devices (pacemakers, implantable headphones, etc.) to avoid magnetic card failure. The distance between the device and the wireless charger should be at least 20 cm to avoid possible interference with medical devices.
6. Children should be supervised to ensure that they do not use the wireless charger as a toy to avoid unnecessary accidents.
7. The charger and receiver should be kept away from water and other liquids.
8. If you need to clean the charger, please disconnect the power supply.
9. Please use it at an ambient temperature of 0-45°C.
10. This product is suitable for mobile phones, headsets and iWatch 2-9 that support Qi protocol.

Package Contents

- | | |
|---------------------|-------------------|
| 1x Wireless Charger | 1x User Manual |
| 1x Charging Cable | 1x PD 20W Adapter |

FCC Warning

This device complies with part 15 of the FCC Rules. Operation is subject to the following two conditions:

1. This device may not cause harmful interference.
2. This device must accept any interference received, including interference that may cause undesired operation.

Any Changes or modifications not expressly approved by the party responsible for compliance could void the user's authority to operate the equipment.

This equipment has been tested and found to comply with the limits for a Class B digital device, pursuant to part 15 of the FCC Rules.

These limits are designed to provide reasonable protection against harmful interference in a residential installation. This equipment generates uses and can radiate radio frequency energy and, if not installed and used in accordance with the instructions, may cause harmful interference to radio communications. However, there is no guarantee that interference will not occur in a particular installation. If this equipment does cause harmful interference to radio or television reception, which can be determined by turning the equipment off and on, the user is encouraged to try to correct the interference by one or more of the following measures:

1. Reorient or relocate the receiving antenna.
2. Increase the separation between the equipment and receiver.
3. Connect the equipment into an outlet on a circuit different from that to which the receiver is connected.
4. Consult the dealer or an experienced radio/TV technician for help.

FCC RF exposure statement:

The equipment complies with FCC radiation exposure limits set forth for an uncontrolled environment. This equipment should be installed and operated with minimum distance between 20cm the radiator your body.



Konformitätserklärung
Shenzhen Muweisan Technology Co., Ltd. erklärt hiermit, dass Produkttyp die Richtlinien 2014/53/EU erfüllt. Der vollständige Text der EU-Konformitätserklärung ist unter der folgenden Internetadresse verfügbar:

<https://www.eazpowertech.com>

Shenzhen Muweisan Technology Co., Ltd.

Room 613, 6 Floor, Xusheng R&D Building, Xi'fa District B, Gonghe Industrial Rd., Longteng Community, Xi'xiang street, Bao'an District, Shenzhen City, Guangdong Province, China 518102

Dieses Produkt erfüllt die Anforderungen der Europäischen Gemeinschaft an Funkstörungen.

| | |
|--|---|
| | Verwendung nur in Innenbereichen |
| | Dieses Symbol bedeutet, dass das Produkt nicht als Hausmüll entsorgt werden darf. Stattdessen ist es an der jeweiligen Sammelstelle für das Recycling von Elektro- und Elektronikgeräten abzugeben. |

eazpower
Easy Power, Easy Go

support@eazpowertech.com
 <https://www.eazpowertech.com>