

Quick Start Guide

OZERX

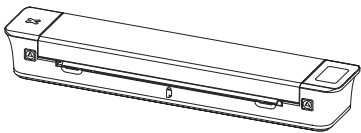

1. Product Introduction

1.1 Packing List

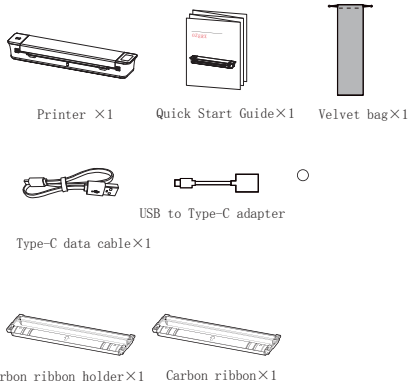

① The carbon ribbon has been placed inside the printer.

1.2 Printer Component Guide

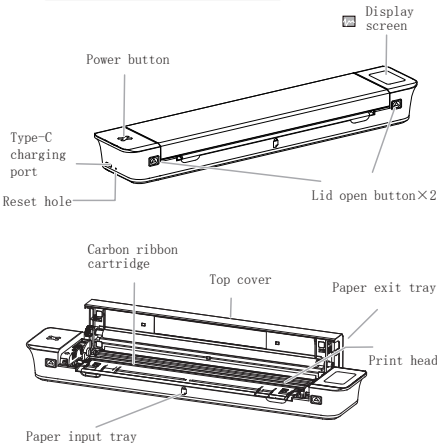

2. Quick Start

2.1 App download

Method 1: Please search for the 'Quick Stencil' application on the App Store or Google Play™, and download and install it.



2.2 Paper loading guide

1、"Press and hold the power button for 3 seconds to turn on the printer until the display screen lights up."

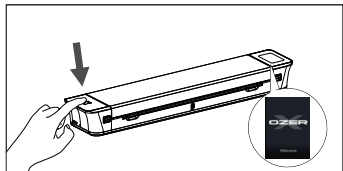

2、"Take out a single tattoo paper and insert it smoothly into the paper input tray until the printer automatically feeds the paper. The display screen will show 'Ready' status, indicating that the paper loading is complete."

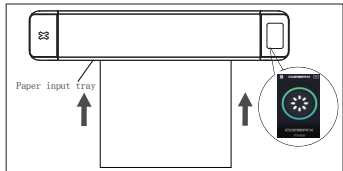

① "The single tattoo paper does not have a front or back side. If the carbon ribbon is already inserted in the machine, you can directly insert the paper into the printer for use."

2.3 Mobile Device User Guide

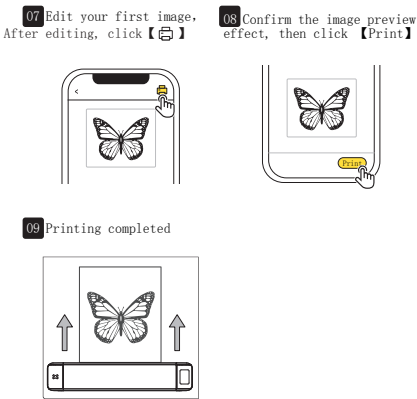
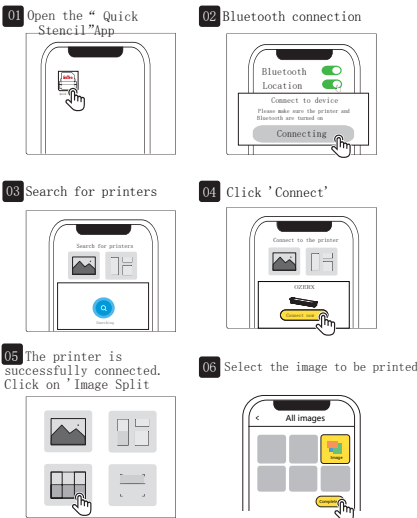

2.4 Computer Usage Guide

01 Please ensure that the printer is powered on and connect it to the computer using the original Type-C data cable.

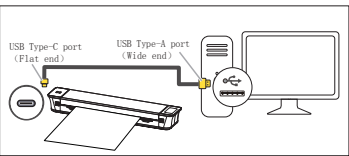

① If your computer has a Type-C interface, you can use the provided adapter to convert the interface. Insert the Type-C end of the adapter into your computer.
The adapter is designed for one-way transmission. It may not transmit data when the Type-C end of the adapter is inserted into the printer.

02 Please visit ozquickstencil.com

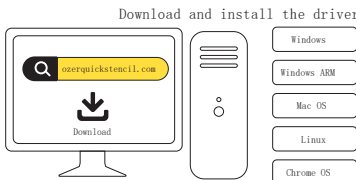

03 Select and open the file you want to print

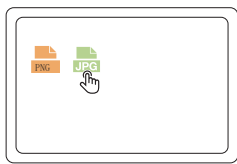

① The printer supports printing JPG, PNG, and other file formats

04 Click [Print]

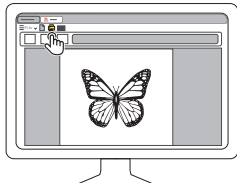

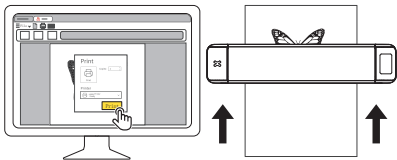

05 Select the OZERX Printer, click on 'Print' to start printing

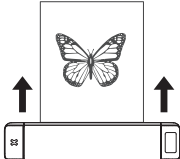

06 Take out the printed tattoo paper, and use it with tattoo paste (to be purchased separately) to begin using it

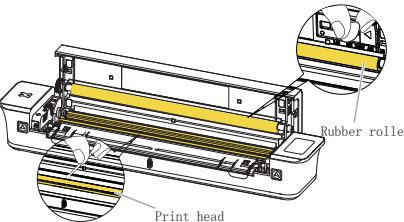
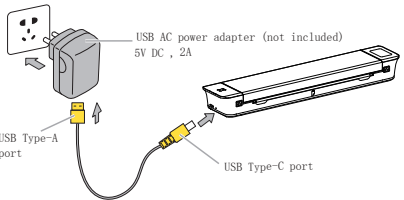
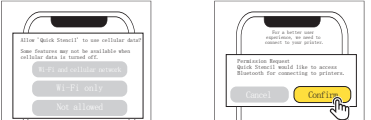

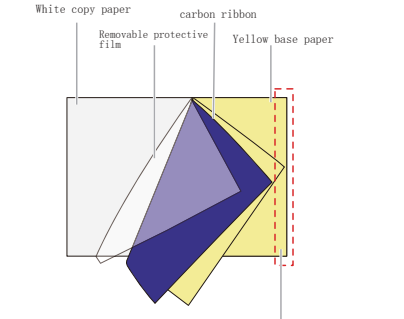
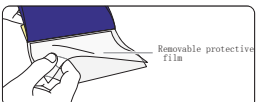
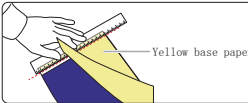
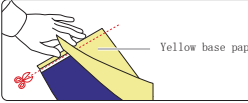
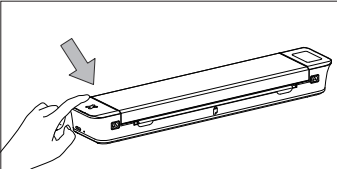
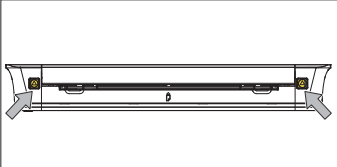
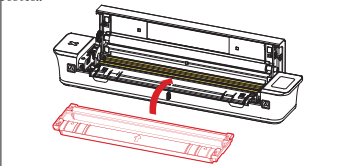
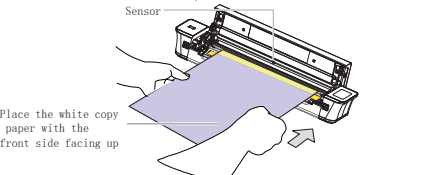
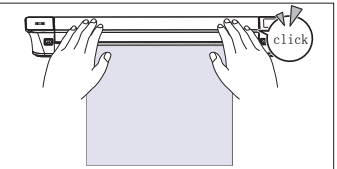
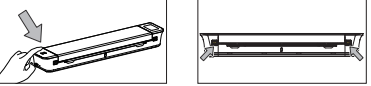
<h3>3.Cleaning and maintenance</h3> <p>① Before performing any cleaning or maintenance, please make sure to disconnect the printer from the power source.</p> <p>② If you have just finished printing, please wait for half an hour to allow the print head to cool down completely. If you encounter issues like blank lines, blurry or missing text, it may be due to dirt on the print head. Please follow the steps below to resolve the issue.</p> <p>01.Dip a cotton swab in alcohol or use an alcohol-soaked cotton ball (make sure it's not dripping), and gently wipe back and forth for 5 times on both sides. Clean the dust, stains, and other debris from the rubber roller and print head surface.</p> <p>02.Wait for 5-10 minutes until the alcohol completely evaporates, then close the lid. Cleaning is now completed.</p>  <p>Rubber roller</p> <p>Print head</p> <p>⚠ Print head warning: Hot component! Contacting this component may cause burns to fingers. Wait for half an hour after powering off before touching the component.</p>		<h3>4.Charging instructions</h3> <p>01.Please prepare a 5V DC/2A direct current Type-A interface power adapter on your own.</p> <p>02.Please connect the Type-C end of the USB charging cable to the charging port of the OZERX printer. Connect the Type-A end of the USB charging cable to the Type-A interface of the power adapter.</p> <p>03. After the connection is completed and plugged into the socket, please check the status of the printer indicator light. When the printer is in the off state, the display screen shows . When the printer is in the on state, the top right corner of the display screen shows .</p> <p>04. Please charge for at least 20 minutes for quick use. Charging for 4 hours will complete the charging process, or until the top right corner of the display screen shows .</p> <p>05. During the charging process, the printer may generate temperature changes. Please do not place the printer on materials such as cotton or linen while charging.</p>  <p>USB AC power adapter (not included) 5V DC, 2A</p> <p>USB Type-A port</p> <p>USB Type-C port</p> <p>06. After charging is complete, please promptly unplug the charger. Using the printer while it is being charged may affect the charging speed, printing quality, and battery lifespan."</p>		<h3>5.More help</h3> <h4>5.1 Button instructions</h4> <table><thead><tr><th>Button types</th><th>Operating instructions</th><th>Function description</th></tr></thead><tbody><tr><td rowspan="3">Power button</td><td>Long press for 3 seconds</td><td>Power on/off</td></tr><tr><td>Print self-test</td><td>Double-click while in the power-on state</td></tr><tr><td>page content</td><td></td></tr></tbody></table> <h4>5.2 Printer status description</h4> <table><thead><tr><th>Display screen status</th><th>Status description</th><th>Operating instructions</th></tr></thead><tbody><tr><td></td><td>Normal use</td><td>/</td></tr><tr><td></td><td>Not installed ribbon</td><td>Insert ribbon</td></tr><tr><td></td><td>No paper inserted</td><td>Insert paper</td></tr><tr><td></td><td>Printer cover open</td><td>Close the top cover</td></tr><tr><td></td><td>Printer overheating</td><td>Pause printing for 5-10 minutes</td></tr></tbody></table>		Button types	Operating instructions	Function description	Power button	Long press for 3 seconds	Power on/off	Print self-test	Double-click while in the power-on state	page content		Display screen status	Status description	Operating instructions		Normal use	/		Not installed ribbon	Insert ribbon		No paper inserted	Insert paper		Printer cover open	Close the top cover		Printer overheating	Pause printing for 5-10 minutes	<h3>5.3 Printer battery level description</h3> <table><thead><tr><th>Display screen status</th><th>Status description</th><th>Operating instructions</th></tr></thead><tbody><tr><td></td><td>Fully charged</td><td>/</td></tr><tr><td></td><td>The battery level is greater than 50%</td><td>/</td></tr><tr><td></td><td>less than 50%</td><td>/</td></tr><tr><td></td><td>Battery level is less than 20%</td><td>Charge for 1 hour (if you need to use it urgently, please charge for at least 20 minutes)</td></tr><tr><td></td><td>Charging while the device is powered on</td><td>/</td></tr><tr><td></td><td>Charging while the device is powered off</td><td>/</td></tr><tr><td colspan="2">Long press the power button, but the screen doesn't light up</td><td>Battery is depleted</td></tr><tr><td colspan="2"></td><td>Charge for 4 hours</td></tr></tbody></table> <h3>5.4 Instructions for obtaining permissions</h3> <h4>01 Notice for IOS users</h4> <ul style="list-style-type: none">App requesting network permissionApp requesting Bluetooth permission 		Display screen status	Status description	Operating instructions		Fully charged	/		The battery level is greater than 50%	/		less than 50%	/		Battery level is less than 20%	Charge for 1 hour (if you need to use it urgently, please charge for at least 20 minutes)		Charging while the device is powered on	/		Charging while the device is powered off	/	Long press the power button, but the screen doesn't light up		Battery is depleted			Charge for 4 hours	<h4>02 Notice for Android users:</h4> <ul style="list-style-type: none">App requesting Bluetooth permissionPermission required for the phone system to access and search nearby Bluetooth devices  <p>① For Android 12 and above, it is required to allow the app to search for nearby Bluetooth devices:</p> <p>For Android versions below Android 12, GPS permission must be enabled to search for nearby Bluetooth devices:</p> <ul style="list-style-type: none">Mobile system Bluetooth pairing prompt  <p>② No need to check 'Allow access to your contacts and call logs', simply click 'Pair'</p>	
Button types	Operating instructions	Function description																																																														
Power button	Long press for 3 seconds	Power on/off																																																														
	Print self-test	Double-click while in the power-on state																																																														
	page content																																																															
Display screen status	Status description	Operating instructions																																																														
	Normal use	/																																																														
	Not installed ribbon	Insert ribbon																																																														
	No paper inserted	Insert paper																																																														
	Printer cover open	Close the top cover																																																														
	Printer overheating	Pause printing for 5-10 minutes																																																														
Display screen status	Status description	Operating instructions																																																														
	Fully charged	/																																																														
	The battery level is greater than 50%	/																																																														
	less than 50%	/																																																														
	Battery level is less than 20%	Charge for 1 hour (if you need to use it urgently, please charge for at least 20 minutes)																																																														
	Charging while the device is powered on	/																																																														
	Charging while the device is powered off	/																																																														
Long press the power button, but the screen doesn't light up		Battery is depleted																																																														
		Charge for 4 hours																																																														
<h3>6. More paper types</h3> <h4>6.1 Tattoo paper + empty support</h4> <p>01.Tattoo paper introduction</p>  <p>① This is the adhesive area at the top of the paper, please do not tear it!</p>		<p>02.Preparation before use</p> <p>01 Take out the tattoo paper and remove the protective film</p>  <p>02 Use a ruler or scissors to cut the yellow base paper along the adhesive area at the top</p> <p>Method 1:</p>  <p>Method 2:</p>  <p>① Please be careful to keep the adhesive area of the paper intact while cutting</p>		<p>03.Paper loading guide</p> <p>01 Press and hold the power button for 3 seconds to power on, until the indicator light turns on</p>  <p>02 Simultaneously press the open cover button with both hands to open the top cover</p>  <p>① A single sheet of tattoo paper does not have a specific front or back. If the carbon ribbon is already inserted in the machine, you can directly insert the paper into the printer for use.</p>		<p>03 Take out the carbon ribbon empty support included in the set, and insert it into the carbon ribbon compartment following the illustrated direction</p>  <p>04 Place the white tracing paper facing up, aligning it smoothly along the direction of the paper exit. Make sure the tattoo paper covers the sensor.</p>  <p>Sensor</p> <p>Place the white copy paper with the front side facing up</p>		<p>05 Lower the top cover and place both hands on the ends of the cover. Press down simultaneously until you hear a 'click' sound, indicating that the cover is properly closed.</p>  <h3>6.2 Roll paper + built-in carbon ribbon</h3> <p>01 Press and hold the power button for 3 seconds to power on, until the indicator light turns on.</p> <p>02 Simultaneously press the open cover button with both hands to open the top cover.</p> 																																																								

03

Insert the carbon ribbon spool included in the package into the printer

04

Take out the new roll paper package and open it.

05

Remove the protective sticker from the roll paper

06

Thread the paper end of the roll through the accessory box and out through the paper exit

07

Place the accessory box at the paper feed opening of the printer. Pull out the paper end from the paper exit of the accessory box, aligning it with the position of the display screen. Lower the top cover and place both hands on the ends of the cover. Press down simultaneously until you hear a 'click' sound, indicating that the cover is properly closed.

08

Simultaneously press the open cover button with both hands to open the top cover

09

Connect the mobile app or computer driver to start printing

10

After printing is complete, use scissors to cut the printed paper from the paper exit

01

Press and hold the power button for 3 seconds to power on, until the indicator light turns on

02

Simultaneously press the open cover button with both hands to open the top cover

03

Insert the empty carbon ribbon spool included in the package into the printer

04

Take out the new roll paper package and open it

05

Unwrap the packaged carbon ribbon, and pull out the carbon ribbon end

06

Unroll the paper roll and pull out the paper end, aligning it with the top of the carbon ribbon. Stick the paper onto the adhesive

07

Pull the adhered paper out from the paper exit of the accessory box

08

09

Lower the top cover and place both hands on the ends of the cover. Simultaneously, press down until you hear a 'click' sound, indicating that the cover is closed

10

Connect the mobile app or computer driver to start printing

11

After printing is complete, use scissors to cut the printed paper from the paper exit

6.3 Roll paper + carbon ribbon combination

01

Press and hold the power button for 3 seconds to power on, until the indicator light turns on

02

Simultaneously press the open cover button with both hands to open the top cover

6.2 Bluetooth connection

01

Open the 'Quick Stencil' app

02

Tap on the Bluetooth connection icon in the upper right corner

03

Select your printer

04

Device connected successfully

01

Enable Bluetooth permissions to quickly search and connect to the printer

8. Warranty Card

☐ Return

☐ Exchange

☐ Repair

User Info	Name:	Sex:	Phone:
Product Info	Address:		
	Purchase date:		
	Product order number:		
Requirements of return /replacement /repair	Product Serial Number:		
	Reason description:		
Maintenance records	Failure condition:	Maintenance person:	
	Handling situation:	Delivery date:	
	Maintenance ticket number:	Delivery date:	

Product certification

Inspector:

Delivery date:

9. FCC Warning

1. This device complies with Part 15 of the FCC Rules. Operation is subject to the following two conditions:
(1) This device may not cause harmful interference, and
(2) This device must accept any interference received, including interference that may cause undesired operation.
2. Any Changes or modifications not expressly approved by the party responsible for compliance could void the user's authority to operate the equipment.
NOTE: This equipment has been tested and found to comply with the limits for a Class B digital device, pursuant to Part 15 of the FCC Rules. These limits are designed to provide reasonable protection against harmful interference in a residential installation. This equipment generates uses and can radiate radio frequency energy and, if not installed and used in accordance with the instructions, may cause harmful interference to radio communications. However, there is no guarantee that interference will not occur in a particular installation.
If this equipment does cause harmful interference to radio or television reception, which can be determined by turning the equipment off and on, the user is encouraged to try to correct the interference by one or more of the following measures:
—Reorient or relocate the receiving antenna.
—Increase the separation between the equipment and receiver.
—Connect the equipment into an outlet on a circuit different from that to which the receiver is connected.
—Consult the dealer or an experienced radio/TV technician for help.
FCC Radiation Exposure Statement

The device has been evaluated to meet general RF exposure requirement. The device can be used in portable exposure condition without restriction.

10. ISED Warning

This device complies with Innovation, Science and Economic Development Canada licence-exempt RSS standard(s). Operation is subject to the following two conditions:

(1) This device may not cause interference, and
(2) This device must accept any interference, including interference that may cause undesired operation of the device.
The device has been evaluated to meet general RF exposure requirement. The device can be used in portable exposure condition without restriction.

French:
Cet appareil est conforme aux normes RSS exemptées de licence d'innovation, sciences et développement économique Canada. L'exploitation est autorisée aux deux conditions suivantes:
(1) l'appareil ne doit pas produire de brouillage, et
(2) l'utilisateur de l'appareil doit accepter tout brouillage radioélectrique subi, même si le brouillage est susceptible d' compromettre le fonctionnement.
Le matériel a été évalué pour répondre aux exigences générales d'exposition aux radiofréquences. Le dispositif peut être utilisé dans des conditions d'exposition portables illimitées.