



## XPEVO Motorcycle & Powersports Stereo System USER MANUAL

www.XPEVO.com  
US +1 (984) 226-1985

©2023 Expangelly Ltd. XPEVO and all related logos are trademarks of Expangelly Ltd. or its affiliates. Expangelly Ltd. Rm C, 6/F, World Trust Tower, 50 Stanley Street, Central, HK. Made in China.

## 1. Contents

### Model: EVO32

- 2 x Speaker
- 1 x Amplifier
- 1 x Wired Control
- 3 x Mounting Clamp
- 1 x AUX Cable
- 1 x DC Power Cord
- 1 x Output Jack Connector
- 1 x User's Manual

### Model: EVO34

- 4 x Speaker
- 1 x Amplifier
- 1 x Wired Control
- 5 x Mounting Clamp
- 1 x AUX Cable
- 1 x DC Power Cord
- 1 x Output Jack Connector
- 1 x User's Manual

## 2. Features

- 3" Waterproof Speakers
- Built-In Bluetooth 4.2 for Audio Streaming
- 3.5mm AUX Input Jack
- Built-In FM Radio Receiver
- Support USB & micro SD drive
- Wired Control with LED backlit

## 3. Read Before Installation

- 1) The components and wiring should not be installed on or around any moving parts, keep away from ignition parts, fuel lines, engine or any hot exhaust.
- 2) Speakers should not be installed where they might inhibit safety features on the vehicle such as lights, horns, brake levers, etc..
- 3) Always test the speakers/amplifier prior to installation. Connect to the battery and play the music at least 3-minute to ensure the product is fully functional.
- 4) Cutting rubber insert may be required for certain bar sizes.
- 5) Splash, water and dust resistance are not permanent conditions and resistance might decrease as a result of normal wear.
- 6) To avoid battery draining, disconnect the speaker from the battery if the motorcycle/ATV is planned non-operation for more than 15 days.
- 7) Engine, pipe and wind noise will overpower any speakers once it reaches certain speeds, it is physics and unavoidable.
- 8) Please connect to a correct power supply (DC 12V)

## 4. Wiring Instruction

### Wiring diagram:

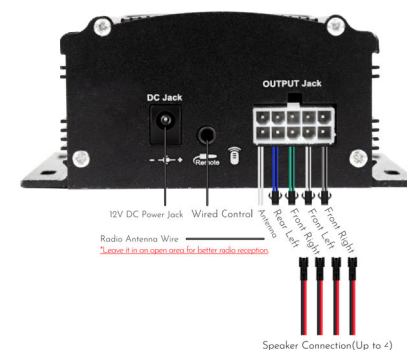

### Wiring Instruction:

- 1) Connect the speakers to the output jack connector.
- 2) Plug the wired control into the Remote jack at the back.
- 3) Leave the antenna wire in an open area for better reception.
- 4) Connect the RED wire to positive and BLACK wire to negative on a 12V battery.

### Mounting the speakers:

- 1) Screw the mounting bracket to the bottom of the speaker.
  - 2) Locate a safety mounting location on the mounting bar.
  - 3) Install the speaker with mounting clamp.
- (Cutting rubber insert may be required for certain bar sizes)

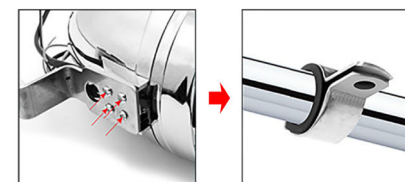

### Output Jack Connector:

- FM radio antenna wire (white)
- Rear left speaker + (blue)
- Rear left speaker - (blue/black)
- Rear right speaker - (green)
- Rear right speaker + (green/black)
- Front left speaker + (white)
- Front left speaker - (white/black)
- Front right speaker + (grey)
- Front right speaker - (grey/black)



## 5. Operation Instruction

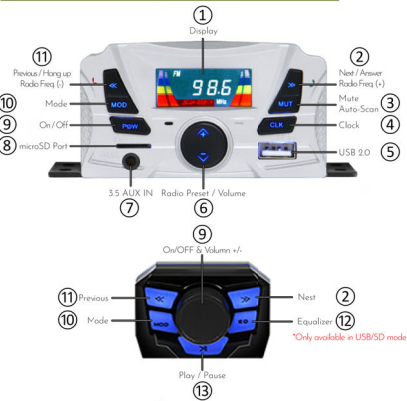

**On/OFF:** Short press ⑨ to power on / off.

**Mode:** Short press ⑩ to switch modes (FM Radio, BT, AUX-IN, USB, SD)

**EQ:** Press ⑫ to choose 5 different EQ settings. (EQ Settings are only available in USB/SD mode.)

**Clock:** Short press ④ to display the time. To set the clock, long press ④, then press ⑥ VOL+, VOL- to set the clock. Short press ④ will exit clock menu.

## 6. BT / FM / AUX / USB

**FM Radio Mode:**

1. Press ⑩ (Mode) to switch the unit in FM mode.
2. Long-press ③ (Mute) to start an auto-scanning. Short-press to mute.
3. Short-press ⑥ to select the radio presets. Long-press to adjust volume.
4. Short press ⑪ ⑫ (Previous / Next) to adjust radio frequency. Long-press to quick scan scan radio stations manually.

**Bluetooth Mode:**

1. Press ⑩ (Mode) to switch the unit in Bluetooth mode.
2. Enable Bluetooth function on your smartphone.
3. Search for Bluetooth device named "XPEVO".
4. Pair the device. (Enter 0000 if it asks for a PIN)

**AUX-IN Mode:**

1. Press ⑩ (Mode) to switch the unit to AUX-IN mode.
2. Connect the smartphone or MP3 device with included AUX cable.

**USB / micro SD Card Mode:**

Insert a USB/SD card and press mode to switch to USB/SD.

NOTE:

USB / SD drive must be in FAT format with MP3 music files. If no USB / SD drive is inserted, the stereo will skip the mode automatically.

## 7. Troubleshooting

**The unit is not turning on:**

1. The wired control should be plugged at the back, not in the front.
2. Make sure the RED wire is connected to positive, BLACK wire to negative
3. Inspect the fuse, replace it if blown.
4. Check if the battery is in good condition, unit required at least 12V to operate. Contact us if the above steps do not work.

**Volume is not loud enough:**

1. Check if both speakers are in working condition.
2. Adjust the speaker direction toward the driver's position.
3. Turn on the volume all the way up on BOTH stereo unit AND music device (such as smartphone and mp3 player)
4. Check if the battery has at least 12V after motorcycle startup.
5. Contact us if the above steps do not fix the issue.

**Mounting clamp does not fit:**

1. Mounting clamp is designed for bar size up to 1/4" (32mm)
2. Custom mounting may be required if your bar size is not within the recommended size.
3. Contact us if you have trouble installing the item.

## 8. Specifications

**Amplifier:**

Working Voltage: DC 12V  
Rated Power: 4\*25W @ 4Ω  
Peak Power: 180W  
Channel: 4.0  
Channel separation: >60dB  
Frequency range: 87.5-108MHz  
Fuse rating: 6A

**Speaker:**

Outline Size: 3-3/8" x 4"  
Speaker Core: 3"  
Rated Power: 15W  
Impedance: 4Ω  
Resonance Frequency: 165HZ  
Effective Frequency: Fo-12kHz  
Sensitivity: 88dB

## 9. Warranty

**REGISTER YOUR PRODUCT:**  
[www.xpevo.com/warranty](http://www.xpevo.com/warranty)

**1-Year Limited Parts Warranty:**

All XPEVO products purchased in the United States are warranted for a period of one year from the purchase date against defects in materials and workmanship. We will provide you with free parts for one year after your purchase. The warranty is for replacement at the sole discretion of the selling dealer. If we choose to replace your product, we may replace it with a new or reconditioned unit of the same or similar design. The customer is responsible for freight charges incurred to return the product.

For all other countries, contact our technical support where you must send a copy of the original invoice with the date of purchase. Please enclose a letter stating the problem you are having with the product, your daytime phone number, and your return shipping address (no P.O. Box). Contact us to receive an RA# before sending your defective item. This warranty does not cover any unit subject to abuse, neglect, incorrect wiring, water and/or physical damage, or any repair or modification performed by someone other than a XPEVO repair technician.

Any damages resulting from legal action for breach of expressed or implied warranties shall be limited to the cost of the original purchase price of the unit. As a condition of this warranty, it is agreed that the remedy provided in this document is the sole remedy under this warranty. All liability for coincidental damages is excluded. The purchaser agrees to retain the original proof-of-purchase for establishing the effective date of this warranty. Should XPEVO or an authorized dealer replace your product under warranty, this replacement shall be considered a transaction under the original warranty and does not extend the original warranty period.

## 10. Product Support

[www.XPEVO.com](http://www.XPEVO.com)  
Email: [info@xpevo.com](mailto:info@xpevo.com) Tel: US +1 (984) 226-1988

**FCC Caution:**

This device complies with part 15 of the FCC Rules. Operation is subject to the following two conditions: (1) this device may not cause harmful interference, and (2) this device must accept any interference received, including interference that may cause undesired operation.

Any changes or modifications not expressly approved by the party responsible for compliance could void the user's authority to operate the equipment.

NOTE: This equipment has been tested and found to comply with the limits for a Class B digital device, pursuant to Part 15 of the FCC Rules. These limits are designed to provide reasonable protection against harmful interference in a residential installation. This equipment generates, uses and can radiate radio frequency energy and, if not installed and used in accordance with the instructions, may cause harmful interference to radio communications. However, there is no guarantee that interference will not occur in a particular installation.

If this equipment does cause harmful interference to radio or television reception, which can be determined by turning the equipment off and on, the user is encouraged to try to correct the interference by one or more of the following measures:

- Reorient or relocate the receiving antenna.
- Increase the separation between the equipment and receiver.
- Connect the equipment into an outlet on a circuit different from that to which the receiver is connected.
- Consult the dealer or an experienced radio/TV technician for help.

**RF Exposure**

This device complies with FCC radiation exposure limits set forth for an uncontrolled environment. This equipment should be installed and operated with minimum distance 20cm between the radiator & your body.

**ISED Statement:**

English: This device contains licence-exempt transmitter(s)/receiver(s) that comply with Innovation, Science and Economic Development Canada's licence-exempt RSS(s). Operation is subject to the following two conditions:

- (1) This device may not cause interference.
  - (2) This device must accept any interference, including interference that may cause undesired operation of the device.
- The digital apparatus complies with Canadian CAN ICES-3 (B)/NMB-3(B).

French: Cet appareil contient des émetteurs/récepteurs exempts de licence qui sont conformes aux RSS exemptés de licence d'Innovation, Sciences et Développement économique Canada.

L'exploitation est soumise aux deux conditions suivantes :

- (1) Cet appareil ne doit pas provoquer d'interférences.
  - (2) Cet appareil doit accepter toute interférence, y compris les interférences susceptibles de provoquer un fonctionnement indésirable de l'appareil.
- L'appareil numérique du ciem conforme canadien peut - 3 (b) / nmb - 3 (b).

This device meets the exemption from the routine evaluation limits in section 5.3.2 of RSS 102 and compliance with RSS 102 RF exposure, users can obtain Canadian information on RF exposure and compliance.

cet appareil est conforme à l'exemption des limites d'évaluation courante dans la section 5.3.2 du cnr - 102 et conformité avec rss 102 de l'exposition aux rf, les utilisateurs peuvent obtenir des données canadiennes sur l'exposition aux champs rf et la conformité.

This equipment complies with Canada radiation exposure limits set forth for an uncontrolled environment.

Cet équipement est conforme aux limites d'exposition aux rayonnements du Canada établies pour un environnement non contrôlé.

This equipment should be installed and operated with minimum distance 20cm between the radiator & your body.

Cet équipement doit être installé et utilisé à une distance minimale de 20 cm entre le radiateur et votre corps.