

**FCC WARNING:**  
This device complies with part 15 of the FCC Rules. Operation is subject to the following two conditions:  
(1) This device may not cause harmful interference, and (2) this device must accept any interference received, including interference that may cause undesired operation.

**Note:**  
This equipment has been tested and found to comply with the limits for a Class B digital device, pursuant to part 15 of the FCC Rules. These limits are designed to provide reasonable protection against the risk of interference in a residential installation. This equipment generates and can receive radio frequency energy and, if not properly installed and used, may cause interference to radio communications. Proper installation is the best way to reduce the risk of interference. This equipment is designed to be used in a residential installation. Interference to radio communications may occur if the equipment is not installed and used in accordance with the instructions. You may need to take certain steps to reduce the risk of interference, which can be determined by turning the equipment off and on. You are encouraged to try to correct the interference by one or more of the following measures:  
Reorient or relocate the receiving antenna.  
Increase the separation between the equipment and the receiver.  
Connect the equipment into an outlet on a circuit different from that to which the receiver is connected.  
Consult the dealer or an experienced radio/television repair person for help.

**MOORE DATA**

**BeKey**



**User Manual**  
ES1

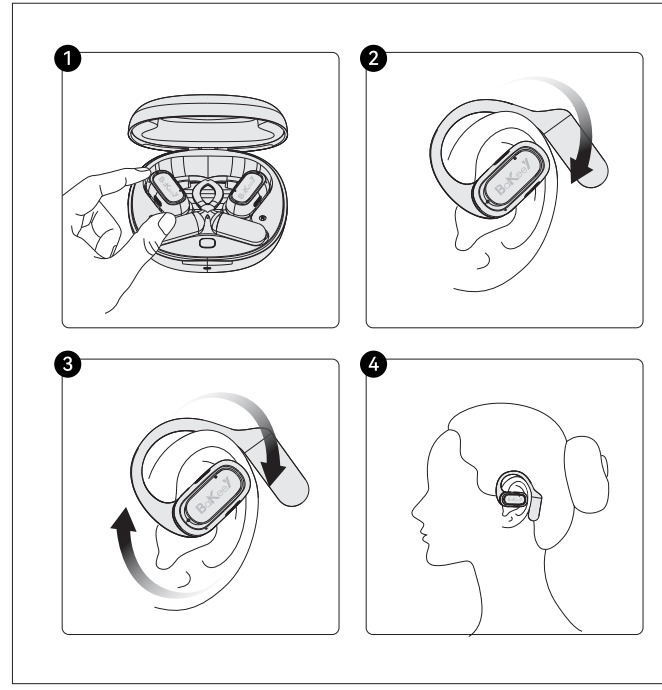

**Contents**

English ..... 01-12

Deutsch ..... 13-24

Fransis ..... 25-36

Italiano ..... 37-48

Español ..... 49-60

**PACKAGE CONTENTS**

Headphones\*1  
Charging Case\*1  
Charging Cable\*1  
User Manual\*1

**PRODUCT INTRODUCTION**

- Headphone Charging Status Indicator
- Touch Area
- Status Indicator
- Charging Interface
- Charging Pin
- Charging Contacts
- Smart Screen
- MUSIC-Function Button

\*Please use the provided Type-C Charging Cable to charge.

**CHARGE**

- Place the earbuds into the charging case. The charging status indicator light will light up.
- Put the earbuds into the charging case. The earbuds status indicator light will light up.
- Charging status indicator light will light up when the earbuds are fully charged.
- The charging box cannot be charged if 2 times.

**PAIRING**

- Automatic pairing after opening lid.
- Press and hold the touch area for 5 seconds to enter pairing mode. The earbuds will start pairing with the smartphone.
- Press and hold the touch area for 5 seconds to enter pairing mode. The earbuds will start pairing with the smartphone.
- Press and hold the touch area for 5 seconds to enter pairing mode. The earbuds will start pairing with the smartphone.

**FUNCTION**

1	1/4	1/4	1/4
2	2/4	2/4	2/4
3	3/4	3/4	3/4
4	4/4	4/4	4/4
5	5/4	5/4	5/4
6	6/4	6/4	6/4
7	7/4	7/4	7/4
8	8/4	8/4	8/4
9	9/4	9/4	9/4
10	10/4	10/4	10/4
11	11/4	11/4	11/4
12	12/4	12/4	12/4
13	13/4	13/4	13/4
14	14/4	14/4	14/4
15	15/4	15/4	15/4
16	16/4	16/4	16/4
17	17/4	17/4	17/4
18	18/4	18/4	18/4
19	19/4	19/4	19/4
20	20/4	20/4	20/4
21	21/4	21/4	21/4
22	22/4	22/4	22/4
23	23/4	23/4	23/4
24	24/4	24/4	24/4
25	25/4	25/4	25/4
26	26/4	26/4	26/4
27	27/4	27/4	27/4
28	28/4	28/4	28/4
29	29/4	29/4	29/4
30	30/4	30/4	30/4
31	31/4	31/4	31/4
32	32/4	32/4	32/4
33	33/4	33/4	33/4
34	34/4	34/4	34/4
35	35/4	35/4	35/4
36	36/4	36/4	36/4
37	37/4	37/4	37/4
38	38/4	38/4	38/4
39	39/4	39/4	39/4
40	40/4	40/4	40/4
41	41/4	41/4	41/4
42	42/4	42/4	42/4
43	43/4	43/4	43/4
44	44/4	44/4	44/4
45	45/4	45/4	45/4
46	46/4	46/4	46/4
47	47/4	47/4	47/4
48	48/4	48/4	48/4
49	49/4	49/4	49/4
50	50/4	50/4	50/4
51	51/4	51/4	51/4
52	52/4	52/4	52/4
53	53/4	53/4	53/4
54	54/4	54/4	54/4
55	55/4	55/4	55/4
56	56/4	56/4	56/4
57	57/4	57/4	57/4
58	58/4	58/4	58/4
59	59/4	59/4	59/4
60	60/4	60/4	60/4
61	61/4	61/4	61/4
62	62/4	62/4	62/4
63	63/4	63/4	63/4
64	64/4	64/4	64/4
65	65/4	65/4	65/4
66	66/4	66/4	66/4
67	67/4	67/4	67/4
68	68/4	68/4	68/4
69	69/4	69/4	69/4
70	70/4	70/4	70/4
71	71/4	71/4	71/4
72	72/4	72/4	72/4
73	73/4	73/4	73/4
74	74/4	74/4	74/4
75	75/4	75/4	75/4
76	76/4	76/4	76/4
77	77/4	77/4	77/4
78	78/4	78/4	78/4
79	79/4	79/4	79/4
80	80/4	80/4	80/4
81	81/4	81/4	81/4
82	82/4	82/4	82/4
83	83/4	83/4	83/4
84	84/4	84/4	84/4
85	85/4	85/4	85/4
86	86/4	86/4	86/4
87	87/4	87/4	87/4
88	88/4	88/4	88/4
89	89/4	89/4	89/4
90	90/4	90/4	90/4
91	91/4	91/4	91/4
92	92/4	92/4	92/4
93	93/4	93/4	93/4
94	94/4	94/4	94/4
95	95/4	95/4	95/4
96	96/4	96/4	96/4
97	97/4	97/4	97/4
98	98/4	98/4	98/4
99	99/4	99/4	99/4
100	100/4	100/4	100/4

**POWER ON/OFF**

- Press and hold the touch area for 5 seconds to power on the earbuds.
- Press and hold the touch area for 5 seconds to power off the earbuds.
- Press and hold the touch area for 5 seconds to power on the earbuds.
- Press and hold the touch area for 5 seconds to power off the earbuds.

**TROUBLE SHOOTING**

**Charging not working**  
Check the power source, including the charging cable, and ensure the charging case is fully charged.  
**Earbuds not connecting to Bluetooth**  
Ensure the earbuds are in pairing mode and the Bluetooth is turned on on the smartphone.  
**Earbuds not working properly**  
Check the earbuds for any physical damage and ensure they are properly inserted into the ear.

**RESTORE FACTORY SETTINGS IN SMART SCREEN**

- Tap the smart screen to wake it up.
- Tap the smart screen to wake it up.
- Tap the smart screen to wake it up.
- Tap the smart screen to wake it up.

**Smart Screen**

- Tap the smart screen to wake it up.
- Tap the smart screen to wake it up.
- Tap the smart screen to wake it up.
- Tap the smart screen to wake it up.

**Smart Screen**

- Tap the smart screen to wake it up.
- Tap the smart screen to wake it up.
- Tap the smart screen to wake it up.
- Tap the smart screen to wake it up.

**Smart Screen**

- Tap the smart screen to wake it up.
- Tap the smart screen to wake it up.
- Tap the smart screen to wake it up.
- Tap the smart screen to wake it up.

**SPECIFICATIONS**

Model	ES1
Color	Black
Bluetooth	Bluetooth 5.0
Bluetooth Version	Bluetooth 5.0
Bluetooth Frequency	2.4GHz
Bluetooth Range	10m

尺寸：90\*90mm  
材质：80g双铜纸+双面四色印刷

This device complies with part 15 of the FCC Rules. Operation is subject to the following two conditions: (1) this device may not cause harmful interference, and (2) this device must accept any interference received, including interference that may cause undesired operation.

Any changes or modifications not expressly approved by the party responsible for compliance could void the user's authority to operate the equipment.

NOTE: This equipment has been tested and found to comply with the limits for a Class B digital device, pursuant to Part 15 of the FCC Rules. These limits are designed to provide reasonable protection against harmful interference in a residential installation. This equipment generates, uses and can radiate radio frequency energy and, if not installed and used in accordance with the instructions, may cause harmful interference to radio communications.

However, there is no guarantee that interference will not occur in a particular installation.

If this equipment does cause harmful interference to radio or television reception, which can be determined by turning the equipment off and on, the user is encouraged to try to correct the interference by one or more of the following measures:

- Reorient or relocate the receiving antenna.
- Increase the separation between the equipment and receiver.
- Connect the equipment into an outlet on a circuit different from that to which the receiver is connected.
- Consult the dealer or an experienced radio/TV technician for help.

The device has been evaluated to meet general RF exposure requirement. The device can be used in portable exposure condition without restriction