

# Four channel monitoring system an instruction manual

## 一、monitor

### 1、Key function introduction



1: The screen opening key

2: Move the key up

3: Move down the key

4: Mode switching key / left shift key

5: The menu key / confirm key / return key

6: Channel switch key / right shift key

#### 1.1、The screen is on key

Function 1: Open / off screen function

Power on the screen, if you need to close the screen, press once to close the screen, press again to open the screen.

#### 1.2、Move the key up

Function 1: Move-up selection

In the menu for to select the previous item.

Function 2: Increase

Increase for the value in the date setting.

#### 1.3、Move down the key

Function 1: Move down selection

In the menu, it is necessary to select the next item.

Function 2: Reduce

Value reduction in the date setting.

## 1.4、Mode switch key / left shift key

Function 1: Switch between the split screen

In the standby mode, select the split mode. (Two split, three divided, four divided pictures)

Function 2: Move left

Move to the left option in the menu interface.

## 1.5、The menu key / confirm key / return key

Function 1: Menu

In standby state, short press the menu button to enter the menu.

Function 2: Confirm the function

Confirm on the selected items.

Function 3: Return function

Long press the menu button for about 3 seconds to return to the previous interface.

## 1.6、Channel switch keys / right-shift keys

Function 1: Switch between the single screen

In standby state, switch to display a single large screen.

Function 2: Move right

Right right option in the menu interface.

# 2、Menu feature introduction:

## 2.1、Video setting:

1)、automatic

Open the ACC, the DVR display will automatically start (about 15 seconds) and turn on the video function (a red dot in the lower left corner indicates the video is turned on); close the ACC, the DVR display will automatically save the video content on the SD card, which will automatically overwrite the video files when the SD card is full.

2)、Manual

Enter the menu with the menu (Figure 1.1), move right and select "Video Settings", and the menu will confirm the entry (Figure 1.2). The Channel

Selection can be selected between CH 1-CH4, and the user can set up other functions under this channel according to their own needs. If video is not required, set Video Mode to Off; set image mirror to Level; the video delay time is optional 5S / 10S to ensure that the video is not missing.



Figure 1.1



Figure 1.2

## 2.2、Video playback

Users can set the playback channel video, date and time period according to their own needs. When the setting is completed, click "Query" to confirm the playback video file.



Figure2.1

Click up / down to select the video to be played back (Figure 2.2) and click OK to select the video to be played. Click on the "play" below again to view the playback image (Figure 2.3).

◀▶ / ▶▶ The video can be played at multiple speed, ▼ The progress bar can be hidden.

Note: The video recording stops automatically during the operation, and the end operation video recording starts automatically.



Figure 2.2

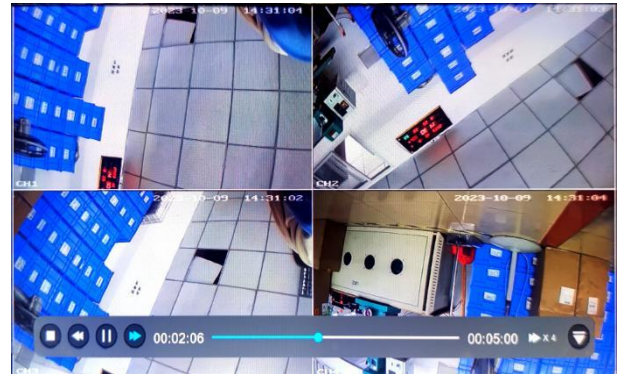

Figure 2.3

## 2.3、Display settings

1. Display adjustment: the display can be set for individual channels; (Figure 3.1)
2. Channel name: the name of each channel can be modified; (Figure 3.2)
3. Installation method: The reversing scale and reversing priority can be set for the reversing monitoring screen, and the turn signal mode can be set according to the demand; (Figure 3.3)
4. Picture Settings: the background color, border color and frame color can be set for the display mode. (Figure 3.4)



Figure3.1



Figure3.2

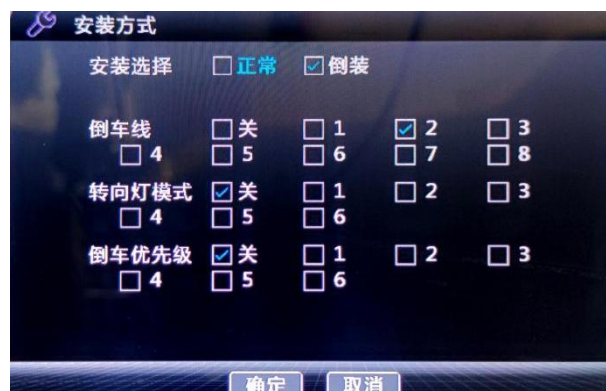

Figure 3.3



Figure 3.4



## 2.4、System Settings

1. Power saving mode: the screen rest screen time can be set according to its own needs; (the video recording has not stopped during the rest screen period) (Figure 4.1)
2. System time: In order to effectively video record the date and time of the evidence collection of driving safety accidents, please set the correct time immediately before using the local machine;
3. Storage management: you can view the current remaining space. In order to effectively video the evidence collection date and time of traffic safety accidents, do not easily formatting.



Figure 4.1

## Product technical parameters:

supply voltage	DC 9~36V
Use the temperature range	-20℃~+70℃
window	7"
Video input resolution	1920*1080 (max)
Video input format	AHD/CVBS (self-adaption)
display resolution	1024*600
Video resolution	1280*720*4/960*1080*4 (Independent video recording of each channel)
compressed format	H.264
file format	TS(The power-off video does not miss

	seconds), MP4	
joggle	Number of channels	4 channels (displayed simultaneously)
	Video source input	1.0Vp-p
	SD block	The maximum capacity supports 256G capacity
working current	24V:450mA (loaded to capacity)	
working temperature	-20°C~+70°C	
storage temperature	-40°C~+90°C	
relative humidity	<90%	
Picture segmentation	Single picture, double picture, three pictures, four pictures Single picture, double picture, three pictures, four pictures	
Each channel can be regulated independently	Mirror image, horizontal, vertical, horizontal and vertical simultaneously, original image, brightness, saturation, contrast	

## 二、Wireless module

Launch module (CQ-MK8208A-TX-3DB)

Receive the module (CQ-MK8208B-RX-3DB)

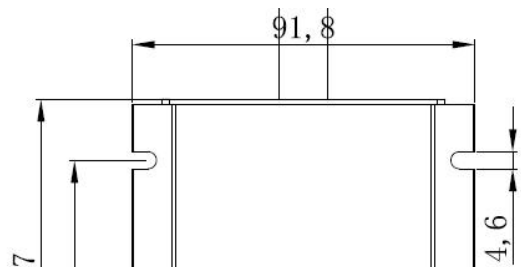

interface specification :

Launch module (CQ-MK8208A-TX-3DB)	
①: power input	12-32V power input
②: Video input port	Connect the camera
③: The code switch	When the emission does not match with the reception, it can be matched by matching the code
Receive the module (CQ-MK8208B-RX-3DB)	
①: power input	12-32V power input
②: Video output port	Connect the display
③: The code switch	When the emission does not match with the reception, it can be matched by matching the code

technical parameters :

working voltage	DC 12-32V	available machine time	<2S
delay time	150ms	resolution	AHD 720P, AHD 1080P
Output video system	PAL/NTSC	Operating frequency range	2400 ~ 2483MHz
working current	TX: 260mA RX: 130mA	Antenna input / output impedance	50 $\Omega$ , Typ.
receiving sensitivity	-83dBm	transmission distance	500 meters
working temperature	-30°C~70°C	levels of protection	IP67



Video input	720P/1080P All support	Video output	1080P
-------------	------------------------	--------------	-------

### 三、Distance measurement module

Trigger the reverse signal, forcibly switch to the rear view reversing monitoring screen, display characters at the top of the screen (the reversing scale is turned off by default, and can be turned on), and the reversing radar starts to range, and the ranging range is 0.4m-2m. When the distance is less than 0.4m, "STOP" voice prompt is displayed to stop, real-time broadcast between 0.4-1.6m and the data is displayed between 1.6m and 2m.

### 四、Disclaimer

The information provided in the manual of vehicle DVR display is for reference only. Users refer take the physical object during use. We are not liable for any fine or traffic accident caused by the use of this product.

Car DVR display video is recorded in a loop, please keep important information in time. This product does not exclude the possibility of unexpected situations in the process of use, if there is no video video or image data, our company will not assume any responsibility. At the same time, our company also advocates civilized driving, obey the traffic rules.

Purchase of this product, it shall be deemed to have complied with this statement!

## FCC Statement

This equipment has been tested and found to comply with the limits for a Class B digital device, pursuant to part 15 of the FCC Rules. These limits are designed to provide reasonable protection against harmful interference in a residential installation. This equipment generates, uses and can radiate radio frequency energy and, if not installed and used in accordance with the instructions, may cause harmful interference to radio communications. However, there is no guarantee that interference will not occur in a particular installation. If this equipment does cause harmful interference to radio or television reception, which can be determined by turning the equipment off and on, the user is encouraged to try to correct the interference by one or more of the following measures:

- Reorient or relocate the receiving antenna.
- Increase the separation between the equipment and receiver.
- Connect the equipment into an outlet on a circuit different from that to which the receiver is connected.
- Consult the dealer or an experienced radio/TV technician for help.

Caution: Any changes or modifications

to this device not explicitly approved by manufacturer could void your authority to operate this equipment. This device complies with part 15 of the FCC Rules. Operation is subject to the following two conditions: (1) This device may not cause harmful interference, and (2) this device must accept any interference received, including interference that may cause undesired operation.

### RF Exposure Information

This equipment complies with FCC radiation exposure limits set forth for an uncontrolled environment. This equipment should be installed and operated with minimum distance 20cm between the radiator and your body.

Telephone: 023-68623207

Fax: 023-68517734

website: <http://www.cheqidz.cn/>

Address: Standard Building J, No.70, Keyuan 4th Street,  
Jiulongpo District, Chongqing