

尺寸: A5

材质: 105g铜版纸彩印+正反面1C+骑马钉

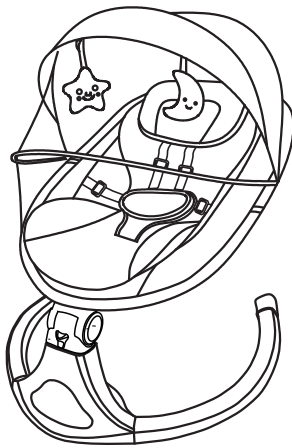

Best Care for Ever !



User Manual

Electric Baby Swing

Model: CR018B

For tutorial videos, customer service, extended 12-month warranty, and more information, please visit:

<https://www.larexcare.com>

Or scan the QR code below:



Please scan the QR code beside:



Manufacturer: Zhongshan City Cironbaby Co.,Ltd.

Address: No.6,Yongxing North Road,Yongxing Industrial Zone, Henglan Town,
Zhongshan City,Guangdong,China



larexbabycare



Larex Baby Care



Larex Baby Care



support@larexcare.com

WARNING	01
FCC WARNING	02
Parts Instruction	03
Assembly Steps	04-05
Disassembly Steps	06
Using Methods	07-08
Function Introduction	09-11
Product Contents	11
Clean, Maintenance & Troubleshooting	12-13

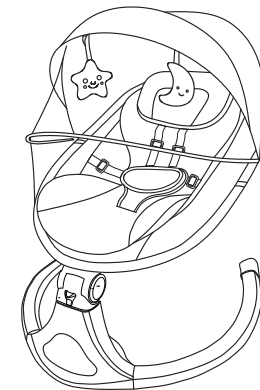

WARNING

IMPORTANT SAFETY GUARDS

SAFETY PRECAUTION: FAILURE TO FOLLOW THESE WARNINGS AND ASSEMBLY INSTRUCTIONS COULD RESULT IN SERIOUS INJURY OR DEATH.

In the event of damage or problems, discontinue use and contact LAREX

customer service: support@larexcare.com

To prevent serious injury or death from infants falling or being strangled in straps:

- Do NOT use this device if it is damaged or broken. Keep small parts away from children.
- This product is not intended for prolonged periods of sleeping.
- Do not use the LAREX swing once your children can sit up unaided or attempt to climb out, regardless of age or weight (better use within 6 months).
- Never leave the infant unattended.
- Never use on soft surfaces (bed, sofa, cushion), as the seat may tip over and cause suffocation.
- Use only on a floor. Never use on any elevated surface.
- Maximum weight 20 lbs (9 kg).
- Be sure to use a seat belt that is tightly attached to your baby to protect their safety and prevent them from falling off.
- Do not use accessories or replacement parts other than those approved by LAREX
- Do not use the product if any components are broken or missing.
- Do not place the product in any location where there are cords, such as window blind cords, drapes, phone cords, etc.
- Power adapter cable can cause strangulation hazard! Keep cable out of reach of children.
- Do not move or lift this product with the baby inside it.
- Only use the power cord provided

SUFFOCATION HAZARDS: Young infants have limited head and neck control. If the seat is too upright, infant's head can drop forward and compress the airway.

ALWAYS keep swing seat fully reclined until infant is at least 4 months old **AND** can hold up head without help.

FCC WARNING

The device complies with part 15 of the FCC Rules. Operation is subject to the following two conditions: (1) This device may not cause harmful interference, and (2) This device must accept any interference received, including interference that may cause undesired operation.

Caution: Changes or modifications not expressly approved by the party responsible for compliance could void the user's authority to operate the equipment. This equipment complies with FCC radiation exposure limits set forth for an uncontrolled environment. This transmitter must not be co-located or operating in conjunction with any other antenna or transmitter. The base bracket should be installed and operated with minimum distance 10cm between the radiator and your body.

WARNING:

Changes or modifications to this unit not expressly approved by the party responsible for compliance could void the user's authority to operate the equipment.

NOTE: This equipment has been tested and found to comply with the limits for a Class B digital device, pursuant to part 15 of the FCC Rules. These limits are designed to provide reasonable protection against harmful interference in a residential installation. This equipment generates, uses, and can radiate radio frequency energy and if not installed and used in accordance with the instructions, may cause harmful interference to radio communications. However, there is no guarantee that interference will not occur in a particular installation. If this equipment does cause harmful interference to radio or television reception, which can be determined by turning the equipment off and on, the user is encouraged to try to connect the interference by one or more of the following measures:

- Reorient or relocate the receiving antenna.
- Increase the separation between the equipment and receiver.
- Connect the equipment to an outlet on a circuit different from that to which the receiver is connected.
- Consult the dealer or an experienced radio/TV technician for help.

CAN ICES-3(B)/NMB-3(B)

CAUTION

To prevent battery leaks, which can burn skin and eyes:

- Always replace the entire set of batteries at one time.
- Never mix old and new batteries, or batteries of different brands or types.
- Remove batteries when storing product for a long time.
- Dispose of used batteries immediately.

Parts Instruction

Make sure that all of the following parts listed are included in the box. If any part is missing, please contact us before operating.



Plush toy*2



Reversible headrest

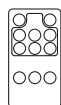

Remote controller



Adaptor*1
USB cable*1

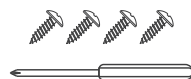

Screws*4
Screwdrivers*1

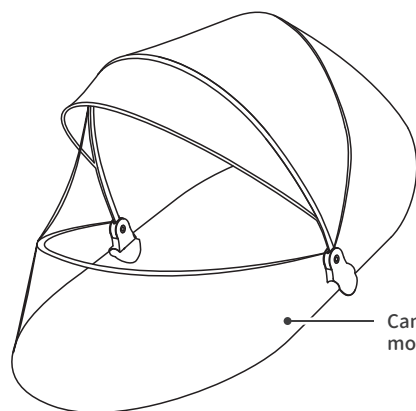

Canopy with mosquito net

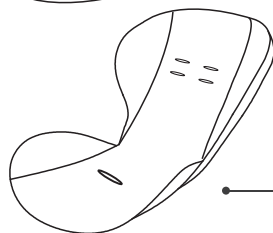

Reversible body pad

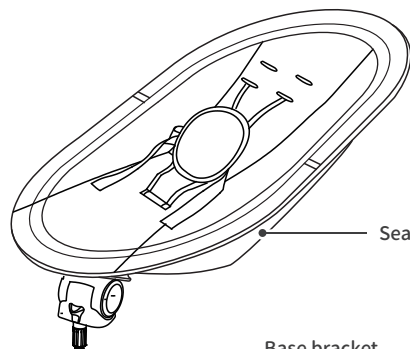

Seat cover seat frame

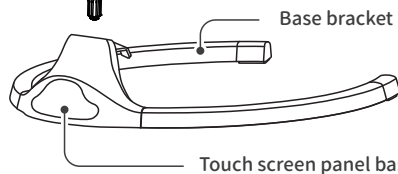

Base bracket

Touch screen panel base

Assembly Steps

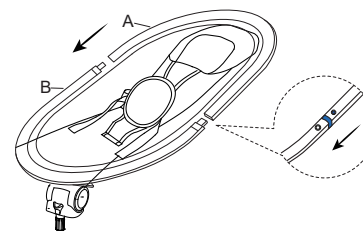

1. Unfold the backrest to the same level. Connecting A with B together and installing securely.

Note: Connect one side first, then the other side. Please ensure the buttons on the back of the frame are fully closed after connecting.

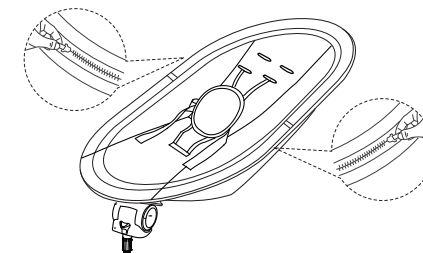

2. Put the seat cover on the seat frame and zip up the top and bottom sections to secure it.

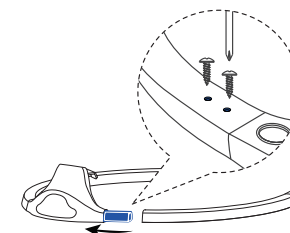

3. Assemble the base bracket to the touch panel base. Tighten with screws to secure.

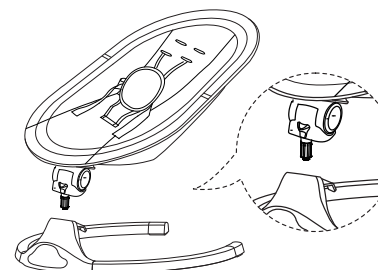

Seat D hole and mainframe base D iron shaft keep the same direction

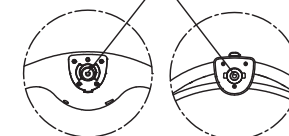

4. Insert the seat's frame into the base support post.

Seat installation details: Keep the same direction of seat D hole and mainframe base D iron shaft, then insert the seat into the mainframe base, then rotate the seat left and right slightly, then press down the seat after alignment, then finish the seat installation.

WARNING: After completing the installation of the seat, please check the seat to ensure that it is well locked before using it.

Disassembly Steps

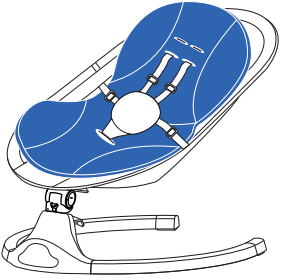

5. Place the reversible body pad onto the seat, then thread the harness strap through the top and bottom slot of the body pad. (The top slot has two options, you can choose one of the two.)

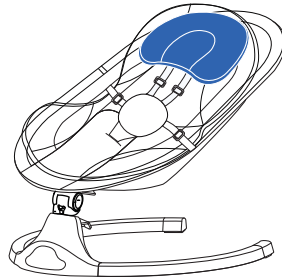

6. Place the headrest onto the seat, then pull the hook-and-loop strap through the ring. Fold to secure.

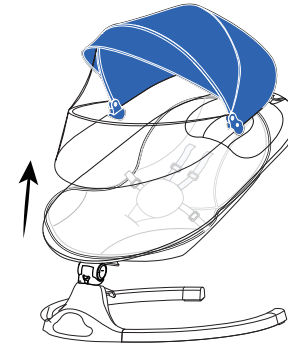

1. Pull out the clasp to remove the canopy.

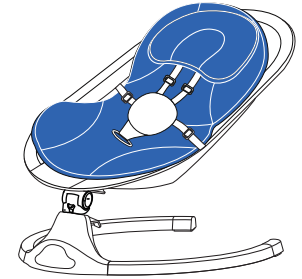

2. Pull the velcro to separate the headrest and thread the harness strap through the slot of the body pad to remove the body pad.

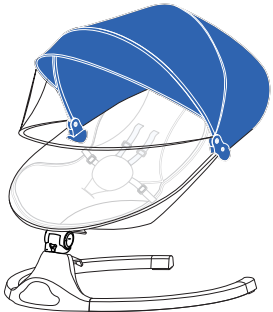

7. Attach the canopy to the seat frame. Snap the two canopy brackets onto either side of the seat frame to secure.

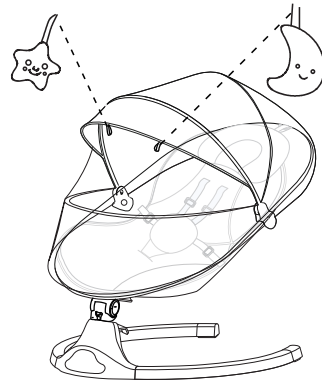

8. Hang the two plush toys to the canopy by wrapping the straps through loops on the canopy. Attach the mosquito net to the seat frame.

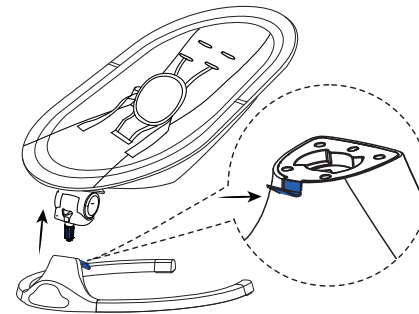

3. Push the iron sheet in and then lift the seat from the support post.

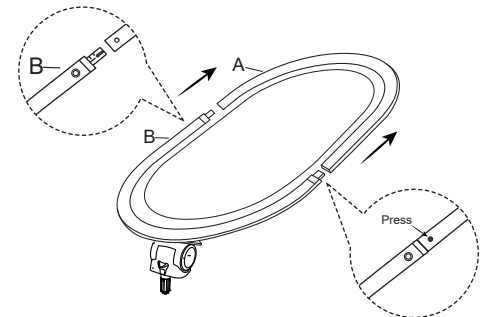

4. Find the left and right side buttons on the back of the seat frame, press down firmly on one of the buttons and pull firmly away, then press the button on the other side and pull firmly away. Fold the seat frame.

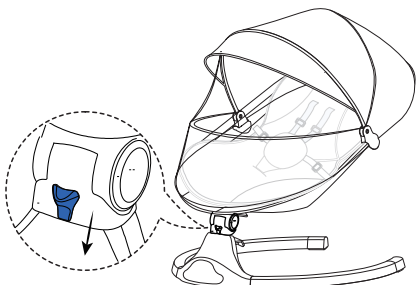

1. Push the motion down to lock the seat frame to prevent the seat from moving.

IMPORTANT: Always set the swing on a flat, stable surface. Never use the seat without safely buckling your child into the harness.

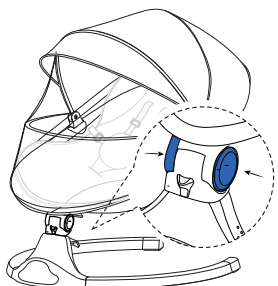

2. Adjust seat angle.

1) To adjust the seat angle downwards, press the adjustment buttons on both sides of the joint at the same time, adjust the seat downward to the desired angle, then lift the seat slightly and the buttons will spring back automatically to complete the adjustment.

2) To adjust the seat angle upwards, simply lift the rear end of the seat to adjust it automatically.

Note: The seat angle is adjustable in three positions.

3. Put the baby in the seat and then fasten the seat belt. Adjust the strap length if necessary. Cover the buckle bag well.

Shoulder belt install details:

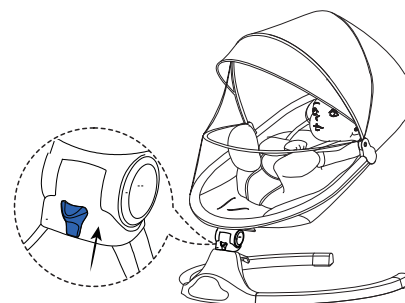
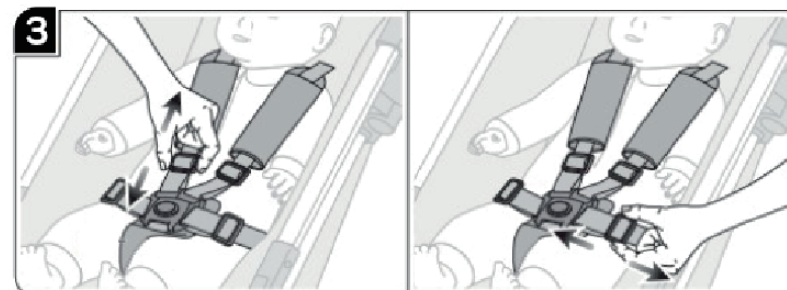
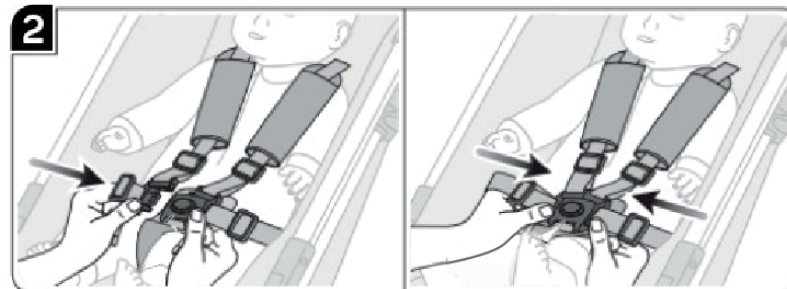
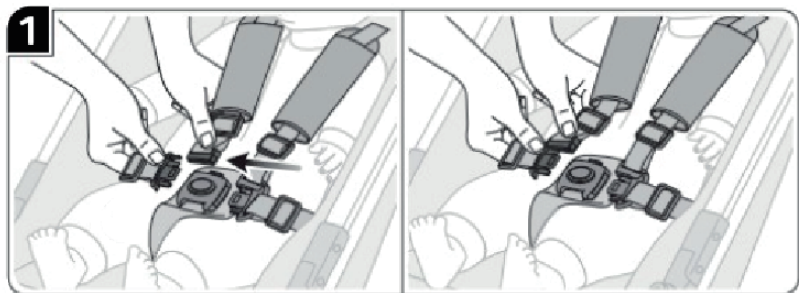

4. After the baby is secure, pull the motion lock up to unlock the seat frame.

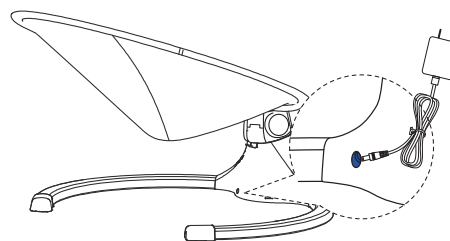

5. Connect the power cord to the port on the back of the display panel. Then plug the cord into an electrical outlet.

NOTE: The swing does not operate off of batteries. The power cord is the only source of power. Only use the original adapter. If the adapter is missing please email us at support@larexcare.com

Function Introduction

Panel Function

Control the unit's functions with the buttons indicated below:

Caution: To ensure the safety of the baby, the swing amplitude and speed will slowly increase when setting the initial gear.

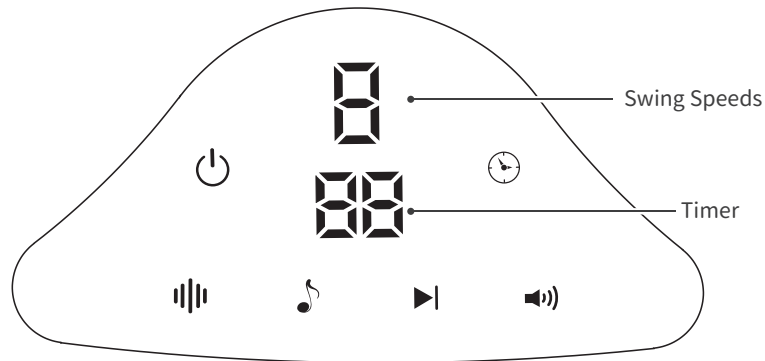

Power Switch: Plug in and the indicator light is on. Press the button to turn the swing on/off.



Timing button: Touch the button to set time to 8mins, 15mins, 30mins, or cancel. The unit will turn off automatically when the timer finishes.



Swing Speeds Setting: Touch the button to make swing settings. There are five swing gears available. After 5 gears, the speed resets to zero.



Music Play/Pause: Touch the button to play the built-in music. Touch it again to turn the music off.



Next Tune: Touch the button to play the next song.



Volume Adjustment: Touch the button to adjust the volume.

*There are 4 levels of volume available, long touch the button for 2 seconds to select one, cycling through them in sequence.

Remote Function

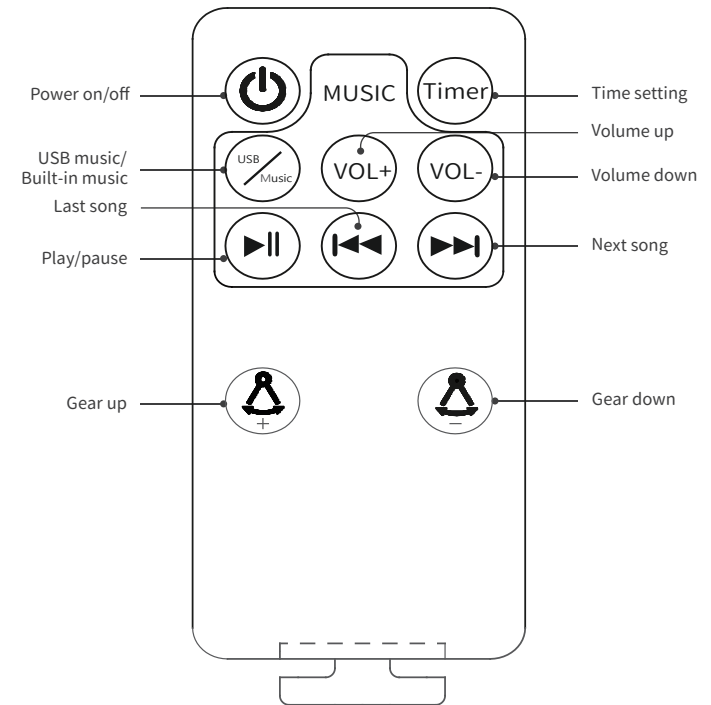

MP3 Function

- 1) Plug the USB device into the USB interface port to play the music inside the USB device.
- 2) Unplug the USB device and turn on the music button to play the music built into the product.

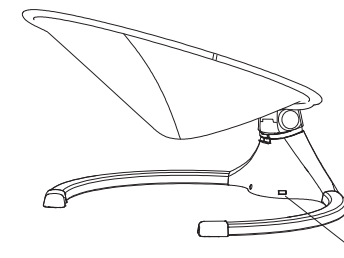

Bluetooth Function

Turn on the Bluetooth function in your phone to search the name of "swing chair", the product could play the music inside your phone after successful Bluetooth connection.

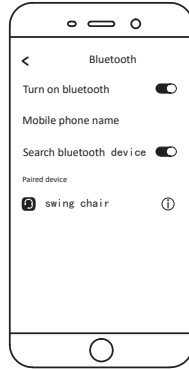

Product Contents

Product Name	Electric Baby Swing
Model No.	CR018B
Input Voltage	100-240V~50/60Hz 0.3A
Output Voltage	DC5.8V/1A
Applicable Age	0-6 MONTH
Application	Children up to a weight of 9 kg and unable to sit up unaided
Main Material	100% polyester fiber, Aviation aluminum base bracket
Standard	ASTM F2088-22, ASTM F963-17

Clean

1. Clean the base bracket and seat frame with a wet cloth and a mild detergent. Dry thoroughly then. Please do not use corrosive cleaner.
2. Removable and washable fabric
 - Seat fabric: Clean it with a wet cloth and a mild detergent. Do not bleach, air dry.
 - Canopy. Take it off and put a little cleaner, wash it gently by hands. Rinse it with clean water, and then hang it to dry, avoiding exposure to the sun.

Maintenance

1. Please check this baby swing regularly. Make sure each part is well-connected and well-installed. Stop using it for poor connection and connect/install it again if necessary.
2. This product contains electronic components, which shall not be used in water or a humid environment. Please ensure the product is dry, and store it in a cool and dry place, avoiding direct sunshine for a long time.

Troubleshooting

Fast self-inspection solution below.

No.	Trouble	Solution
1	Not energized	1. Check whether the adapter and DC cable are firmly connected. If loose, connect them firmly. 2. The DC cable may be damaged, Please contact customer service to replace the DC cable.
2	The power lamp keeps flashing	Use a matchable adapter with an output voltage of 5V and 1A.
3	Motion lock stuck	Check the motion lock. Put it up to unlock the seat frame.
4	Overstring/Strike	Power off and restart it again

Note: For other issues, please contact our customer service for help. Never disassemble and repair the swing by yourself.

Customer Service

ONE-YEAR LIMITED WARRANTY

LAREX's Swing includes a 1-year limited warranty against defects from the date of purchase. In the event of a malfunction or defect during the in-warranty period, we will replace the product under warranty. Upon receipt of the product and proof of purchase with a valid date of purchase, we will send you a new one freely. Please send the defective unit, proof of purchase and a description of the problem you have encountered to our customer service email: support@larexcare.com

Note: This warranty does not cover claims resulting from misuse, abuse, alteration, inflicted damage, accidental damage, normal wear and tear, involvement in an accident, and/or failure to comply with the instructions on assembly, maintenance and use.

Contact US

Thank you for purchasing our products. If you have any questions or suggestions about this product, feel free to contact our customer service at support@larexcare.com