



# HEATED SOCKS

## INSTRUCTION MANUAL

Thank you for purchasing

Customer Support  
[service@saviorheat.com](mailto:service@saviorheat.com)



NOTE: Please read the instructions carefully before the first use.

## HOW TO CHARGE BATTERIES

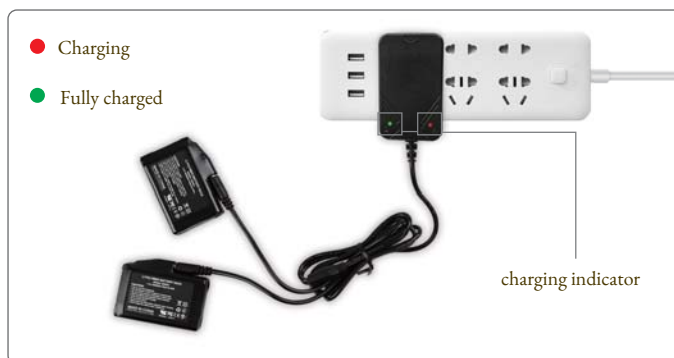

Please fully charge the batteries before first use (about 4-5hours)

## HOW TO INSTALL BATTERIES



Step 1: Find out the electric wire from the battery pocket.



Step 2: Insert the battery

Note:

1. To activate, press and hold the power button for 3 seconds.
2. Starts in the high mode by default; jump to medium after 5 minutes if not adjusted.
3. Data is related to the external ambient temperature, the lower the temperature, the faster the power consumption.

## HEATING TIME AND TEMPERATURE



## BATTERY POWER

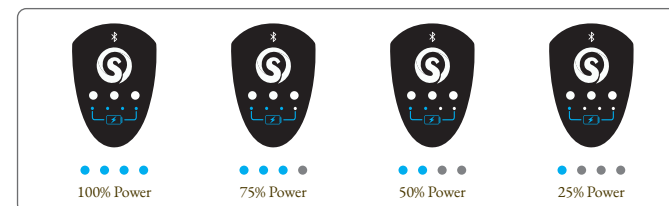

SAVIOR HEAT Heated socks can be controlled in 2 ways:

### 1. Manually

- Step 1: Press and hold the button on the socks for 3 seconds to activate the socks.
- Step 2: Press the button for 1s to adjust the heat settings.
- Step 3: Press and hold the button on the socks for 3 seconds to turn off the socks.

### 2. Mobile app

This product is compatible with the "Savior Heat" app. Use the "Savior Heat" app to control YOUR SOCKS.

- Step 1: Scan the QR code to get the app installation link or search for "Savior Heat" on Google Play or Apple Store to download and install.



iOS



Android

- Step 2: Click to download and install the app.



ENGLISH

- Step 3: Language Settings:  
Open the app and select your preferred language. Please allow the app to use Bluetooth to connect to devices.



- Step 4:  
Bluetooth Pairing:  
Enable the Bluetooth function on your phone first, then hold down the socks' on/off button for 3s to activate the sock, the Bluetooth light will flash in red, indicating in pairing mode. Search for nearby socks on your phone, and the Bluetooth address will appear on the pairing page. Tap on it.



Bluetooth Address



ENGLISH

Step 5: Enter the product type interface and select the product you paired with. For example, choose "Socks".

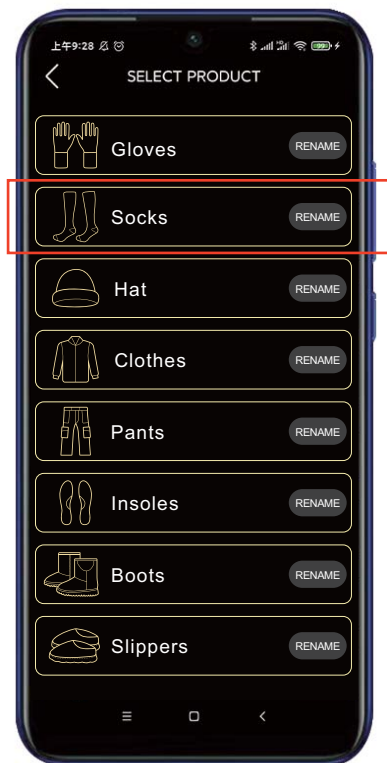

Step 6: Select the LEFT/RIGHT Sock according.

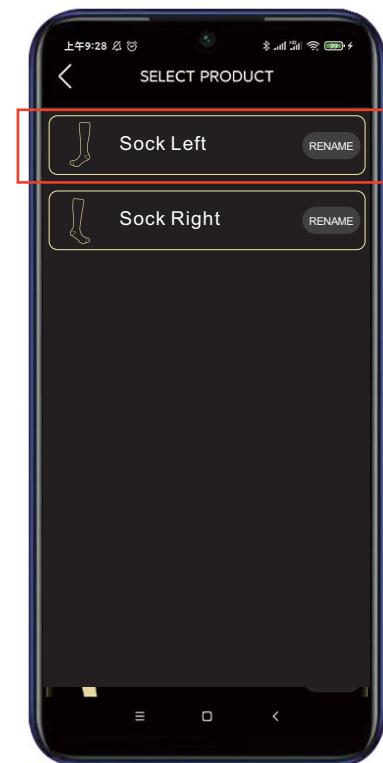

Step 7: Tap the "+" icon at the top left to repeat Steps 4-6 to add the other Sock.

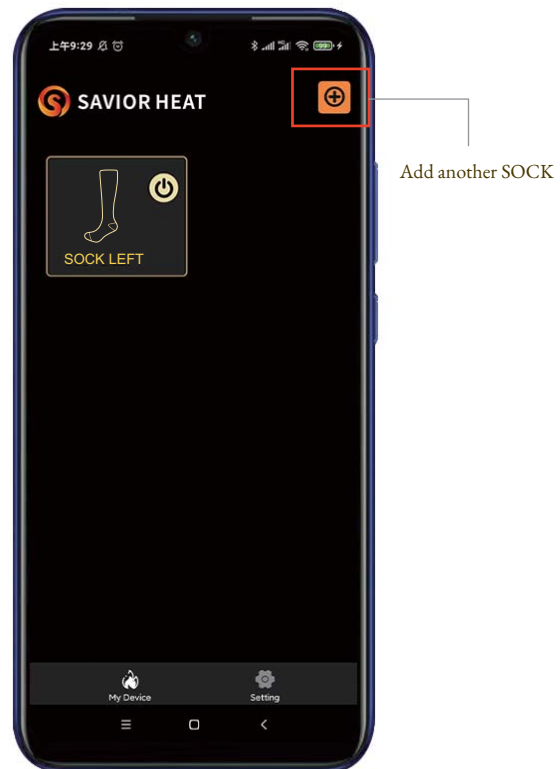

Step 8: Complete pairing for a pair of Socks.

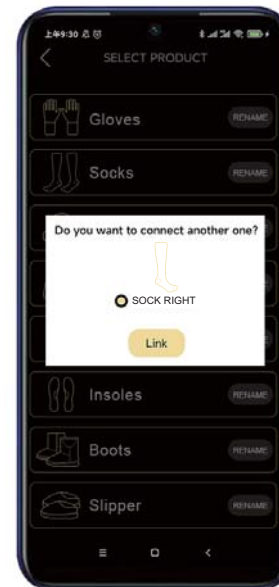

Step 9: Tap the Sock icon to enter the operation interface.

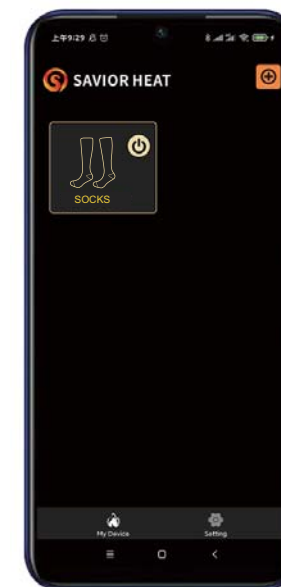

Step 10: Enter the sock control page where you can check battery levels, control the on/off switch, adjust heating temperatures, and set a timer to turn off the socks.



## How to split or merge groups? How to control one sock or both simultaneously?

After the initial pairing of "LEFT SOCK" and "RIGHT SOCK," the system defaults to combined control.

To switch from combined to single control. Select "UNGROUP" from the settings menu in the top right corner of the screen.

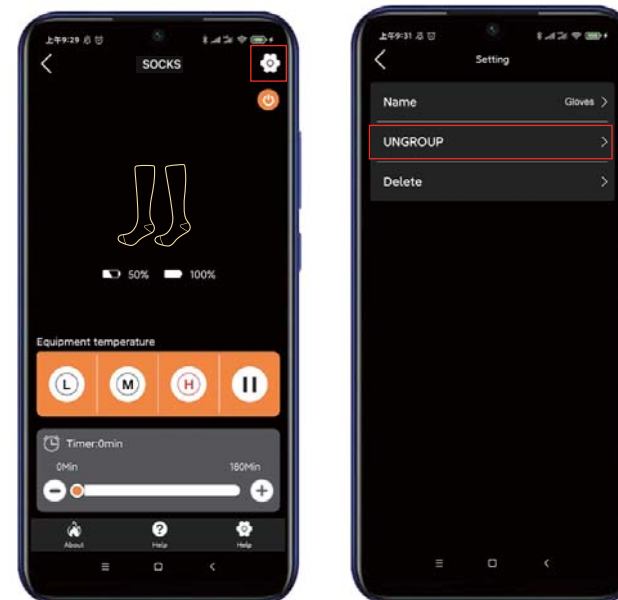

After splitting the pair, you can control each glove independently.

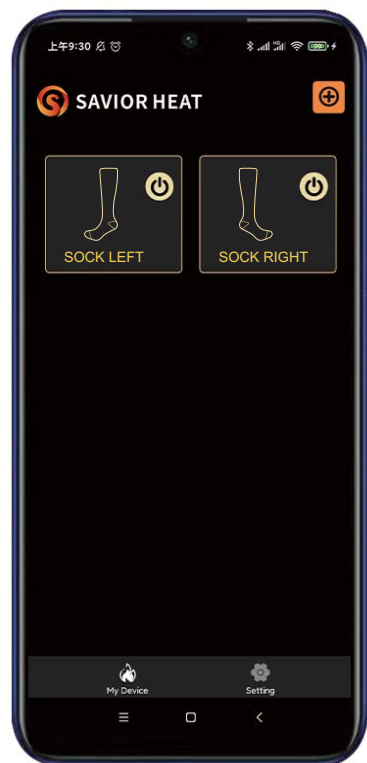

To switch back from single to combined control, tap "LEFT SOCK" or "RIGHT SOCK" on the main screen to access the operation interface. Then, select "Delete" from the settings menu in the top right corner of the screen. Repeat steps 7-9 to re-add the deleted side.

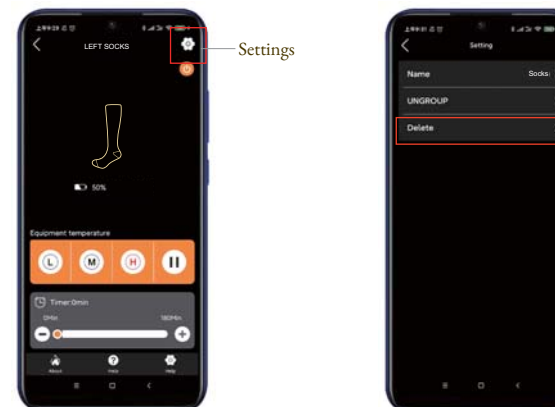

**Troubleshooting:** If the blue battery indicator flashes and the heating socks fail to turn on after being switched off using the Bluetooth app, it indicates that the switch is in protection mode. Disconnect and reconnect the battery to restore normal function.



If the indicator light flashes and the device won't turn on, unplug and reconnect the battery.

## PACKAGE CONTENTS

- ▶ 1\* Pair Heated Socks
- ▶ 1\* Pair Battery Pack (2200mah)
- ▶ 1\* Charger
- ▶ 1\* User Manual
- ▶ 1\* Gift Box

## WASHING INSTRUCTIONS

- ▶ Remove the battery from the pocket, and zip up before washing the socks.
- ▶ Use mild detergent to clean the spots and line dry only.
- ▶ Hand wash only.
- ▶ Do not machine dry or use bleach.

## HOW TO CHARGE

- ▶ Remove batteries from socks before charging.
- ▶ Before first use, please fully charge the battery, about 4-5 hours.
- ▶ Red light illuminates while charging.
- ▶ Green light illuminates when charging is completed.
- ▶ Please charge and discharge the batteries at least once every 3 months to keep them usable (If products are not in use).

## ATTENTION

- ▶ Always remove the batteries from your gloves before charging.
- ▶ For safety, do not drop, short circuit, or operate under high temperature conditions.
- ▶ Please do NOT disassemble, knock, squeeze the battery or throw it into the fire. If the device or the battery swells or becomes malformed, please stop using it immediately.

## WARNING

- ▶ Please make sure to charge the battery correctly, improper use may cause fire in severe cases!
- ▶ Charge the battery with the original charger only.
- ▶ Forbidden to use in high temperature environment. Forbidden to use the battery after soaking in water.
- ▶ When the battery is fully charged and turns on the green light, please remove the battery in time, and do not charge it when unattended.
- ▶ The elderly, children and people with limited mobility should not use it alone.
- ▶ Do not use the products during sleeping.
- ▶ If one place is very hot during use, there may be a short circuit of the heating wire. Please stop using it immediately.
- ▶ Do not use this product if your feet or hands have bacterial infections and other diseases.

## BATTERY USAGE PRECAUTIONS

- ▶ Please use the original charger and battery.
- ▶ Please do not leave the battery on flammable items for a long time, such as beds, sofas, blankets, etc. Please stay away from flammable and explosive materials when charging.
- ▶ When the battery pack is not in use, please keep it away from other metal objects, such as paper clips, coins, keys, nails, screws or other small metal objects that can be connected to terminals. Shorting the battery terminals together may cause burns or a fire.
- ▶ In the case of abuse, liquid may be sprayed from the battery. Please avoid contact. In case of accidental contact, please flush with water. If liquid contacts eyes, please seek medical attention immediately. Liquid ejected from the battery may cause irritation or burns.



Scan for an Extended Warranty



ENGLISH



ENGLISH



## FCC Warning

This device complies with part 15 of the FCC Rules. Operation is subject to the following two conditions:

(1) This device may not cause harmful interference, and (2) this device must accept any interference received, including interference that may cause undesired operation.

Any Changes or modifications not expressly approved by the party responsible for compliance could void the user's authority to operate the equipment.

**Note:** This equipment has been tested and found to comply with the limits for a Class B digital device, pursuant to part 15 of the FCC Rules. These limits are designed to provide reasonable protection against harmful interference in a residential installation. This equipment generates uses and can radiate radio frequency energy and, if not installed and used in accordance with the instructions, may cause harmful interference to radio communications. However, there is no guarantee that interference will not occur in a particular installation. If this equipment does cause harmful interference to radio or television reception, which can be determined by turning the equipment off and on, the user is encouraged to try to correct the interference by one or more of the following measures:

- Reorient or relocate the receiving antenna.
- Increase the separation between the equipment and receiver.
- Connect the equipment into an outlet on a circuit different from that to which the receiver is connected.
- Consult the dealer or an experienced radio/TV technician for help.

\* RF warning for Portable device:

The device has been evaluated to meet general RF exposure requirement. The device can be used in portable exposure condition without restriction.