

WeHere®

Smart Lock



I FCC WARNING

This device complies with part 15 of the FCC Rules. Operation is subject to the following two conditions: (1) this device may not cause harmful interference, and (2) this device must accept any interference received, including interference that may cause undesired operation. Any changes or modifications not expressly approved by the party responsible for compliance

could void the user's authority to operate the equipment.

NOTE: This equipment has been tested and found to comply with the limits for a Class B digital device, pursuant to Part 15 of the FCC Rules. These limits are designed to provide reasonable protection against harmful interference in a residential installation. This equipment generates, uses and can radiate radio frequency energy and, if not installed and used in accordance with the instructions, may cause harmful interference to radio communications. However, there is no guarantee that interference will not occur in a particular installation. If this equipment does cause harmful interference to radio or television reception, which can be determined by turning the equipment off and on, the user is encouraged to try to

correct the interference by one or more of the following measures:

- Reorient or relocate the receiving antenna.
- Increase the separation between the equipment and receiver.
- Connect the equipment into an outlet on a circuit different from that to which the receiver is connected.
- Consult the dealer or an experienced radio/TV technician for help.

To maintain compliance with FCC's RF Exposure guidelines, This equipment should be installed and operated with minimum distance between 20cm the radiator your body: Use only the supplied antenna

I CONTENTS



1-2

B100 Smart lock



3-3

APP Download



4-4

APP Register



5-13

APP Use Tutorial



14-19

Product Description



20-21

Customer Q&A

B100 Smart lock

B100 Smart lock exterior



How to install battery



How to install lock

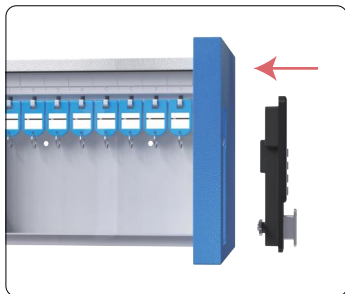

1.B100 is installed externally on the product



2. Install screws from the inside

B100 smart lock parameters

Unlock method	Bluetooth/dynamic password/period password/static password
Material	Zinc Alloy
Size	145*63*26mm
Weight	0.4kg
Battery	2*AA (alkaline battery ,not including)
Battery Life	1 year

APP Download

APP Download

1.Scan the QR code below,or visit the website to download the APP and register for an account.

2.Or you can also search “Wehere” in Google play or App store to download the app and register an account .



<https://wehereapp.we-here.com/en/app.html>

Roles in the system

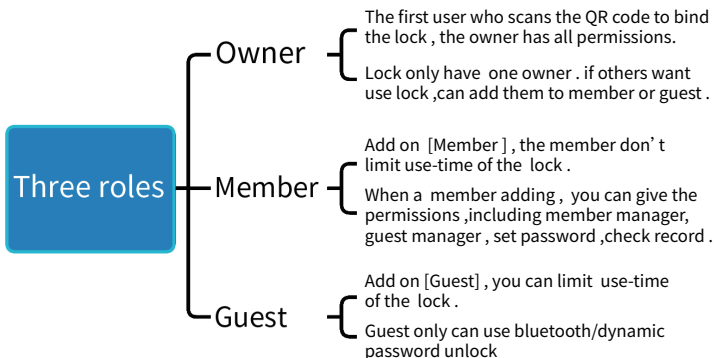

APP Register

■ Three registration methods

1. Phone registration (need enter sms code)
2. Email registration (need enter Email verification code)
3. User defined account registration

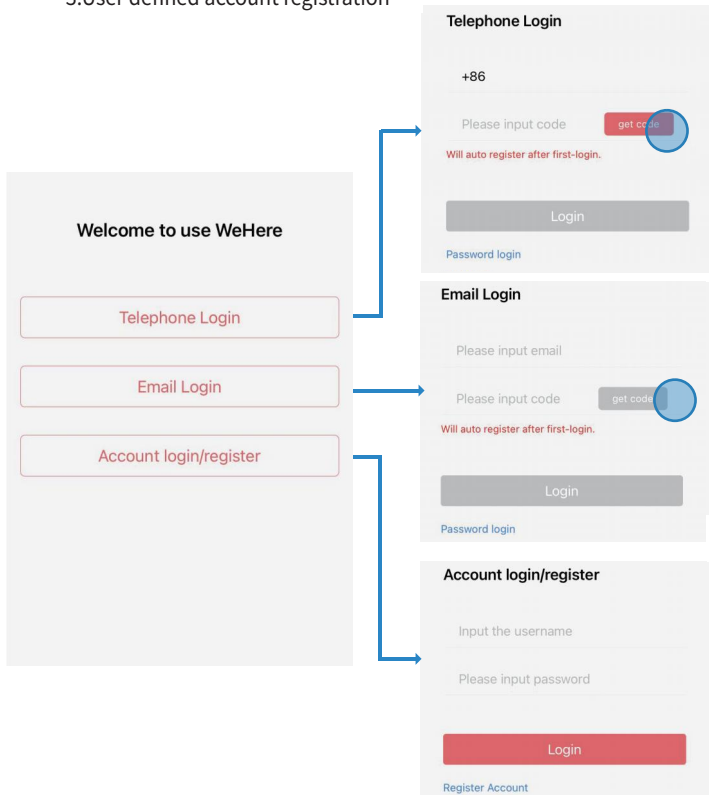

APP Use Tutorial

How to add the lock to wehere app

You can scan the qr code of lock to bind the lock.
the person who first bind lock is the lock owner ,have all permissions.

(Note: the owner can manager member/ guest , set password ,hand over the lock)

(The owner/member who have the permission can add[Member] or [Guest])

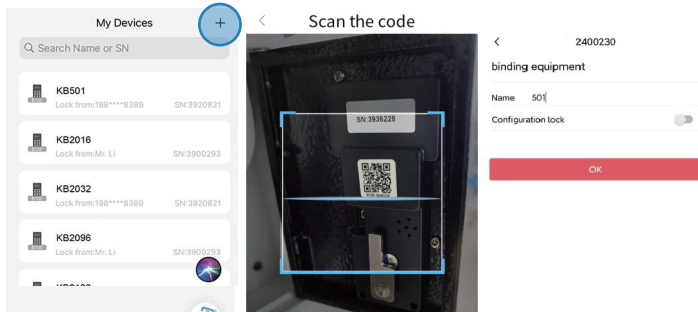

How to share access rights to others

The owner /member who have the permission can add[Member] or [Guest]

(Note :when add a member , can give the permissions ,including member manager, guest manager , set password ,check record .)

Open [Member] and click on the “+” to add member .

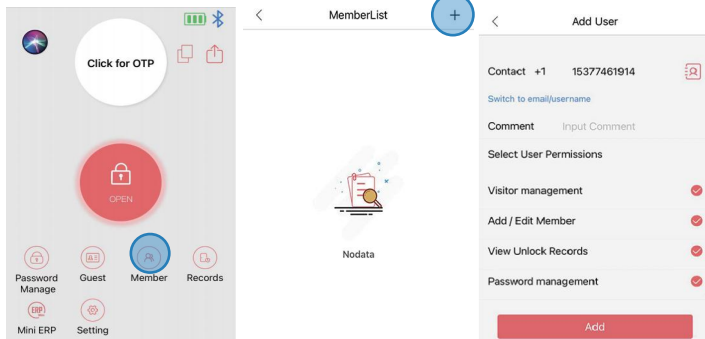

After the members added , they can login the account and see the lock on the [My Devices] page. if don't see, pull down to refresh.

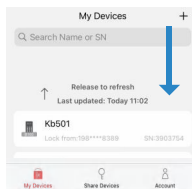
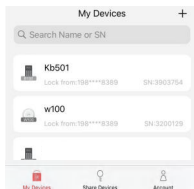

Open [Guest] and click on the “+” to add Guest.

(When adding guest, you can also set the access time. You don't need to delete the guest , the lock can not open when time expired when time expired)

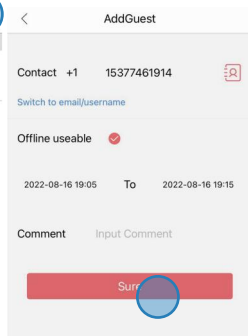
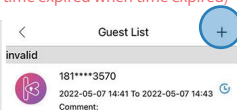
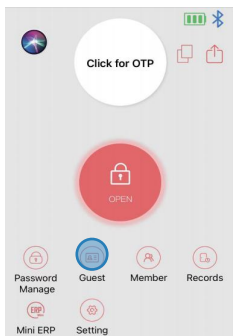

After the guests added , they can login the account and see the lock on the [share Devices] page. if don't see, pull down to refresh

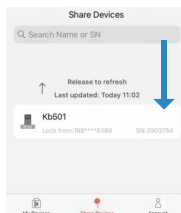
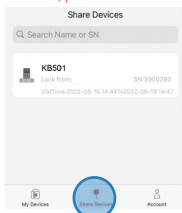

How to set password

Dynamic password change each minute.

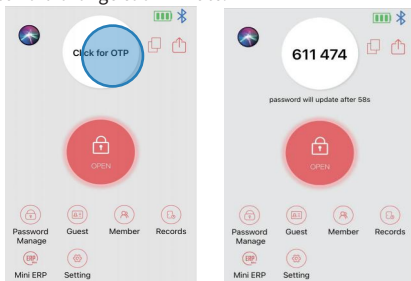

Period password (you can set the password validity time)

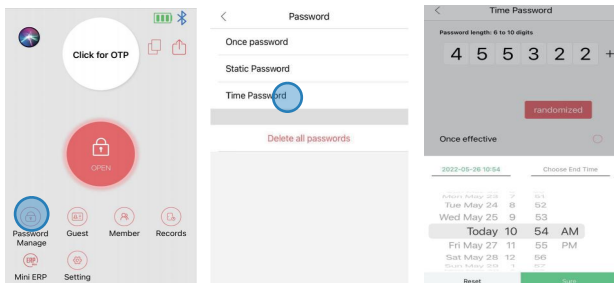

Static password.

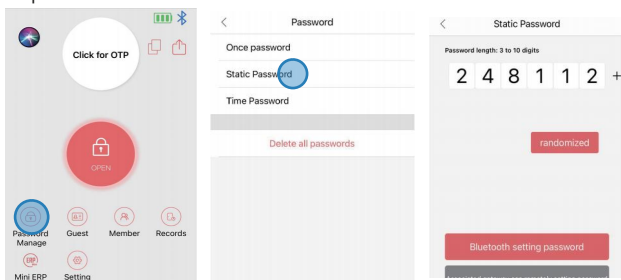

Two of Unlocking methods

1. Bluetooth unlocking

(If your lock page is [click for OTP], click left lower corner icon [Bluetooth] to switch.)

2. Password unlocking

(You can use static/period password unlocking that you set before .For dynamic password, click the center icon [click for OTP] to get)

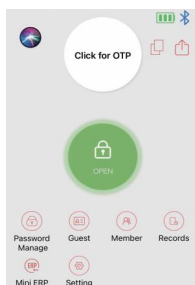
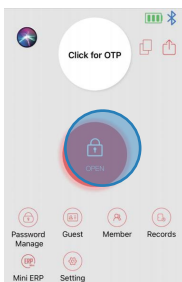

How to check record

The owner (member who have the permission) can check the records.

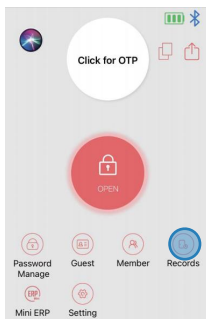

< Kb2016		
PreDay	2022-05-26	NextDay
	Get otp 198****8389 19864588389	10:26
	Get otp 198****8389 19864588389	10:26
	Get otp 198****8389 19864588389	10:26
	198****8389 19864588389	09:51
	198****8389 19864588389	09:51
	198****8389 19864588389	09:51
	198****8389 19864588389	09:51

How to share Dynamic Password by URL

Go to lock manage page, open [Share] icon,click on [Add OTP Url].

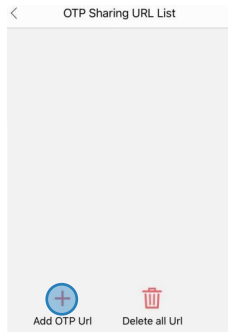
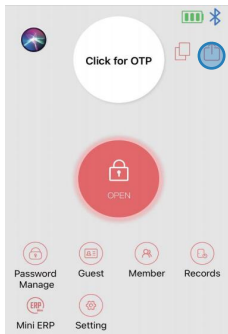

You can set the Url access time by setting start time and send time. Click to save this url share.

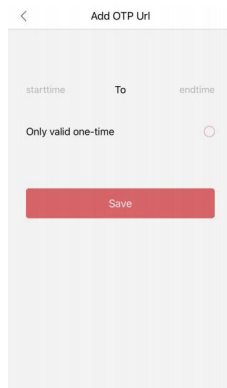
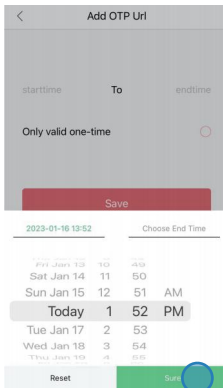

Click on [Copy] icon, then can copy the url message, and send this to your friend/ guest by message.

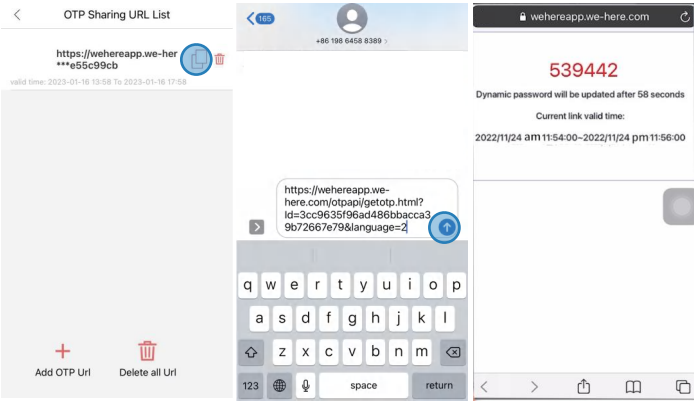

You also can delete the Url shared, after you delete, the Url can not access anymore.

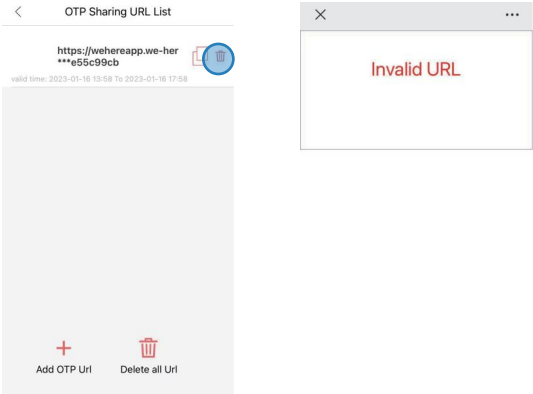

Mini ERP

Go to lock manager page, open [MiniERP] ,enter your keybox position number

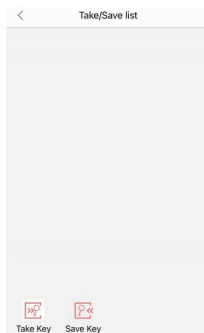
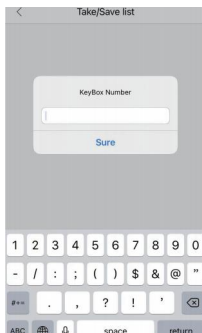
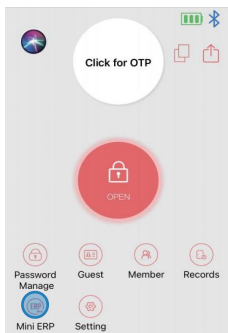

Click [Save key] icon, choose key position ,and input comment.

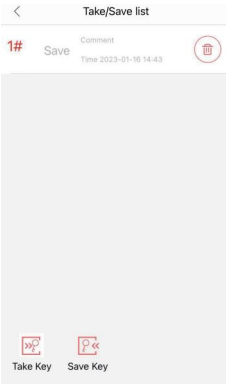
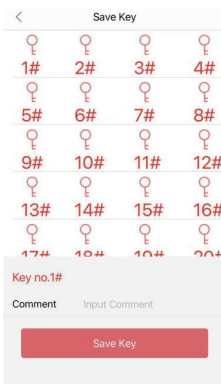
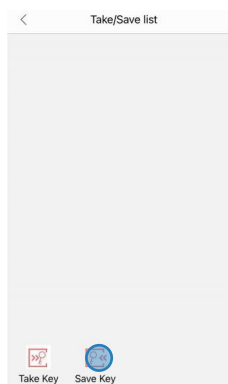

Click[Take key] icon, choose key postion, and input comment

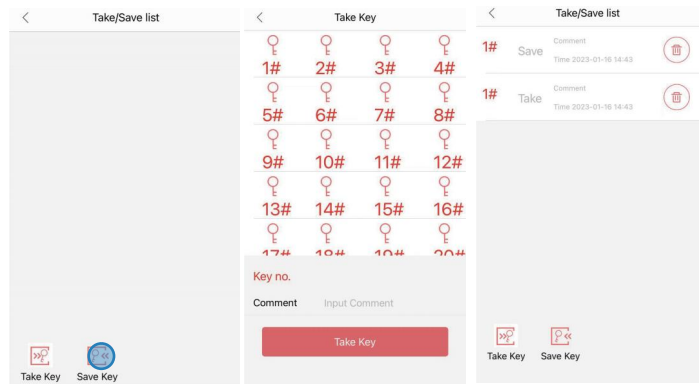

click [🗑️] icon, and delete the record .

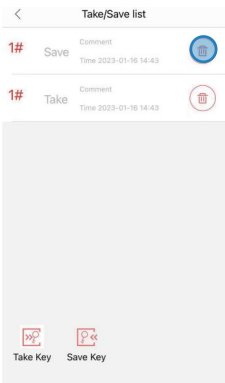

How to delete the lock

Click the lock you want delete, Open[Setting] and click on [Delete lock].

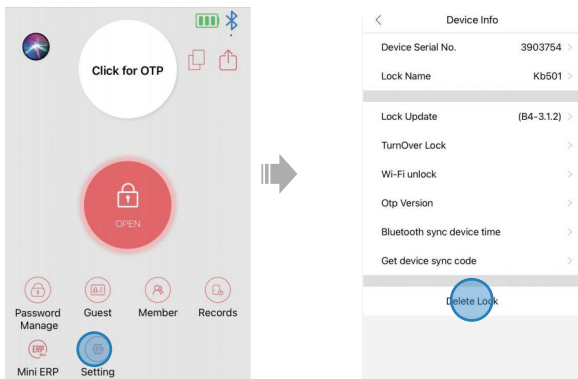

How to transfer the lock

Click the lock you want transfer, Open[Setting] and click on [TurnOver Lock] Enter the account you want to transfer, then this person will be the new owner of this lock.

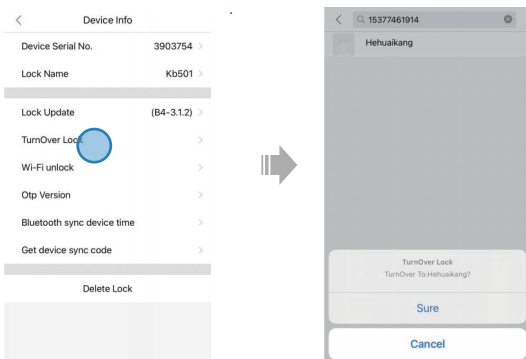

W:286mm
H:210mm
L:59mm



KB2016 (Blue /Black)

W:406mm
H:210mm
L:59mm



KB2024 (Blue /Black)

W:286mm
H:361mm
L:59mm



KB2032 (Blue /Black)

W:286mm
H:550mm
L:59mm



KB2048 (Blue /Black)



W:550mm
H:406mm
L:59mm



KB2072 (Blue /Black)



W:650mm
H:406mm
L:59mm



KB2096 (Blue /Black)



W:805mm
H:406mm
L:59mm

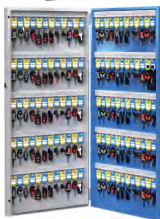

KB2120 (Blue /Black)



W:685mm
H:406mm
L:110mm



KB2192 (Blue /Black)

Tips :If have many car keys or large keys to store ,using usingthe Plus version
will not interfere the box door close



W:406mm
H:220mm
L:72mm



KB7024Plus (Blue /Black)



W:406 mm
H:550mm
L:75mm



KB7072Plus (Blue /Black)



W:286mm
H:406mm
L:90mm

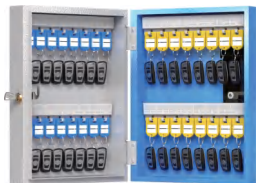

KB2032Plus (Blue /Black)



W:650mm
H:406mm
L:90mm



KB2096Plus (Blue /Black)



W:105mm
H:185mm
L:45mm

KB501 (Blue /Black)



W:140mm
H:212mm
L:68mm



KB503 (Blue /Black)

New

W:170mm
H:214mm
L:68mm



KB521 (Blue /Black)

New

W:450mm
H:805mm
L:110mm



KB3104 (Blue /Black)

SFB1001



W:280mm
H:220mm
L:220mm

SFB1002



W:430mm
H:220mm
L:370mm

SFB1003



W:430mm
H:270mm
L:370mm

■ Customer Q&A

What type of battery does it use?

It uses 2 pcs AA **alkaline batteries**.

Generally, 2pcs AA alkaline batteries can provide 12 months of power.

How many users can I add?

Owner : only one (the first person who scan qr code and bind the lock)

Member : no limited

Guest : no limited

How many passwords can be set?

Dynamic password change each minute .no limited .

Static password /period password ,total of 20 pcs passwords can be set.

If users (employees) no longer work in the company,
can we delete them?

Yes , the owner (member who have the permission) can delete
them from the member list/guess list.

Can we check the use records?

The owner (member who have the permission) can check the records . Records include bluetooth unlock records , set password records , get dynamic records . Each record has user name ,time ,action.

Can it be installed outdoors or only indoors?

Will rain affect its performance?

The waterproof grade is IP44. There is no problem with daily splashing, but you can't leave it outside in the rain. If you have to install it in a place where it may rain, you need to use something to cover it.

How to set a fixed password? The application always prompts "failed to connect the device".

1、Set static password need use phone bluetooth . So your phone needs to turn on Bluetooth (Some android phone need turn on GPS) . And it should be close to the lock in about 5 meters;

2、If you still cannot connect, you can try reset the device, by reinstall the battery .

How to remote unlock?

There are the following ways to remote unlock:

1、OTP: You can [Click for OTP] to get the OTP code, then send the code via SMS/WhatsApp to somebody who near the lock to unlock;

2、Share App: You can ask your peopel to install WeHere App on his phone and regist account, then you add his account into Member/ Guess list to share lock,then he can unlock;

3、Via W100: If you buy our W100(Wifi-Bluetooth bridge), then you can via wifi to remote unlock directly; also You can via W100 to Set/ delete period password/static password remotely;

WeHere®

Shenzhen Seamooncloud Technology Co., Ltd.

E-mail: service@we-here.com

Tel: +86-755-26052705

web: we-here.com

Add: The 2nd Floor, B1 Tower Of Jinshun Industrial Park,
Anliang Anju Road, Henggang, Longgang, Shenzhen, China