



Hollywood Makeup Mirror Four-Touch Button Controller Manual

The working temperature of this product should be below 70 C (working environment temperature + product temperature rise).

USER MANUAL



- ◀ Turn down the volume / next song  Turn on the Bluetooth function
- ▶ Turn up the volume / previous song  **Long press to adjust brightness**

4 Button Operations:

4.1 Previous Track: Short press to skip to the previous track while playing Bluetooth music. Long press to decrease the volume.

4.2 Next Track: Short press to skip to the next track while playing Bluetooth music. Long press to increase the volume.

4.3 Bluetooth: Short press to play or pause Bluetooth music.

4.4 Light Bulb Control: Short press to turn on the light. Short press again to switch the color temperature in the sequence (cool light -> warm light -> neutral light -> off -> cycle). Long press to adjust brightness when the light is on. Release and long press again to adjust brightness in the opposite direction. Long press to turn off the device when the light is off, which also turns off Bluetooth music and the button backlight. Long press again to turn on the device.

5. Notes:

5.1 The button backlight will automatically turn off 30 seconds after the last button operation. Touch any button to light up the backlight again.

5.2 When powered on, the Bluetooth device will automatically turn on. On your phone, search for the device named "**Makeup Mirror**" to connect. Once connected, you can control the playback, pause, and volume of Bluetooth music through the touch buttons on the controller panel.

Note: When the music is played at maximum volume, the LED bulbs may flicker. This is a normal resonance phenomenon.

This product uses a 12V 4A American-standard power supply.

INSTALLATION MODE

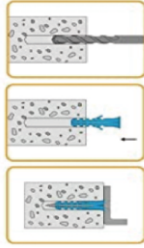

A

1. Pre-drilling holes on the wall.
2. Pushing the wall anchor gently into the pre-drilled hold.
3. Driving screws with a screwdriver into the anchor.
4. Hanging up the mirror.



B

Locking the detachable base with 4 pcs of screw (screw pack included) to be your table Hollywood mirror.

4

FCC Warning

This device complies with Part 15 of the FCC Rules. Operation is subject to the following two conditions:

(1) This device may not cause harmful interference, and (2) this device must accept any interference received, including interference that may cause undesired operation.

NOTE 1: This equipment has been tested and found to comply with the limits for a Class B digital device, pursuant to part 15 of the FCC Rules. These limits are designed to provide reasonable protection against harmful interference in a residential installation. This equipment generates, uses and can radiate radio frequency energy and, if not installed and used in accordance with the instructions, may cause harmful interference to radio communications. However, there is no guarantee that interference will not occur in a particular installation. If this equipment does cause harmful interference to radio or television reception, which can be determined by turning the equipment off and on, the user is encouraged to try to correct the interference by one or more of the following measures:

- Reorient or relocate the receiving antenna.
- Increase the separation between the equipment and receiver.
- Connect the equipment into an outlet on a circuit different from that to which the receiver is connected.
- Consult the dealer or an experienced radio/TV technician for help.

NOTE 2: Any changes or modifications to this unit not expressly approved by the party responsible for compliance could void the user's authority to operate the equipment.

RF Exposure Statement

To maintain compliance with FCC'S RF Exposure guidelines, This equipment should be installed and operated with minimum 20cm between the radiator and your body. This device and its antenna(s) must not be co-located or operation in conjunction with any other antenna or transmitter.