

CARE & MAINTENANCE

- Before using these remotes, please read the user manual thoroughly and use it according to the instructions.
- Do not use or store the remotes with temperatures exceeding 131°F (55°C) or in direct sunlight. Do not put it in fire or water.
- Do not disassemble the remotes as it does not contain self-serviceable parts.
- Ensure cards are not warped or deformed and surfaces are clean, as this can affect proper card drawing.
- Avoid strong vibrations, impacts, or shocks to the remotes, as these can interfere with proper card drawing.

WARRANTY

Thank you for choosing **KPAW**. Your satisfaction is our top priority. We stand behind our products with a comprehensive 2-year warranty.

Coverage: We replace machines with manufacturing defects, faulty materials, or craftsmanship issues. during the warranty period.

Exclusions: Damages from misuse, abuse, unauthorized modifications, fair wear and tear, or external events (e.g., accidents, natural disasters).

Claim Process: Email support@wxkpaw.com with your order ID or receipt. Describe the issue and attach relevant pictures or documentation.

KPAW

Need Help? Contact Our Customer Support Team

support@wxkpaw.com

Manufacturer: Weixing Chuangke (Shenzhen) Technology Co., Ltd

Inquiries: info@wxkpaw.com

Address: 956-958 Jiayie Plaza, No. 318 Minzhi Avenue, Minzhi Community, Minzhi Street, Longhua District, Shenzhen, Guangdong, China

Made in China

Drawing Remote



User Manual

Question or Concern?
support@wxkpaw.com

Please read the manual carefully before use and keep it for future reference.

PRODUCT DESCRIPTIONS



Remote Numbering:

Each remote is labeled with a unique number indicating its position in the system (e.g., Remote 1, Remote 2, etc.), which identifies which remote is in use.

REMOTE PAIRING

Follow the steps to pair the remotes with the machine:

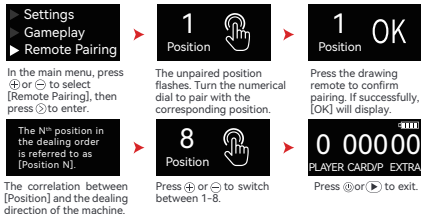

USAGE INSTRUCTIONS

Drawing Mode

1

"1" indicates the machine is oriented toward [Position 1].

During the game, press any paired drawing remote to enter [Drawing Mode]. The machine will turn to the corresponding position and deal a card. Hold any drawing remote to exit [Drawing Mode], and the machine will return to its original position and the current gameplay page.

*In [Texas Hold'em], any paired drawing remote can replace \blacktriangle to start dealing remotely.

SPECIFICATIONS

Product: Drawing Remote

Battery: CR2032

Material: ABS/POM Plastic

Weight: 0.49 oz (14 g) ea.

Dimensions: 1.7×1.7×0.4 in (45×45×10mm)

Quantity: 4

FCC WARNING

This device complies with part 15 of the FCC Rules. Operation is subject to the following two conditions: (1) This device may not cause harmful interference, and (2) this device must accept any interference received, including interference that may cause undesired operation.

Any changes or modifications not expressly approved by the party responsible for compliance could void the user's authority to operate the equipment.

This equipment has been tested and found to comply with the limits for a Class B digital device, pursuant to part 15 of the FCC Rules. These limits are designed to provide reasonable protection against harmful interference in a residential installation. This equipment generates, uses and can radiate radio frequency energy and, if not installed and used in accordance with the instructions, may cause harmful interference to radio communications. However, there is no guarantee that interference will not occur in a particular installation. If this equipment does cause harmful interference to radio or television reception, which can be determined by turning the equipment off and on, the user is encouraged to try to correct the interference by one or more of the following measures:

- Reorient or relocate the receiving antenna.
- Increase the separation between the equipment and receiver.
- Connect the equipment into an outlet on a circuit different from that to which the receiver is connected.
- Consult the dealer or an experienced radio/TV technician for help.

FCC Radiation Exposure Statement:

This equipment complies with FCC radiation exposure limits set forth for an uncontrolled environment.

This transmitter must not be colocated or operating in conjunction with any other antenna or transmitter.