

WiFi PIR Motion Sensor USER MANUAL



Modell: YX55-06001

-1-

Product Presentation:

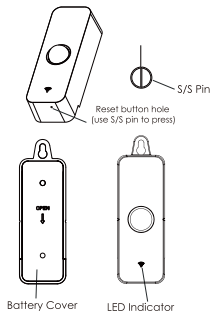

-2-

Specification

Size: 71*25*20mm

Battery: LR03-1.5V/AAA*2 (Alkaline battery)

Wi-Fi Standard: 2.4GHz

Wi-Fi Frequency: IEEE 802.11b/g/n

Standby Current: 22uA

Alarm Current: ≤ 45mA

Detect Angle: 128°

Detect distance: ≤ 6 Meters

-3-

How to use:

Slide downwards to open back cover of battery compartment, install 2pcs AAA Alkaline batteries in the right direction of electrode, the indicator will blink, then push to close the cover.

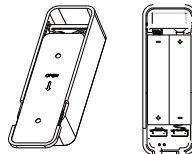

(Notes: when batteries are run out, please choose Alkaline battery instead of Carbon-zinc battery.)

-4-

How to set up:

1. Use your smartphone to scan QR code, or search "Smart Life" app in Google Play Store or APP Store to download and install.



2. Create an account with your mobile number and authentication code.

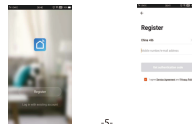

-5-

3. Connect your mobile to the Wi-Fi router, click "Add Device". Make your zigbee gateway ready and supply power to the gateway.



4. 1) Bluetooth Mode:

The app advises you to turn on the bluetooth in your mobile, enter wifi name and password, it will search nearby device, and connect the motion sensor automatically.

-6-

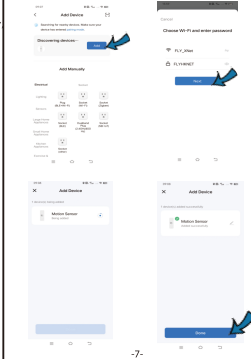

-7-

2) Blink Quickly:

Select "Motion Detector (Wi-Fi)" from "Sensors", enter wifi name and password, Select "Blink Quickly", make sure the LED indicator is blinking quickly, if not, use the supplied S/S Pin to press the reset button till indicator is blinking quickly.

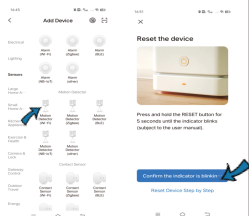

-8-

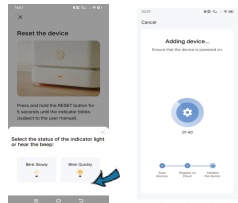

3) Blink Slowly:

You can also select "Blink Slowly", make sure the LED indicator is blinking slowly, if not, use the S/S pin to press reset button till the indicator is blinking slowly. Connect your mobile to the device's hotspot: "SmartLife-XXXX", then click to return to App interface, it will connect automatically, configuration completed.

-9-

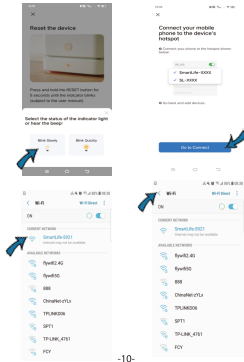

-10-

Functions

1. Alarm alert

When the sensor detects someone is passing by, you will receive alarm message on your mobile.

2. Alarm records

You can check all alarm records in the app, so you will not miss any important moments.

3. Low power alarm

When the battery power is low, the app will alert you to replace with new batteries.

4. Device sharing

Share your added sensors with family members, so they can also monitor the status on their App.

5. Scene linkage

You can set scene linkage with other tuya smart devices such as light. When it detects someone is passing by, the light will turn on automatically.

-11-

FAQ

1. If you use the motion sensor the first time, it will alarm when the sensor detects body movement. And there will be about 30s time interval to alarm after you leave the detect angle or detect range then pass by again.

2. The motion sensor is vulnerable to interrupt by heat or light sources, the infrared radiation of human body is easy to be sheltered due to poor penetration, so the detector is hard to receive the infrared.

3. The motion sensor is vulnerable to interrupt by RF radiation. When environment temperature is close to human body temperature, the detect sensitivity will decrease obviously, making sensor short-term failure sometimes.

Please contact us if you have any questions: Wiooni@outlook.com

-12-

FCC WARNING

This device complies with part 15 of the FCC Rules. Operation is subject to the following two conditions: (1) this device may not cause harmful interference, and (2) this device must accept any interference received, including interference that may cause undesired operation.

Any changes or modifications not expressly approved by the party responsible for compliance could void the user's authority to operate the equipment.

NOTE: This equipment has been tested and found to comply with the limits for a Class B digital device, pursuant to Part 15 of the FCC Rules. These limits are designed to provide reasonable protection against harmful interference in a residential installation. This equipment generates, uses and can radiate radio frequency energy and, if not installed and used in accordance with the instructions, may cause harmful interference to radio communications.

However, there is no guarantee that interference will not occur in a particular installation. If this equipment does cause harmful interference to radio or television reception,

-13-

which can be determined by turning the equipment off and on, the user is encouraged to try to correct the interference by one or more of the following measures:

- Reorient or relocate the receiving antenna.
- Increase the separation between the equipment and receiver.
- Connect the equipment into an outlet on a circuit different from that to which the receiver is connected.
- Consult the dealer or an experienced radio/TV technician for help.

To maintain compliance with FCC's RF Exposure guidelines, This equipment should be installed and operated with minimum 20cm distance between the radiator and your body. Use only the supplied antenna.

-14-