

# LOKI EARBUDS USER MANUAL

## 01/Specifications

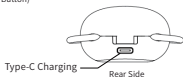
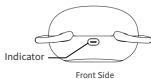
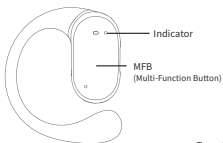

Brand: Swonder 鲸语

Model: Loki

Input: DC5V 1000mA

Materials: Titanium Alloy+SiliconeGel

Charging time for charging case: 1.5hour

Bluetooth: V5.4

Range: 10M

Frequency Response: 20Hz-20kHz

Earbud Charging Time: 1 hour

Charging Cycles: 2 Times

## 02/Bluetooth Connection

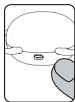

1

Taken out of earbuds  
from Charging case  
Earbuds powered on  
automatically



2

Enable Bluetooth  
function



3

Connect Bluetooth

1. Open the charging case to take two earbuds out, they will turn on automatically and enter Pairing state.
2. Enable Bluetooth function on the phone, search and find the bluetooth name "loki", then click to connect it.
3. Voice prompt "Connected successfully" once connected.

## 03/In box



Earbuds



Charging Case



User Manual



Type-C Charging Cable

## 04/Function Operation Instruction

⏻	Power On	Power on automatically after taken out of charging case Hold and press MFB button for 3 seconds to power on earb
	Power Off	Place the earbud into the charging case, earbuds powered Earbuds will be powered off automatically if not connect Hold and press MFB button for 5 seconds to power off earb
+ -	Volume+	Double Click on MFB button on right earbud
	Volume-	Double Click on MFB button on left earbud
⏮	Last one	Hold and press on MBF on left earbud for 2 seconds
	Next one	Hold and press on MBF on right earbud for 2 seconds
⏸	Play/Pause	Single Click on left or right earbud
📞	Answer call/Hang off	Single Click MFB on right or left earbud
	Reject Incoming Call	Press and hold on MFB for 2seconds when incoming call
🗣	Siri	Click on MFB three times on the Left Earbud to active or disactive
🎵	Music Mode	Click on MFB three times on right earbud
	Game Mode	Click on MFB three times on right earbud
🔄	Clear Paired	Powered off after Click on MFB four times on the left or right earbuds

## 05/LED Indicator Instruction

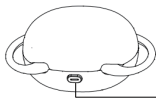

The blue LED light ON when placing earbuds on the charging case for charging.  
The blue LED light OFF after fully charged.

Be Charging	Red LED Flash
Fully Charged	Red LED Light
Low Battery	Blue LED Flash
Be Charging Earbuds	Blue LED Light
Earbuds are Fully Charged	LED Light OFF

## 06/LED Indicator/Voice Prompt Description

Mode	LED Indicator	Voice Prompt
Power ON	Blue LED Light For 3s	Power ON
Power OFF	Red LED Light For 3s	Power OFF
Pairing Mode	Blue&Red LED Flash	Doh
Connected Successfully	Light Off	Connected Successfully
Disconnected	Red&Blue light flash on right earbud, light off on Left earbud	Disconnected
Low Battery	Red LED Flash	Low Battery
Charging	Blue LED light on when charging light off after fully charged	/

## 07/Read Before Using

During using, please read the following advices carefully.

- ① Keep the product away from humid places to avoid affecting internal circuit. Do not use the product during intense exercise or with much sweat to prevent sweat from dropping into the product to make damage.
- ② Do not put the product in places exposed to sun or with high temperature. High temperature will shorten service life of electronic components damage battery and deform plastic components.
- ③ Do not put the product in cold places to avoid damaging internal circuit board.
- ④ Do not dismantle the product. Non-professional personnel may damage the product.
- ⑤ Do not drop, strongly vibrate, strike the product with hard object to avoid damaging internal circuit.
- ⑥ Do not use drastic chemicals or cleaner to clean the product.
- ⑦ Do not use sharp objects to scratch product surface to avoid damaging shell and affecting looking.

## 08/Caution

Danger of explosion if battery is incorrectly replaced.

Replace only with the same or equivalent type.

A warning that batteries (battery pack or batteries installed) shall not be exposed to excessive heat such as sunshine, fire or the like

"To prevent possible hearing damage, do not listen at high volume levels for long time."

- "Fully understand user manual before use."
- "Make sure your earbud at low volume levels or power off before youleaving."



Correct Disposal of this product. This marking indicates that this product should not be disposed with other household disposal, recycle it responsibly to promote the sustainable reuse of material resources. To return your used device, please use the return and collection systems or contact the retailer where the product was purchased. They can take this product for environmental safe recycling.

## 09/Warning

Danger of explosion if the battery is incorrectly replaced. Replace only with the same or equivalent type. For products with removable battery, the battery must be properly recycled or disposed. For products with built-in battery, disassembling is prohibited.

Never disassemble, hit with force, squeeze batteries or dispose of batteries in fire. Do not expose batteries in conductive materials, liquid, fire or heat. Do not let metal object contact two battery poles. If the battery looks swollen, leaking, discolored, having odor or any abnormal appearance, stop using it. Do not use the battery after immersed in water.

Improper use of battery may lead to explosion or leakage, causing skin burn or other injuries; in the event of battery leakage, handle it with care and immediately dispose of the battery in the manner in compliance with applicable laws and regulations in your locality.

**FCC Warning:**

This equipment has been tested and found to comply with the limits for a Class B digital device, pursuant to part 15 of the FCC Rules. These limits are designed to provide reasonable protection against harmful interference in a residential installation. This equipment generates, uses and can radiate radio frequency energy and, if not installed and used in accordance with the instructions, may cause harmful interference to radio communications. However, there is no guarantee that interference will not occur in a particular installation. If this equipment does cause harmful interference to radio or television reception, which can be determined by turning the equipment off and on, the user is encouraged to try to correct the interference by one or more of the following measures:

- Reorient or relocate the receiving antenna.
- Increase the separation between the equipment and receiver.
- Connect the equipment into an outlet on a circuit different from that to which the receiver is connected.
- Consult the dealer or an experienced radio/TV technician for help.

**Caution:** Any changes or modifications to this device not explicitly approved by manufacturer could void your authority to operate this equipment.

This device complies with part 15 of the FCC Rules. Operation is subject to the following two conditions:

(1) This device may not cause harmful interference, and (2) this device must accept any interference received, including interference that may cause undesired operation.

This equipment complies with FCC radiation exposure limits set forth for an uncontrolled environment. This equipment should be installed and operated with minimum distance 0cm between the radiator and your body.