

Product Description

Use 3X1.5V "AAA" Batteries (not included)

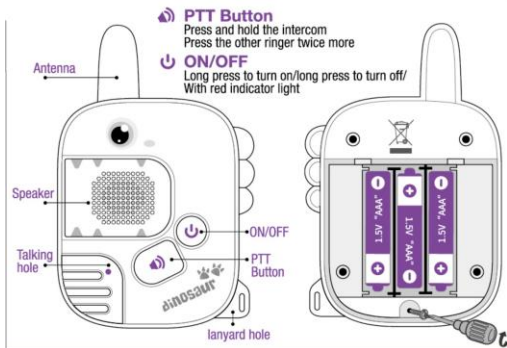

1). Belt-clip installation

Push the belt-clip into back slot of walkie-talkie, if want to take off the belt-clip, just need open the axis lock and push the belt-clip inversely.

2) Battery installation

Firstly take off the belt-clip, then open the battery compartment door, and put in 3 pieces AAA batteries, make sure + and - direction.

Note: if don't use this machine, please take off batteries.

3) Operation

Power on or off:

After installed batteries, walkie-talkie is on ready to work, it will

beep and the LED display shows the current signal channel number. As auto squelch of walkie-talkie, it will not sound before received the call information. Press  button long till LED display blanked, again press it long, the walkie-talkie will rework.

Transmit information:

While you pressing long the Talk button , than talk 3~4cm far from walkie-talkie, if your voice is so louder or the distance is so close to walkie-talkie, the signal will loss quality or distort on opponent sets.

Release the Talk button in order to listen to opponent.

Note: You have to talk in the same signal channel whatever how many people communicate.

FCC Statement

This device complies with Part 15 of the FCC rules. Operation is subject to the following two conditions: 1) this device may not cause harmful interference, and 2) this device must accept any interference received, including interference that may cause undesired operation.

Note: This equipment has been tested and found to comply with the limits for a Class B digital device, pursuant to part 15 of the FCC Rules. These limits are designed to provide reasonable protection against harmful interference in a residential installation. This equipment generates uses and can radiate radio frequency energy and, if not installed and used in accordance with the instructions, may cause harmful interference to radio communications. However, there is no guarantee that interference will not occur in particular installation. If this equipment does cause harmful interference to radio or television reception, which can be determined by turning the equipment off and on, the user is encouraged to try to correct the interference by one or more of the following measures:

- Reorient or relocate the receiving antenna.
- Increase the separation between the equipment and receiver.
- Connect the equipment into an outlet on a circuit different from that to which the receiver is connected.
- Consult the dealer or an experienced radio/TV technician for

help.

Changes or modifications not expressly approved by the party responsible for compliance could void the user's authority to operate the equipment.

This equipment complies with FCC radiation exposure limits set forth for an uncontrolled environment. User should avoid un-intended operation of usage when it is collocated with other transmitters or antenna.