

## NON-RECHARGEABLE VERSION



Doll & Remote Control vehicle:  
3 X AA batteries (not included)



Remote Control:  
2 X AA batteries (not included)

### BATTERY INSTALLATION Non-Rechargeable Version:

Make sure it is in the off state. Use a crosshead or Phillips screwdriver to remove the screws from the back battery cover of the remote control or the vehicle. Insert 2 "AA" batteries into the remote control or 3 "AA" batteries into the vehicle, ensuring that the batteries match the corresponding polarity marked with "+" and "-". Reinstall the battery cover and tighten the screws.

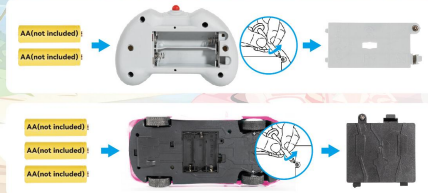

### Remote Control Function

POWER INDICATOR

FORWARD  
BACKWARD  
LEFT/RIGHT



POWER SWITCH: Short press to turn on  
Long press for 2s to turn off

- 1. Flashing Indicator Light:  
Pairing in progress
- 1. Indicator Light On:  
Remote control turned on
- 1. Indicator Light Off:  
Remote control turned off

### To pair the remote control with the remote control car:

1. Make sure there are no other remote control vehicles in the "ON" state nearby. Press the power switch on the remote control to turn it on and set the "ON/OFF" switch on the back of the remote control vehicle to the "ON" position to turn on the remote control vehicle.
2. The indicator lights on the remote control and the vehicle's lights will flash, indicating they are ready to pair.
3. Once the indicator light on the remote control stays on and the vehicle's lights turn off, it means the pairing process is successful.

### To control the remote control vehicle, follow these steps:

1. Turn on the remote control by pressing the power switch. Switch the remote control vehicle to the "ON" position. Use the control sticks on the left and right sides of the remote control to maneuver the vehicle. Pushing the sticks forward or backward controls the vehicle's forward and backward movement, while moving the sticks left or right controls the vehicle's turning.
2. When the remote control vehicle moves forward or backward, the headlights will light on, but when it turns left or right, the headlights are off.
3. If you do not operate the remote control for approximately 10 minutes, the remote control will shut off to preserve the life of the batteries. The vehicle's lights will flash as a reminder to turn off the vehicle's power. (Closing the power of both the car and the remote control when not playing helps conserve battery power and increase overall battery life. This practice is beneficial for maximizing the vehicle's runtime and reducing unnecessary battery drain.) To reactivate, simply press the button on the remote control, and the power ON and pair with the vehicle again.

### TIPS



If the vehicle does not move forward or backward in a straight line, you may want to adjust the front wheels. Adjust the drift position dial to either the right or left.



To release the seatbelt, pull it vertically upwards, and it will loosen, allowing you to pull it out. To fasten the seatbelt, insert the buckle into the corresponding receptacle and pull it downwards vertically to tighten it securely.



The doll can be taken out for play.

### BATTERY SAFETY INFORMATION

In exceptional circumstances, batteries may leak fluids that can cause a chemical burn injury or ruin your product. To avoid battery leakage.

#### ⚠️ ALKALINE BATTERY WARNINGS

Do not mix old and new batteries.  
Do not mix alkaline, standard (vehiclebon-zinc), or rechargeable batteries. Alkaline batteries are recommended. Use only the specified voltage. Insert batteries using the correct polarity. Always use, replace, and recharge (if applicable) batteries under adult supervision.  
Do not charge non-rechargeable batteries.  
Do not short-circuit the battery supply terminals.  
Remove batteries before storing the vehicle. Please make sure to remove exhausted batteries from the product. Dispose of the batteries safely and in accordance with local regulations.  
Do not dispose of batteries in fire, batteries may explode or leak.  
Recycle or dispose of batteries according to federal, state, and local laws.

Battery chargers used with the product are to be regularly examined for damage to the cord, plug, enclosure, and other parts, and in the event of such damage, they must not be used until the damage has been repaired. Recycle or dispose of battery according to federal, state, and local laws. Keep these instructions for future reference.

FAULT DESCRIPTION	SOLUTION
Vehicle drives slowly	The wheels on the vehicle may be dirty. Clean with a damp cloth.
	Battery power may be low. First change the batteries in the vehicle. If still slow, change the batteries in the remote control.
Vehicle does not respond to the remote control	First, check to make sure the batteries are installed correctly. You may also need to reset the electronics. To reset, slide the power switch off and back on. If the vehicle continues to malfunction or no longer operates, it's time to replace the batteries with fresh batteries.
	Battery power may be low in the vehicle or the remote control. First replace the batteries in the vehicle. If there is still no response, replace the batteries in the remote control.
	The maximum range between the remote control and vehicle is about 196.85 feet (60 meters). Operate the remote control closer to the vehicle. Remove any obstructions between them.

### Contact us

If you have any issues with our product, please do not hesitate to contact us through the following channels. We will do our best to assist you.

EMAIL: [service.hapkid@gmail.com](mailto:service.hapkid@gmail.com)

## FCC Statement

This device complies with part 15 of the FCC Rules. Operation is subject to the following two conditions: (1) This device may not cause harmful interference, and (2) this device must accept any interference received, including interference that may cause undesired operation.

This equipment has been tested and found to comply with the limits for a Class B digital device, pursuant to part 15 of the FCC Rules. These limits are designed to provide reasonable protection against harmful interference in a residential installation. This equipment generates, uses and can radiate radio frequency energy and, if not installed and used in accordance with the instructions, may cause harmful interference to radio communications. However, there is no guarantee that interference will not occur in a particular installation. If this equipment does cause harmful interference to radio or television reception, which can be determined by turning the equipment off and on, the user is encouraged to try to correct the interference by one or more of the following measures:

- Reorient or relocate the receiving antenna.
- Increase the separation between the equipment and receiver.
- Connect the equipment into an outlet on a circuit different from that to which the receiver is connected.
- Consult the dealer or an experienced radio/TV technician for help.

Caution: Any changes or modifications to this device not explicitly approved by manufacturer could void your authority to operate this equipment.

### RF Exposure Information

The device has been evaluated to meet general RF exposure requirement. The device can be used in portable exposure condition without restriction.