

Welcome Guide

Product Number: ZW1009

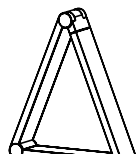

1×LED Lamp



1×Welcome Guide

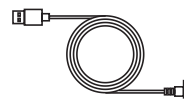

1×A- DC Cable

Page 02-04

Product Number: ZW1010 (with wireless charger)

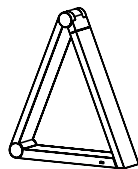

1×LED Lamp



1×Welcome Guide

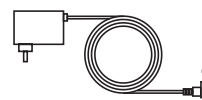

1×Adapter

Page 05-07

Specifications (ZW1009)

| | |
|--------------------------|----------------------------|
| Material: | ABS, PC |
| CCT: | 2800K-6500K (adjustable) |
| CRI: | Ra95 |
| Lumen: | 570lm |
| Rated Input: | DC 5V |
| Lamp Power: | 11W |
| Wireless Charger Output: | No Wireless Charger |
| USB-C Output: | 5V- 1A/2A |

Specifications are subject to change without notice.

-01-

-02-

Operating Instructions

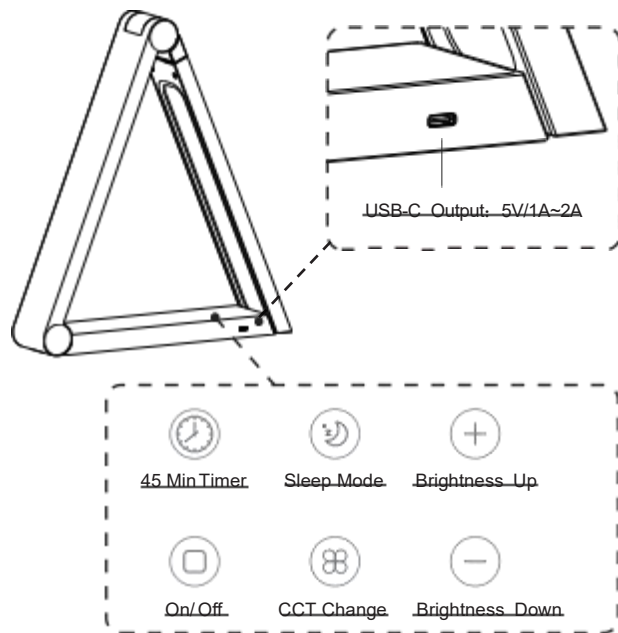

-03-

Operating Instructions

Swivel lamp head via hinge
Cast light directly where you needed.

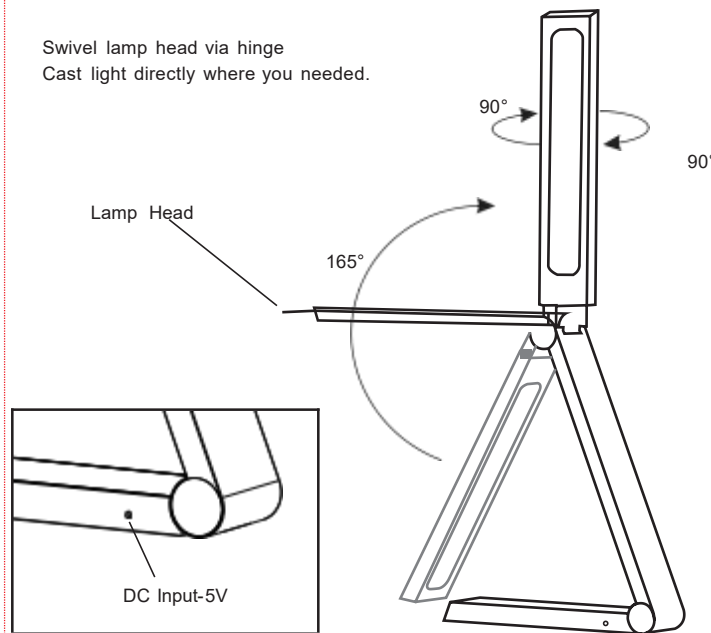

-04-

Specifications(ZW1010)

| | |
|--------------------------|----------------------------|
| Material: | ABS, PC |
| CCT: | 2800K-6500K (adjustable) |
| CRI: | Ra95 |
| Lumen: | 570lm |
| Lamp Input: | DC 12V |
| Lamp Power: | 11W |
| Adapter: | AC 100-240V |
| Wireless Charger Output: | 15W/10W/7.5W/5W |
| USB-C Output: | 5V/9V/12V - 20W MAX |

Specifications are subject to change without notice.

-05-

Operating Instructions

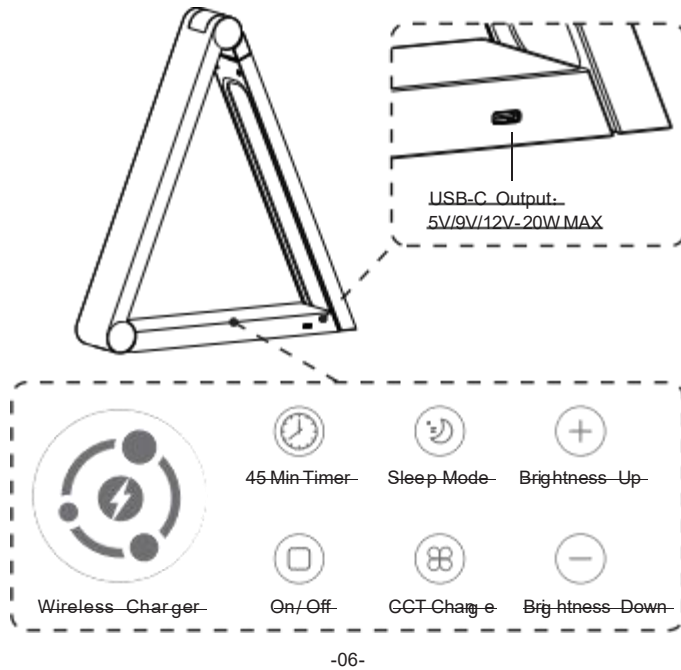

Operating Instructions

Swivel lamp head via hinge
Cast light directly where you needed.

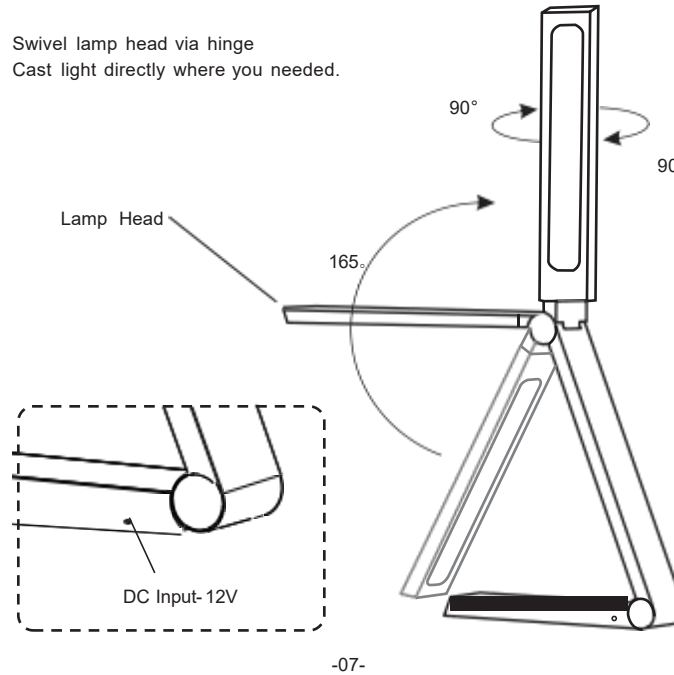

Safety Precautions

1. Please use the lamp on a stable table to avoid falling.
2. Do not disassemble any part of the desk lamp.
3. Do not use the desk lamp in a damp place.
4. Please avoid extreme temperatures.
5. Please use the original power adapter.
6. Do not clean the desk lamp with any corrosive cleaner.
7. Do not use the desk lamp in series with other electrical appliances, nor in parallel with the dimmer.
8. Avoid using metal cases when using wireless charging, otherwise it may cause errors.
9. If the wireless charging doesn't work, please check if your products have the function of wireless charging.
10. If the desk lamp is faulty, please disconnect the power supply in time and contact the supplier.

Attention: Please comply with the above items, otherwise the faulty will not be covered by the warranty.

-09-

Compliance

The product complies with all applicable requirements for Restriction of Hazardous (ROHS) and Waste Electrical & Electronic Equipment (WEEE)

FCC WARNING

This device complies with part 15 of the FCC Rules. Operation is subject to the following two conditions:

- (1) this device may not cause harmful interference, and
- (2) this device must accept any interference received, including interference that may cause undesired operation.

Any changes or modifications not expressly approved by the party responsible for compliance could void the user's authority to operate the equipment.

NOTE: This equipment has been tested and found to comply with the limits for a Class B digital device, pursuant to Part 15 of the FCC Rules. These limits are designed to provide reasonable protection against harmful interference in a residential installation. This equipment generates, uses and can radiate radio frequency energy and, if not installed and used in accordance with the instructions, may cause harmful interference to radio communications.

However, there is no guarantee that interference will not occur in a particular installation. If this equipment does cause harmful

interference to radio or television reception, which can be determined by turning the equipment off and on, the user is encouraged to try to correct the interference by one or more of the following measures:

- Reorient or relocate the receiving antenna.
 - Increase the separation between the equipment and receiver.
 - Connect the equipment into an outlet on a circuit different from that to which the receiver is connected.
 - Consult the dealer or an experienced radio/TV technician for help.
- To maintain compliance with FCC's RF Exposure guidelines, This equipment should be installed and operated with minimum 20cm distance between the radiator and your body: Use only the supplied antenna.

WEEE Compliance



Correct Disposal of This Product (Waste Electrical & Electronic Equipment)(Applicable in countries with separate collection systems)

This marking on the product, accessories or literature indicates that the product and its electronic accessories should not be disposed of with other household waste at the end of their working life. To prevent possible harm to the environment or human health from uncontrolled waste disposal, please separate these items from other types of waste and recycle them responsibly to promote the sustainable reuse of material resources. Household users should contact either the retailer where they purchased this product, or their local government office, for details of where and how they can take these items for environmentally safe recycling. Business users should contact their supplier and check the terms and conditions of the purchase contract. This product and its electronic accessories should not be mixed with other commercial wastes for disposal.