

WIRELESS MEAT THERMOMETER

Thank you for choosing our Wireless Smart Meat Thermometer

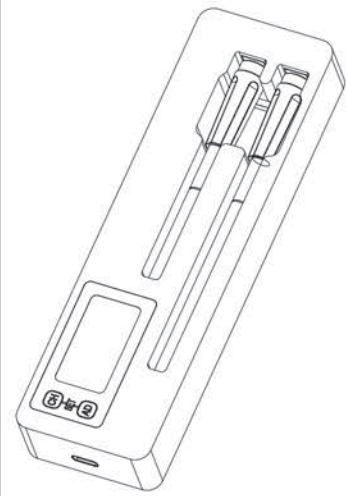

USER MANUAL

Model: A7

Please read this manual carefully before using and keep it properly for future reference (Please follow the important safety information (at the back of this page/ in the AIBBQ life APP) to get the better user experience. For more information, please check "Settings-Help/-Support" on the APP)

OPERATING INSTRUCTION

Step 1.

After receiving the product, charge the product first. During the charging process, the display screen will light up, and a charging instruction will appear in the display screen.



Step 2.

Scan the QR code on the back of the manual (or search for AIBBQ life in the app store) (iOS/Android).



iOS



Android

Step 3.

Launch the app



Step 4.

When the product gap is taken out upward, the temperature probe is automatically activated and connected to the charging box repeater

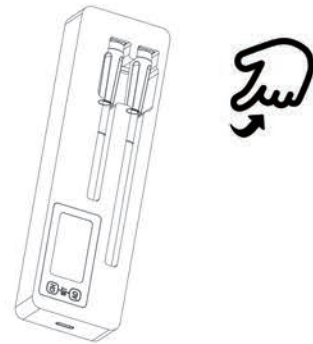

Step 5.

Click "+" in the APP, search for AIBBQ life and click Bind to connect to the charging box repeater



Step 6.

Start making the meat dishes you want.

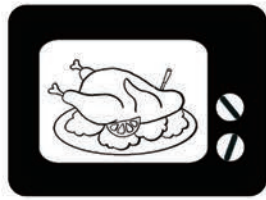

PROBE INSERTION

ALWAYS INSERT INTO MEAT PAST THE SAFETY NOTCH TO AVOID DAMAGE

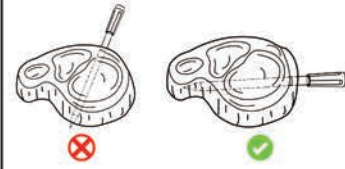

Click to enter the cooking interface, select the food to be cooked, set the target temperature and the preset temperature.

Click on the settings in the upper left corner of the APP interface to select functions such as Fahrenheit/Celsius, language, sound, etc Click to start cooking. When the selected food reaches the target temperature, the APP will issue an alert or vibration to remind you that the food is ready.

PRODUCT FEATURES

Internal Temperature Probe

Accurate measures internal temperatures from 32°F to 212°F
+/-1.8°F Accuracy
Fast respond in 2 seconds

Premium Food Grade304 Stainless Steel

Water resistant design,dustproof and easy to clean

Safety Notch

Always insert into meat past the safety notch to avoid damage

Heat-resistant Plastic Handle

Maximum temperatureresistance 608°F

The short needle needs to be inserted into the food with the entire stainless steel surface to better monitor the temperature.

Please Place the Booster Close to the Probe

CAUTION

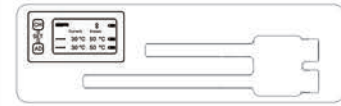
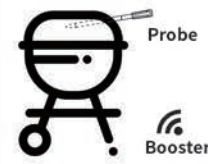

Long range 500ft



CAUTION

Probe: Charging for 10-15 minutes can be used for 36-48 hours.

The barbecue needle can work alone without connecting to the mobile APP, or it can be connected to the mobile APP and work in cooperation with the APP.

Default double needle back to the warehouse, double needle and repeater are in standby state, and the display screen is off.

POWER ON

When the long/short probe is removed from the repeater, the removed probe is in the working state, and the repeater wakes up from the standby state and the display is lit.

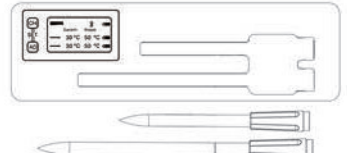

LIGHT UP THE DISPLAY SCREEN

When the repeater is powered on, you can touch the touch key CH or AD on the display screen to power on the display screen. The display screen automatically turns off after no operation for 15 seconds.

The BBQ needle can be connected to APP and work together with APP. The display screen displays information about the connection status between the repeater and the APP, the battery power of the repeater and the probe connected to the repeater, the real-time temperature of the needles connected to the repeater and the target temperature of the probe connected to the repeater.

THE REPEATER ACCESS STATUS IS DISPLAYED

When the repeater is connected to the APP, the Bluetooth icon will appear in the repeater access status bar. But APP if no is connected to the repeater, The access status bar of the repeater is blank.

THE LONG OR SHORT ACCESS STATUS IS DISPLAYED

If the long/short probe are connected to the repeater, the real-time temperature of the long/short probe is displayed in the real-time temperature bar. Display the current target temperature of the long/short probe in the long/short probe target temperature bar;The battery level of the long/short pins is displayed in the battery level bar. If the long/short pins are not connected to the repeater, NA is displayed in the real-time temperature bar of the long/short probe and the target temperature bar of the long/short probe.

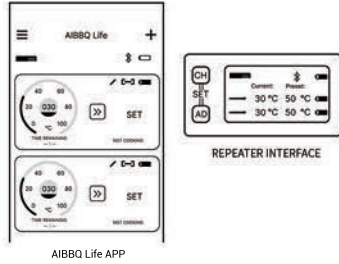

SET MODE

Setting mode can be used to change the temperature unit and set the target temperature of the needle. The operation method is as follows: When the display is on, touch the CH and AD buttons on the display to enter the setting mode. A small gray box appears on the display. Touch the touch button CH on the display screen to move the small square between the temperature unit -- needle 1 target temperature -- needle 2 target temperature.

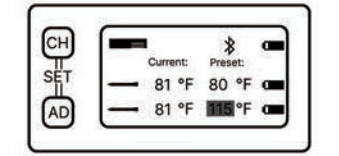

SWITCHING TEMPERATURE UNIT

Move the small box to the temperature unit setting bar and touch the touch button AD on the display screen to switch the temperature unit between °C and °F;

SET TARGET TEMPERATURE

Move the small box to the long/short probe target temperature setting bar, and long press the touch button AD to increase the long/short probe target temperature; Short press the AD button to reduce the target temperature of the long/short probe (the target temperature of the long/short probe can be set only after the long/short probe are connected to the repeater).

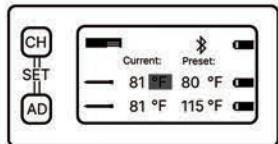
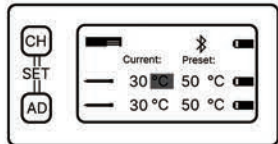

After setting the target temperature of the long/short probe on the repeater, if the repeater is connected to the APP, the target temperature of the long/short probe will be synchronized to the APP. You can also set the target temperature of the long/short probe on the APP. After the target temperature of the long/short probe is set, it will be synchronized to the repeater, and the temperature unit on the repeater will be automatically adjusted according to the temperature unit selected by the APP.

WARNING REMINDER

When the real-time temperature of the long/short probe reaches or exceeds the target temperature of the long/short probe, the display light up, the buzzer buzzes, and the real-time temperature and target temperature of the long/short probe turn red. If the repeater is connected to the APP, the APP will open the alarm reminder simultaneously. At this time, touch any key to turn off the repeater alarm.

POWER OFF

Insert the long or short probe back into the repeater, and the long or short probe will stop working and start charging. When all the probe are inserted back into the repeater, the repeater stops working and the touch button on the display screen is invalid.

DEVICE CHARGING

When the long/short probe battery is low on the display screen, the long/short probe must be plugged back into the repeater to charge. Long/short probe will automatically stop charging after charging is completed without manual intervention.

REPEATER CHARGING

When the battery of the repeater is low on the display, charge the repeater in time. The display lights up during charging of the repeater. You can view the charging status of the repeater on the display.

IMPORTANT SAFETY INFORMATION

NOTE:Use this device only for its intended purpose

Warning

1.Do not have direct skin contact with the probe during or after cooking to avoid burns

2. Close supervision is necessary if this is to be used near children. To prevent them from using this product as a toy.

3.Do not immerse the charging base in water or other liquid. The probe is designed to be water resistant, not waterproof, it should not be submerged in water for a long time to avoid product damage.

4.The use of accessories not recommended by the device manufacturer may cause danger or injury.

5.Do not place this product in a microwave oven, pressure cooker, or deep frying pan to avoid danger.



Probe

Make sure that any part of the probe does not come into contact with any open flames to avoid damage



CARE AND MAINTENANCE

CARE

1. Clean before/after use.
2. When the probe is completely dry and clean, return it to the charging box/repeater.
3. When the pin is not in use, store the device in a cool, dry place.



When cleaning, pay special attention to the stainless steel head to be clean and dry before entering the storage box

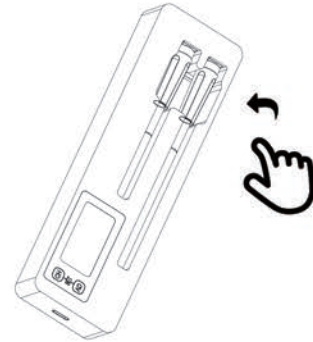

WARRANTY

This device complies with part 15 of the FCC Rules. Operation is subject to the following two conditions: (1) this device may not cause harmful interference, and (2) this device must accept any interference received, including interference that may cause undesired operation.

Any changes or modifications not expressly approved by the party responsible for compliance could void the user's authority to operate the equipment.

NOTE: This equipment has been tested and found to comply with the limits for a Class B digital device, pursuant to Part 15 of the FCC Rules. These limits are designed to provide reasonable protection against harmful interference in a residential installation. This equipment generates, uses and can radiate radio frequency energy and, if not installed and used in accordance with the instructions, may cause harmful interference to radio communications. However, there is no guarantee that interference will not occur in a particular installation.

If this equipment does cause harmful interference to radio or television reception, which can be determined by turning the equipment off and on, the user is encouraged to try to correct the interference by one or more of the following measures:

-- Reorient or relocate the receiving antenna.
-- Increase the separation between the equipment and receiver.

-- Connect the equipment into an outlet on a circuit different from that to which the receiver is connected.
-- Consult the dealer or an experienced radio/TV technician for help.
The device has been evaluated to meet general RF exposure requirement. The device can be used in portable exposure condition without restriction.

1.This device has a 12-month after-sales warranty. We will provide free service for any functional failure confirmed by the service center.

2. If you have any questions, please feel free to email us and we will be happy to serve you.

CE

The CE mark which is shown on the certificate can only be used under the conditions that the products complete with all of the relevant Directives of EC Declaration of Conformity.



The APP does not have cloud server and will not automatically collect customer private information