

**SECU365**

# SECU365 Smart Cam



## SCB15

User Guide v1.0

### 1 What's Inside



SCB15



Mounting Plate



Power Adapter DC12V-1A



User Guide



Waterproof jacket



Expansion Anchors\*3



Screws\*3

### 2 Tools for Set Up



Phillips screwdriver



Electric drill

### 3 Product Overview

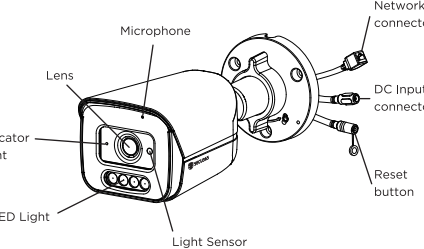

Microphone

Lens

Indicator Light

LED Light

Light Sensor

Network connector

DC Input connector

Reset button

**Indicator light status:**

Solid red: Camera malfunction or offline

Solid green: Camera operating normally

### 4 Wiring diagram—Power Adapter

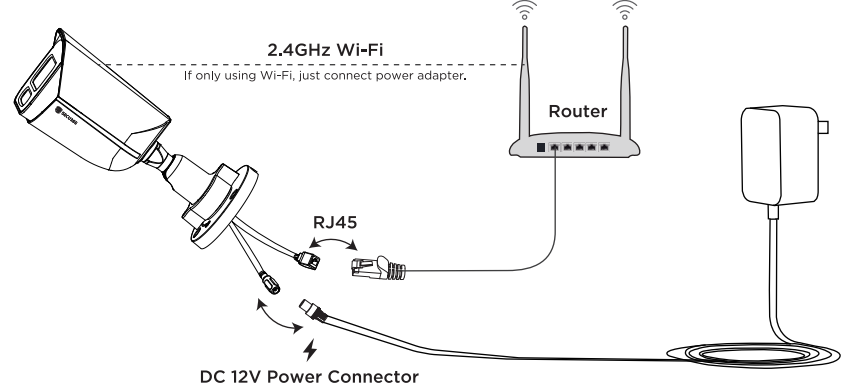

2.4GHz Wi-Fi

If only using Wi-Fi, just connect power adapter.

Router

RJ45

DC 12V Power Connector

**Notice:** By default, the cameras use Dynamic Host Configuration Protocol (DHCP) and User Datagram Protocol (UDP) to obtain their IP addresses and network configurations.

### 5 Wiring diagram—PoE

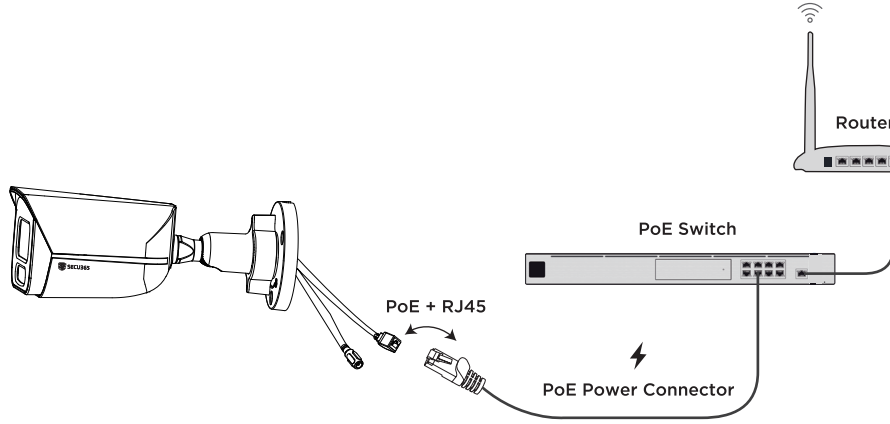

PoE + RJ45

PoE Power Connector

PoE Switch

Router

**Notice:** SECU365 cameras are powered through Power over Ethernet (POE supports Standard IEEE 802.3at PoE PD). This means the network switch needs to provide power to the camera, or a PoE injector needs to be utilized.



**SECU365**

  
**Tel**  
1-866-866-8365

  
**Support**  
Support@secu365.com

  
**Website**  
www.secu365.com

© 2024 SECU365 brands and products are trademarked and protected under law in the United States. Unauthorized use is prohibited.

## 6 Download App



Scan the QR code to download SECU365 app.

## 7 Watch Video



Please scan the QR code for detailed instruction video.

## 8 How to Install

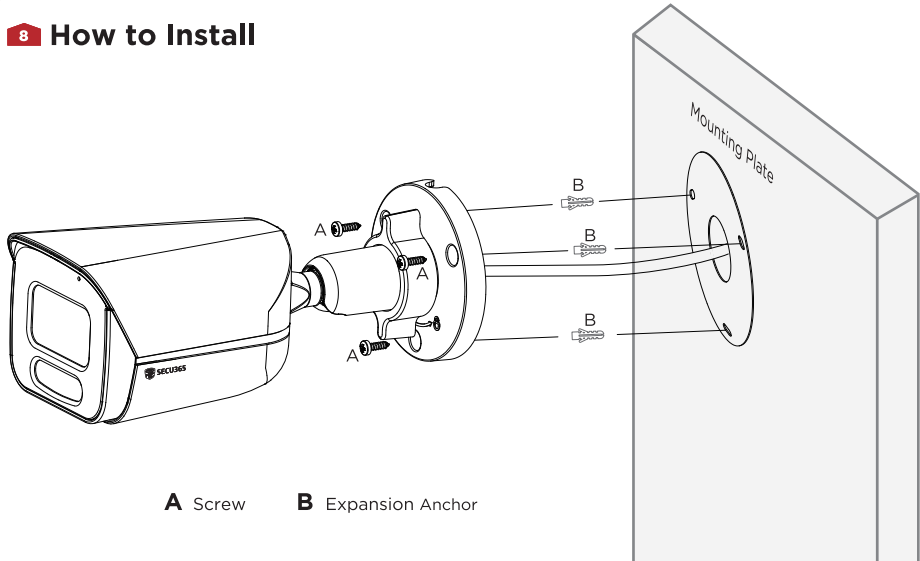

A Screw

B Expansion Anchor

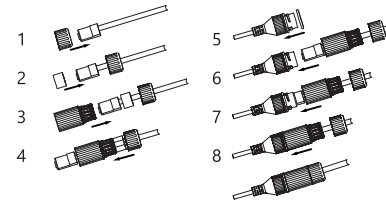
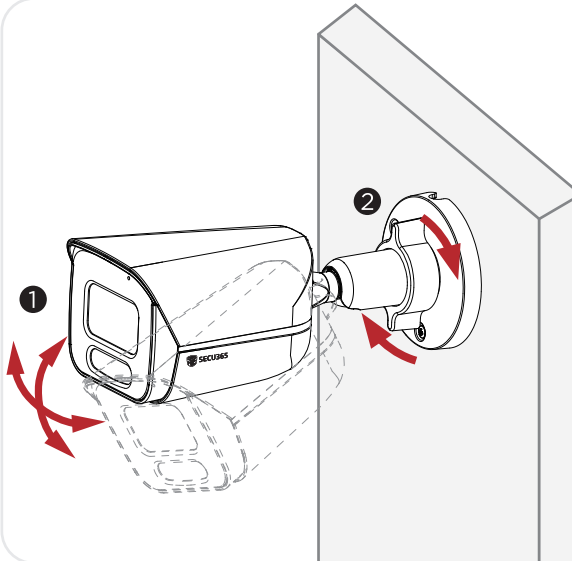

### Simple Plug

Waterproof jacket (Type A) assembly instructions:

1. Insert screw top into riveted plug.
2. Insert silicone barrel-type circle into plug.
3. Insert waterproof jacket into plug.
4. Put silicone barrel-type circle into waterproof jacket.
5. Put seal ring onto RJ45 jack.
6. Slip plug into RJ45 jack.
7. Fasten waterproof jacket.
8. Tighten screw top.

## 9 Specifications

Camera	
Image Sensor	1/2.7" 5 Megapixel Progressive Scan CMOS
Max Resolution	2560×1440
Lens	
Focal Length	2.8mm
Aperture	F1.3
Angle of View	111.5°(H) 134.8°(D)
Lens	Fixed
Video	
Video Compression	H.264 H.265
Resolution	Main Stream (2560×1440) Sub Stream (640×360)
Smart Feature	
Feature	Person detection, Motion detection
Technical Data	
Operating Temp	-30~45°C (22~113°F)
Power	PoE or 12V/1A adapter
Weather Proof	IP65
Network	
Management	Secu365 Web, Secu365 Mobile APP
Network Requirement	10/100M Adaptive Ethernet 802.11 b/g/n

## 10 FCC Warning:

This equipment has been tested and found to comply with the limits for a Class B digital device, pursuant to part 15 of the FCC Rules. These limits are designed to provide reasonable protection against harmful interference in a residential installation. This equipment generates, uses and can radiate radio frequency energy and, if not installed and used in accordance with the instructions, may cause harmful interference to radio communications. However, there is no guarantee that interference will not occur in a particular installation. If this equipment does cause harmful interference to radio or television reception, which can be determined by turning the equipment off and on, the user is encouraged to try to correct the interference by one or more of the following measures:

- Reorient or relocate the receiving antenna.
- Increase the separation between the equipment and receiver.
- Connect the equipment into an outlet on a circuit different from that to which the receiver is connected.
- Consult the dealer or an experienced radio/TV technician for help.

### Caution:

Any changes or modifications to this device not explicitly approved by manufacturer could void your authority to operate this equipment.

This device complies with part 15 of the FCC Rules. Operation is subject to the following two conditions: (1) This device may not cause harmful interference, and (2) this device must accept any interference received, including interference that may cause undesired operation. The device has been evaluated to meet general RF exposure requirement. This equipment complies with FCC radiation exposure limits set forth for an uncontrolled environment. This equipment should be installed and operated with minimum distance 20cm between the radiator & your body.

This symbol refers that the product must not be discarded as household waste, and should be delivered to an appropriate collection bucket for recycling. Proper disposal and recycling help to protect natural resources, human health and the environment. For more information on disposal and recycling of this product, contact your local municipality, disposal service, or the shop where you bought this product.





C: 30    M: 100    Y: 100    K: 0

RGB: #C40000



PANTONE P 49-8 C/U