

## Bluetooth Speaker

### CHARGING METHOD

Insert one end of the power cord into the mini jack of this unit and the other end into the USB port of the computer or connect the standard 5V 500mA charging interface, charging "red light" light, full "red light" off. This machine built-in overcharge protection circuit can be connected to the computer or charger for a long time to use, about 3 hours can be full of batteries; electricity Each battery life will vary depending on the volume of time used.

### BATTERY IS LOW

When the battery power is low, the system will automatically shut down, then please charge in time; if the machine is not used for a long time, to Charge less once a month, you can protect the battery to extend battery life.

### LIST OF PACKAGED GOODS

The following items are included in the box. If there is any missing, please contact the seller.  
Bluetooth speaker: 1 set  
Charging line: 1 PCS  
Product manual: 1 PCS

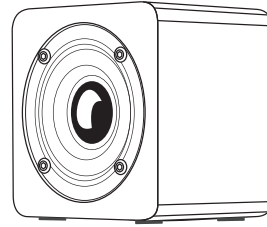

## PRODUCT MANUAL

## Bluetooth Speaker

To customers:

Thank you for choosing our Bluetooth mini speaker, in order to let you experience the product easily, we have the content Detailed instructions for use, you can get in formation on the product introduction, use, etc. In the Before you use this machine, please read the instructions carefully, if there is a typographical error or translation error, the majority of users understand.

### PRECAUTIONS

In order for the user to use the player correctly and ensure the player performs well, please read and follow carefully:

- Do not hit the host seriously.
- Do not touch benzene, thinner and other chemicals.
- Please do not close the strong magnetic field, electric field.
- Please avoid direct light or heating appliances.
- Do not disassemble, repair, alteration.
- Do not listen at a loud volume to avoid adversely affecting your hearing.
- Discard packaging, batteries, old electronic products, please sort properly handle.

### PERFORMANCE PARAMETER

- Speaker specifications: 2 inches 3.5 ohms
  - Frequency response: 60Hz-18KHz
  - Sensitivity: 80dB  $\pm$  2dB
  - Signal to noise ratio:  $\geq$ 90dB
  - Distortion: 0.5%
  - Bluetooth version: BLUETOOTH5.0
- Bluetooth communication range: more than 10 meters in straight line without blocking (mobile phone Different types of equipment and environment will affect the distance).
- Power supply: built-in lithium battery

## Bluetooth Speaker

### SCHEMATIC

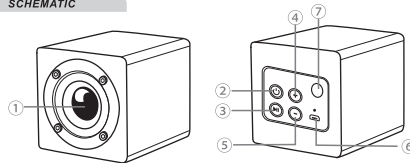

1. Horn.
  2. [⏻] power
  3. [⏮] Play/Pause .
  4. [⏩] Long press volume increase/Short press a song
  5. [⏮] Long press the volume minus/Short press the previous song
  6. DC 5V charging.
  7. Air guiding hole
- Note: If a crash occurs, press and hold the play/pause button for 8 seconds to automatically reset.

### Bluetooth connection method

1. Boot into Bluetooth mode
  2. Turn on the Bluetooth function of mobile devices (mobile phones, computers, etc.) and search for Bluetooth devices.
  3. Manually click, the device automatically pairs, connects, and the connection will beep when the connection is successful.
  4. A device that has been paired successfully will automatically connect the next time it opens.
- Note: Within 10 seconds of entering Bluetooth mode, Bluetooth will automatically find the device and pair it.

This device complies with part 15 of the FCC Rules. Operation is subject to the following two conditions: (1) This device may not cause harmful interference, and (2) this device must accept any interference received, including interference that may cause undesired operation.

Any Changes or modifications not expressly approved by the party responsible for compliance could void the user's authority to operate the equipment.

**Note:** This equipment has been tested and found to comply with the limits for a Class B digital device, pursuant to part 15 of the FCC Rules. These limits are designed to provide reasonable protection against harmful interference in a residential installation. This equipment generates uses and can radiate radio frequency energy and, if not installed and used in accordance with the instructions, may cause harmful interference to radio communications. However, there is no guarantee that interference will not occur in a particular installation. If this equipment does cause harmful interference to radio or television reception, which can be determined by turning the equipment off and on, the user is encouraged to try to correct the interference by one or more of the following measures:

- Reorient or relocate the receiving antenna.
- Increase the separation between the equipment and receiver.
- Connect the equipment into an outlet on a circuit different from that to which the receiver is connected.
- Consult the dealer or an experienced radio/TV technician for help.

#### FCC Radiation Exposure statement

The device has been evaluatec to meel general RF exposure requirement. The device can be used in porlable exposure condition without restriction.