

READ ME!

# CHARGING TIPS

1

INCLUDED ARE  
TWO TYPES OF CABLES  
(usb-a or usb-c)

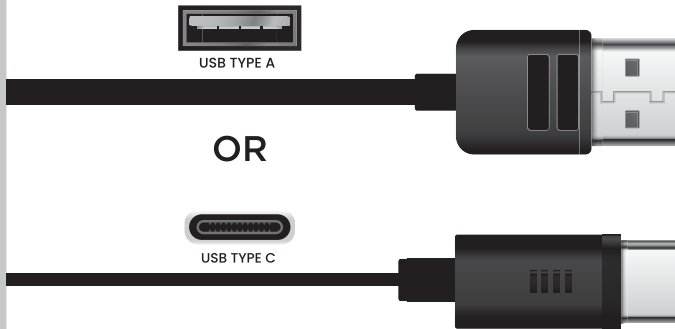

2

PLUG CABLE INTO  
YOUR APPLE OR ANDROID  
PHONE CHARGING BLOCK

Single port! Don't use multi ports.



3

PLUG INTO  
WALL SOCKET

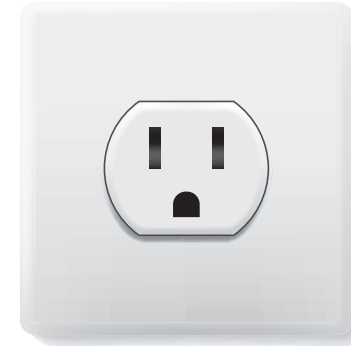

## AVOID USING THESE!

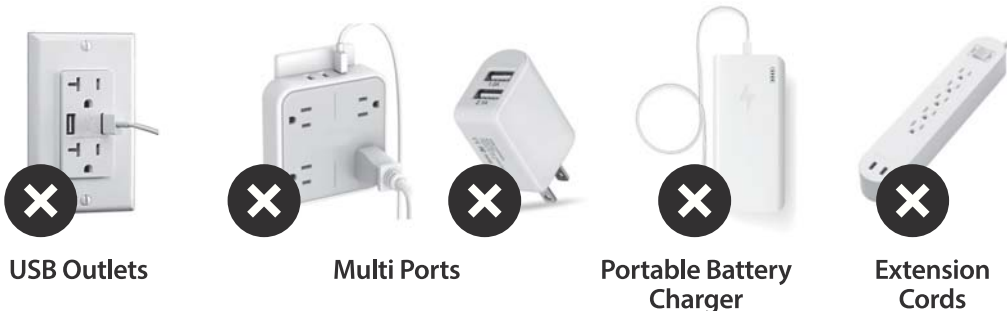

VENTY has a super strong battery and these methods do not work well at charging large batteries.

## CHARGING THE FAN

- The lithium ion battery can be used 24+ hours depending on which features are used.
- The battery can take up to 8 hours to fully charge. The charging light will illuminate white while charging and will turn off when fully charged.
- Make sure you are charging directly into a head that is plugged into the wall. Do not use a multi port or extension cord.

## USING THE FAN TO CHARGE YOUR DEVICE

The port also acts as an output to charge your mobile phone or tablet.

## CHECKING BATTERY LEVEL

To check how much battery is left, long press the power button on the console. 1, 2 or 3 lights will light up to represent how much juice is left in the battery.

## CONTROL FEATURES

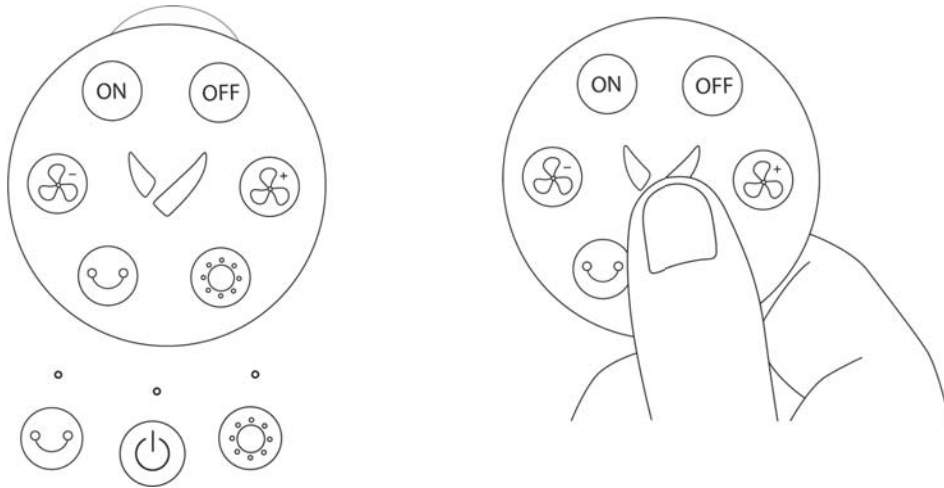

**POWER ON:** Turn Venty on by a long press of the ON button.



**POWER OFF:** Turn Venty off by a long press of the OFF button.



**SPEED INCREASE:** 4 speeds are accessible from the remote, or by pressing the power button.



**SPEED DECREASE:** 4 speeds are accessible from the remote, or by press the power button.



**LIGHT SETTING:** 3 modes of light can be accessed by pressing the button on the control panel, or via remote control.



**OSCILLATION:** Press to allow the fan to oscillate airflow.

## OPENING THE FACEPLATE

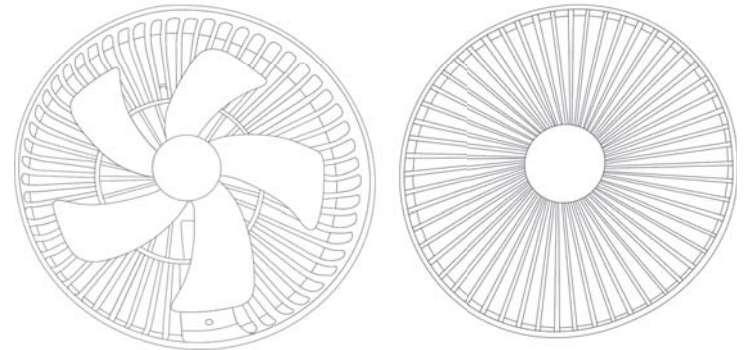
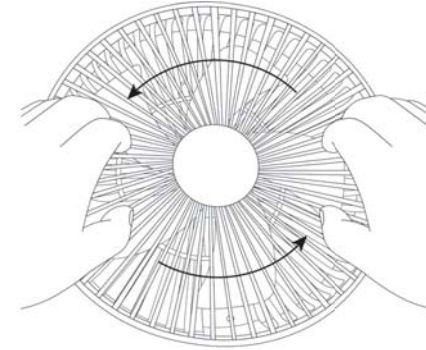

### REMOVING THE FACEPLATE

To clean the Venty fan, you can remove the faceplate by twisting the interior plate counterclockwise. Do not try to take the head off, only the face plate.

Once removed, you can use a damp rag to remove any dust built up on the fan blades.

Do not try to remove the fan blade and never submerge in water. The faceplate can be put back in place by turning clockwise.

#### FCC Warning Statement:

This equipment has been tested and found to comply with the limits for a Class B digital device, pursuant to part 15 of the FCC Rules. These limits are designed to provide reasonable protection against harmful interference in a residential installation. This equipment generates, uses and can radiate radio frequency energy and, if not installed and used in accordance with the instructions, may cause harmful interference to radio communications.

However, there is no guarantee that interference will not occur in a particular installation. If this equipment does cause harmful interference to radio or television reception, which can be determined by turning the equipment off and on, the user is encouraged to try to correct the interference by one or more of the following measures:

- Reorient or relocate the receiving antenna.
- Increase the separation between the equipment and receiver.
- Connect the equipment into an outlet on a circuit different from that to which the receiver is connected.
- Consult the dealer or an experienced radio/TV technician for help.

**Caution:** Any changes or modifications to this device not explicitly approved by manufacturer could void your authority to operate this equipment.

This device complies with part 15 of the FCC Rules. Operation is subject to the following two conditions: (1) This device may not cause harmful interference, and (2) this device must accept any interference received, including interference that may cause undesired operation.

The device has been evaluated to meet general RF exposure requirement.