

Table of Symbol			
	Store between 2°C~30°C		For in vitro diagnostic use only
	Caution		Consult instructions for use
	Manufacturer		Lot number
	Tests per kit		Date of Manufacture
	Serial number		Waste electrical materials should be sent to a dedicated collection point for recycling.
	Courant Direct		Connect to bluetooth devices
	Do not reuse		

femometer®

**Hangzhou Laihe Biotech Co., Ltd.**  
Room 401-406, F1-3, Building 1, No.425 Miaohouwang Road,  
Xixing Street, Binjiang District, Hangzhou, 310051 Zhejiang P.R.  
China

**Distributor: Lollipop Technology (Hangzhou) Co., Ltd.**  
1901 Dongguan Building, No.618 Jiangnan Avenue, Binjiang  
District, 310000, Hangzhou, Zhejiang, China

**Customer service:** support@femometer.com

**Made in China**

File version: A11  
Effective Date:2023-10

5. Place the meter on a flat surface. Wait for about 5-10 minutes till you hear ten beeps which indicate that the test is completed. The test result will be displayed on the screen.



①do not pull out the test stick while testing.  
②If the Femometer App is connected, the test results will also be uploaded to the App for historical records.

6. Remove and discard the test stick after the test is complete.



#### 9. Test result

\* The measurement result will be displayed for 10 minutes. If the screen goes out after some time, pulling out the test stick, it will show again for 5 minutes.

Indicates a LOW result with a low probability of conception. Please test again after 24 hours. To ensure the accuracy of the tests, please test every day.



Indicates HIGH result, when the test detects the rise of LH, "+" will be displayed, which indicates a high probability of conception. Please test every 4-6 hours afterwards. Have intercourse today to increase your chance to pregnant.



Indicated a PEAK result which means an LH surge is detected. And you have the highest probability of conception. Please keep testing every 4-6 hours until it shows "+" or "-", which indicates that you have ovulated. Have intercourse within 24 hours to maximize your chance to pregnant.



#### 10. Product specifications

Product name: Fertility Tracking Kit  
Product model: FM-IVY-103  
Dimension of meter: 120\*28.5\*19mm  
Weight of meter: 30g  
Operation condition Temperature: 20°C~30°C(68°F~86°F), RH: ≤85%,  
Pressure: 86~106kpa  
Storage condition Temperature: -25°C~55°C(-13°F~131°F), RH: ≤95%,  
Pressure: 86~106kpa  
Service life of meter: 3 years  
Battery: CR2032 battery (replaceable battery)  
Test sticks: Contains 20 Fertility Tests  
Storage condition of test stick Temperature: 2°C~30°C(36°F~86°F)  
Accuracy: 99%

#### 11. Error and troubleshooting

When a fault occurs during the test process, the instrument will beep for 10 seconds and display the error code on the screen. The

meanings of the error code are shown in the following table. If the methods do not solve the problem, please contact customer services (support@femometer.com) for help.

Trouble	Reason	Solution
The screen becomes unclear or doesn't show anything	Low battery	Replace battery
	An error occurs and the machine shuts down automatically	Replace a new test Stick and take test again.
Inaccurate results	Incorrect test procedure	Test according to the user manual strictly
Error code: E0	Low battery	Replace battery
Error code: E1	Test fail	Before adding sample: Reinsert the stick and take a test again After adding sample: Replace a new test Stick and take test again
Error code: E2	Add sample time out (more than 10 minutes without complete add sample)	Take out the test stick, wait 10 seconds after the meter is off, then reinsert the test. Sample addition should be completed within 10 minutes
Error code: E3	Pull out test stick during test	Reinsert the test stick within 10 seconds; otherwise, the test will fail

#### 12. Maintenance

Replace the battery  
When the meter starts to blink the low battery signal " ~- ", Replace a new battery for the meter.

Maintenance  
1. Please keep the meter clean.  
2. The internal hardware and software of the Digital Fertility Meter can only be repaired, replaced or upgraded by manufacturer. Please contact customer services for support.

Maintenance Method and Plan  
The meter does not require special maintenance or cleaning. External cleaning and maintenance method: A cloth dampened with 70% alcohol can be used to wipe the outside of the meter. Do not use strong bleach (≥0.5% bleach solution), because oxidizing substances and solvents may damage the meter's parts and touch screen. Take care to avoid getting liquids, dirt, blood or buffer into the meter through the slot or data port.

Caution  
Before cleaning, please make sure the meter is turned off and the battery has been taken out.

#### 13. Precautions for meter use

1. Do not place the meter in a position that is difficult to operate.  
2. In addition to the test stick provided by the manufacturer, do

not put any other items into the meter.

3. If the test sample is potentially infectious, please use protective gloves or other protective measures to avoid skin contact with the test stick and sample.

4. Please treat the used test stick according to the Medical Waste Management Regulations to avoid biological hazards.

5. Please use the meter in strict accordance with the instructions provided by Femometer, otherwise, the protection provided by the meter will be damaged.

#### 14. Q&A

1. Q: Why is my Ivy not connecting to the app via Bluetooth?  
A: Make sure your phone's Bluetooth is turned on. If Ivy still does not connect, restart your smartphone and Ivy.

2. Q: How do I restart my Ivy?  
A: Pull out the test stick, wait 10 seconds for the automatic shutdown, and reinsert a test stick to restart.

3. Q: How long should I continue testing?  
A: Test until an LH surge has been detected. If your bleed begins before you see a surge, test again during the next cycle, but start on an earlier cycle day. If you do not see a HIGH result after testing for 3 cycles, consult your doctor.

4. Q: Do alcohol or common medications affect the test?  
A: No, but consult your doctor regarding whether LH testing is useful for you if you are taking medications that affect hormones or for fertility reasons.

5. Q: Once I see a PEAK result, when is the best time to have intercourse?  
A: Ovulation is likely to occur within 24-48 hours. This is your most fertile time, so we advise having intercourse within 24 hours.

6. Q: Will the amount of liquid I drink affect the result?  
A: We suggest that you limit your intake to less than about two hours before you collect your sample. Drinking a large amount before testing will dilute the hormone in your urine.

7. Q: Can I determine the result from the lines on the test stick?  
A: No, the results can only be read on the meter's screen or in the Femometer app.

8. Q: Can I buy more test sticks used with the meter?  
A: Yes, the meter can be re-used with supplement test stick for FM-IVY-103 only. Do not put any other test stick or stick into the meter.

#### 15. Disclaimer

This manual is written in accordance with available information and contents are subject to change without notice. Lollipop Technology (Hangzhou) Co., Ltd. has made the best effort to guarantee the manual's accuracy and reliability. However, the company does not assume liability for loss or damage caused by omissions, inaccuracies or typographical errors in this manual.

If there are discrepancies in this manual due to software upgrades, instructions and functions dictated by the software.

#### 16. Warranty page

Product model: Remark:  
Purchase data: Point of sales:

Note

- 1-year warranty (from date of purchase) is included under proper usage.
- Warranty doesn't cover parts other than the meter itself.
- Under these circumstances, repair will be charged.
  - Warranty expired.
  - Warranty card not shown to the seller.
  - Vague information on the warranty card.
- The warranty does not cover
  - Product surface damage
  - Battery
  - Damages caused by improper using habit
  - Improper inspection and maintenance
  - Other irresistible reasons

#### Warning:

This device complies with Part 15 of the FCC Rules. Operation is subject to the following two conditions: (1) this device may not cause harmful interference, and (2) this device must accept any interference received, including interference that may cause undesired operation. Changes or modifications not expressly approved by the party responsible for compliance could void the user's authority to operate the equipment. NOTE: This equipment has been tested and found to comply with the limits for a Class B digital device, pursuant to Part 15 of the FCC Rules. These limits are designed to provide reasonable protection against harmful interference in a residential installation. This equipment generates, uses and can radiate radio frequency energy and, if not installed and used in accordance with the instructions, may cause harmful interference to radio communications. However, there is no guarantee that interference will not occur in a particular installation.

If this equipment does cause harmful interference to radio or television reception which can be determined by turning the equipment off and on, the user is encouraged to try to correct the interference by one or more of the following measures:  
--Reorient or relocate the receiving antenna.  
-- Increase the separation between the equipment and receiver  
--Connect the equipment into an outlet on a circuit different from that to which the receiver is connected.  
--Consult the dealer or an experienced radio/TV technician for help

**NOTE:** This device and its antenna(s) must not be co-located or operation in conjunction with any other antenna or transmitter. The device has been evaluated to meet general RF exposure requirement. The device can be used in portable exposure condition without restriction.

femometer®

# IVY 103

FM-IVY-103

## Fertility Tracking Kit User Manual

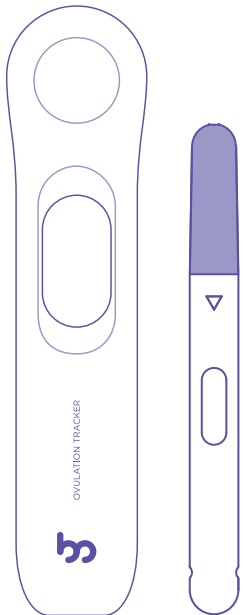

## Thank you for purchasing!

For the safe use of the product, please read this User Manual first, and keep it properly after reading so that you may access and consult it at any time.

## 1. Intended use

Fertility Tracking Kit is composed of the Meter and Test stick. It is intended to be used for the semi-quantitative detection of luteinizing hormone (LH) in human urine, as an aid in predicting the time of ovulation, and peak fertility.

## 2. Summary

Ovulation is the release of an egg from the ovary. The egg then passes into the fallopian tube where it is ready to be fertilized. In order for pregnancy to occur, the egg must be fertilized by sperm within 24 hours after its release. Immediately prior to ovulation, the body produces a large amount of luteinizing hormone (LH) which triggers the release of a ripened egg from the ovary. This "LH surge" usually takes place in the middle of the menstrual cycle.

Fertility Tracking Kit is a complete system to help predict the time of ovulation, and peak fertility. It is during this fertile time that pregnancy is most likely to occur. The product detects the LH surge in urine, signaling that ovulation is likely to occur in the next 24-36 hours. The test utilizes a combination of antibodies including a monoclonal LH antibody to selectively detect elevated levels of LH. Important: The LH surge and ovulation may not occur in all cycles.

## Reagents

The test contains anti-LH particles and anti-LH antibodies coated on the membrane.

## 3. Test principle

Fertility Tracking Kit is a lateral flow sandwich immunoassay employing monoclonal antibodies that are specifically directed against the coating and labeling antibody. During the test procedures, the user collects a sample in a clean, dry container and dips the sample pad into the collected sample until the screen prompts sample adding is complete (which usually takes 15-20 seconds). After the urine specimen is applied to the stick, the substance to be tested in the sample will react with the monoclonal antibody conjugate of the substance to be tested obtained by mouse immunization. Conjugated complexes migrate along the membrane to the test and control regions. The digital component integrated with the chromatographic strip displays the results of the immunochemical reaction on the screen of the equipment. After the equipment self-calibration procedure is completed, the screen displays the progress bar to indicate that the test is working. After the result is displayed on the screen, the test is completed. The test progress usually takes 5-10 minutes.

## 4. Product structure

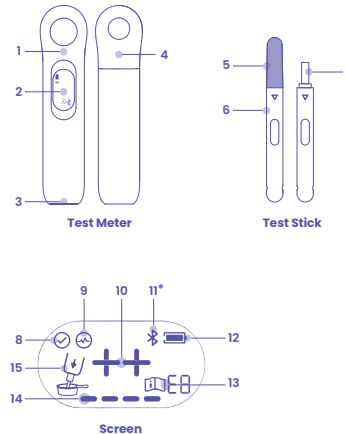

- 1.FM-IVY 103 meter 2.Screen 3.Test insert position 4.Battery cover 5.Test stick cap 6.Test stick 7.Sampling tip8.Test complete 9. In testing 10.Test results 11.Bluetooth connection status 12.Battery status 13.Error code 14. Progress bar in test 15.Prompt to add sample

\*Steady on indicates that the Femometer App is connected, blinking or off indicates that the App is not connected

## 5. List of accessories

1 digital meter, 20 fertility tests, 1 urine cup, 1 CR2032 battery, 1 user manual, 1 quick guide.

Please confirm what's in the package you have purchased. In case anything is missing, please contact us via [support@femometer.com](mailto:support@femometer.com)

## 6. Dos and Don'ts

- For Self-testing. Do not use it after the expiration date.
- Do not eat, drink or smoke in the area where the samples or products are handled.
- Do not use a test if the pouch is damaged.
- Handle all samples as if they contain infectious agents. Observe established precautions against microbiological hazards throughout the procedure and follow the standard procedures for the proper disposal of samples.
- Humidity and temperature can adversely affect results.
- Keep out of the reach of children.
- The test stick in the bag should be used immediately after unpacking to avoid failure caused by dampness.
- Stop drinking water 2 hours before collecting the urine sample to prevent it from being diluted.
- There is a desiccant in the aluminum foil bag. Do not eat it.
- The urine cup can be reused.
- Test sticks are disposable and cannot be reused.
- The used test should be discarded according to local regulations.
- This product is for in vitro diagnostic use only.
- This product is an auxiliary diagnostic device only. It cannot determine the actual amount of hormone in a urine sample. The test results cannot serve as a basis for diagnosis.
- Used test stick, meter and the battery disposal must comply with the regulations of the national government and environmental protection agencies.
- When there are stains, it is recommended to wipe with alcohol cotton or damp cloth.
- Do not attempt to disassemble or repair the meter. Doing so may result in inaccurate readings.
- Please check the delivery information of products, including unpacking, completeness and any damages during transport, and contact customer services ([support@femometer.com](mailto:support@femometer.com)) if there are any damages.

## Warning

Any measurement done by this product is for personal reference only. It is very dangerous for a patient to conduct self-diagnosis and self-treatment based on measurements only. Please be sure to follow your doctor's instructions.

## 7. When to start testing

First, determine the subject's menstrual cycle length. The menstrual cycle length is the number of days from the first day of the subject's period (menstrual bleeding) to the last day before the next period starts.

Next, determine the days to count ahead after the period to start testing. Find the subject's menstrual cycle length on the first row of the chart below, and read the corresponding days to count ahead in the second row. This is the number of days after the period to begin testing.

Cycle length	Testing day
21 or less	5
22	5
23	6
24	7
25	8
26	9
27	10
28	11
29	12
30	13
31	14
32	15
33	16
34	17
35	18
36	19
37	20
38	21
39	22
40 or more	23



## Days to Count Ahead

Finally, determine the day to start testing. Starting from and including the first day of the last period, count ahead the number of days indicated in the previous step. This is the day on which testing should begin.

Note: If uncertain about the length of the subject's menstrual cycle, use the shortest menstrual cycle length (21 days) when reading the chart.

## 8. How to use

Install the CR2032 battery inside the package.



Scan QR code with a phone camera to download the App.

①The Digital Fertility Tracking kit can work without App. In order to take historical records, it is recommended to use it with the Femometer App.

②To avoid wasting the test stick, it's better to pair the App when you are trying to take a test.

③Please place the meter as close as possible to your phone. If the first pairing fails, please try it again. If the pairing still fails, please contact customer services ([support@femometer.com](mailto:support@femometer.com)) for help.

## Start the IVY meter

Take out a test stick from the foil wrapper, insert the test into the meter.



## Pair IVY 103

For the newly downloaded App, tap the scan icon on the Prime promotion page and scan the QR code to pair.

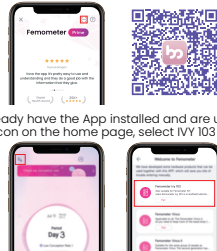

• If you already have the App installed and are using it, tap the Bluetooth icon on the home page, select IVY 103 to pair.

## Take test

1. Collect your urine sample using the clean dry cup included in the package.

① First morning urine is not recommended, but any other time of day is suitable. For best results, try to collect urine at approximately the same time each day.

② Only fill sample cup to the line. Don't drink too much liquid before testing.

2. Allow the test stick to equilibrate to room temperature (20°C-30°C or 68°F-86°F).

3. Take out the test stick from the foil wrapper, remove the test stick cap, and insert it into the meter. The screen will display the last test result for 5 seconds, then the icon "⚡" blinks prompt to add sample. (Please make sure that the test stick is inserted all the way to the bottom)



4. Dip the sampling tip of the test stick into the urine and hold the meter until you hear three "beeps" (usually takes 15-20 seconds to complete), a progress bar will appear at the bottom of the screen. Then pull out the meter and put the test stick cap back on.

①Please finish adding samples within 10 minutes, otherwise the test will fail.

②Do not let the urine pass over the plastic part of the test stick.

③Do not pull out the test stick while adding samples.

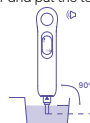

成品尺寸：120\*65mm

纸张材质：70克双胶纸，风琴折