

POWERSPORT AMPLIFIED  
SOUNDBAR



INSTRUCTION MANUAL  
MODEL: MS2608

3. Product Overview

Front Panel of the Soundbar

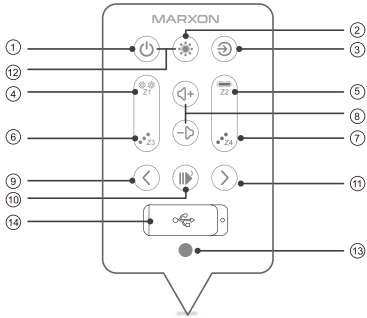

**1) Power**  
Long touch>=2s to switch the soundbar on/off

**2) Multiple link**  
Touch to enter broadcast mode

**3) Source**  
Touch to switch input source, circulation as below: BT→Aux in→USB→FM  
Long touch>=2s to enter pairing mode/disconnect current connection in BT mode  
Long touch>=5s to clear all Bluetooth connections in BT mode

**4) Z1 light**  
Touch to switch the drive light effect, circulation as below: Bounce→Gradient→Red→White→Green→Blue→off

**5) Z2 light**  
Touch to switch the light band effect, circulation as below: Red→White→Yellow→Purple→Blue→off

**6) Z3 light(The light effect is synchronized with the Z1 light)**  
Touch to switch the external light on/off.  
Long touch>=2s to set the currently playing radio station to preset 1 in FM mode

**7) Z4 light (The light effect is synchronized with the Z1 light)**  
Touch to switch the external light on/off.  
Long touch>=2s to set the currently playing radio station to preset 2 in FM mode



Used correctly, domestic batteries are a safe and dependable source of portable power. Problems can occur if they are misused or abused – resulting in leakage or, in extreme cases, fire or explosion. Here are some simple guidelines to safe battery use designed to eliminate any such problems.

Take care to fit your batteries correctly, observing the plus and minus marks on the battery and appliance. Incorrect fitting can cause leakage or, in extreme cases, fire or even an explosion.

Replace the whole set of batteries at one time, taking care not to mix old and new batteries or batteries of different types, since this can result in leakage or, in extreme cases, fire or even an explosion.

Store unused batteries in their packaging and away from metal objects which may cause a short-circuit resulting in leakage or, in extreme cases, fire or even an explosion.

Remove dead batteries from equipment and all batteries from equipment you know you are not going to use for a long time. Otherwise the batteries may leak and cause damage.

Never dispose of batteries in fire as this can cause them to explode. Please recycle dead batteries; do not put with the normal household waste.

Never attempt to recharge ordinary batteries, either in a charger or by applying heat to them. They may leak, cause fire or even explode. There are special rechargeable batteries which are clearly marked as such.

Supervise children if they are replacing batteries themselves in order to ensure these guidelines are followed.

Remember that small button cell batteries such as used in some hearing aids, toys, games and other appliances, are easily swallowed by young children and this can be dangerous.

Keep loose button cells away from young children.

Make sure battery compartments are secure.

Seek medical advice if you believe a cell has been swallowed.

**8) Volume up/down**  
Increase or decrease the volume  
Press and hold to decrease or increase the volume continuously

**9) Previous**  
Touch to skip to the previous track in USB/BT mode  
Touch to tune down the frequency in FM mode  
Long touch>=2s to scan down radio in FM mode

**10) Play/Pause**  
Touch to start, pause or resume play in USB/BT mode  
Long touch>=3s to activate your phone's voice assistant in BT mode  
Touch once to answer the call and again to hang up when there is a call in BT mode  
Touch to switch to preset station 1/2 in FM mode

**11) Next**  
Touch to skip to the next track in USB/BT mode  
Touch to tune up the frequency in FM mode  
Long touch>=2s to scan up radio in F mode

**12) Power+ Multiple link**  
Hold down the power and multiple link buttons for 5 seconds at the same time to factory reset.

**13) Remote Control Sensor**

**14) USB**  
Audio input from a USB storage device

**LED indications**  
The soundbar has an indicator light below each button.

LED indication		Status	Behavior
Power(backlight)		Power on	Solid(Red)
		Standby	Slow breathe(Red)
Multiple link(backlight)	Master device	Broadcast transmission mode on	White, solid
		Broadcast transmission mode off	-
	Slave device	Broadcast reception mode on	White, fast flash
		Connected	White, solid
		Disconnected	White, slow flash 3s and then enter broadcast reception mode
		Broadcast reception mode off	-
Source(backlight)		BT ready mode	Solid(Blue)
		BT pairing mode	Fast flash(Blue)
		BT connected	Solid(Blue)
		BT disconnected	Slow flash 3s(Blue)
		Aux in mode	Solid(Green)
		USB mode	Solid(White)
		FM mode	Solid(Amber)

1. Safety Warnings

- ! Read all the instructions carefully before using the unit and keep them for future reference.
- ! Retain the manual. If you pass the unit onto a third party make sure to include this manual.
- ! Check that the voltage marked on the rating label matches your mains voltage.

**Damage**  
! Please inspect the unit for damage after unpacking.  
! Do not continue to operate the unit if you are in any doubt about it working normally, or if it is damaged in any way - switch off, withdraw the mains plug and consult your dealer.

**Location of Unit**  
! The unit must be placed on a flat stable surface and should not be subjected to vibrations.  
! Do not place the unit on sloping or unstable surfaces as the unit may fall off or tip over.  
! The mains socket must be located near the unit and should be easily accessible.

**Temperature**  
! Avoid extreme degrees of temperature, either hot or cold. Place the unit well away from heat sources such as radiators or gas/ electric fires.  
! Avoid exposure to direct sunlight and other heat sources.

**Naked Flames**  
! Never place any type of candle or naked flame on the top of or near the unit.

**Moisture**  
! To reduce the risk of fire, electric shock or product damage, do not expose this unit to rain, moisture, dripping or splashing. No objects filled with liquids, such as vases, should be placed on the unit.  
! If you spill any liquid into the unit, it can cause serious damage. Switch it off at the mains immediately. Withdraw the mains plug and consult your dealer.

**Batteries**  
! Batteries used in the remote control for this unit are easily swallowed by young children and this is dangerous.  
! Please dispose of batteries correctly by following the guidance in this manual.

**Ventilation**  
! To prevent the risk of electric shock or fire hazard due to overheating, ensure that curtains and other materials do not obstruct the ventilation vents.  
! Do not install or place this unit in a bookcase, built-in cabinet or in another confined space. Ensure the unit is well-ventilated.

**Safety**  
! Always disconnect the unit from the mains supply

before connecting/ disconnecting other devices or moving the unit.  
! Unplug the unit from the mains socket before a lightning storm.

**Interference**  
! Do not place the unit on or near appliances which may cause electromagnetic interference. If you do, it may adversely affect the operating performance of the unit, and cause a distorted picture or sound.

**Supervision**  
! Children should be supervised to ensure that they do not play with the unit and the remote control.  
! Never let anyone especially children push anything into the holes, slots or any other openings in the case - this could result in a fatal electric shock.

The lightning flash with arrowhead symbol, within an equilateral triangle, is intended to alert the user to the presence of uninsulated dangerous voltage within the units enclosure that may be of sufficient magnitude to constitute a risk of electric shock.

The exclamation point within an equilateral triangle is intended to alert the user to the presence of important operating and maintenance (servicing) instructions in the manual accompanying the unit.

**Service**  
! To reduce the risk of electric shock, do not remove screws. The unit does not contain any user-serviceable parts. Please leave all maintenance work to qualified personnel.  
! Do not open any fixed covers as this may expose dangerous voltages.

**Maintenance**  
! Ensure the unit is fully unplugged from the power supply before cleaning.  
! Do not use any type of abrasive pad or abrasive cleaning solutions as these may damage the units surface.  
! Do not use any liquids to clean the unit.

Back Panel of the Soundbar

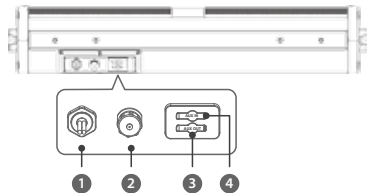

- 1) Power cord (with SAE plug)**  
Connect to the power supply
- 2) For external socket (for Z3,Z4 light band and CAN communication)**  
Connect to external Z3 and z4 light  
Connect to the CAN port on the car for communication

**3) Aux out**  
Audio output, connect to an audio amplifier or another speaker

**4) Aux in**  
Audio input from, for example MP3 player or CD player

4. Remote Control

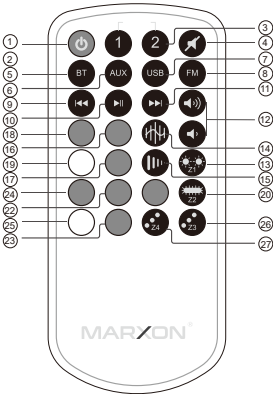

- 1) Power**  
Switch the soundbar on/off
- 2) Preset 1**  
Switch to preset radio station 1 in FM mode
- 3) Preset 2**  
Switch to preset radio station 2 in FM mode
- 4) Mute**  
Switch to the audio mute on/off
- 5) BT**  
Switch to Bluetooth mode  
Long press> 2s to enter pairing mode/disconnect current connection in BT mode  
Long press> 5s to clear all Bluetooth connections in BT mode
- 6) Aux in**  
Switch to Aux in mode
- 7) USB**  
Switch to USB mode

2. Unpacking

Remove all items from the packaging. Retain the packaging. If you dispose of it please do so according to local regulations.  
The following items are included:

Soundbar  
x1

Remote Control  
x1

Remote Control Case  
x1

Aluminum bracket  
x2

Power Cable (2.5m)  
x1

Power Cable (0.14 m)  
x1

Screw(30mm)  
x4

Aluminum base  
x2

Screw(50mm)  
x2

Nut  
x2

Washer  
x2

Hex Wrench  
x1

Rubber Washer  
x2

Screw(90mm)  
x2

Screw(16mm)  
x2

Screw(40mm)  
x2

Clamp 40-63mm  
x2

Clamp 52-76mm  
x2

Hoop tape  
x2

- 8) FM**  
Switch to FM mode
- 9) Previous**  
Press to skip to the previous track in USB/BT mode  
Press to tune down the frequency in FM mode  
Long press>=2s to scan down radio in FM mode
- 10) Play/Pause**  
Press to start, pause or resume play in USB/BT mode  
Press once to answer the call and again to hang up when there is a call in BT mode  
Long press>=3s to activate your phone's voice assistant in BT mode
- 11) Next**  
Press to skip to the next track in USB/BT mode  
Press to tune up the frequency in FM mode  
Long press>=2s to scan up radio in FM mode
- 12) Volume up/down**  
Increase or decrease the volume  
Press and hold to decrease or increase the volume continuously
- 13) Z1 light**  
Switch the Z1 light on/off
- 14) Bouncing light**  
Switch the Z1 light to bouncing light
- 15) Gradient light**  
Switch the Z1 light to gradient light
- 16) Green light**  
Switch the Z1 light to green light

- 17) Blue light**  
Switch the Z1 light to blue light
- 18) Red light**  
Switch the Z1 light to red light
- 19) White light**  
Switch the Z1 light to white light
- 20) Z2 light**  
Switch the Z2 light on/off
- 21) Blue light**  
Switch the Z2 light to blue light
- 22) Yellow light**  
Switch the Z2 light to yellow light
- 23) Purple light**  
Switch the Z2 light to purple light
- 24) Red light**  
Switch the Z2 light to red light
- 25) White light**  
Switch the Z2 light to white light
- 26) Z3 light(The light effect is synchronized with the Z1 light)**  
Switch the Z3 light on/off
- 27) Z4 light (The light effect is synchronized with the Z1 light)**  
Switch the Z4 light on/off

Remove the Plastic Strip from the Remote Control

Remove the plastic strip from the battery if the battery is being used for the first time. It is located at the bottom rear of the remote control.

Battery Replacement for the Remote Control

The remote control requires a CR2025, 3V Lithium battery.

- Slide and hold the battery release tab in the direction of the arrow.
- Pull out the battery holder and remove the old battery.
- Replace with a new battery.
- Insert the battery holder back into the remote control.

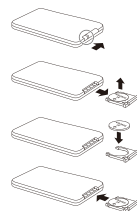

Handling the Battery

- ! Improper or incorrect use of batteries may cause corrosion or battery leakage, which could cause fire, personal injury or damage to property.
- ! Install the battery correctly in the battery compartment. Normally the batterys positive polarity (+) will face up.
- ! Use only the battery type indicated in this manual.
- ! Do not dispose of the used battery as domestic waste. Dispose of it in accordance with local regulations.
- ! Small button cell batteries such as the one used in the remote control are easily swallowed by young children and this is dangerous. Keep loose button cells away from young children and make sure that the battery is secure in the remote control. Seek medical advice if you believe a battery cell has been swallowed.

Handling the Remote Control

- ! Take care of your fingernails when you slide and pull the battery release tab.
- ! Do not drop the remote control.
- ! Do not allow anything to impact the remote control.
- ! Do not spill water or liquid on the remote control.
- ! Do not place the remote control on a wet object.
- ! Do not place the remote control under direct sunlight or near sources of excessive heat.
- ! Remove the battery from the remote control when not in use for a long period of time, as corrosion or battery leakage may occur and result in physical injury, and/or property damage, and/or fire.
- ! When the battery is exhausted, the remote control will not function.

Remote Control Operation Range

- ! The remote control sensor on the front unit is sensitive to the remote controls commands up to a maximum of 5 metres away and within a maximum of a 60° arc.
- ! Please note that the operating distance may vary depending on the brightness of the room.

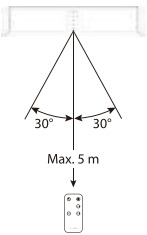

5. Connections

Using the AUX IN Connection

Use a 3.5mm to 3.5mm audio cable (no include) to connect the phone/MP3/car headphone socket to the AUX IN socket on the unit.

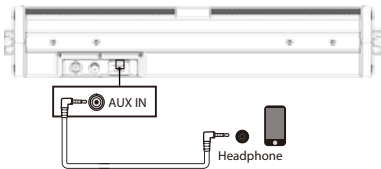

Note:

This unit can play MP3, WMA, APE, FLAC, WAV, AAC.

Multiple link function



If you have two or more soundbars, you can use the multiple link function to have one or more soundbars play music at the same time.

Two soundbars connection

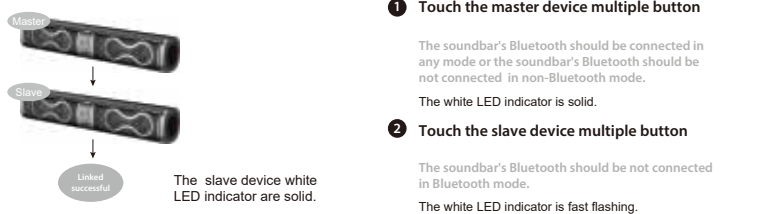

Multi-soundbar connection

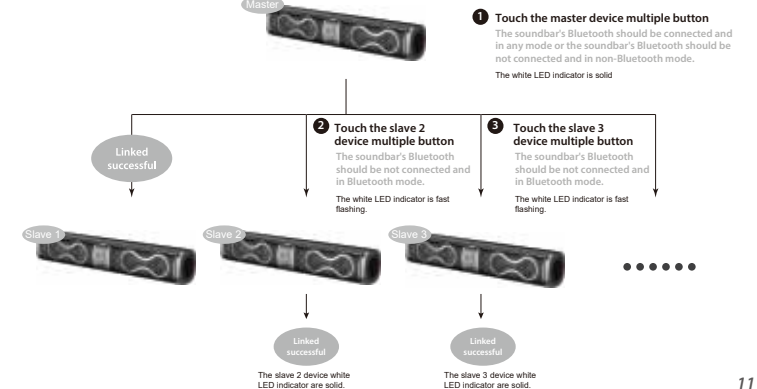

Using the AUX OUT Connection

Use a 3.5mm to 3.5mm audio cable (no include) to connect the amplifier/another speaker headphone socket to the AUX OUT socket on the unit.

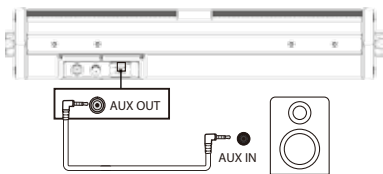

Using the External Cable Connection

Using an external cable (no include) to connect external Z3, Z4 light and CAN socket to the external socket on the unit.

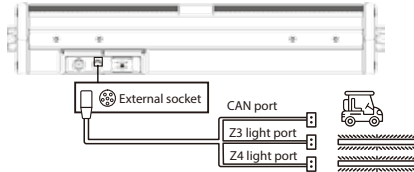

Connecting Electrical Power

The soundbar has no built-in battery and must be connected to an external 12V DC power supply to work properly. Before connecting the soundbar to the battery or regulator of a car such as a golf cart, boat, UTV ATV, make sure the car battery or battery pack terminal voltage is 12V DC. If the battery terminal voltage is not 12V, use it with a DC-DC converter whose output is 12V. Otherwise, the speaker may fail or be damaged.

Note:

Even with the power off, the soundbar still draws a small amount of power from the battery you plug in. If the soundbar or your car, boat, etc. has not been used for more than 48 hours, to prevent the battery from running out, we recommend cutting the connection between the soundbar and the battery or adding a toggle switch.

7.Installation

Installation method 1: Top mounting

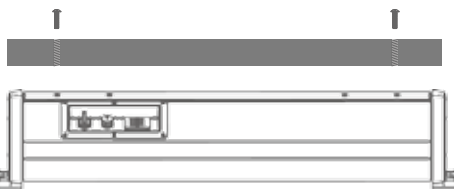

1. There are four mounting holes on the top of the soundbar, two of which you can choose to fasten.
2. Make sure the soundbar is installed in the desired location and mark it.
3. Drill the mounting holes in the marked locations.
4. Use the nuts and bolts in the kit to securely attach your soundbar to your car.

Installation method 2: Bottom bracket mounting

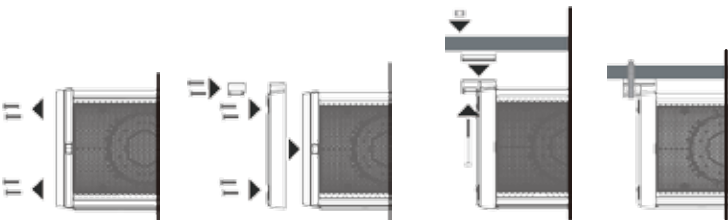

1. Remove the eight screws at both ends of the soundbar, take out the aluminum bracket of the accessory bag, and install it on the end caps at both ends of the soundbar, then take out the aluminum base, rubber pad and screws of the accessory bag, and firmly fix it to the aluminum bracket.
2. Make sure the soundbar is installed in the desired location and mark it.
3. Drill the mounting holes in the marked locations.
4. Use the nuts and bolts in the kit to secure your soudbar to your car.

Note:

To avoid scratching your car, you can use the clamp and rubber strip in the accessory box to assist installation, install the rubber strip and clamp first and then install and fix the soundbar.

Please connect 2.5m power cord to SAE interface (red).



Note:

If the SAE connector is wet, do not connect it to the power supply to avoid electric shock and accidental injury.

Remove the 15A fuse from the fuse holder.

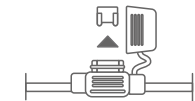

Note:

If the fuse holder is wet, do not remove the fuse to avoid electric shock and accidental injury. Close properly and make sure the lid snaps in place.

Installed: Fuel Vehicle

1. Loosen the bolt on the battery terminal.

Note:

If the battery is damp, do not attempt to loosen the bolt to avoid electric shock and injury.

2. Connect the black cable of the power cable to the black negative terminal and the red cable of the power cable to the red positive terminal. If the connection is not correct, the soundbar may not work properly or be damaged.
3. Tighten the bolt on the battery terminal until it is secured in place.
4. Place the 15A fuse back into the fuse holder and close tightly.

Installed: Electocar

1. Switch the car to TOW mode.
2. Unscrew the bolt on the battery terminal.
3. Connect the black cable of the power cable to the ground cable of the DC-DC converter, and the red cable of the power cable to the positive pole (+) of the DC-DC converter. If the connection is not correct, the soundbar may not work properly or be damaged.
4. Tighten the bolt on the battery terminal until it is secured in place.
5. Place the 15A fuse back into the fuse holder and close tightly.

Note:

The excess cable can be tied and secured with cable ties so that they do not hang loosely.

8.Hit and Tips

If a problem occurs, it may often be due to something very minor. The following table contains various tips:

1) No power

Ensure the power is connected securely at both ends. Make sure that the power on mode is selected.

2)The remote control is not function

Point the remote control at the remote sensor on the unit. Replace the battery in the remote control with a new one. Remove any obstacles between the remote control and the unit.

3) Bluetooth not found

If you do not pair Bluetooth for a long time or switch to another mode, the system will automatically exit the pairing mode. You can refer to the previous Bluetooth connection operation to connect the Bluetooth.

4) LED lights are for display and off-road use only

Check your local regulations before using LED lights. Do not drive on public roads with LED lights on. LED lights do not meet DOT standards.

Note:

If you encounter any abnormal functions, disconnect the power supply of the device and reconnect it again.

9.Specifications

Model	MS2608
Power Consumption	100W
Speaker Output Power	2× (40+10Wrms)@1%THD
Power	Operating voltage: 12VDC, 15A (Need to connect external DC battery power supply)
Bluetooth Version	V5.3
Radio Frequency Range	US: FM 87.5 – 107.9 mHz
Operating temperature	-10 C - 55 C
Water/dust Resistant Rating	IP66
Net Weight	5.2kg
Dimension(with barcket)	70.2cmx14.36cmx13.2cm(LxHxD)

Features and specifications are subject to change without prior notice.

6. General Operation

Power on/off

Long touch>=2s the power button on the soundbar to power on/off, or short press the power button on the remote control to power on/off.

Note:

After starting up, if there is no action within 30mins, the unit will enter standby mode, if there is no action one hour, the unit will shut down.

Bluetooth Connection

1. Turn on the soundbar, and touch the source button on the soundbar or press the BT button on the reomte control to switch to BT mode, you will hear "Bluetooth mode".
2. Long touch>=2s the source button on the soundbar or long press>=2s the BT button on the remote control to enter pairing mode, the Bluetooth indicator will be fast flash, you will hear "pairing mode".
3. Turn on your Bluetooth device, locate MS2608 and start connecting. If the connection is successful, the Bluetooth indicator will be steady blue and you will hear saying "paired".

Notes:

1. If pairing is not completed within 10 minutes, the soundbar will exit pairing mode. Long touch>=2s the source button on the soundbar or short press the BT button on the remote control to enter the pairing state again.
2. Once the connection is successful, if you turn off the soundbar and turn it back on and into Bluetooth mode, you will hear "Bluetooth mode", the speaker will automatically reconnect to the last connected device.
3. Long press>=5s the source button on the soundbar or long press>=5s the BT button on the remote control to clear all Bluetooth connections.

FM Mode

1. Short touch the source button on the soundbar or short press the FM button on the remote control to switch to FM mode, and the LED indicator (source button backlight) will light solid amber.
2. Short touch the previous/next button on the soundbar or short press the previous/next button on the remote control to tune down/up the frequency, long touch>=2s the previous/next button on the soundbar or long press>=2s the previous/next button on the remote control to scan down/up radio.
3. Long touch>=2s the Z3/Z4 light button on the soundbar to set the currently playing radio station to the preset 1/2.
4. Short touch the play/pause button on the soundbar or short press the preset 1/2 button on the remote control to switch to preset station 1/2.

USB play

- Enjoy audio on a USB storage device, such as an MP3 player and USB flash memory, etc.
1. Insert the USB device.
  2. Short touch the source button on the soundbar or short press the USB button on the remote control to switch to USB mode, and the LED indicator (source button backlight) will light solid white.
  3. Press the previous next button on the soundbar/remote to change to the previous/next track, press the play/pause button on the soundbar/remote to play pause.

Notes for battery disposal

The batteries used with this product contain chemicals that are harmful to the environment. To preserve our environment, dispose of used batteries according to your local laws or regulations. Do not dispose of batteries with normal household waste. For more information, please contact the local authority or your retailer where you purchased the product.



The above mark is in compliance with the Waste Electrical and Electronic Equipment Directive 2002/96/EC (WEEE). The mark indicates the requirement NOT to dispose the equipment including any spent or discarded batteries as unsorted municipal waste, but use the return and collection systems available. If the batteries or accumulators included with this equipment display the chemical symbol Hg, Cd or Pb, then it means that the battery has a heavy metal content of more than 0.0005% Mercury, or more than 0.002% Cadmium or more than, 0.004% Lead.

In the unlikely event of a problem developing, please contact the store where you purchased your equipment. We continually strive to improve our products; specifications may change without prior notice. For advice on where to purchase accessories, please contact the store where you purchased your equipment.

All trademarks are the property of their respective owners and all rights are acknowledged.

FCC statement:

This equipment has been tested and found to comply with the limits for a Class B digital device, pursuant to Part 15 of the FCC Rules. These limits are designed to provide reasonable protection against harmful interference in a residential installation. This equipment generates uses and can radiate radio frequency energy and, if not installed and used in accordance with the instructions, may cause harmful interference to radio communications. However, there is no guarantee that interference will not occur in a particular installation. If this equipment does cause harmful interference to radio or television reception, which can be determined by turning the equipment off and on, the user is encouraged to try to correct the interference by one or more of the following measures:

- Reorient or relocate the receiving antenna.
- Increase the separation between the equipment and receiver.
- Connect the equipment into an outlet on a circuit different from that to which the receiver is connected.
- Consult the dealer or an experienced radio/TV technician for help.

Changes or modifications not expressly approved by the party responsible for compliance could void the user's authority to operate the equipment.

This device complies with part 15 of the FCC Rules. Operation is subject to the following two conditions: (1) This device may not cause harmful interference, and (2) this device must accept any interference received, including interference that may cause undesired operation.

This device can be used without restriction.