

wait for the APP to
search for the device.

6. Please configure the

Please configure the
name and password

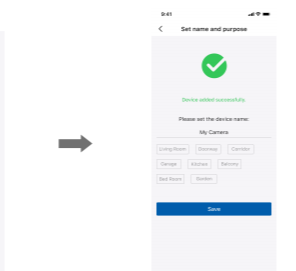

8. The c



s added
se give the
me.

- Add device: Wi-Fi Add

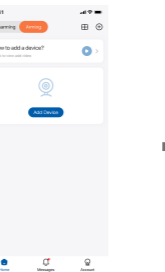

Click "Add Device"

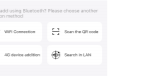

Choose "Wi-Fi Add" 3. F

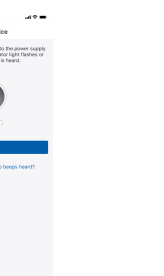

the instructions on
and click Next

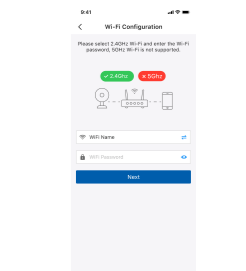

4 Please

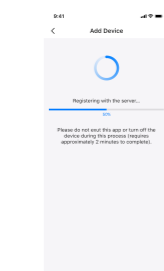

5. Conclusion

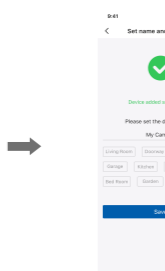

6 TH

led
ve the

installation



ectly connected to the lamp head

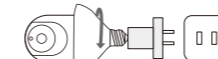

Connect the camera to the holder and the socket

- the provided screws to ensure safe use of the camera and bracket.

- To avoid the risk of fire or electric shock, keep the camera in a cool, dry place.
- Please place the camera out of the reach of children. Children should use this product under adult supervision.
- The power adapter cable and network cable of this product have potential strangulation hazards. For child safety, please keep these wires out of reach of children.

7.Frequently Asked Quest

1.What is the minimum bandwidth required to view real-time video?

(1) In order to ensure the smoothness of viewing real-time video, it is recommended that the upload bandwidth is less than 512kbps.

(2)The real-time video traffic is about 2MB/minute, After turning on the sound, it will increase by about 0,4MB per minute.

2. Why can't I store and read videos normally even after inserting a Micro SD(TF) card?

Kingston 8G/16G/

SanDisk	16G/32G
---------	---------

PNY	16G/32G
-----	---------