



Made in China

VIVOSUN

# AeroLush C08

## User Manual



VIVOSUN

---

## Contents

Safety Information	1
Key Features	3
Product Contents	4
Dimensions	5
Installation	5
Control Panel	16
Operation	18
Wi-Fi Configuration	19
Maintenance	20
Trouble Shooting	21
Complete Your Setup	22
Warranty	25

## Safety Information

Please read these instructions carefully before using the device. Failure to follow these safety guidelines may result in injury, void the product warranty, and release Vivosun from all liability.

1. Do not operate the device with wet hands, submerge it in water, or place it near water or oil.
2. Do not pierce or burn the device.
3. Keep all ventilation openings clear of obstructions.
4. Do not use this product outdoors, in direct sunlight, or expose it to weather or the elements.
5. Follow local grid interconnection rules when installing the air conditioner and ensure proper grounding. If you have any questions about electrical installation, follow the manufacturer's instructions or consult a professional electrician.
6. Never insert fingers or objects into the air outlet. Warn children about these dangers.
7. If the device emits a burning smell or shows signs of malfunction, immediately cut off the power supply and stop using it.
8. Do not disassemble, modify, repair, or clean internal components without authorization.
9. Keep hands away from the air outlet and internal components.
10. Do not place heavy objects on the air outlet or sit directly on it.
11. Do not replace the power cord without authorization, splice it, or use it in parallel with other high-power electrical devices.
12. Do not cover the product or power cords with rugs or other fabric materials.
13. Place the device on a flat, dry surface, maintaining at least 50 cm of clearance from surrounding objects or walls.
14. Do not place the product on a soft, elevated, or unstable surface where it may fall or have its air intakes or exhaust blocked.
15. Do not clean the air conditioner with chemical solvents such as gasoline or alcohol. Before cleaning, disconnect the power supply and use a slightly damp soft cloth. For heavy dirt, use a mild detergent.

## Safety Information

16. This device may be used by children aged 8 and above, as well as individuals with reduced physical, sensory, or mental capabilities, or those lacking experience and knowledge, provided they have received proper supervision or instruction on its safe use and understand the associated hazards. Children must not play with the device.



**Risk of fire or explosion—this device contains a flammable refrigerant. Follow all additional safety precautions to prevent hazards.**

1. Do not use any methods to accelerate the defrosting process or for cleaning other than those recommended by the manufacturer.
2. The device must be stored in a room without continuously operating ignition sources, such as open flames, gas appliances, or electric heaters.
3. Do not pierce or burn refrigerant tubing. Be aware that refrigerants may be odorless. Keep ventilation openings clear of obstruction.
4. Do not drill holes in the unit.
5. Maintenance, cleaning, and servicing should only be performed by technicians who are properly trained and qualified in handling flammable refrigerants.
6. Dispose of the air conditioner in accordance with federal and local regulations. Flammable refrigerants require special disposal procedures.

# Key Features

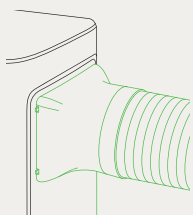

## Designed for Growing

Effortless installation—quickly connect the air conditioner to your grow space.



## 4-in-1 Mode

4-in-1 Mode: Cool, Heat, Dry, Fan. Create the ideal environment for your grow space.



## Precise Sensor

External temperature and humidity probes can be connected for precise, targeted environmental readings.

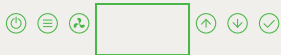

## Convenient Operation

Connect to the Vivosun app for remote control of the device, in addition to using the local operation panel.

# Product Contents



Evaporator Air Inlet Hood

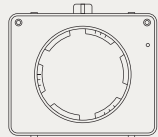

Evaporator Air Outlet Hood

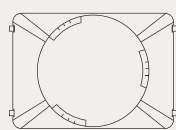

Temperature and Humidity Probe

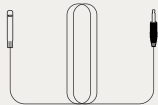

Exhaust Duct 2m(with adapter)  
x2

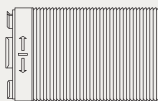

Exhaust Duct 2m

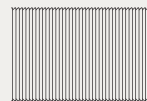

Filter

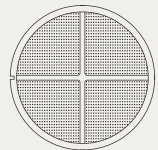

Condenser Outlet Adapter

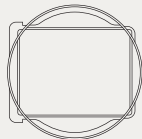

Window Duct Adapter

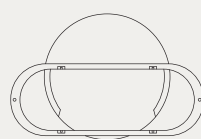

Window Sealing Plate Assembly (Long)



Window Sealing Plate Assembly (Short)

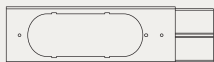

Drain Pipe



# Dimensions

Size	13.1*12.9*27.2 inch
Net Weight	44 lbs
Cooling Capacity	8000 BTU
Dehumidifying Capacity	45 pints/day
Power Supply	120 V/ 60 Hz
Rated Input	840 W
EER/CEER	6.5
Refrigerant	R32

# Installation

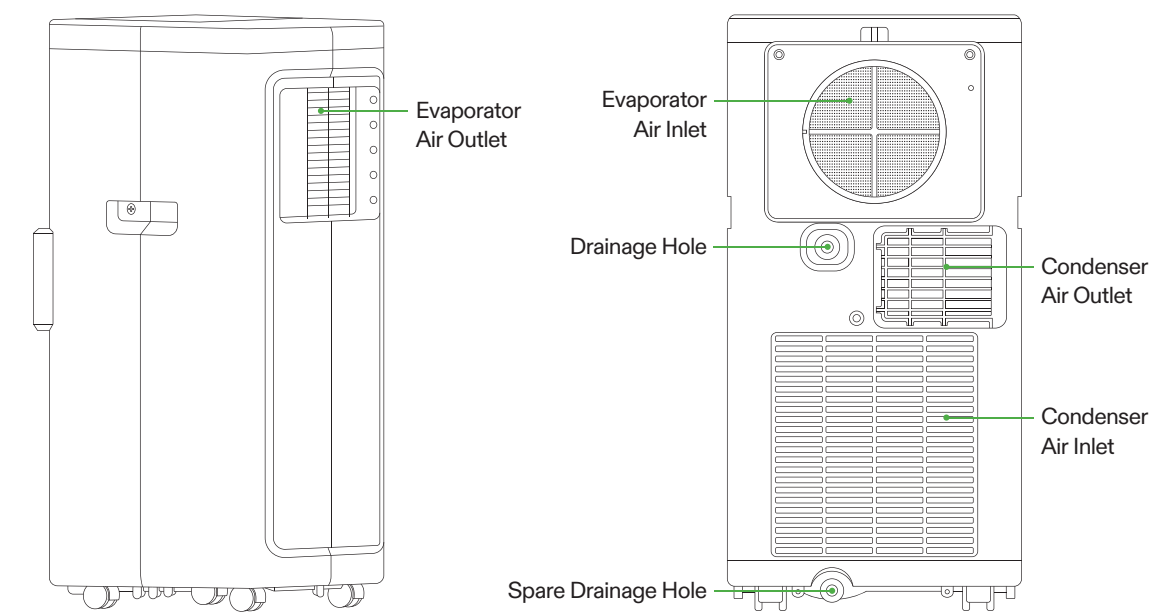

# Installation

## Installation of Accessories

**STEP 1.1** Insert the evaporator air outlet hood into the air conditioner's evaporator air outlet, ensuring the correct top and bottom orientation of the hood.

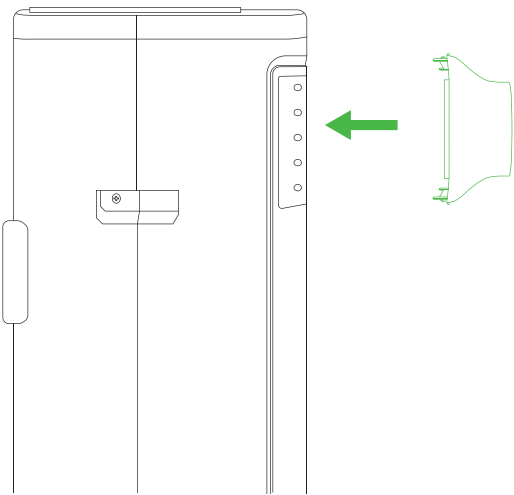

**STEP 1.2** Insert the condenser connector horizontally into the condenser air outlet.

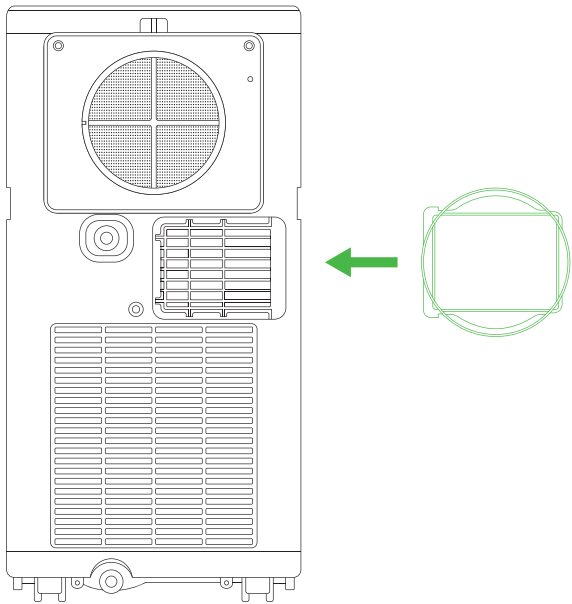

## Installation

**STEP 2.1** Take one piece of exhaust duct (2m with adapter) and connect it to the evaporator air outlet hood, then tighten it counterclockwise.

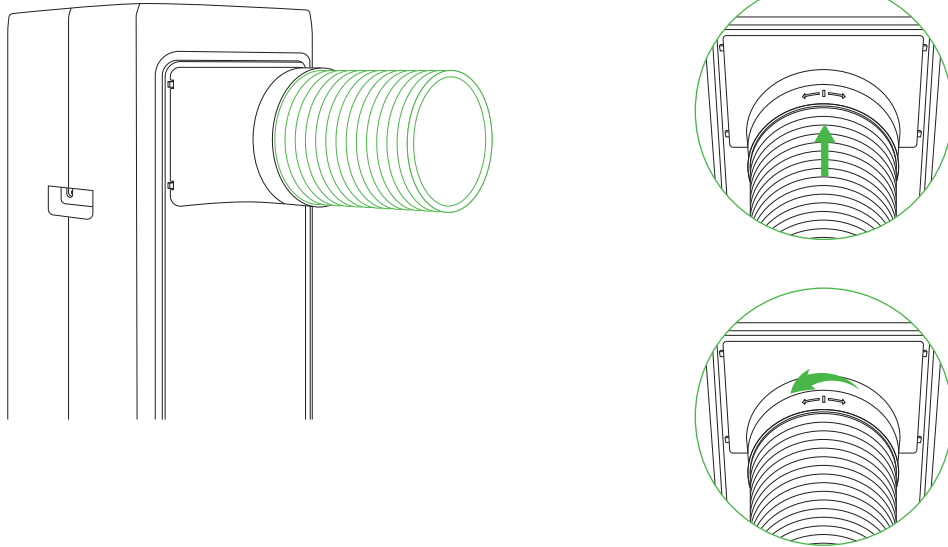

**STEP 2.2** Take the other piece of exhaust duct (2m with adapter) and connect it to the evaporator air inlet hood, then tighten it counterclockwise.

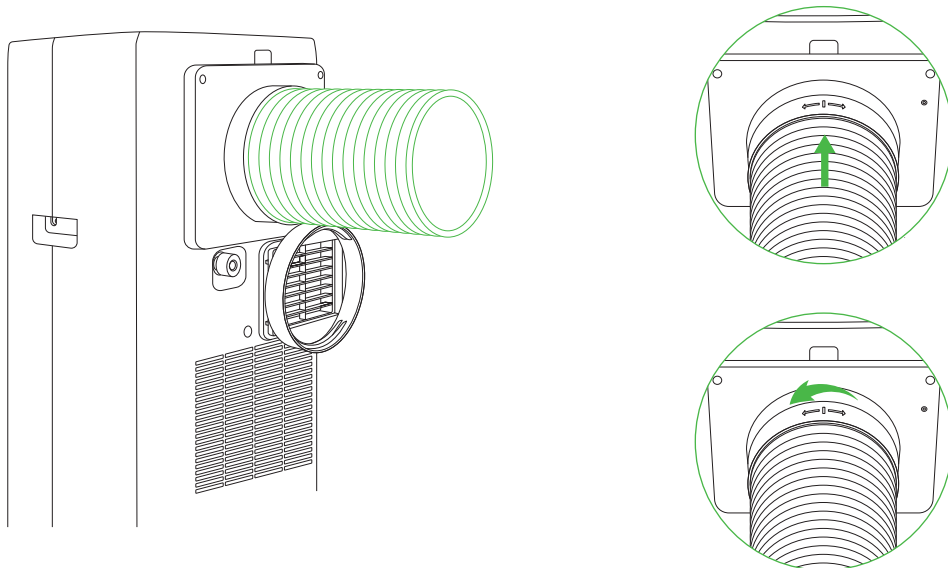

## Installation

**STEP 2.3** Take one exhaust duct, pull out a portion from the duct's end, and then screw it clockwise into the condenser outlet adapter.

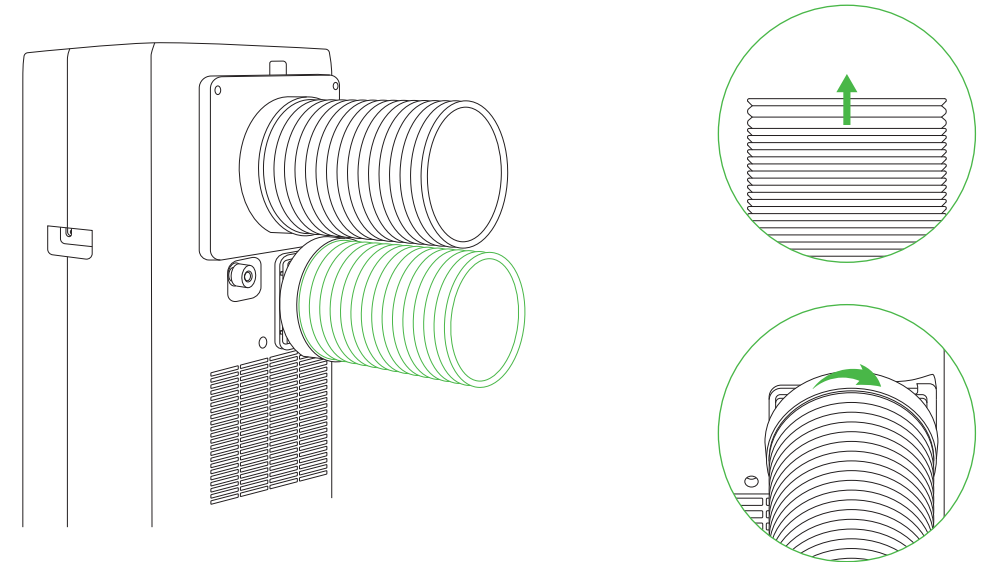

**STEP 3** Ensure that the adapter, hoods, and ducts are securely installed and properly fitted in place.

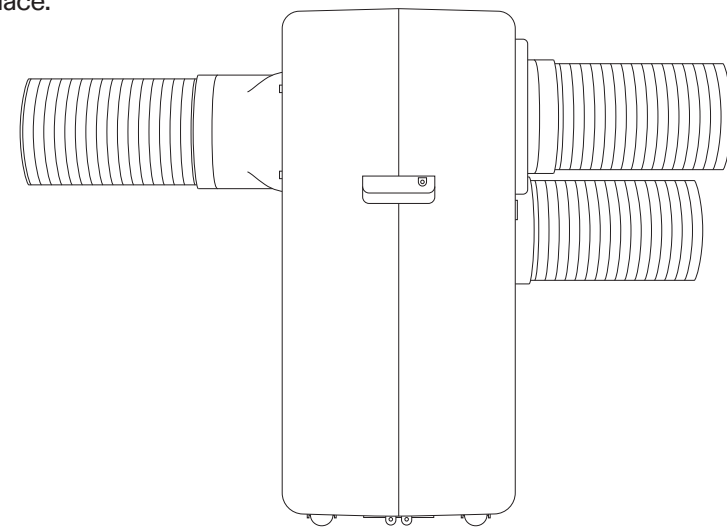

# Installation

## Installation of Probe

**STEP 1** Insert the temperature and humidity probe into the 2.5mm jack on the right side of the evaporator air inlet hood, ensuring it is securely in place.  
Note: If the probe is not connected, the screen will display “-”.

**STEP 2** Place the probe in the target area and secure it.  
Note: It is recommended to position the sensor at a height of 2 to 4 inches above the canopy.

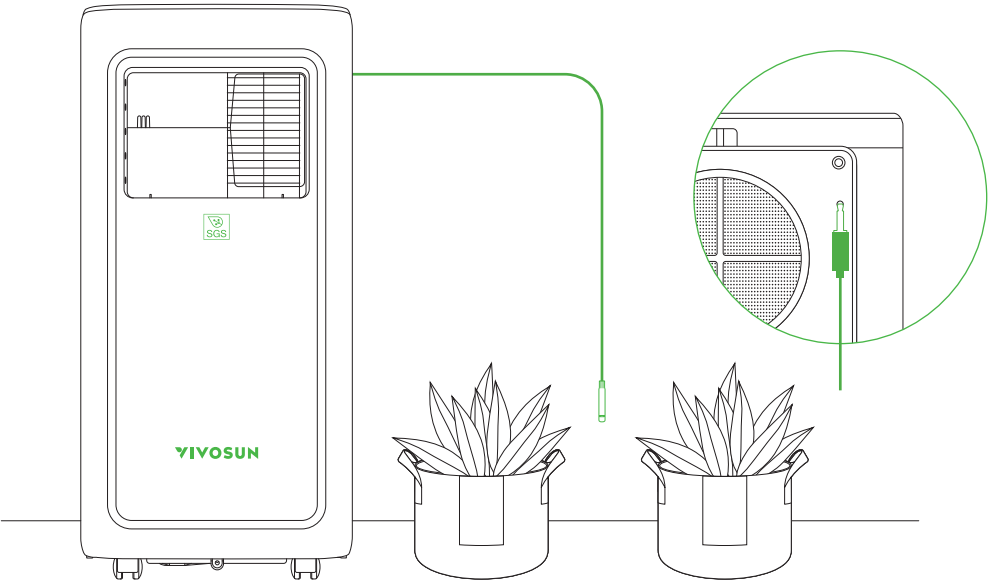

# Installation

## Configuration of Duct Configuration

A. Cool Mode & Dry Mode

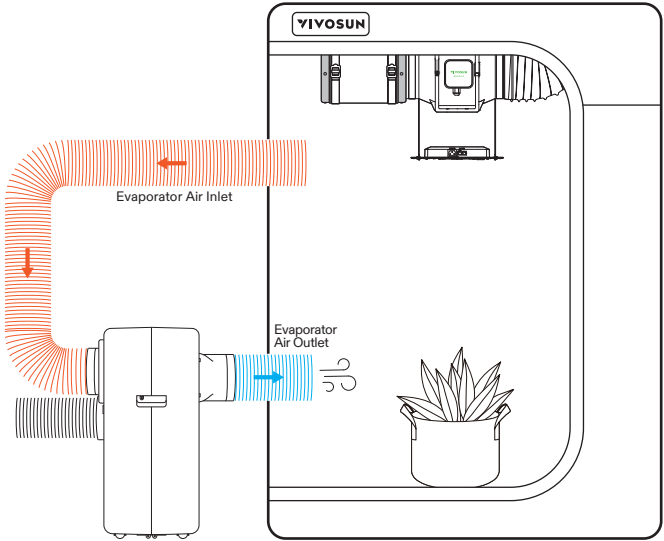

B. Heat Mode

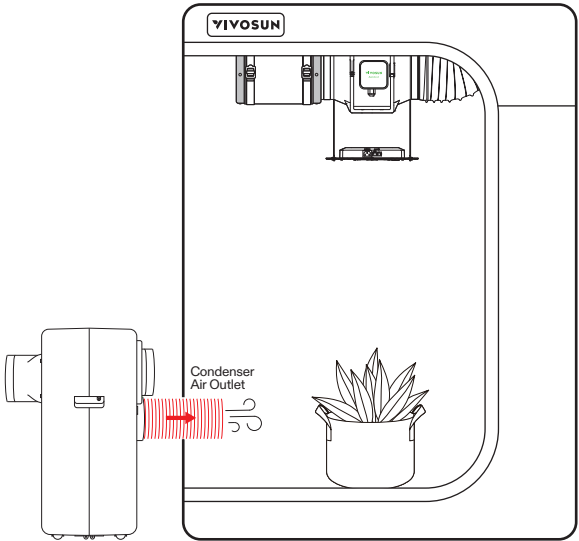

**Note:** When using heat mode, it is essential to switch the duct connection.

## Installation

### C. Fan Mode

In Fan Mode, there are no specific connection requirements. You may refer to other modes or install the duct as needed based on your setup.

#### Note:

1. Ensure the exhaust duct does not have bends greater than 45°, as this can affect the air conditioner's performance.
2. The exhaust duct inside the tent should be positioned upwards, avoiding direct airflow onto the leaves.

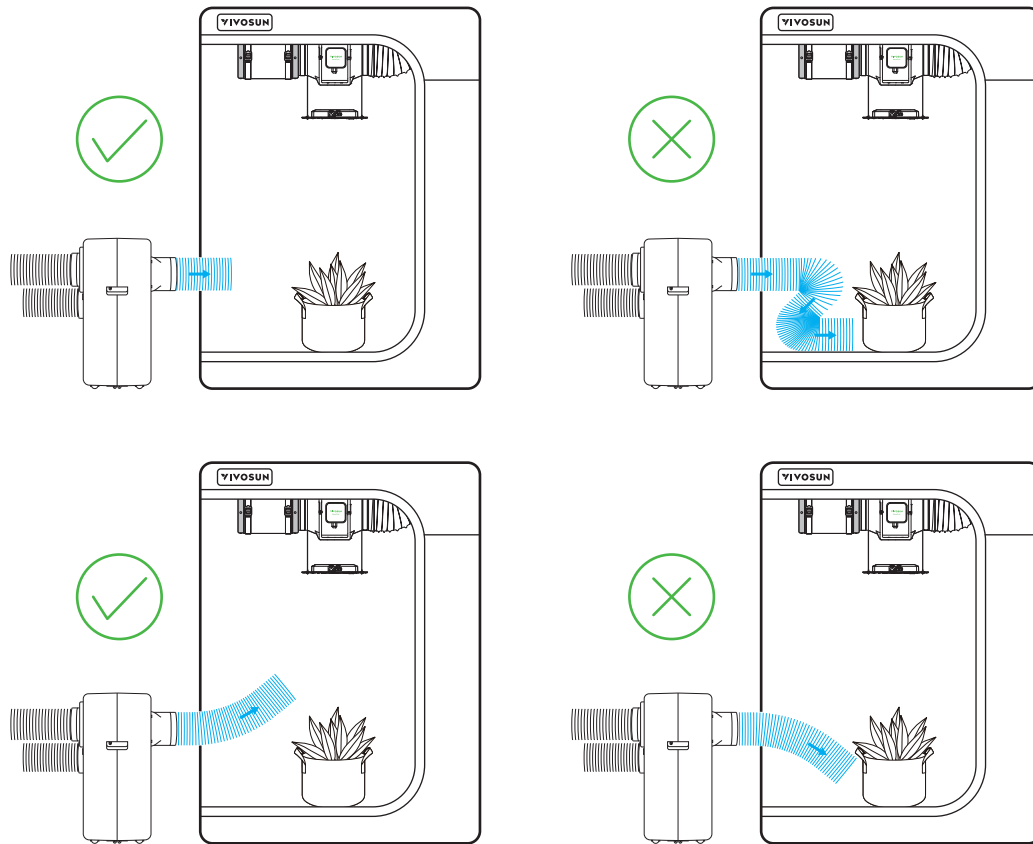

## Installation

3. Temperature and humidity layering may occur inside the tent. If the plants are growing tall, consider adjusting the positions of the air outlet and intake pipes to optimize conditions for the canopy.

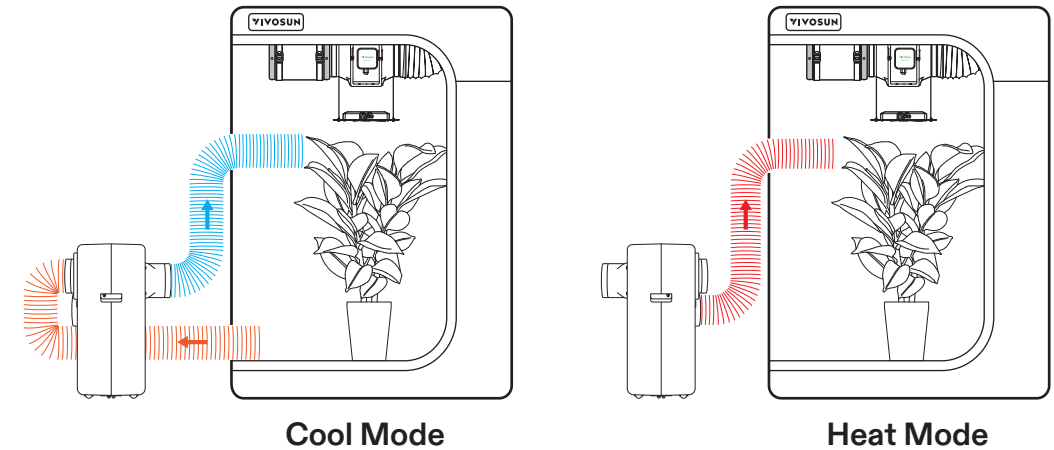

4. If indoor humidity is too high, condensation may form on the evaporator exhaust duct, causing water droplets. Wrapping the exhaust pipe with insulation material can help reduce condensation.

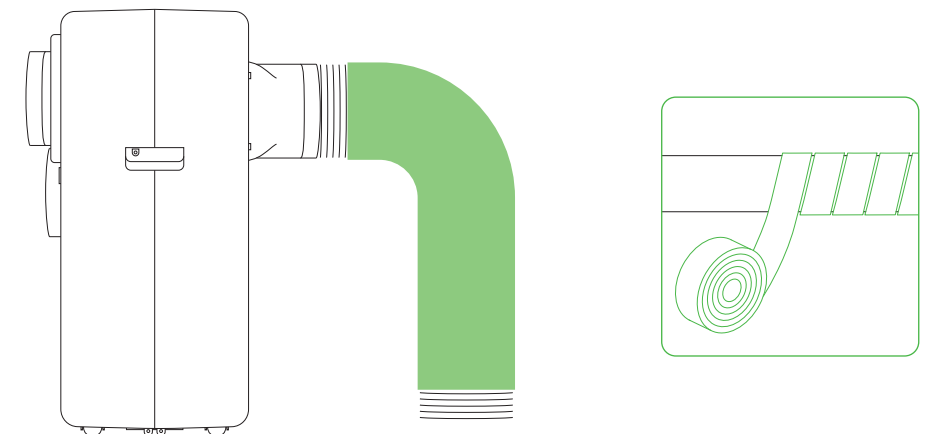



# Installation

## Installation of Drainage Pipe

**Step 1** Unscrew the nut on the drainage hole counterclockwise, then remove the soft plug inside.

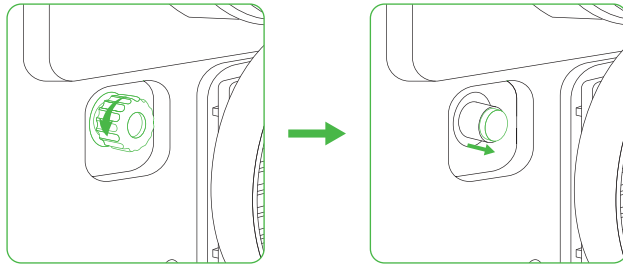

**Step 2** Remove the drainage connector from the water pipe and insert it into the nut, then screw the nut back onto the drainage hole clockwise.

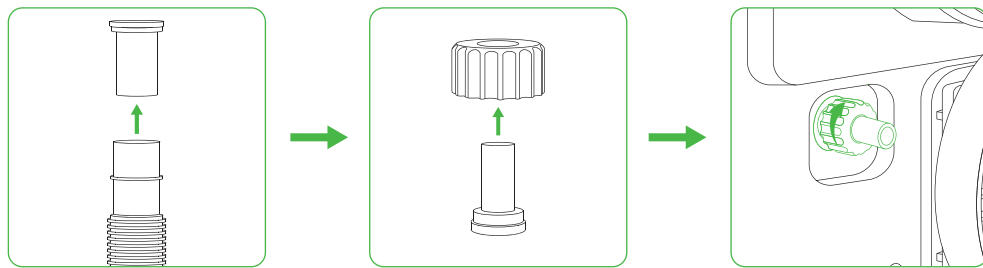

**Step 3** Attach the drainage pipe to the drainage connector and place the other end in the sewer or drainage tray.

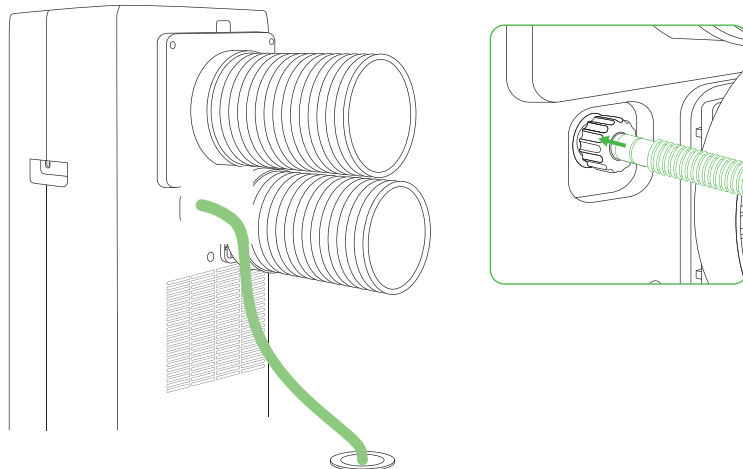

# Installation

## Note:

1. The drainage pipe must be connected in Dry Mode; for other modes, it is optional.
2. If the screen displays a “water full” icon, unscrew the spare drainage hole to drain the water.

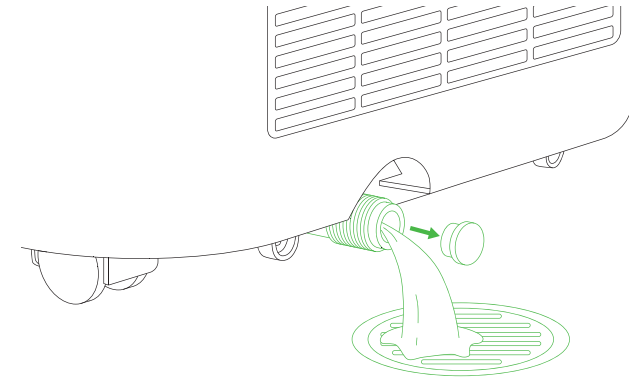

## Installation of Window

**Step 1** Install the Window Duct Adapter clockwise onto the other end of the condenser exhaust pipe.

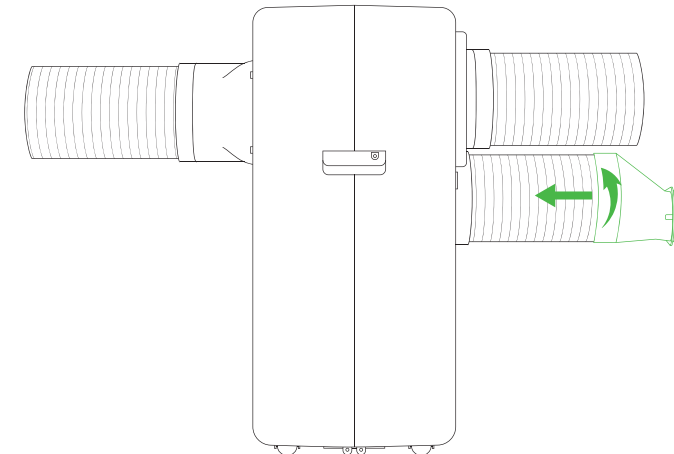

## Installation

**Step 2.1** Partially open the window and mount the window sealing plate assembly onto the window. The components can be placed either horizontally or vertically.

**Step 2.2** Extend the various components of the window sealing plate assembly, adjusting their distance to ensure both ends of the assembly make contact with the window frame. Then, secure all components in place.

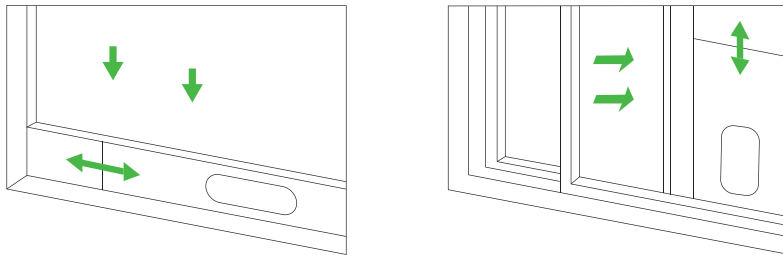

### Note:

1. Select the appropriate window sealing plate (long or short) based on your window size.
2. The flat end of the exhaust pipe joints must be securely snapped into place.
3. The pipe should not be distorted or have substantial bends (greater than 45°). Ensure that the exhaust pipe remains unobstructed for proper ventilation.

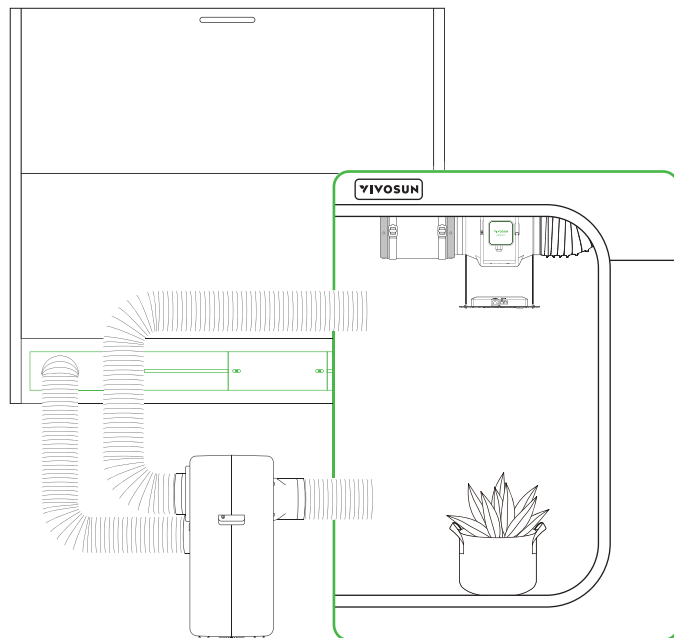

## Control Panel

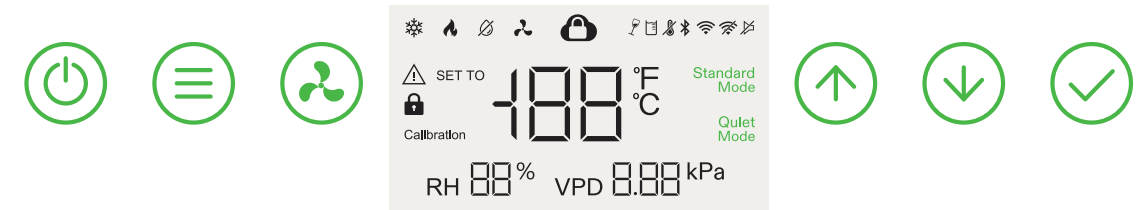

### On/Off Button

Press to turn on.  
Press and hold for 3 s to turn off.



### Mode Button

Press to switch function modes: Cool, Heat, Dry, Fan.  
Press and hold to exit Recipe Mode (Effective only when recipe is running).



### Fan Speed Button

Press to switch fan modes: standard mode and quiet mode.



### Up Button

Press to increase value of current setting.  
Press and hold to switch between °C and °F



### Down Button

Press to decrease value of current setting.



### Confirm Button

Press to confirm current operation.  
Press and hold to enter the settings menu, including calibration, and mute toggle.

## Control Panel

### Other Button Operations:

1. Press and hold the On/Off and Up buttons to lock or unlock the device.
2. Press and hold the On/Off and Confirm buttons to reset the device to factory settings.

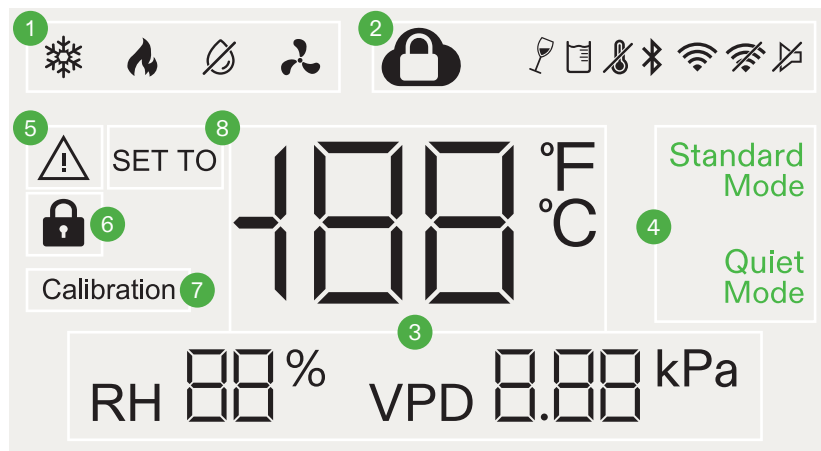

1. **Function Mode**  
Cool, Heat, Dry, Fan.
2. **Status Icon**  
Indicates device status, including cloud lock, tilt, water full, probe detection, connection status, and mute.
3. **Probe Readings**  
Displays current probe readings, including temperature, relative humidity, and VPD.
4. **Fan Speed**  
Standard Mode and Quiet Mode.
5. **Error Icon**  
Displays an error code when the device encounters an issue.
6. **Screen lock Icon**  
Illuminates when screen operation is locked.
7. **Calibration Mode**  
Icon appears when performing temperature and humidity calibration.
8. **Setting Mode**  
Icon appears when adjusting temperature and humidity settings.

## Operation

Press the Mode Button to enter mode selection, then press it again to cycle through available modes. Select Cool Mode and press the Confirm Button to confirm. Use the Up/Down Button to set the target temperature, then press the Confirm Button again to start the device.



### Note:

1. After switching modes, ensure that the duct installation is correct.
2. In Fan Mode, temperature and humidity settings are not required.

## Wi-Fi Configuration

### Step 1 Download the Vivosun app

Search “VIVOSUN” in the Apple App Store or in the Google Play Store to download the Vivosun app.



### Step 2 Add AeroLush

Tap “+” to add AeroLush, then follow the prompts in the app to complete the Wi-Fi configuration.

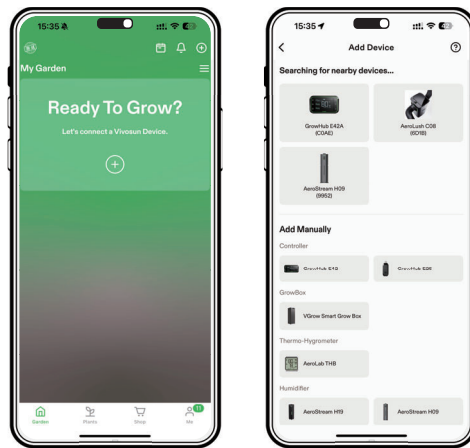

### Step 3 Name Device

After a successful connection, you can rename your device.

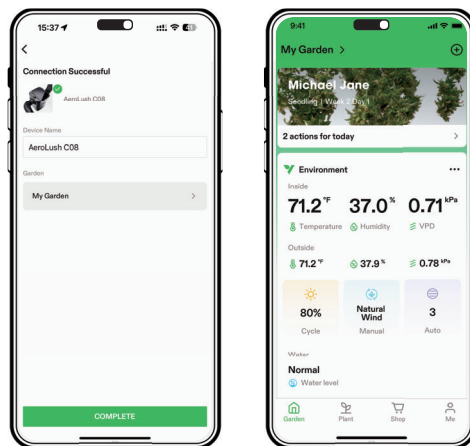

## Maintenance

Before performing maintenance, make sure to turn off the power and unplug the device.

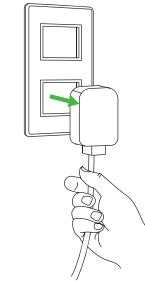

### Surface Clean

Wipe the surface with a soft cloth. Do not use aggressive chemicals or detergents to clean the surface, as they may cause damage.

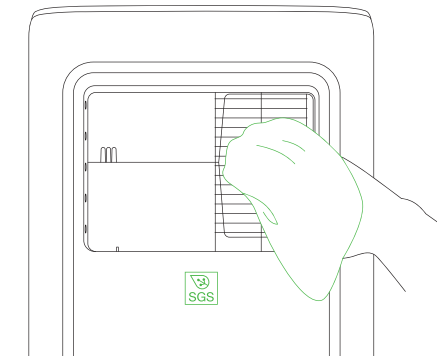

### Filter Clean

Take the filter out of the air conditioner.

Gently soak the filter in a mild detergent, rinse it thoroughly, and allow it to dry.

Dirty filters reduce airflow, so they should be cleaned every two weeks.

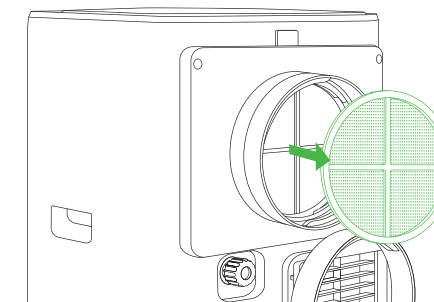

## Troubleshooting

Problems	Reasons	Solutions
The air conditioner does not work.	There is no electricity.	Turn it on after connecting it to a powered socket.
	The ambient temperature is too low or too high.	It is recommended to use the device at a temperature of 7-35°C (44-95°F).
	The environmental target value has been reached.	Adjust the set temperature or humidity.
	The compressor must wait for 3 minutes after stopping before it can restart (system protection).	Wait for 3 minutes and check if it works.
	The water tank is full in dry mode.	Drain the condensed water and connect the drainage pipe.
	Temperature and humidity probe not detected.	Reinsert or replace the temperature and humidity probe.
	The air conditioner tipped over.	Lay the device flat and let sit for at least 24 hours before use.
Cooling capacity is not sufficient.	Product displays error code: DF: Defrosting in progress E01: Power board communication failure E02: NTC sensor short circuit E04: NTC sensor open circuit	Wait for 5 minutes to see if the issue resolves. If not, please contact our customer service for assistance.
	The air inlet and outlet are blocked.	Clear the blockage.
	The exhaust duct is severely bent.	Ensure that the duct bend does not exceed 45°.
	The filter is too dirty.	Clean or replace the filter.
Noise or vibration.	The fan speed is too low.	Switch to standard mode.
	The air conditioner is not placed on a flat surface.	Put the air conditioner on a hard, flat surface.

## Complete Your Setup

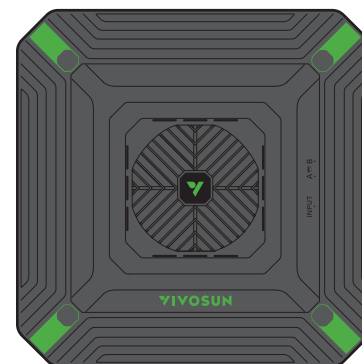

### LED GROW LIGHT

AeroLight/VS/VSX/VSF

- 100W-645W high-powered LED grow light
- High PPE efficacy with Samsung LED
- Full spectrum including FR/UV
- 0-100% dimming with daisy-chain capability
- ETL/CE/FCC certified
- Compatible with GrowHub controller



### CONTROLLER

GrowHub E42/E42A

- Wi-Fi remote control with the Vivosun app
- Complete control of lights, inline fans and circulation fans
- Temp./Humidity monitoring and control
- Compatible with Vivosun devices such as AeroLight, AeroZesh, VS series lights
- Professional controller designed for growers of all levels

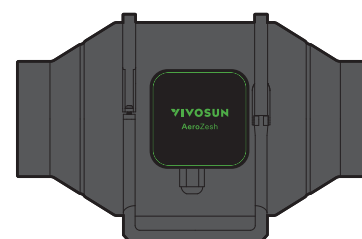

### INLINE DUCT FAN

AeroZesh

- Efficient airflow with high static pressure
- 4" / 6" / 8" for different sized tents
- Energy efficient and quiet EC motor
- Dual ball bearings with long lifespan
- Precise fan speed adjustment by PWM
- Compatible with GrowHub controller for multiple professional operation modes

## Complete Your Setup

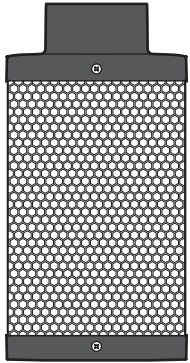

### CARBON FILTER

- Eliminates odors and refreshes air
- Premium-grade Australian charcoal
- High absorption efficiency and long lifespan
- 4" /6" /8" compatible with different inline fans

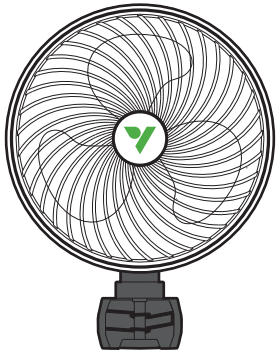

### CLIP-ON CIRCULATION FAN

AeroWave

- Patented clip-on design
- Automatic oscillation
- Adjustable fan speed
- High airflow and energy efficient
- Compatible with GrowHub controller (E Series)

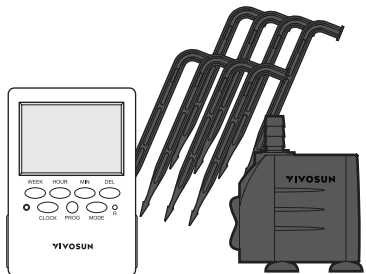

### IRRIGATION SYSTEM

FlexFeed

- Automated drip irrigation system
- Professional irrigation settings
- Precise and stable irrigation
- Quiet and efficient
- Easy to install

## Complete Your Setup

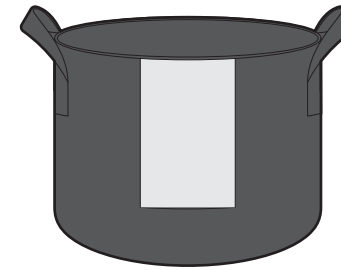

### GROW BAG

- Various sizes ranging from 1–30 gallons
- 300G durable nonwoven fabric
- Root breathable and air pruning

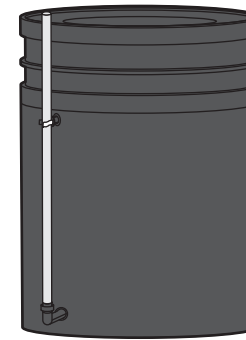

### DWC HYDROPONIC SYSTEM

- DWC + Top Dripping hydroponic system
- Efficient air-driven top dripping technology
- One or four 5-gallon bucket(s)
- Suitable from seedling to harvest
- Easy to install and automated operation

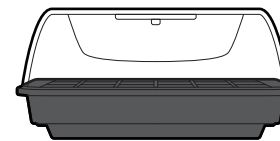

### PROPAGATION TRAY & HEAT MAT

- Propagation tray and heat mat kit
- Transparent dome with humidity adjustment
- Heat mat with precise temperature control
- Easy and safe to use

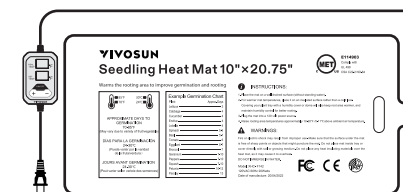

For more information about our products or personalized recommendations for a growing system suited to your needs, feel free to contact us.

# Warranty

Vivosun provides a one-year warranty against defects on the AeroLush Air Conditioner purchased directly from us or through our authorized dealers. This warranty reflects our commitment to addressing any manufacturing defects or premature breakage that may occur during normal use of our products.

Our warranty covers the replacement or refund of purchases that exhibit material defects within one year of the original purchase date. To initiate a claim, customers must contact us and provide proof of purchase to verify eligibility.

This policy does not cover products that have been misused, abused, or intentionally damaged. It also excludes normal wear and tear or cosmetic defects, such as minor scratches.

Customers can feel confident knowing our products undergo rigorous quality testing. This one-year warranty demonstrates our belief in the durability of our products under normal use.



If any product defects are found, customers are encouraged to contact us immediately. Your satisfaction is our priority, and we are committed to resolving any issues in a professional and timely manner.

**FCC Warning:**

This equipment has been tested and found to comply with the limits for a Class B digital device, pursuant to part 15 of the FCC Rules. These limits are designed to provide reasonable protection against harmful interference in a residential installation. This equipment generates, uses and can radiate radio frequency energy and, if not installed and used in accordance with the instructions, may cause harmful interference to radio communications. However, there is no guarantee that interference will not occur in a particular installation. If this equipment does cause harmful interference to radio or television reception, which can be determined by turning the equipment off and on, the user is encouraged to try to correct the interference by one or more of the following measures:

- Reorient or relocate the receiving antenna.
- Increase the separation between the equipment and receiver.
- Connect the equipment into an outlet on a circuit different from that to which the receiver is connected.
- Consult the dealer or an experienced radio/TV technician for help.

**Caution:** Any changes or modifications to this device not explicitly approved by manufacturer could void your authority to operate this equipment.

This device complies with part 15 of the FCC Rules. Operation is subject to the following two conditions:

(1) This device may not cause harmful interference, and (2) this device must accept any interference received, including interference that may cause undesired operation.

This equipment complies with FCC radiation exposure limits set forth for an uncontrolled environment. This equipment should be installed and operated with minimum distance 20cm between the radiator and your body.