

# User Manual

## Smart LED strip

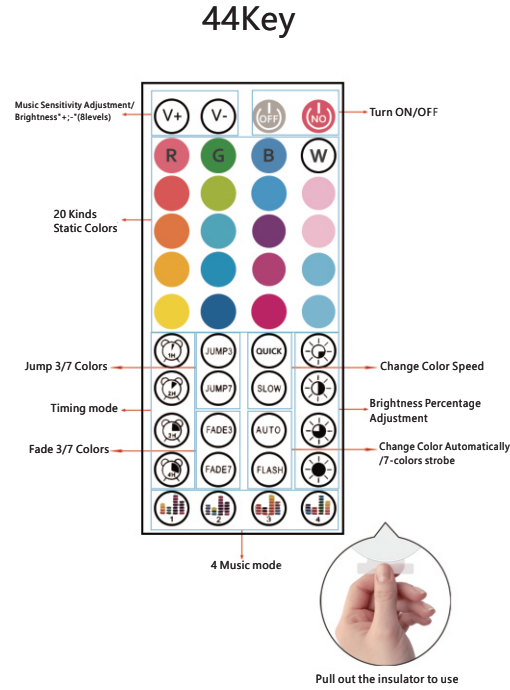

### Operation manual of Magic Lantern APP

**1.1 Overview**  
The Magic Lantern is a mobile app that controls the LED lamp belt through apple or Android mobile phone. The traditional control ways like infrared,433MHz,2.4GHz and others old wired ways will be replaced by mobile phone control way with convenient,powerful and scalable features. Through the mobile app,you can easily and quickly control the color,brightness and color temperature of the LED light belt.You can also set various flashing modes, and make the LED light belt move with the music rhythm.Keep the LED light band powered on, turn on the mobile phone Magic Lotus lamp app intelligent control software,connect one or more LED light band controllers through Bluetooth, so as to realize various settings and control of multiple LED light bands. Operation is very simple,easy to learn and use.

**1.2 Features**  
-Adjust color LED strips with 60,000 colors to change color and brightness and adjust monochrome LED strips to change brightness and color temperature  
-Play mobile music or turn on a sound playback deviceyou can let the light change the color and brightness with the rhythm of music,the music rhythm beautiful  
-Inside multiple setting mode for color change and control LED strips without mobile Long distance control with omni-directional antenna,and many-to-many group control mode  
Quick and easy automatic connection

**1.3 Performance**  
Magic Lantern APP has good ease of use and compatibility.The actual testing and verification of hundreds of mobile phones is compatible with the current market. Most smartphones APPs small and convenientit consumes less system resources, so the requirements of the mobile configuration are low.Control delay is small,the operation feel good,light control is smooth with people's visual sense.

**2.Operating Environment**  
This APP program requires phones of system above Android 4.3 and iOS 8.0 Mobile phone configuration is not limited.

**3. Instructions**  
Note: Android version and iOS version download and use the same method, here in the Android version as an example.

**3.1 APP Download**  
-Scan the QR code  
iOS and Android systems can download the "Magic Lantern" APP by scanning the QR code.Open the browser or other tools with "Scan QRcode"function scan the "Magic Lantern" QR code as below.



After the software is installed and downloaded successfully,click apk to install.After the installation is complete,the following style of program icon will appear on the desktop.



### 3.2 App Operation

(1) Click on the Magic Lantern APP icon,enter the APP page:

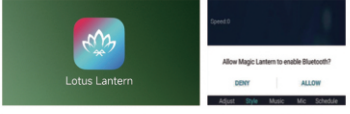

(2)After entering the APP interface, if Bluetooth is not enabled,"Allow Magic Lantern to Bluetooth?" Click[Allow]  
(3) Switch to color and brightness interface:



**Our Mission**  
We are devoted to offer customers better user experiences with smart and connected technology. We trust the power of users, work hand in hand with our users to improve the quality of life.

**Customer Service**  
30-day money-back guarantee for any reason  
For 30 days after the date of purchase, return your undamaged product and receive a full refund for ANY reason.  
12-month warranty for quality-related issues  
For 12 months after the date of purchase,We take care of all quality-related issues with a REPLACEMENT OR FULL REFUND.  
Please contact us in time if you have any questions. And you will receive a response with in 24 hours.  
We will gladly assist you!



**WARNING**  
\*DO NOT IMMERSE IN FIRE  
\*CHILDREN UNDER THE AGE OF 16 SHOULD USE THIS PRODUCT UNDER ADULT SUPERVISION

If you have any questions , please contact our customerservice, we will reply you within 24 hours.



(4) Click to show the lamp list,view lamp list:

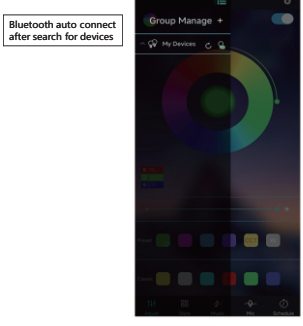

(5) Click to RGB manual adjustment view:



(6)Switch to the mode interface:

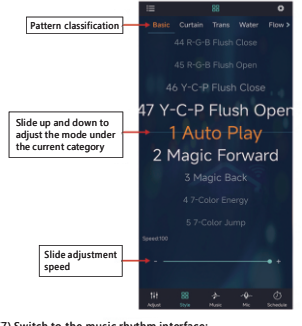

(7) Switch to the music rhythm interface:

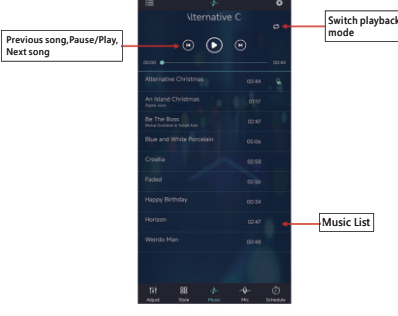

(8) Switch to the microphone rhythm interface:

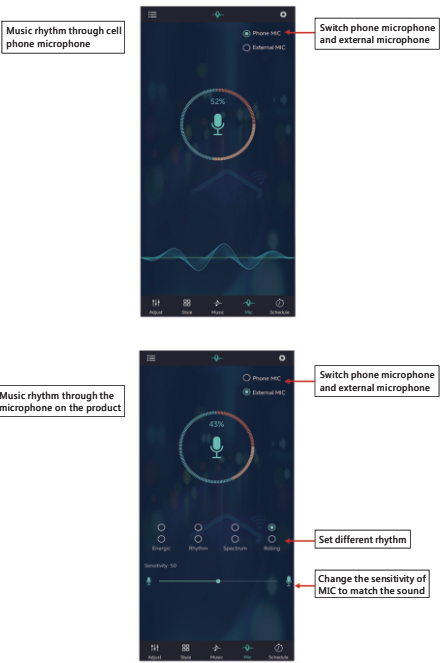

(9) Switch to the timing interface:



(10) Switch to the modify pin sequence interface:

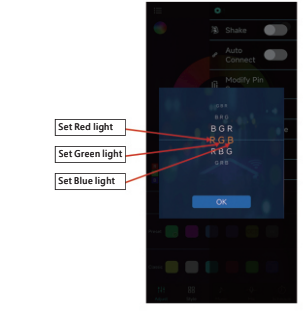

**FCC Warning:**

This equipment has been tested and found to comply with the limits for a Class B digital device, pursuant to part 15 of the FCC Rules. These limits are designed to provide reasonable protection against harmful interference in a residential installation. This equipment generates, uses and can radiate radio frequency energy and, if not installed and used in accordance with the instructions, may cause harmful interference to radio communications. However, there is no guarantee that interference will not occur in a particular installation. If this equipment does cause harmful interference to radio or television reception, which can be determined by turning the equipment off and on, the user is encouraged to try to correct the interference by one or more of the following measures:

- Reorient or relocate the receiving antenna.
- Increase the separation between the equipment and receiver.
- Connect the equipment into an outlet on a circuit different from that to which the receiver is connected.
- Consult the dealer or an experienced radio/TV technician for help.

**Caution:** Any changes or modifications to this device not explicitly approved by manufacturer could void your authority to operate this equipment.

This device complies with part 15 of the FCC Rules. Operation is subject to the following two conditions:

(1) This device may not cause harmful interference, and (2) this device must accept any interference received, including interference that may cause undesired operation.

This equipment complies with FCC radiation exposure limits set forth for an uncontrolled environment. This equipment should be installed and operated with minimum distance 0cm between the radiator and your body.