

E206 user's manual

1. Use environment:

- iPhone: iPhone, iPhone 6S, or later with IOS14.5 or later installed
- iPod: ipad Pro, ipad, ipad Air 2, or later with iPadOS 14.5 or later
- supports the same range as Apple Air Tag

2. Main functions:

- Item Tracking
- Loss alarm
- Remote positioning
- one-click for find item (Bluetooth coverage, open environment effective distance > 25m)
- Lost mode (using the Find my network to find item)
- The announcement is played

3. Tone description:

- Power on: After the battery is installed, it starts by default and plays a "drip" tone and a 2s startup tone
- If the pair is paired successfully, the buzzer plays a "drip" tone
- Unpair: After unpair, the buzzer plays a "drop, drop" tone
- Play the sound Look for the item: After the sound plays, the buzzer beeps "happy" sound
-



Product appearance drawing

4. wireless connection steps:



①: Turn on the iPhone's network, Bluetooth, and location services



②: On an Apple device, open the Find My APP

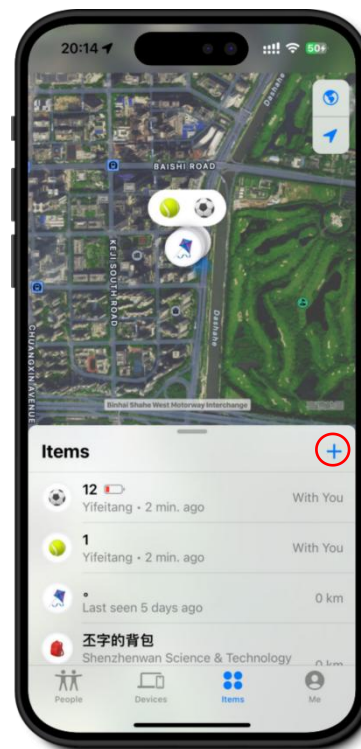

③: Select "Item" and click Add Item

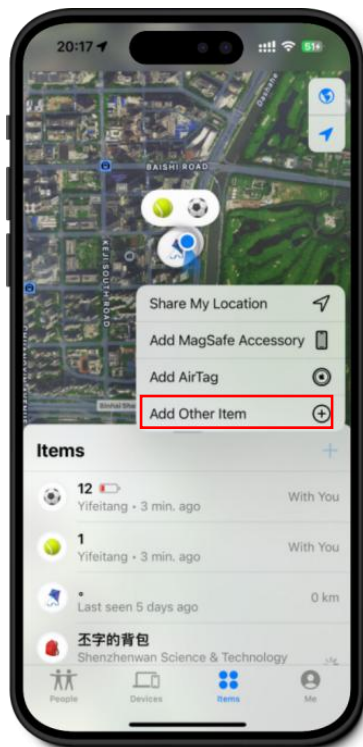

④:Select "Add Other Item"

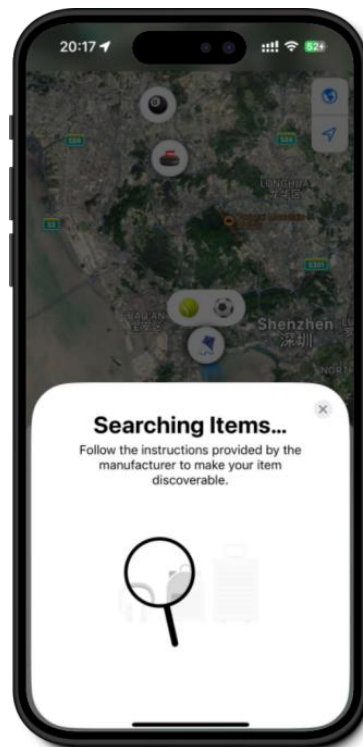

⑤:The words "searching item" appear

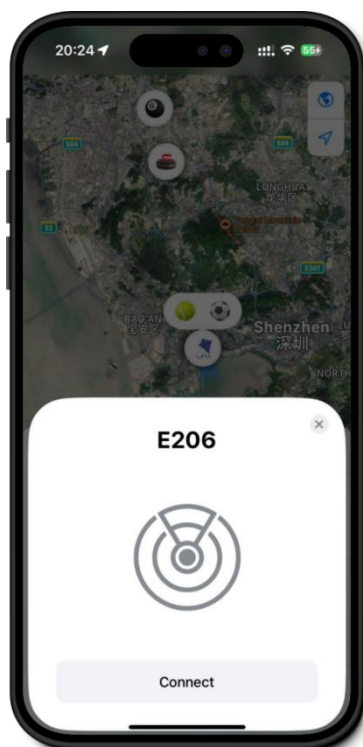

⑥:After finding the anti-loss device
Press the Connect button and add it successfully

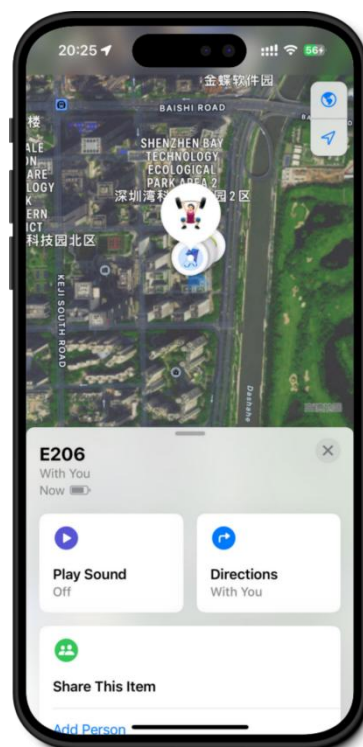

⑦:Added successfully

5. Loss mode:

Slide down the device detail screen, click to enable lost mode, and when the item location is available, the reserved phone number or electronic will receive a notification. Loss mode can be turned off in the same path.

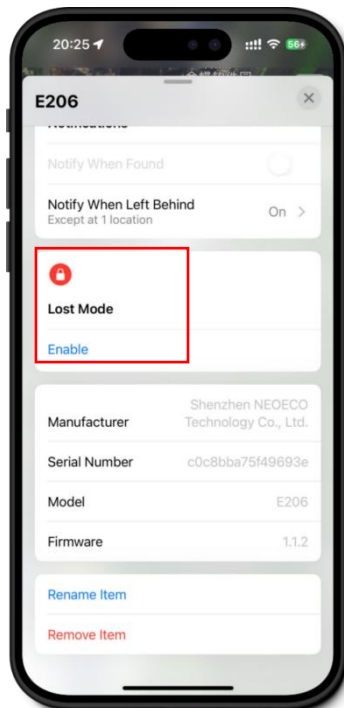

①: Click to enable lost mode

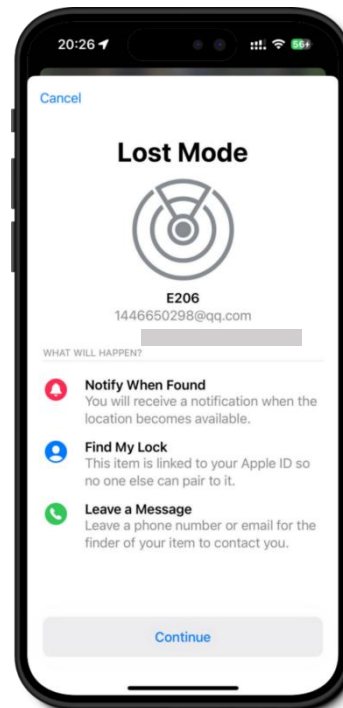

②: To understand the lost mode function, click Continue

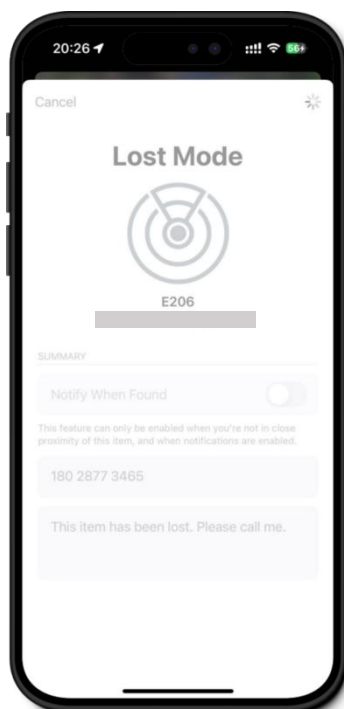

③: Reserve a phone number or email address to confirm the start of loss mode

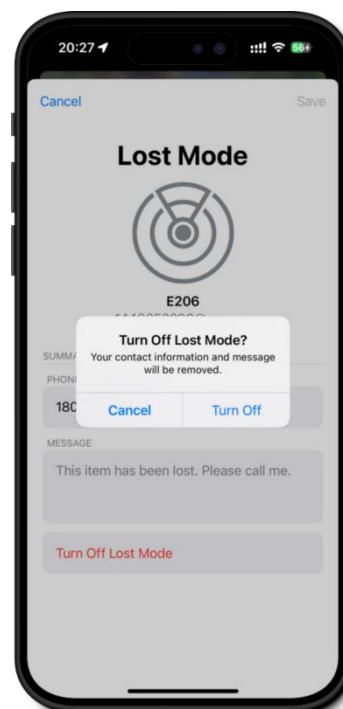

④: Turn off lost mode

6. Rename Item:

Slide down the device details screen and click Rename this item to rename the item type, name, and icon.

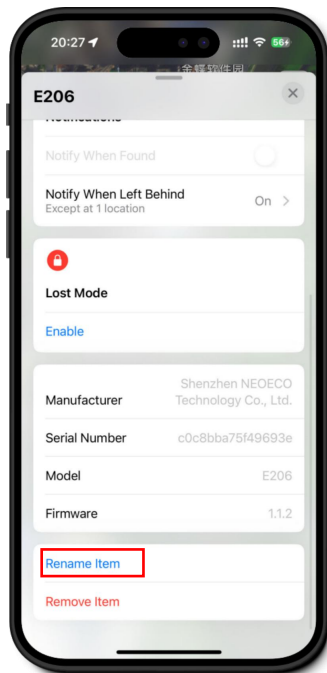

①: Click to rename this item

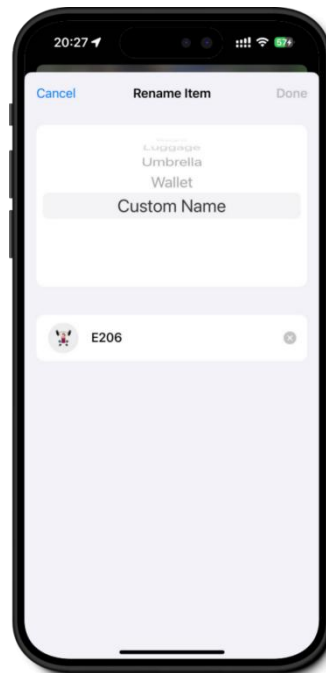

②: Click Finish after modification

7. Remove item:

Slide down the device detail screen and click Remove item to remove the item. After removal, the anti-loss device will play the untie prompt tone. Once removed, the item will be allowed to be activated and used by others.

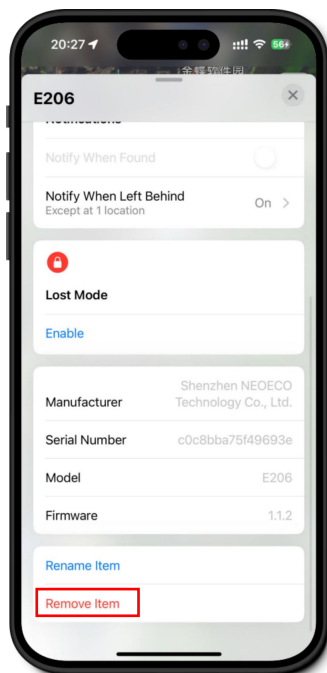

①: Click to remove the item

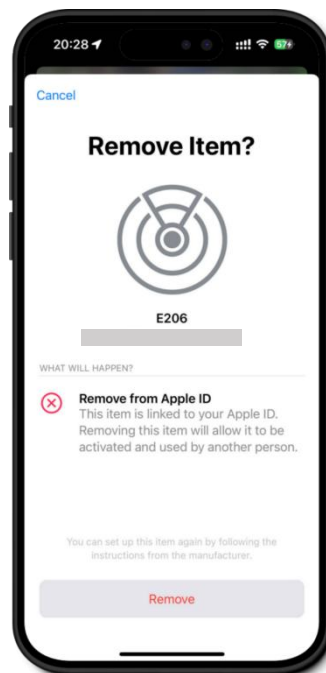

②: Remove item prompt; Allow others to use it after removal

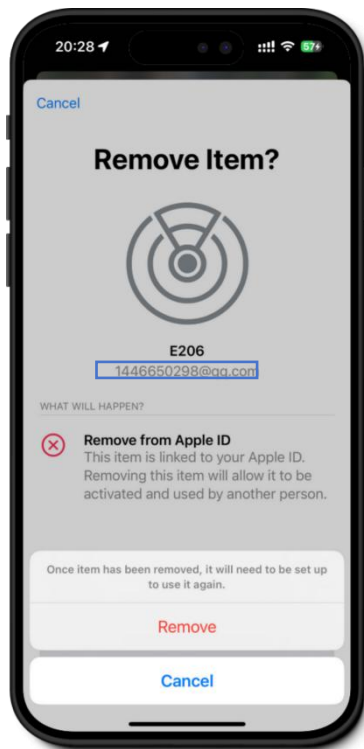

③: Confirm removal



④: Wait 30 seconds to complete the removal

8.battery replacement method:



- ① open the back shell (with logo silkscreen) : press and hold the back shell to the right (->open) and rotate to unscrew the lid
- ② Load the battery: load the new battery; Battery with silk screen facing up
- ③ Cover the back shell: install the corresponding buckle into the back shell, press and hold the back shell left (->close) to rotate the lock lid

9. Factory Reset Your E206 Tag:

- ①: Remove the battery cover: First, you need to press down and turn the battery cover of the E206 tag counterclockwise until the cover stops turning.
- ②: Take out the battery: Then, remove the cover and take out the battery.
- ③: Repeatedly install the battery 4 times (E206 Tag emits a beep sound, which counts as one beep)
- ④: repeated loading battery 4 times can restore factory Settings; (1s interval between each battery loading)
- ⑤: After completing the factory reset, the E206 Tag will emit two beeps.

10. Locate Your E206 Tag:

(1) Find E206 Tag when it's Nearby:

- ①: Open Find My app and select the " Items " tab
- ②: Tap on your E206 Tag from the list
- ③: Tap " Play Sound " to make your E206 Tag Beep
- ④: Tap " Stop Sound " to stop the beeps once you find it

(2) Find E206 Tag 's last Known Location:

- ①: Open Find My app and select the " Items " tab
- ②: Tap on your E206 Tag from the list
- ③: Your E206 Tag's last known location will appear on the map
- ④: To navigate to that last known location , tap " Direction " to open the Apple Maps app

(3) Find E206 Tag Out of Range

——Enabling : Notify When Left Behind ” :

- ①: Open Find My app and select the “ Items " tab
- ②: Tap on your E206 Tag from the list
- ③: Under “ Notifications " enable the " Notify When Left Behind " toggle
- ④: You will receive a notification when you leave your E206 Tag behind and it's no longer in range of your device

——Enabling “ Notify When Found ” :

- ①: Under " Notifications " enable the “ Notify When Found " toggle
- ②: When your E206 Tag is seen by another Find My enabled device , you will receive a notification of its updated location .
- ③: Note: " Notify When Found " can only be activated when your E206 Tag is out of range

(4) When Your E206 Tag Is Lost

——Enabling “ Lost Mode ”

- ①: Open Find My app and select the " Items " tab,
- ②: tap on your E206 Tag from the list
- ③: Under "Lost Mode " tap "Enable",
- ④: A screen detailing Lost Mode will pop up , tap “ Continue ”
- ⑤: Enter your phone number or email address and tap “ Next ”
- ⑥: You may enter a message that will be shared with the person that finds your item .
- ⑦: Tap "Activate " to enable " Lost Mode ”

- ⑧: Note: when "Lost iMode" is enabled, "Notify When Found" is automatically enabled
- ⑨: Note: When "Lost Mode" is enabled, your E206 Tag is locked and cannot be paired to a new iPhone or iPad

11. The Fine Print:

This device complies with part 15 of the FCC Rules. Operation is subject to the following two conditions: (1) This device may not cause harmful interference, and (2) this device must accept any interference received, including interference that may cause undesired operation.

Any changes or modifications not expressly approved by the party responsible for compliance could void the user's authority to operate the equipment.

NOTE: This equipment has been tested and found to comply with the limits for a Class B digital device, pursuant to Part 15 of the FCC Rules. These limits are designed to provide reasonable protection against harmful interference in a residential installation. This equipment generates, uses and can radiate radio frequency energy and, if not installed and used in accordance with the instructions, may cause harmful interference to radio communications. However, there is no guarantee that interference will not occur in a particular installation.

If this equipment does cause harmful interference to radio or television reception, which can be determined by turning the equipment off and on, the user is encouraged to try to correct the interference by one or more of the following measures:

- Reorient or relocate the receiving antenna.
- Increase the separation between the equipment and receiver.
- Connect the equipment into an outlet on a circuit different from that to which the receiver is connected.
- Consult the dealer or an experienced radio/TV technician for help.

The device has been evaluated to meet general RF exposure requirement. The device can be used in portable exposure condition without restriction.