

Product instructions for use

Wired Carlife to Wireless CarPlay

Product connection principle

Freed from the shackles of wired Carlife connectivity, wireless CarPlay brings a more convenient connection experience. When you manually connect the wireless CarPlay feature for the first time, it automatically connects the feature the next time you enter the car.

Usage conditions

Scope of use: iPhone 6 or above, iOS 13.5 or above
above versions

Compatibility mode: for original vehicles with cable
Carlife

Wireless connection

Note: iPhone enters the settings page, opens the Bluetooth list, and deletes the Bluetooth connection record in the car or other devices.

1: Insert the product interface into the original vehicle interface (with data transmission function), please connect according to the prompt (Figure 1).

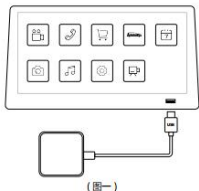

2: Click on the original screen "Carlife" function, the car will jump directly to the connection interface. (Figure 2)



3: Turn on iPhone Bluetooth and Wifi and search for devices in the Bluetooth name interface of the phone.

4: Click on the Bluetooth name that appears, and then click on "Use CarPlay in the car" to use Wireless CarPlay.

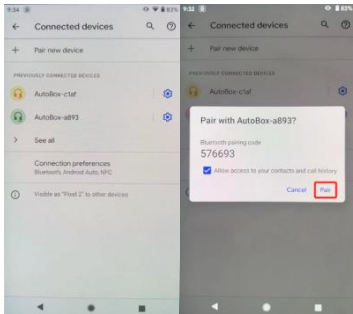

This device complies with part 15 of the FCC Rules. Operation is subject to the following two conditions: (1) this device may not cause harmful interference, and (2) this device must accept any interference received, including interference that may cause undesired operation.

Any changes or modifications not expressly approved by the party responsible for compliance could void the user's authority to operate the equipment. NOTE: This equipment has been tested and found to comply with the limits for a Class B digital device, pursuant to Part 15 of the FCC Rules. These limits are designed to provide reasonable protection against harmful interference in a residential installation. This equipment generates, uses and can radiate radio frequency energy and, if not installed and used in accordance with the instructions, may cause harmful interference to radio communications. However, there is no guarantee that interference will not occur in a particular installation.

If this equipment does cause harmful interference to radio or television reception, which can be determined by turning the equipment off and on, the user is encouraged to try to correct the interference by one or more of the following measures:

- Reorient or relocate the receiving antenna.
- Increase the separation between the equipment and receiver.
- Connect the equipment into an outlet on a circuit different from that to which the receiver is connected.
- Consult the dealer or an experienced radio/TV technician for help.

The device has been evaluated to meet general RF exposure requirement. The device can be used in portable exposure condition without restriction

Specific Absorption Rate (SAR) information:

This product meets the government's requirements for exposure to radio waves. The guidelines are based on standards that were developed by independent scientific organizations through periodic and thorough evaluation

of scientific studies. The standards include a substantial safety margin designed to assure the safety of all persons regardless of age or health.

FCC RF Exposure Information and Statement The SAR limit of USA (FCC) is 1.6 W/kg averaged over one gram of tissue. Device types: U1 (FCC ID: 2BHNQ-U1) has also been tested against this SAR limit. The highest SAR values for body are 0.28 W/Kg. This device was tested for typical body-worn operations with the product kept 5mm from the body. To maintain compliance with FCC RF exposure requirements, use accessories that maintain a 5mm separation distance between the user's body and the product. The use of belt clips, holsters and similar accessories should not contain metallic components in its assembly.

The use of accessories that do not satisfy these requirements may not comply with FCC RF exposure requirements, and should be avoided. Body-worn Operation

This device was tested for typical body-worn operations. To comply with RF exposure requirements, a minimum separation distance of 5mm must be maintained between the user's body and the product, including the antenna. Third-party belt-clips, holsters, and similar accessories used by this device should not contain any metallic components.

Body-worn accessories that do not meet these requirements may not comply with RF exposure requirements and should be avoided. Use only the supplied or an approved antenna.